

SEQUENCE OF CONSTRUCTION  
(For Bidding Purposes Only)

GENERAL:

1. THE SEQUENCE OF CONSTRUCTION SHOWN ON THE PLANS IS FOR THE PREPARATION AND COMPARISON OF BIDS ONLY. PRIOR TO THE START OF WORK, THE CONTRACTOR SHALL DEVELOP, IN DETAIL, A CONSTRUCTION SCHEDULE AND SEQUENCE OF CONSTRUCTION THAT SHALL CAUSE MINIMUM INTERFERENCE WITH TRAFFIC ALONG, ACROSS AND ADJACENT TO THE PROJECT DURING CONSTRUCTION. IF THE SCHEDULE OR SEQUENCE BECOMES UNWORKABLE OR UNSATISFACTORY AS WORK PROCEEDS, ADJUSTMENTS SHALL BE MADE. TWO LANES OF TRAFFIC ON ARAPAHO ROAD (ONE IN EACH DIRECTION) AND ACCESS TO ALL SIDE STREETS AND DRIVEWAYS MUST BE MAINTAINED AT ALL TIMES UNLESS OTHERWISE AUTHORIZED IN WRITING BY THE TOWN OF ADDISON.
2. DURING ALL PHASES OF CONSTRUCTION, TWO LANES OF TRAFFIC (22' MIN. PAVEMENT WIDTH INCLUDING DETOUR PAVEMENT) ON ARAPAHO ROAD (ONE IN EACH DIRECTION) AND ACCESS TO ALL SIDE STREETS AND DRIVEWAYS MUST BE MAINTAINED AT ALL TIMES UNLESS OTHERWISE AUTHORIZED IN WRITING BY THE TOWN OF ADDISON.
3. LIGHTED BARRICADES, TEMPORARY PAVEMENT MARKINGS, AND CHANNELIZING DEVICES CONFORMING TO THE CURRENT EDITION OF THE M.U.T.C.D. SHALL BE USED DURING ALL STAGES OF CONSTRUCTION TO CONTROL TRAFFIC FLOW THROUGH THE WORK ZONES.
4. MAINTAIN A MINIMUM RADIUS OF 20 FEET ON ALL STREET CONNECTIONS AND 10 FEET ON ALL DRIVEWAY CONNECTIONS DURING CONSTRUCTION OF ARAPAHO ROAD TO ACCOMMODATE THE TRAFFIC USING THE ROADWAY DURING CONSTRUCTION.
5. POLLUTION CONTROL DEVICES MUST BE PROPERLY INSTALLED AND MAINTAINED DURING ALL STAGES OF CONSTRUCTION.
6. VERIFY THE LOCATION OF ALL EXISTING UTILITIES AND RELOCATE, IF NECESSARY, PRIOR TO THE START OF ANY STAGE OF CONSTRUCTION, AND INSTALL STORMWATER TO THE EXTENT POSSIBLE.
7. DRIVEWAY CONSTRUCTION MAY BE DONE DURING ONE PHASE OF CONSTRUCTION INSTEAD OF TWO PHASES (1/2 DRIVE - 1/2 DRIVE) WITH THE PERMISSION OF THE AFFECTED PROPERTY OWNER. CONTACT THE AFFECTED PROPERTY OWNER A MINIMUM 48 HOURS PRIOR TO BEGINNING CONSTRUCTION OF ANY DRIVEWAYS.
8. IT IS ASSUMED THAT ALL FRANCHISED UTILITIES HAVE BEEN RELOCATED BY OTHERS PRIOR TO THE COMMENCEMENT OF CONSTRUCTION.
9. THE CONTRACTOR SHALL VERIFY THE LOCATION OF ALL EXISTING UTILITIES PRIOR TO THE COMMENCEMENT OF CONSTRUCTION AND NOTIFY THE TOWN OF ADDISON AND RELATIVE UTILITY COMPANY IMMEDIATELY IF A CONFLICT IS FOUND TO EXIST.
10. CONTRACTOR SHALL COORDINATE & COOPERATE WITH THE DART CONTRACTOR WHO IS CONSTRUCTING THE DART STATION AT THE NORTHWEST CORNER OF QUORUM DRIVE & PROPOSED ARAPAHO ROAD.

NOTE:  
CONTRACTOR SHALL COMPLETE THE SECTION OF ARAPAHO ROAD FROM ADDISON ROAD TO QUORUM DRIVE BY SEPTEMBER 30, 1998.

RECORD DOCUMENTS 6/9/2000

THESE RECORD DOCUMENTS HAVE BEEN PREPARED BASED ON INFORMATION PROVIDED BY OTHERS. THE CONSULTANT HAS NOT VERIFIED THE ACCURACY AND/OR COMPLETENESS OF THIS INFORMATION AND SHALL NOT BE RESPONSIBLE FOR ANY ERRORS OR OMISSIONS THAT MAY BE INCORPORATED AS A RESULT OF ERRONEOUS INFORMATION PROVIDED BY OTHERS.

THE SEAL APPEARING ON THIS DOCUMENT WAS AUTHORIZED BY KENNETH A. ROBERTS, P.E. 55446 ON OCTOBER 24, 1997

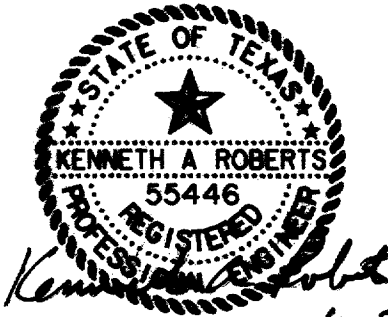

CONSTRUCTION SEQUENCING PLAN  
PHASE I

ARAPAHO ROAD

ADDISON ROAD TO DALLAS NORTH TOLLWAY

TOWN OF ADDISON, TEXAS

Huitt-Zollars, Inc./Consulting Engineers  
Dallas, Fort Worth, Houston, Phoenix, Tustin

DESIGN	DRAWN	APPR.	SCALE	DATE	PROJECT NO.	NO.
HZI	HZI	KAR	1"=50'	OCT 97	1772-01	CS-1

	TEMPORARY DETOUR (ASPHALT)
	UNDER CONSTRUCTION
	COMPLETED CONSTRUCTION
	TRAFFIC FLOW DURING CONSTRUCTION

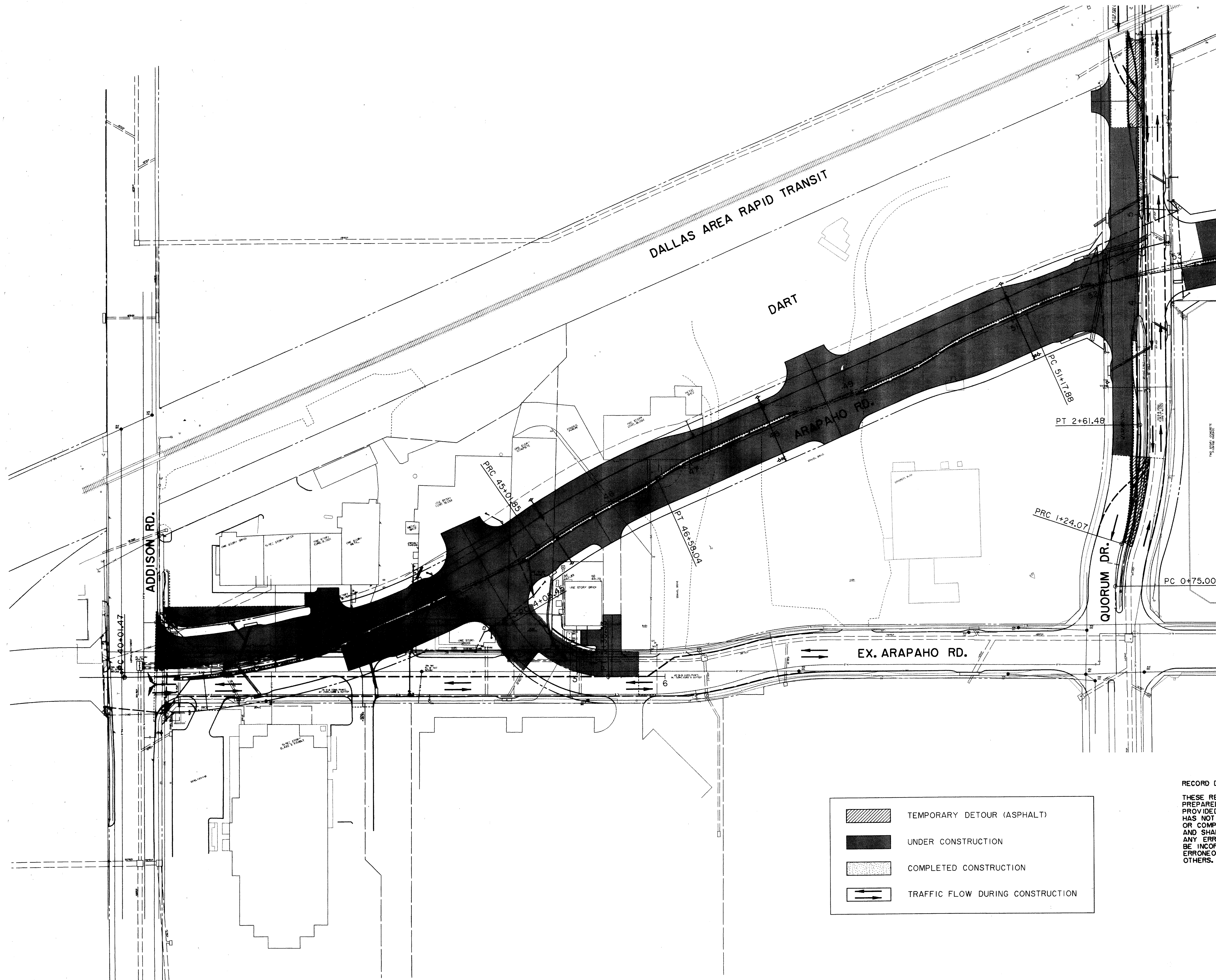

THESE RECORD DOCUMENTS HAVE BEEN PREPARED BASED ON INFORMATION PROVIDED BY OTHERS. THE CONSULTANT HAS NOT VERIFIED THE ACCURACY AND/OR COMPLETENESS OF THIS INFORMATION AND SHALL NOT BE RESPONSIBLE FOR ANY ERRORS OR OMISSIONS THAT MAY BE INCORPORATED AS A RESULT OF ERRONEOUS INFORMATION PROVIDED BY OTHERS.