

DALLAS AREA RAPID TRANSIT

ARAPAHO RD.

EX. ARAPAHO RD.

SPECTRUM

DALLAS NORTH TOLLWAY

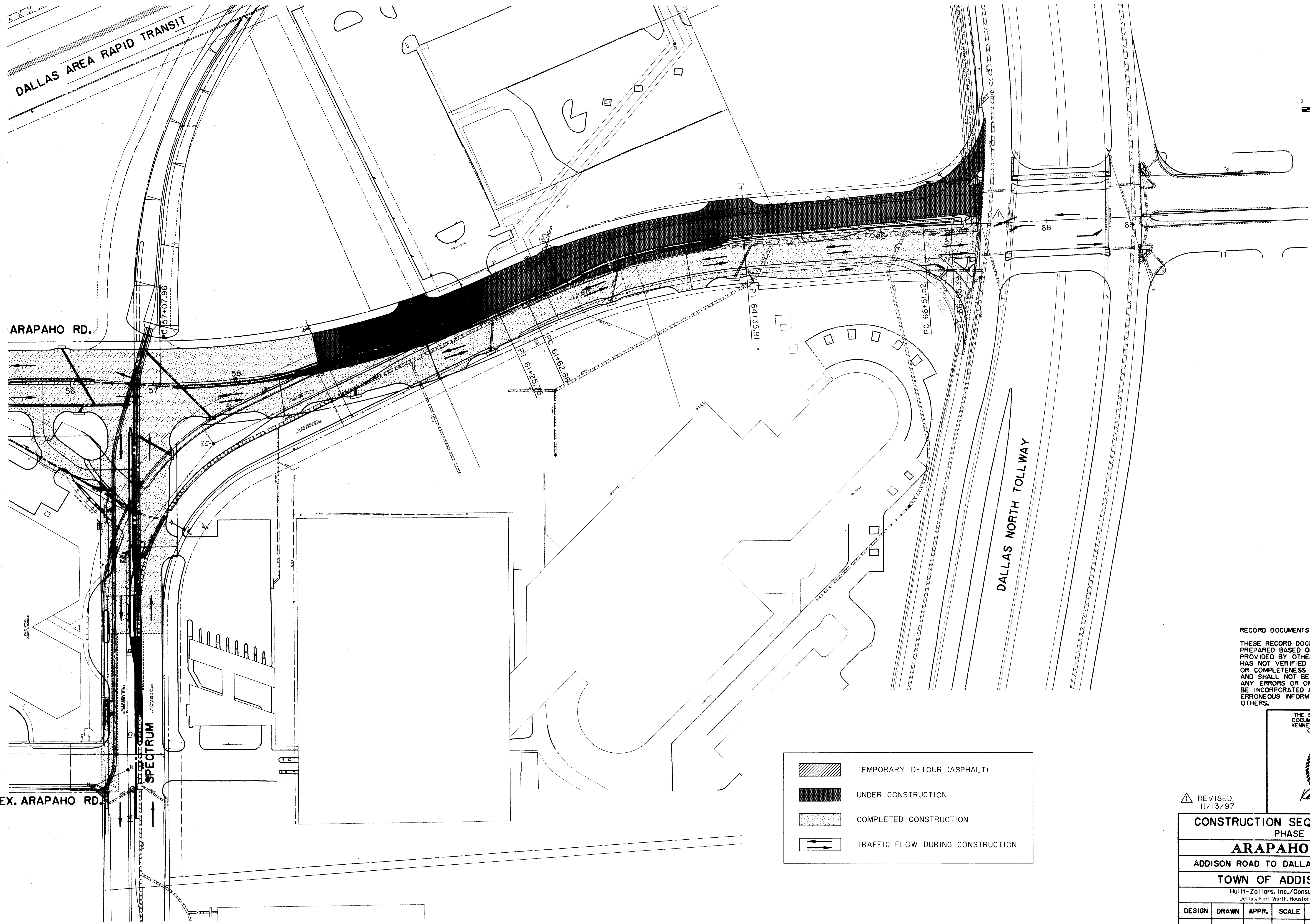
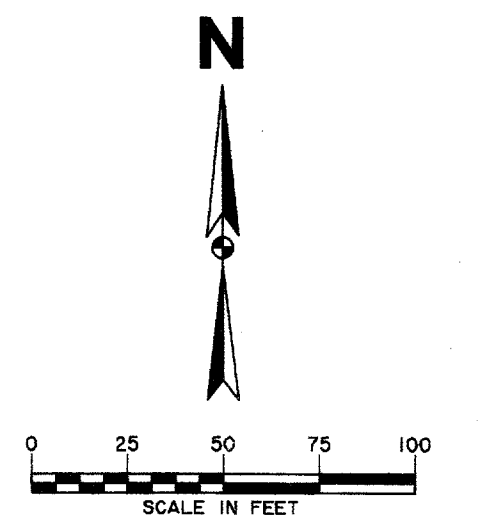

	TEMPORARY DETOUR (ASPHALT)
	UNDER CONSTRUCTION
	COMPLETED CONSTRUCTION
	TRAFFIC FLOW DURING CONSTRUCTION

RECORD DOCUMENTS 6/9/2000
 THESE RECORD DOCUMENTS HAVE BEEN PREPARED BASED ON INFORMATION PROVIDED BY OTHERS. THE CONSULTANT HAS NOT VERIFIED THE ACCURACY AND/OR COMPLETENESS OF THIS INFORMATION AND SHALL NOT BE RESPONSIBLE FOR ANY ERRORS OR OMISSIONS THAT MAY BE INCORPORATED AS A RESULT OF ERRONEOUS INFORMATION PROVIDED BY OTHERS.

THE SEAL APPEARING ON THIS DOCUMENT WAS AUTHORIZED BY KENNETH A. ROBERTS, P.E. 55446 ON OCTOBER 24, 1997

Kenneth A. Roberts
10-24-97

△ REVISED 11/13/97

CONSTRUCTION SEQUENCING PLAN						
PHASE 5						
ARAPAHO ROAD						
ADDISON ROAD TO DALLAS NORTH TOLLWAY						
TOWN OF ADDISON, TEXAS						
Hult-Zollars, Inc./Consulting Engineers Dallas, Fort Worth, Houston, Phoenix, Tustin						
DESIGN	DRAWN	APPR.	SCALE	DATE	PROJECT NO.	NO.
HZI	HZI	KAR	1"=50'	OCT 97	1772-01	CS-7