

NOTE: CONCRETE TO HAVE MINIMUM 3000 P.S.I. COMPRESSIVE STRENGTH AT 28 DAYS AND MINIMUM CEMENT CONTENT OF 5 BAGS PER CUBIC YARD OF CONCRETE.

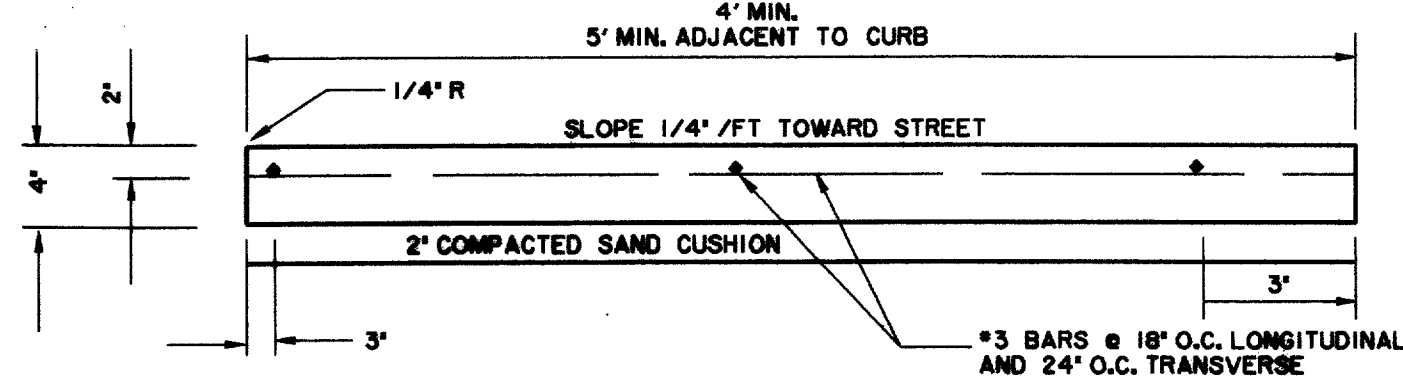

SECTION D-D
TYPICAL SECTION

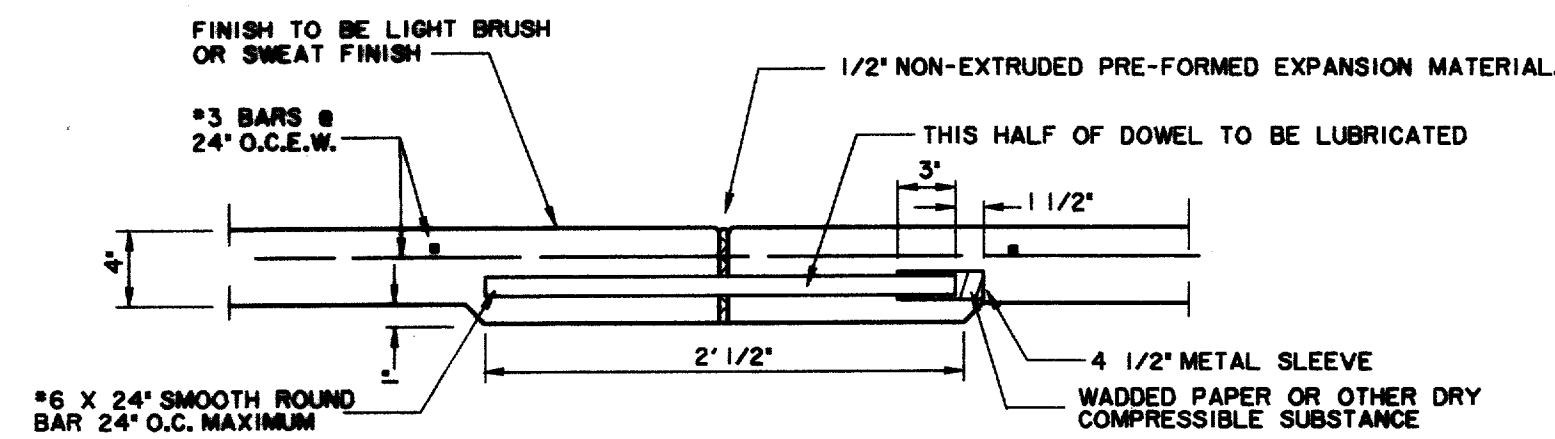

SECTION E-E
EXPANSION JOINT DETAIL

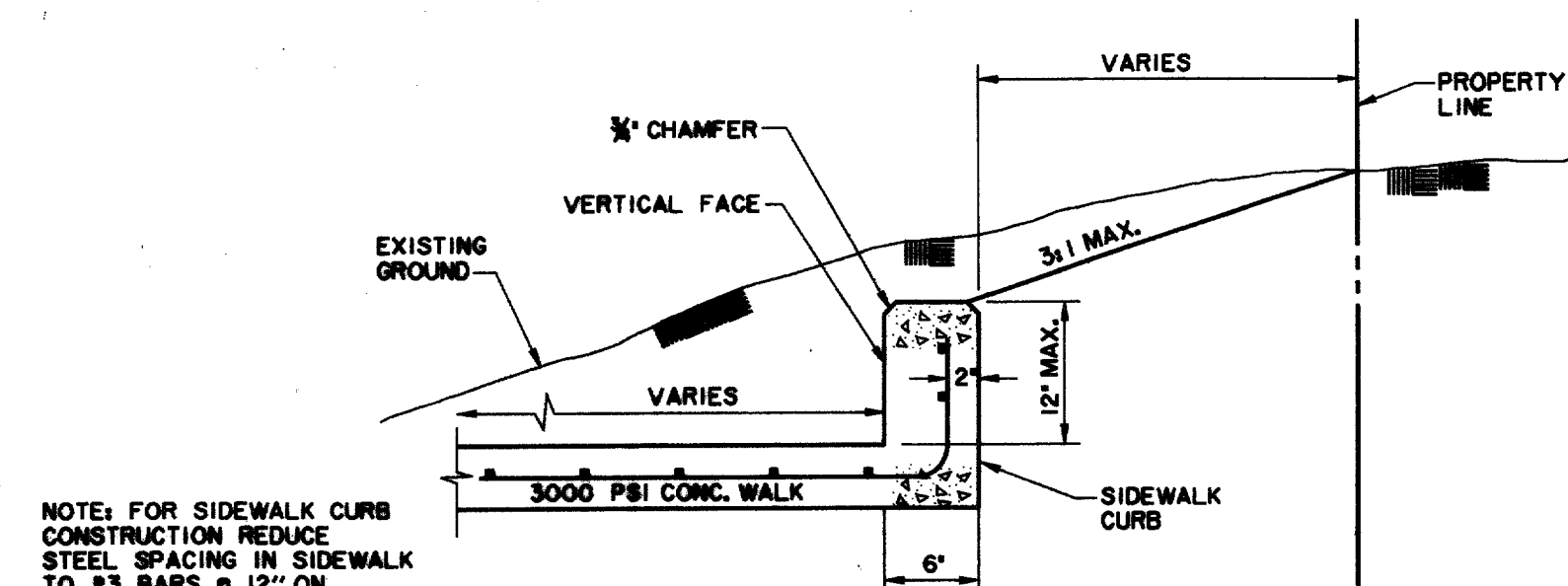

SIDEWALK CURB DETAIL

NOTE: FOR SIDEWALK CURB CONSTRUCTION REDUCE STEEL SPACING IN SIDEWALK TO #3 BARS @ 12\"/>

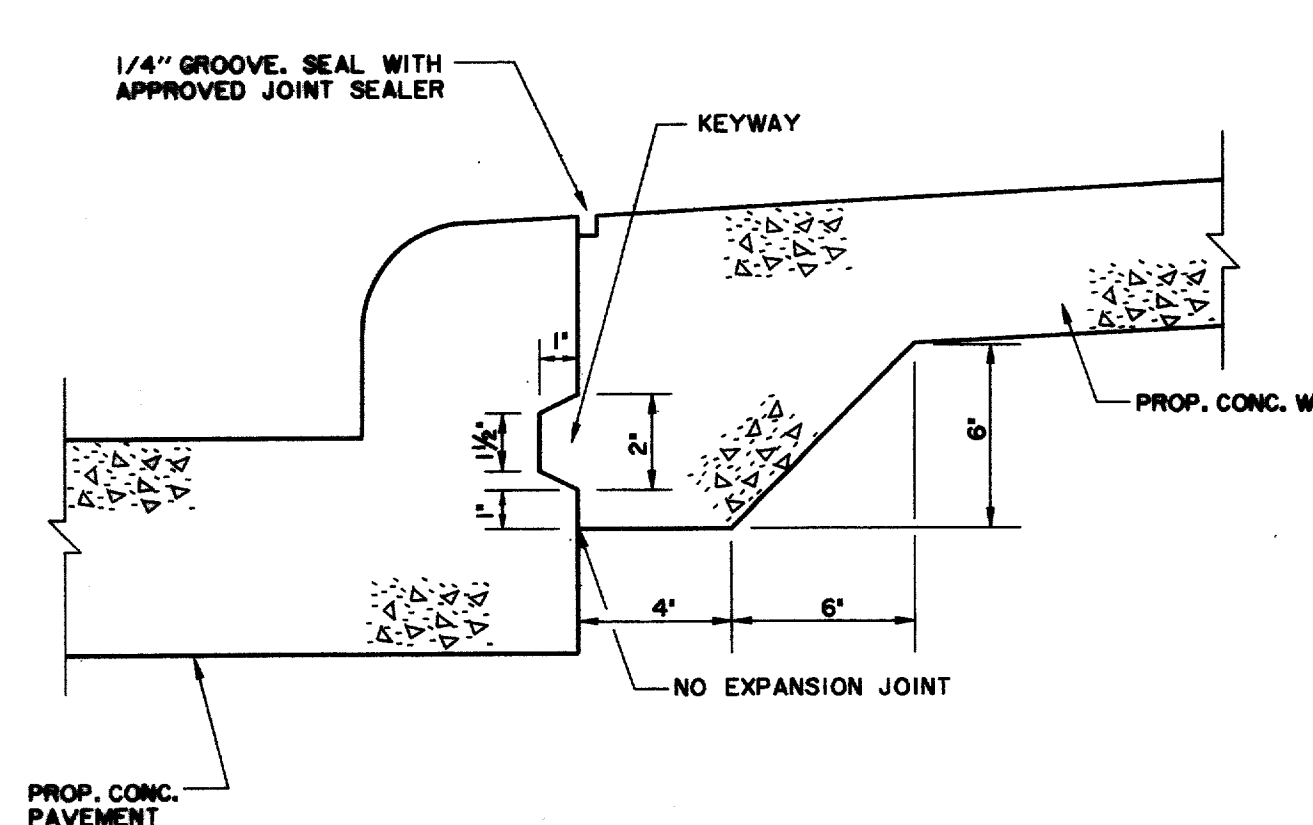

JOINT DETAIL FOR SIDEWALK
ADJACENT TO PROPOSED PAVEMENT

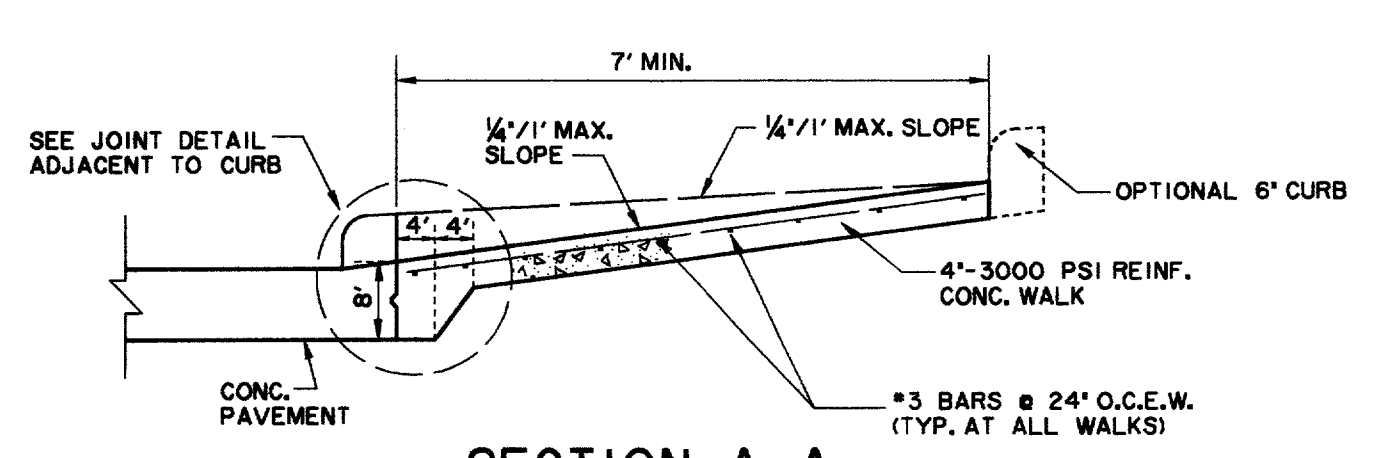

SECTION A-A

NOTES:
1. ALL HONEYCOMB IN BACK OF CURB TO BE TROWEL-PLASTERED BEFORE POURING SIDEWALK
2. LUG MAY BE FORMED BY SHAPING SUBGRADE TO APPROXIMATE DIMENSIONS SHOWN.

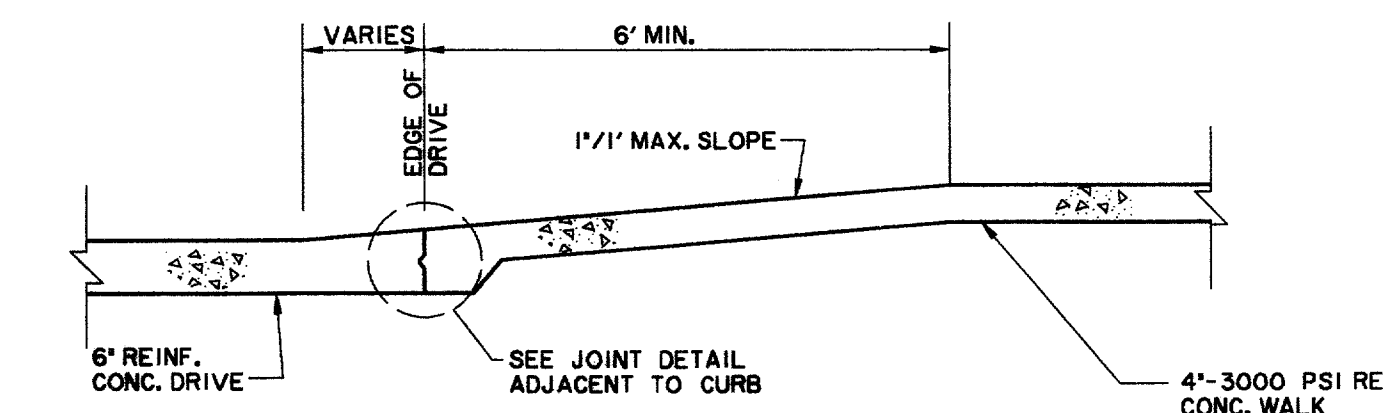

SECTION B-B

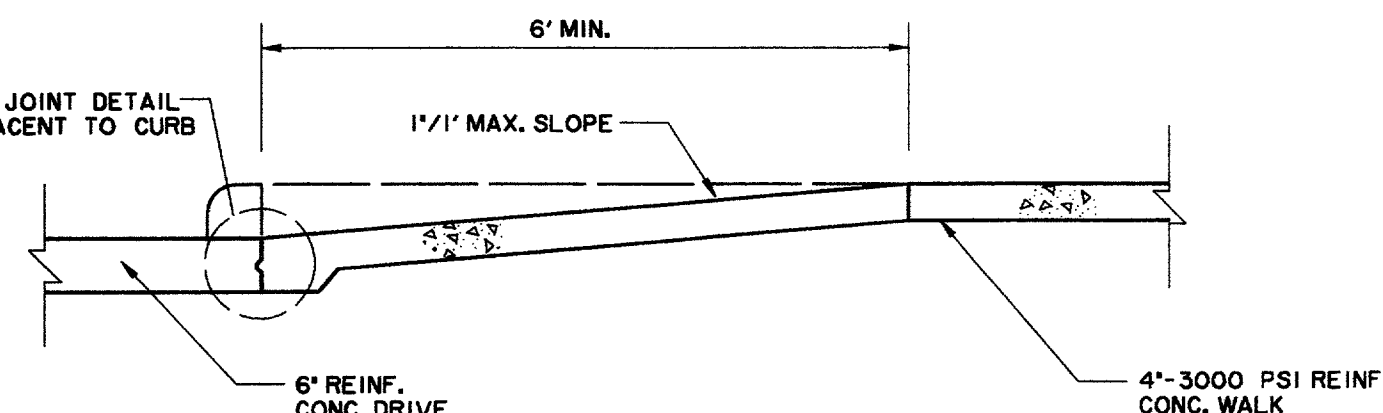

SECTION C-C

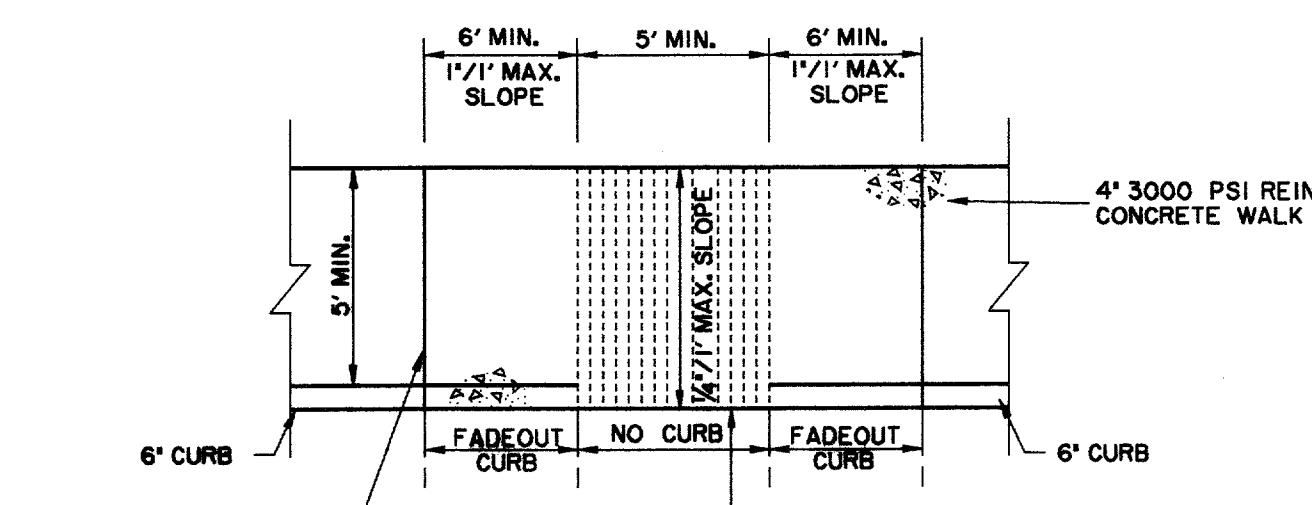

BARRIER FREE RAMP IN STRAIGHT CURB
SIDEWALK ADJACENT TO CURB

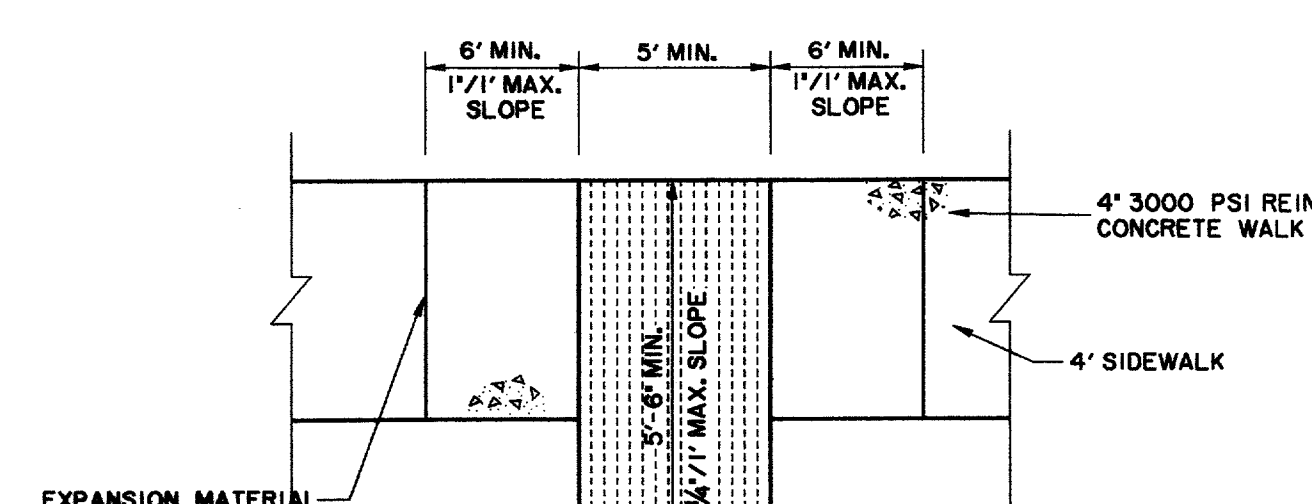

BARRIER FREE RAMP IN STRAIGHT CURB
SIDEWALK AWAY FROM CURB

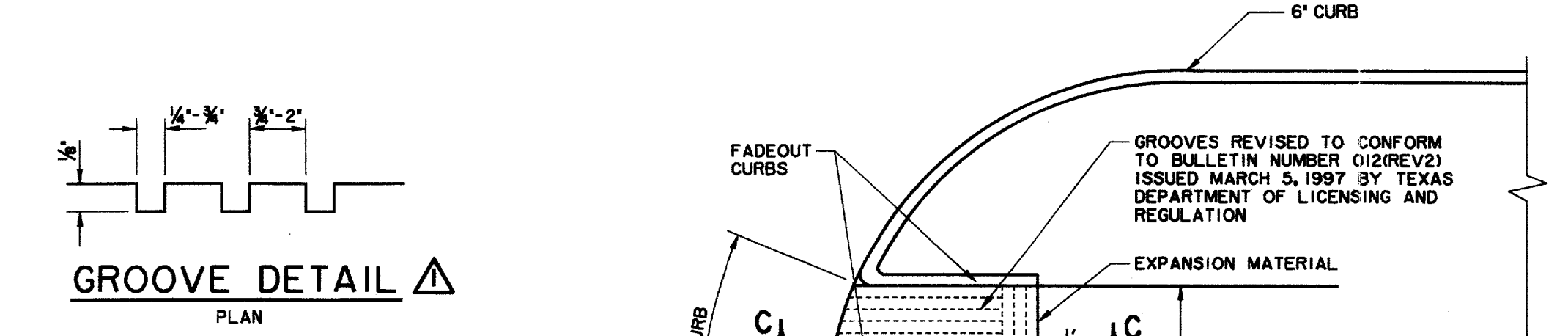

GROOVE DETAIL
PLAN

NOTE: ENTIRE BARRIER FREE RAMP AREA TO HAVE GROOVED TEXTURE.

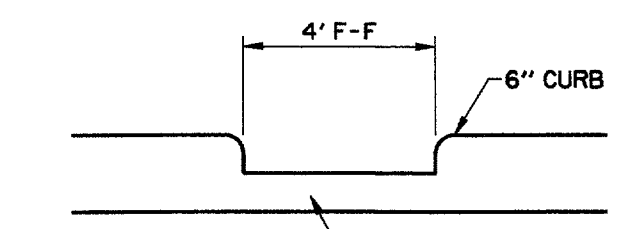

BARRIER FREE
WALK DETAIL

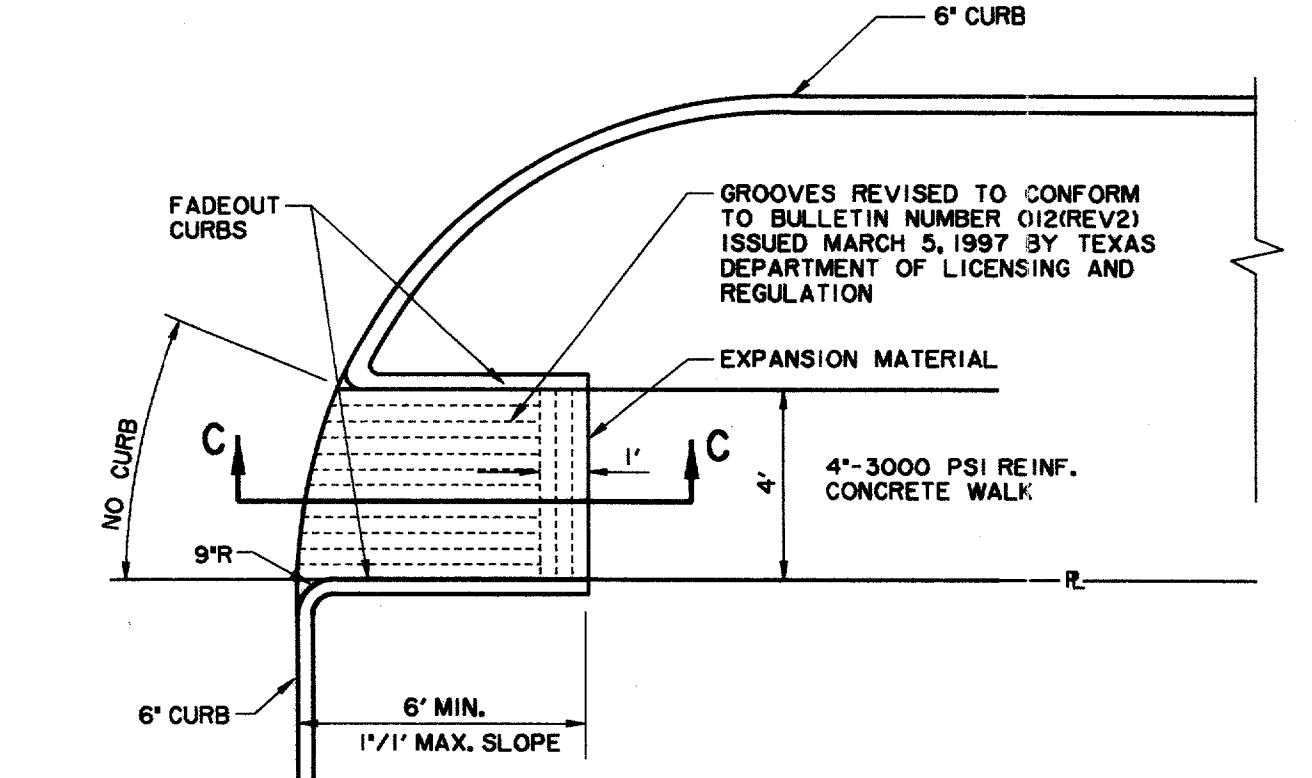

BARRIER FREE RAMP
AT CURBED DRIVE

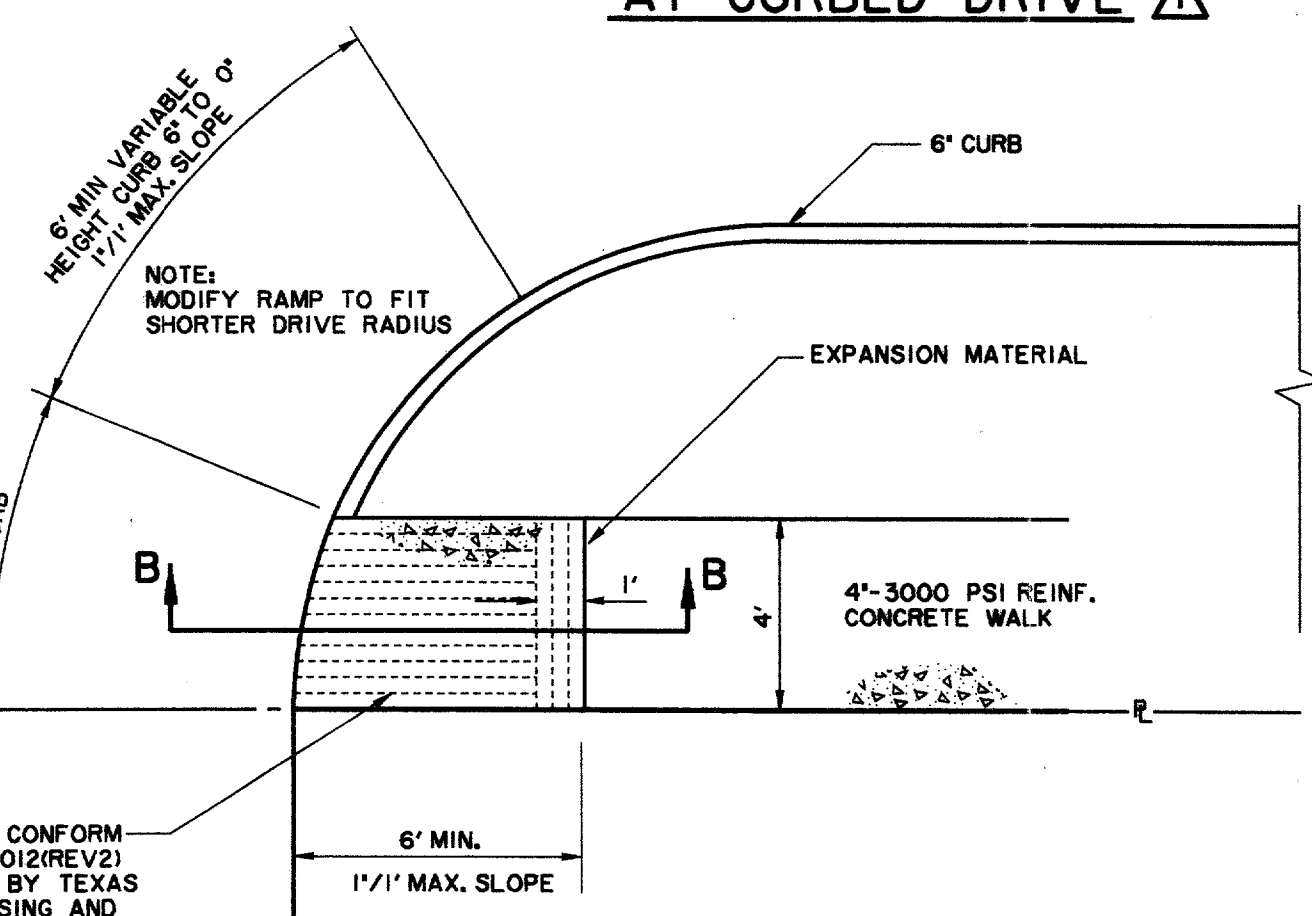

BARRIER FREE RAMP
AT DRIVE

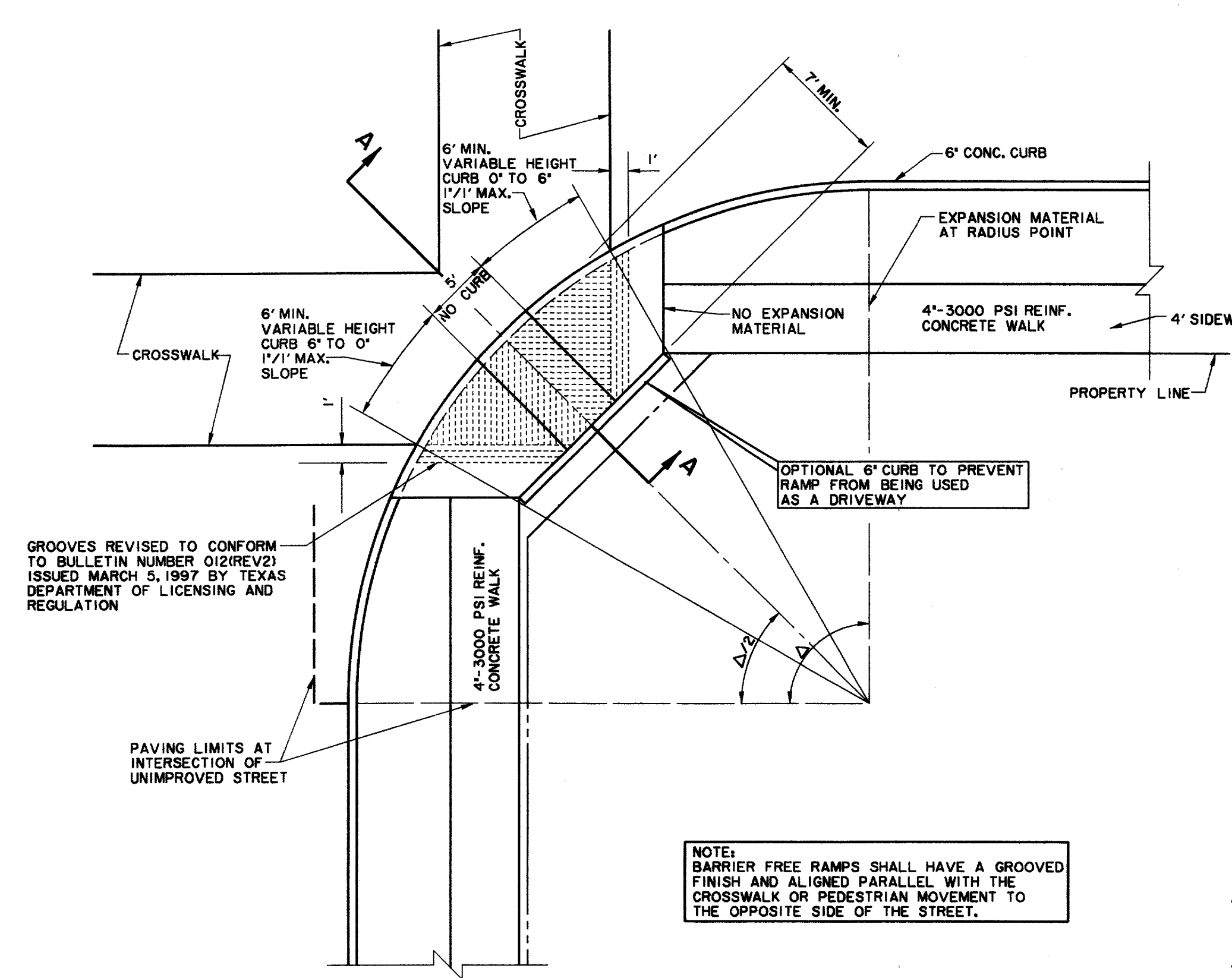

BARRIER FREE RAMP DETAIL
AT INTERSECTING STREET

BARRIER FREE RAMP GENERAL NOTES

1. MAXIMUM SLOPE ON BARRIER FREE RAMPS MUST NOT EXCEED ONE INCH PER FOOT AT ANY LOCATION.
2. DESIGNS SHOWN ARE FOR 6\"/>

REVISÉ 1/16/98
ADDENDUM #2, 11/18/97

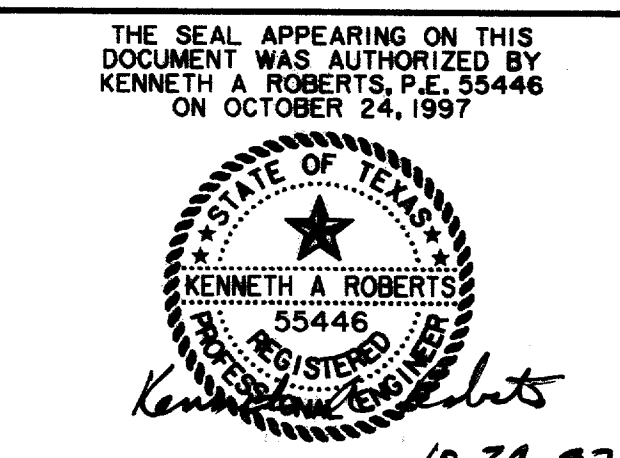

SIDEWALK & B.F. RAMP DETAILS						
ARAPAHO ROAD						
ADDISON ROAD TO DALLAS NORTH TOLLWAY						
TOWN OF ADDISON, TEXAS						
Huitt-Zollars, Inc./Consulting Engineers Dallas, Fort Worth, Houston, Phoenix, Tustin						
DESIGN	DRAWN	APPR.	SCALE	DATE	PROJECT NO.	NO.
HZI	HZI	KAR	N.T.S.	OCT 97	1772-01	P-14

RECORD DOCUMENTS 6/9/2000
THESE RECORD DOCUMENTS HAVE BEEN PREPARED BASED ON INFORMATION PROVIDED BY OTHERS. THE CONSULTANT HAS NOT VERIFIED THE ACCURACY AND/OR COMPLETENESS OF THIS INFORMATION AND SHALL NOT BE RESPONSIBLE FOR ANY ERRORS OR OMISSIONS THAT MAY BE INCORPORATED AS A RESULT OF ERRONEOUS INFORMATION PROVIDED BY OTHERS.