

- IMPORTANT
- MESA Design Group assumes no responsibility for any excavation or grading not shown on surveys or civil engineer's plans supplied to MESA Design Group.
 - All proposed and finished grades provided by MESA Design Group are based on information provided by owner's surveyor and/or civil engineer. Any discrepancies in actual field measurements are to be reported to landscape architect immediately.
 - Contractor shall be responsible for making himself familiar with all underground utilities, pipes, structures, and line runs.
 - Prior to commencement of hardscape construction, all piers, footings, and walls are to be surveyed, laid out, and staked in field for approval by landscape architect. Contractor shall assume responsibility for any demolition, adjustments, or reconstruction resulting from unauthorized construction activities.
 - Contractor is responsible for all final quantities per drawings and specifications. Any quantities provided by MESA Design Group are provided as a convenience only and shall not be considered absolute. Landscape architect should be notified if any discrepancies occur.

All median and parkway planting areas shall have 6 inches of topsoil placed prior to planting. The topsoil shall be tilled into the soil below a minimum of 4 inches deep. Backfill in the medians under the proposed topsoil shall consist of friable native material free of rocks and debris. The cost of topsoil and median backfill shall be subsidiary to the contract.

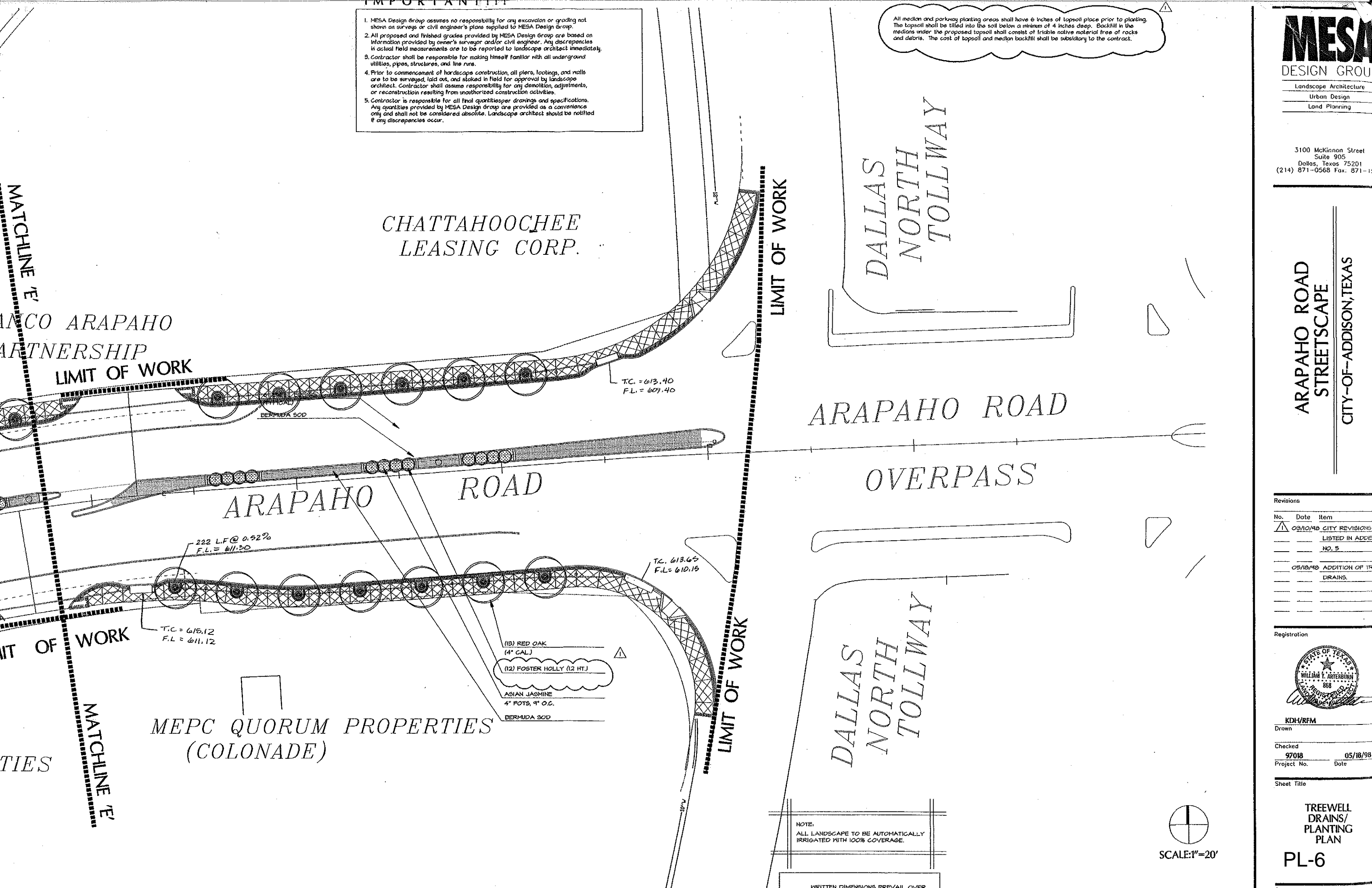

3100 McKinnon Street
Suite 905
Dallas, Texas 75201
(214) 871-0568 Fax: 871-1111

ARAPAHO ROAD
STREETSCAPE
CITY-OF-ADDISON, TEXAS

Revisions

| No. | Date | Item |
|-----|----------|--|
| 1 | 03/10/98 | CITY REVISIONS LISTED IN ADDITION TO NO. 5 |
| 2 | 05/18/98 | ADDITION OF TREE DRAINS. |

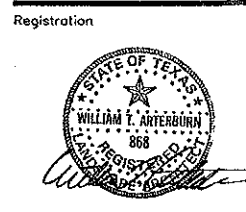

KDH/RFM
Drawn
Checked
97018
Project No. 05/18/98
Date

Sheet Title
TREWELL
DRAINS/
PLANTING
PLAN
PL-6

NOTE:
ALL LANDSCAPE TO BE AUTOMATICALLY
IRRIGATED WITH 100% COVERAGE.

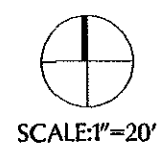

WRITTEN DIMENSIONS PREVAIL OVER