

TYPICAL HANGING SIGNAL INSTALLATIONS

Advance warning channelizing devices are optional.

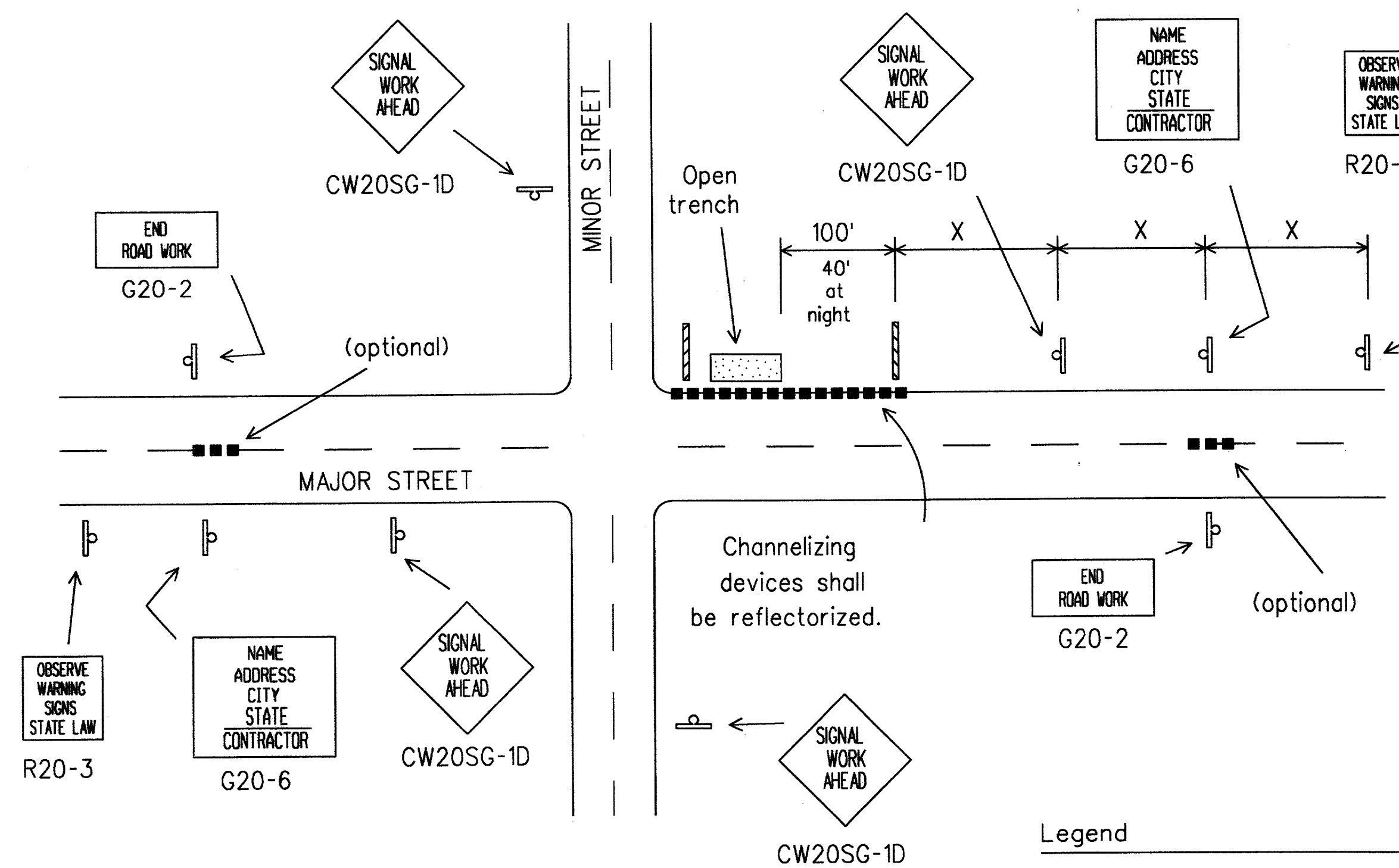

TYPICAL ADVANCE SIGNING

Legend

- Heavy Work Vehicle
- Type I Barricade
- Channelizing Devices

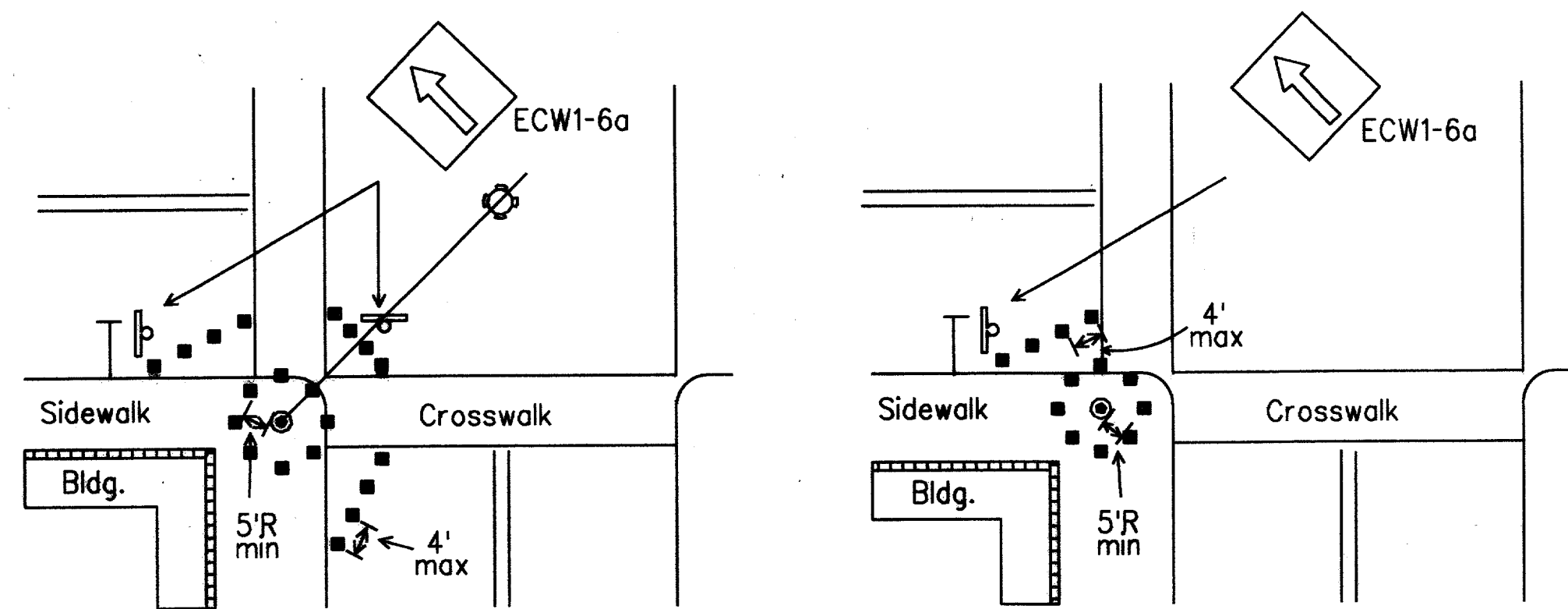

Channelizing devices should not be placed closer than 5 foot radius (minimum) to signal poles.  
 Parking may be eliminated by placing channelizing devices in spaces.  
 If pedestrian walkways are blocked, refer to TMUTCD.

TYPICAL RESTRICTED PEDESTRIAN MOVEMENTS

Typical channelizing device is the 28" cone. Plastic drums may be used if approved by the Engineer. Metal drums shall NOT be used as a channelizing device or sign support.

For several closely adjoining projects, advance signing may not be required in advance of each intersection, but only in advance of the intersections at the project limits. See details elsewhere in the plans for advance signing requirements.

Advance signs and barricades shall be in place when signal construction operations are in progress. The contractor may remove advance signs and barricades when no construction operations are underway if permitted elsewhere in the plans. Obstructions or hazards at the work area shall be clearly marked and delineated at all times.

All holes, trenches or other hazardous areas shall be adequately protected by barricades, lights or other protective devices. Trenches shall be covered or surrounded with orange plastic construction fence as directed by the Engineer.

Flagger and FCW20-7a sign may be required according to field conditions. Vehicles parked in roadway shall be equipped with two strobes. High level flags at corners of vehicle may also be used. Work operations that require work vehicle in traveled way 20 minutes or less may use cones, high level flags and strobes as advance warning devices. Cones should only be placed around vehicle. Flaggers may be used on high speed rural intersections.

RECORD DOCUMENTS 6/9/2000

THESE RECORD DOCUMENTS HAVE BEEN PREPARED BASED ON INFORMATION PROVIDED BY OTHERS. THE CONSULTANT HAS NOT VERIFIED THE ACCURACY AND/OR COMPLETENESS OF THIS INFORMATION AND SHALL NOT BE RESPONSIBLE FOR ANY ERRORS OR OMISSIONS THAT MAY BE INCORPORATED AS A RESULT OF ERRONEOUS INFORMATION PROVIDED BY OTHERS.

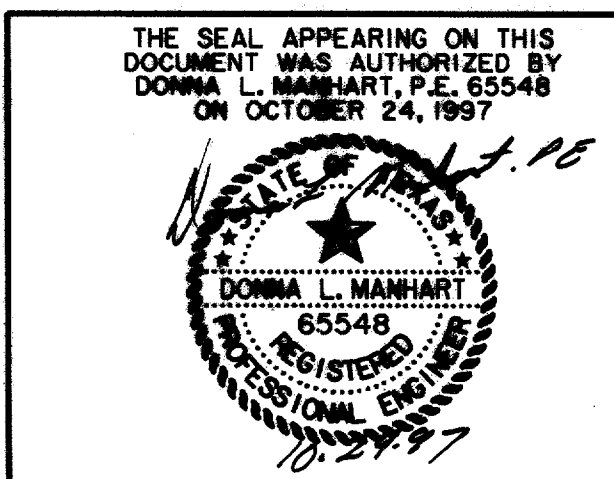

TRAFFIC SIGNAL INSTALLATION TYPICAL DETAILS						
ARAPAHO ROAD						
ADDISON ROAD TO DALLAS NORTH TOLLWAY						
TOWN OF ADDISON, TEXAS						
Hull-Zollars, Inc./Consulting Engineers Dallas, Fort Worth, Houston, Phoenix, Tulsa						
DESIGN	DRAWN	APPR.	SCALE	DATE	PROJECT NO.	NO.
HZI	HZI	DLM	NTS	OCT 97	1772-01	S-13