

AREA B-26 IS DRAINAGE AREA FOR EXISTING STORM SEWER IN ADDISON RD. AND CLARA ST. NORTH OF RAILROAD
 $t_c = 16.13$ MIN.
 $C = 0.90$
 $i_{100} = 7.4$ in/hr

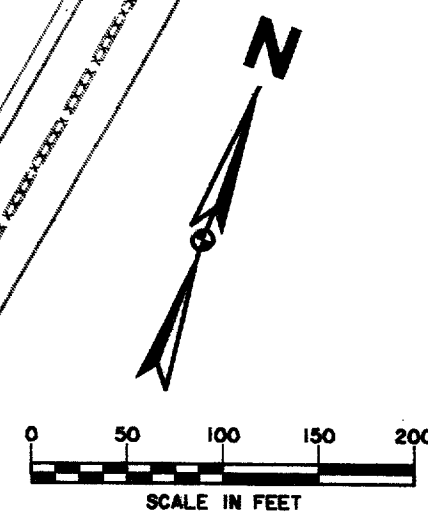
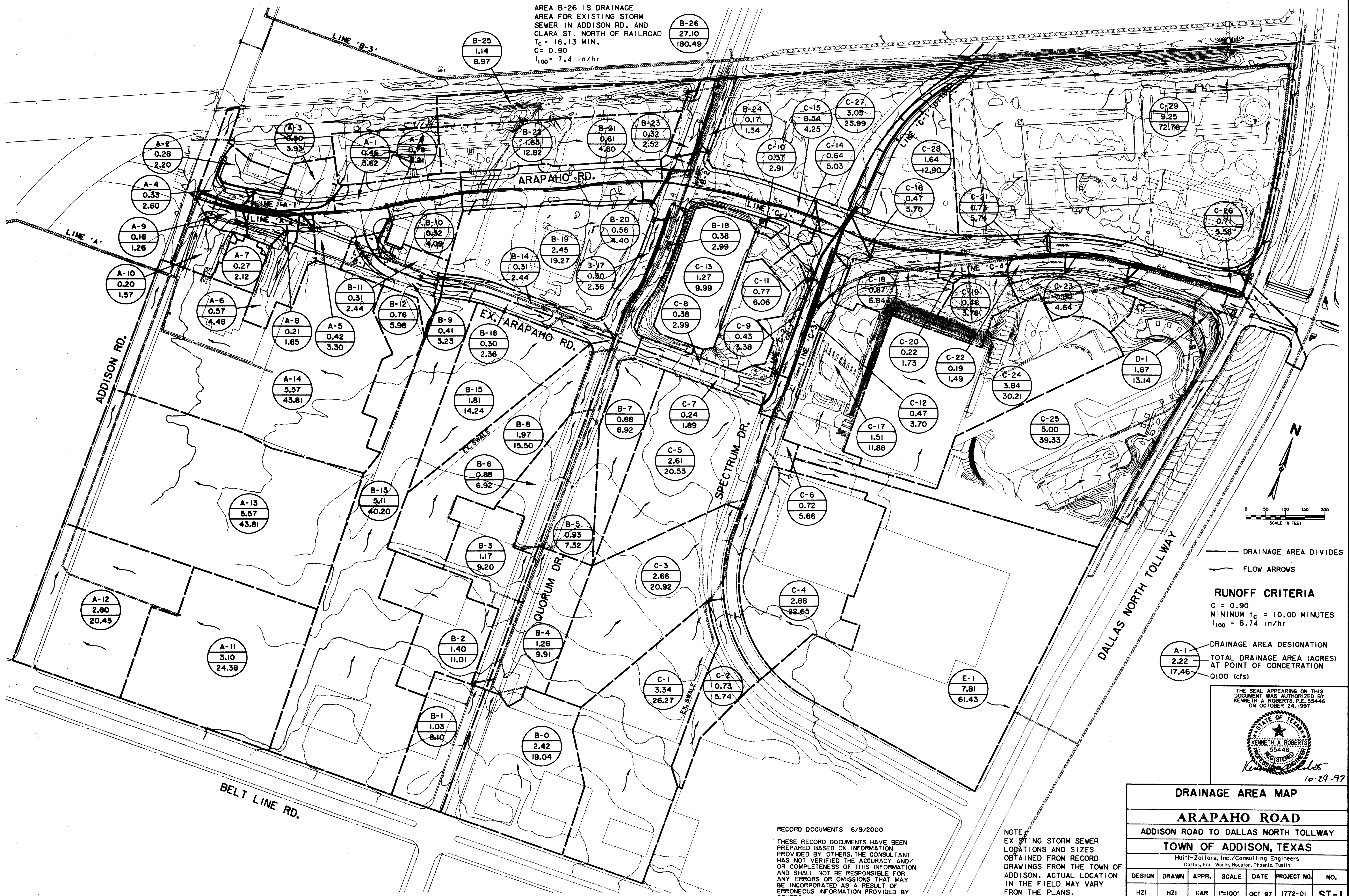

--- DRAINAGE AREA DIVIDES
 --- FLOW ARROWS

RUNOFF CRITERIA
 $C = 0.90$
 MINIMUM $t_c = 10.00$ MINUTES
 $i_{100} = 8.74$ in/hr

A-1
 2.22
 17.46
 DRAINAGE AREA DESIGNATION
 TOTAL DRAINAGE AREA (ACRES) AT POINT OF CONCENTRATION
 Q100 (cfs)

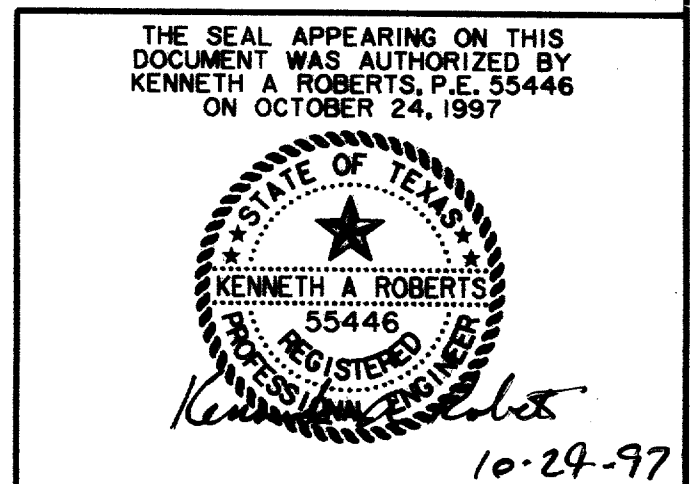

DRAINAGE AREA MAP						
ARAPAHO ROAD						
ADDISON ROAD TO DALLAS NORTH TOLLWAY						
TOWN OF ADDISON, TEXAS						
Huitt-Zollars, Inc./Consulting Engineers Dallas, Fort Worth, Houston, Phoenix, Tustin						
DESIGN	DRAWN	APPR.	SCALE	DATE	PROJECT NO.	NO.
HZI	HZI	KAR	1"=100'	OCT 97	1772-01	ST-1

RECORD DOCUMENTS 6/9/2000
 THESE RECORD DOCUMENTS HAVE BEEN PREPARED BASED ON INFORMATION PROVIDED BY OTHERS. THE CONSULTANT HAS NOT VERIFIED THE ACCURACY AND/OR COMPLETENESS OF THIS INFORMATION AND SHALL NOT BE RESPONSIBLE FOR ANY ERRORS OR OMISSIONS THAT MAY BE INCORPORATED AS A RESULT OF ERRONEOUS INFORMATION PROVIDED BY OTHERS.

NOTE:
 EXISTING STORM SEWER LOCATIONS AND SIZES OBTAINED FROM RECORD DRAWINGS FROM THE TOWN OF ADDISON. ACTUAL LOCATION IN THE FIELD MAY VARY FROM THE PLANS.