

LANCO ARAPAHO PARTNERSHIP

CHATAHOOCHEE LEASING CORPORATION

MEPC QUORUM PROPERTIES II INC.

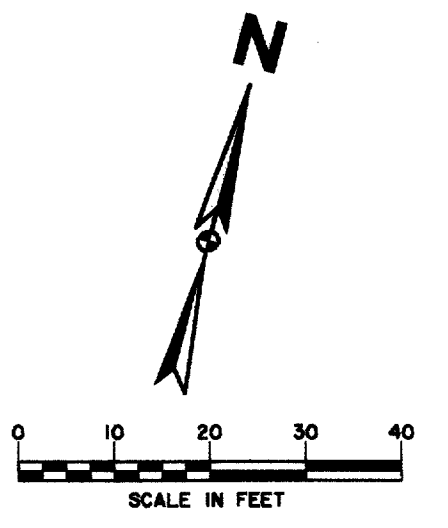

NOTE: VERIFY LOCATION, HORIZONTAL & VERTICAL, OF ALL UTILITIES PRIOR TO CONSTRUCTION OF STORMWATER INLETS & PIPES

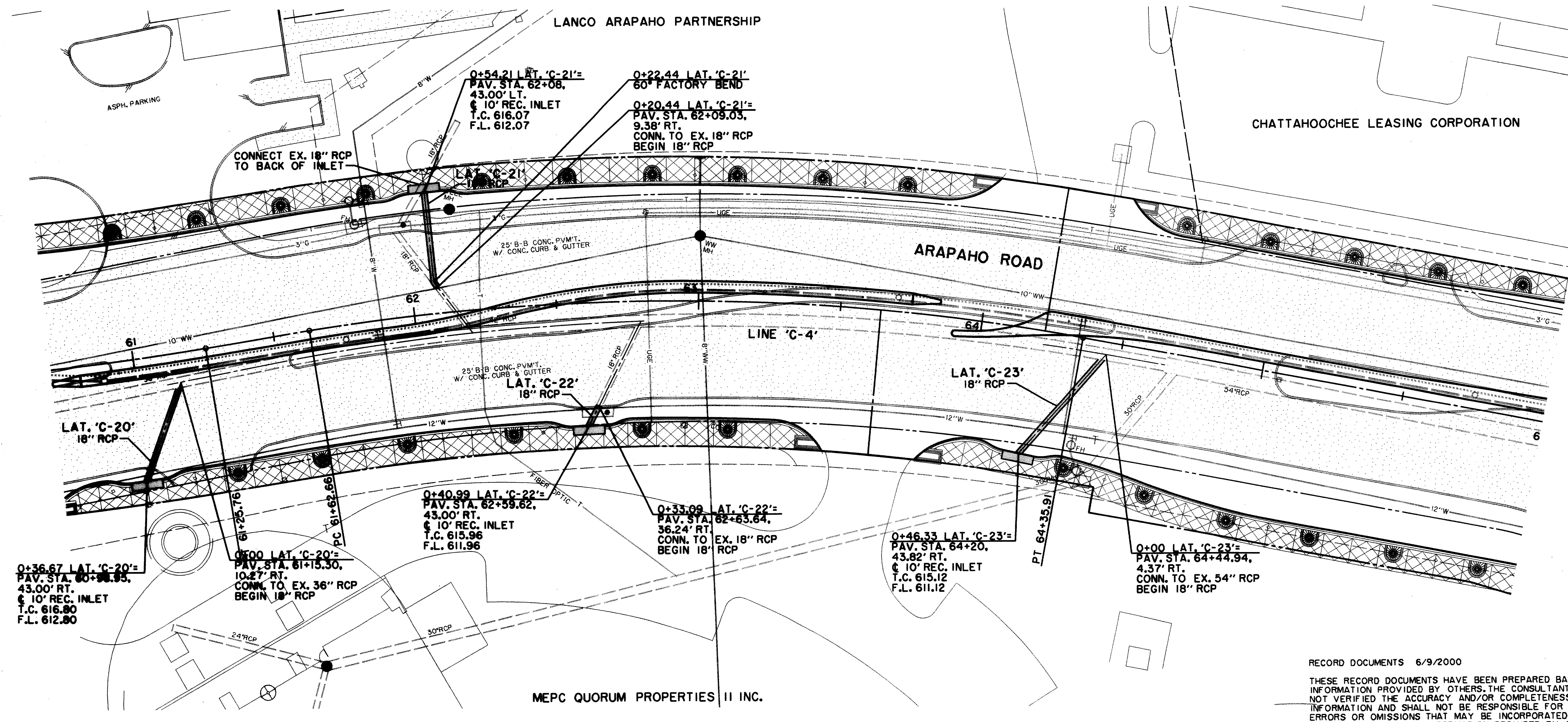

LEGEND

- ELECTRIC — OHE —
- LIGHT POLE
- PP POWER POLE
- GUY WIRE
- TELEPHONE — T —
- TELEPHONE MANHOLE
- TELEPHONE PEDESTAL
- TS TELEPHONE SIGN
- GAS — G —
- GM GAS METER
- GS GAS SIGN
- LAND USE
- RR RAILROAD SIGN
- SIGN
- I.R. FOUND IRON ROD
- TEMP BENCHMARK
- WASTEWATER — WW —
- WASTEWATER MANHOLE
- CO CLEANOUT
- WATER — W —
- FIRE HYDRANT
- WM METER
- T WATER VALVE
- MISC.
- 48\"/>
- CHAIN LINK FENCE
- WOOD FENCE
- EXISTING ASPHALT
- EXISTING DIRT OR GRAVEL
- EX. CONCRETE
- TREE/TREE LINE
- EXISTING CURB
- PROP. CURB
- EX. PROPERTY LINE
- PROP. CENTERLINE
- PROP. R.O.W.
- PROP. INLET
- PVMT TOP OF PAVEMENT
- T.C. TOP OF CURB
- C.R. CURB RETURN

RECORD DOCUMENTS 6/9/2000
THESE RECORD DOCUMENTS HAVE BEEN PREPARED BASED ON INFORMATION PROVIDED BY OTHERS. THE CONSULTANT HAS NOT VERIFIED THE ACCURACY AND/OR COMPLETENESS OF THIS INFORMATION AND SHALL NOT BE RESPONSIBLE FOR ANY ERRORS OR OMISSIONS THAT MAY BE INCORPORATED AS A RESULT OF ERRONEOUS INFORMATION PROVIDED BY OTHERS.

LATERALS NOT PROFILED

BENCHMARKS:
USC & GS E-921 DISK IN BRICK WALL OF OLD ADDISON SCHOOL HOUSE (MAGIC TIME MACHINE RESTAURANT) ON SOUTH WALL, 4' EAST OF CENTER OF THE ENTRANCE, 4.7' ABOVE THE GROUND, ELEV. 650.61

625 "I" ON SOUTHEAST CORNER OF CONCRETE WALK AT FRONT ENTRANCE TO 4805 ARAPAHO ROAD, ELEV. 630.61

620 THE SEAL APPEARING ON THIS DOCUMENT WAS AUTHORIZED BY KENNETH A. ROBERTS, P.E. 55446 ON OCTOBER 24, 1997



STORMWATER PLAN & PROFILE
LINE 'C-4'
ARAPAHO ROAD
ADDISON ROAD TO DALLAS NORTH TOLLWAY
TOWN OF ADDISON, TEXAS
Huitt-Zollars, Inc./Consulting Engineers
Dallas, Fort Worth, Houston, Phoenix, Austin

DESIGN	DRAWN	APPR.	SCALE	DATE	PROJECT NO.	NO.
HZI	HZI	KAR	H: 1"=20' V: 1"=6'	OCT 97	1772-01	ST-13