

NO.	DATE	REVISION	APPROV.
1			
2			
3			

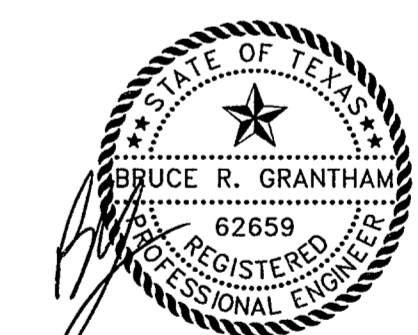
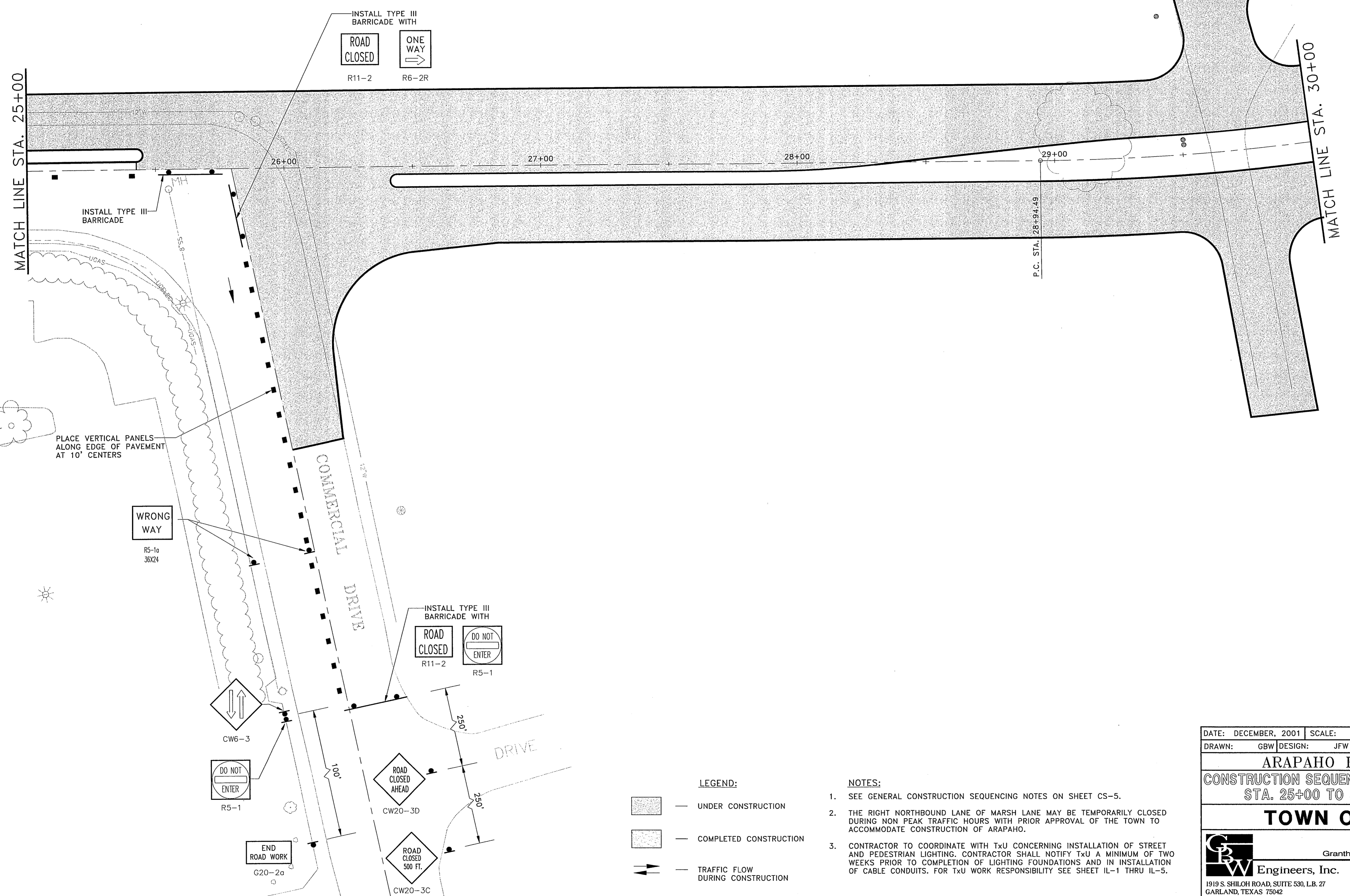
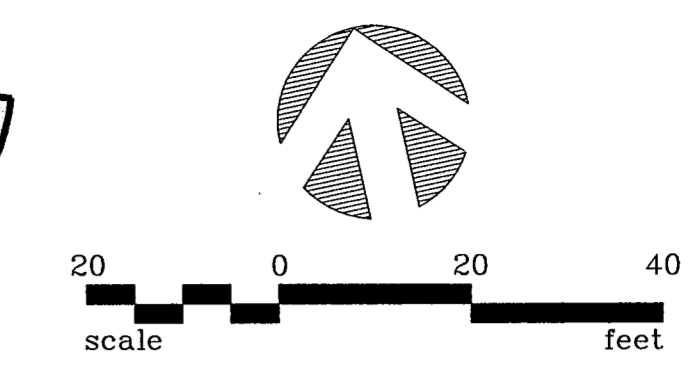

THE SEAL APPEARING ON THIS DOCUMENT WAS AUTHORIZED BY:  
 BRUCE R. GRANTHAM  
 ON 02/14/02  
 ALTERATION OF A SEALED DOCUMENT WITHOUT PROPER NOTIFICATION TO THE RESPONSIBLE ENGINEER IS AN OFFENSE UNDER THE TEXAS ENGINEERING PRACTICE ACT.

17

DATE: DECEMBER, 2001	SCALE: 1" = 20'	JOB NO.: 00-249
DRAWN: GBW	DESIGN: JFW	REVIEWED: BRG
DWG: 249CONST04.DWG		

**ARAPAHO ROAD PHASE II**  
**CONSTRUCTION SEQUENCE/TRAFFIC CONTROL PLAN**  
**STA. 25+00 TO STA. 30+00 (PHASE I)**

**TOWN OF ADDISON**

**Grantham, Burge & Waldbauer**  
**Engineers, Inc.**  
 1919 S. SHILOH ROAD, SUITE 530, L.B. 27  
 GARLAND, TEXAS 75042

SHT. CS-4  
 OF CS-11

- LEGEND:**
- UNDER CONSTRUCTION
  - COMPLETED CONSTRUCTION
  - TRAFFIC FLOW DURING CONSTRUCTION

- NOTES:**
- SEE GENERAL CONSTRUCTION SEQUENCING NOTES ON SHEET CS-5.
  - THE RIGHT NORTHBOUND LANE OF MARSH LANE MAY BE TEMPORARILY CLOSED DURING NON PEAK TRAFFIC HOURS WITH PRIOR APPROVAL OF THE TOWN TO ACCOMMODATE CONSTRUCTION OF ARAPAHO.
  - CONTRACTOR TO COORDINATE WITH TXU CONCERNING INSTALLATION OF STREET AND PEDESTRIAN LIGHTING. CONTRACTOR SHALL NOTIFY TXU A MINIMUM OF TWO WEEKS PRIOR TO COMPLETION OF LIGHTING FOUNDATIONS AND IN INSTALLATION OF CABLE CONDUITS. FOR TXU WORK RESPONSIBILITY SEE SHEET IL-1 THRU IL-5.