

NO.	DATE	REVISION	APPROV.
1	2/06/02	CHANGE NOTE NUMBER	BRG
2			
3			

LEGEND:

- UNDER CONSTRUCTION
- COMPLETED CONSTRUCTION
- TRAFFIC FLOW DURING CONSTRUCTION

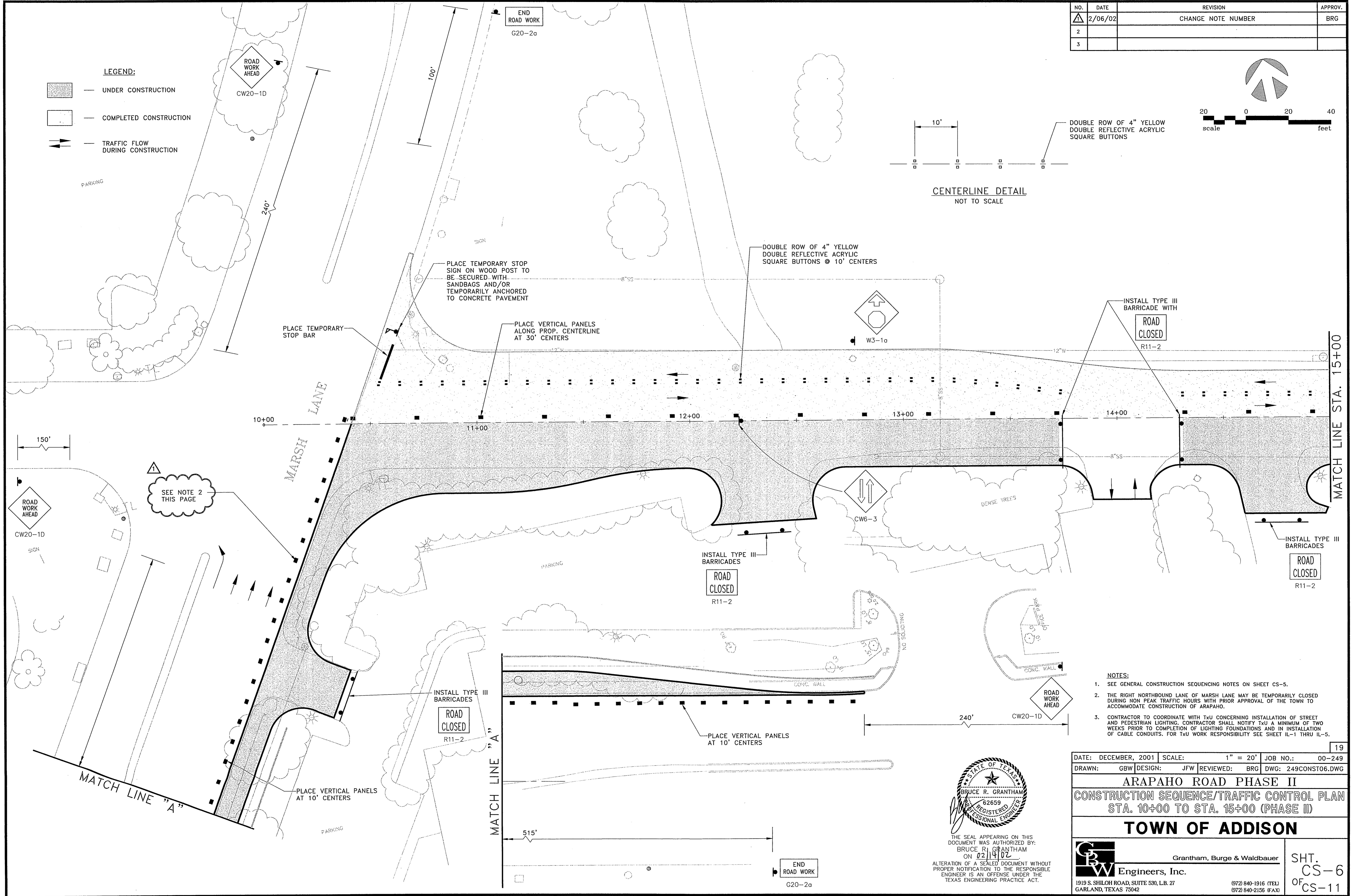
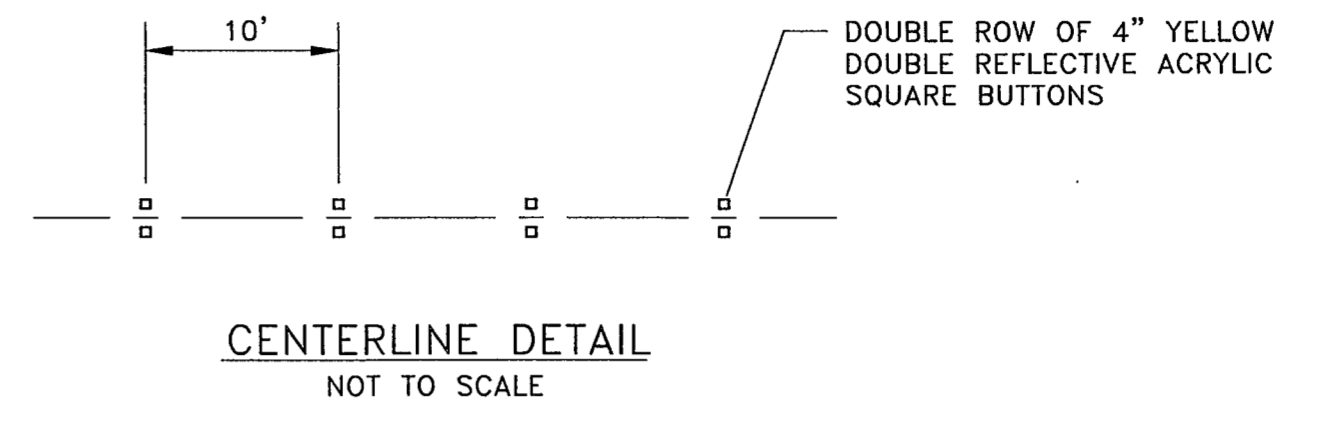
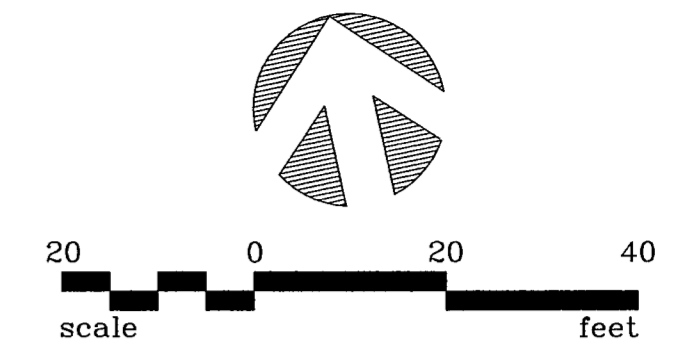

- NOTES:**
- SEE GENERAL CONSTRUCTION SEQUENCING NOTES ON SHEET CS-5.
 - THE RIGHT NORTHBOUND LANE OF MARSH LANE MAY BE TEMPORARILY CLOSED DURING NON PEAK TRAFFIC HOURS WITH PRIOR APPROVAL OF THE TOWN TO ACCOMMODATE CONSTRUCTION OF ARAPAHO.
 - CONTRACTOR TO COORDINATE WITH TXU CONCERNING INSTALLATION OF STREET AND PEDESTRIAN LIGHTING. CONTRACTOR SHALL NOTIFY TXU A MINIMUM OF TWO WEEKS PRIOR TO COMPLETION OF LIGHTING FOUNDATIONS AND IN INSTALLATION OF CABLE CONDUITS. FOR TXU WORK RESPONSIBILITY SEE SHEET IL-1 THRU IL-5.

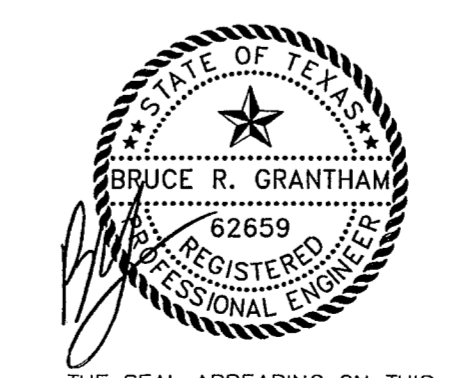

THE SEAL APPEARING ON THIS DOCUMENT WAS AUTHORIZED BY: BRUCE R. GRANTHAM ON 02/14/02. ALTERATION OF A SEALED DOCUMENT WITHOUT PROPER NOTIFICATION TO THE RESPONSIBLE ENGINEER IS AN OFFENSE UNDER THE TEXAS ENGINEERING PRACTICE ACT.

DATE: DECEMBER, 2001	SCALE: 1" = 20'	JOB NO.: 00-249
DRAWN: GBW	DESIGN: JFW	REVIEWED: BRG
DWG: 249CONST06.DWG		

**ARAPAHO ROAD PHASE II
CONSTRUCTION SEQUENCE/TRAFFIC CONTROL PLAN
STA. 10+00 TO STA. 15+00 (PHASE II)**

TOWN OF ADDISON

Grantham, Burge & Waldbauer
Engineers, Inc.
1919 S. SHILOH ROAD, SUITE 530, L.B. 27 GARLAND, TEXAS 75042
(972) 840-1916 (TEL)
(972) 840-2156 (FAX)

SHT. CS-6 OF CS-11