

| NO. | DATE | REVISION | APPROV. |
|-----|------|----------|---------|
| 1 | | | |
| 2 | | | |
| 3 | | | |

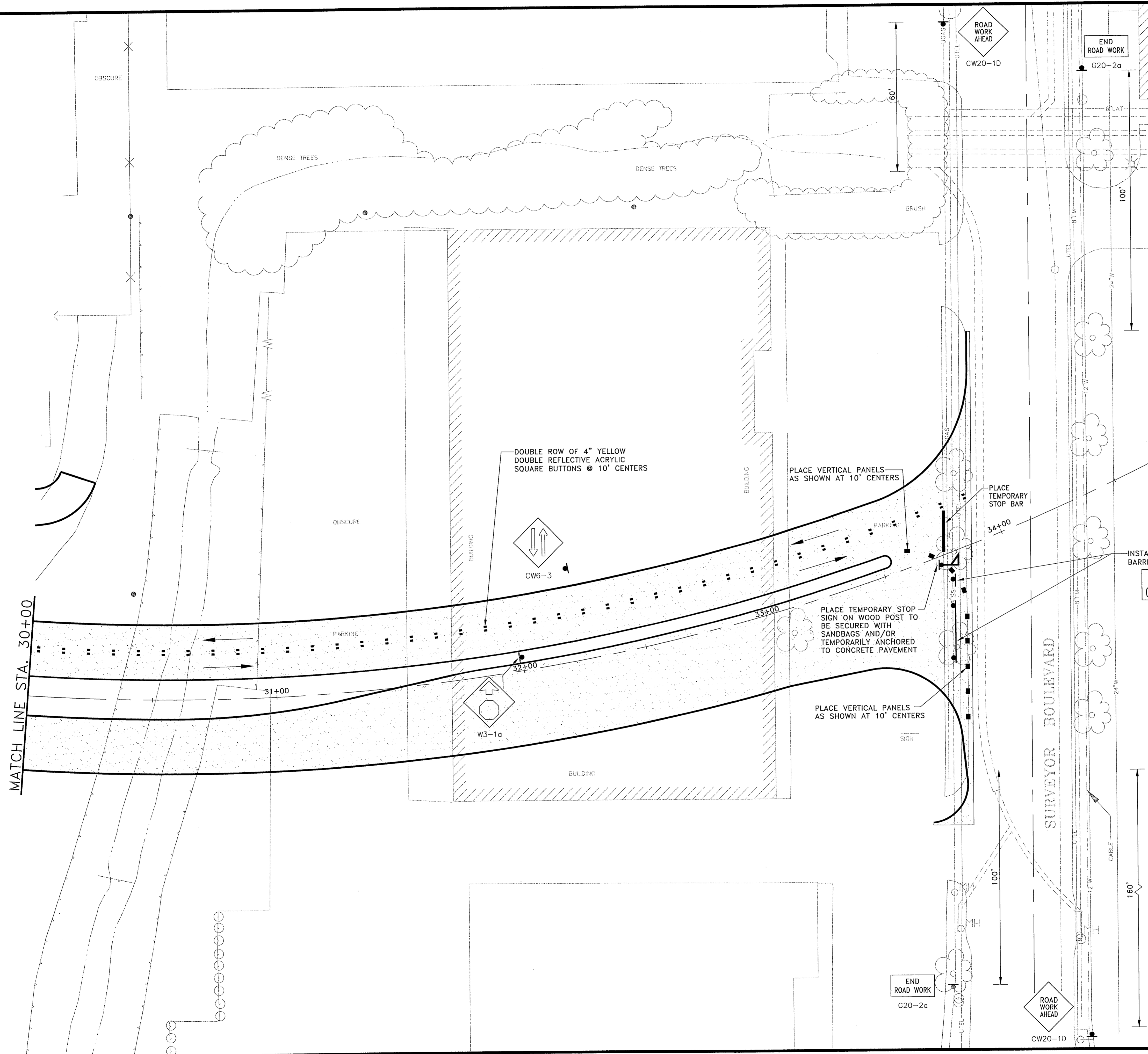

- LEGEND:**
- UNDER CONSTRUCTION
 - COMPLETED CONSTRUCTION
 - TRAFFIC FLOW DURING CONSTRUCTION

- NOTES:**
- SEE GENERAL CONSTRUCTION SEQUENCING NOTES ON SHEET CS-5.
 - THE RIGHT NORTHBOUND LANE OF MARSH LANE MAY BE TEMPORARILY CLOSED DURING NON PEAK TRAFFIC HOURS WITH PRIOR APPROVAL OF THE TOWN TO ACCOMMODATE CONSTRUCTION OF ARAPAHO.
 - CONTRACTOR TO COORDINATE WITH TXU CONCERNING INSTALLATION OF STREET AND PEDESTRIAN LIGHTING. CONTRACTOR SHALL NOTIFY TXU A MINIMUM OF TWO WEEKS PRIOR TO COMPLETION OF LIGHTING FOUNDATIONS AND IN INSTALLATION OF CABLE CONDUITS. FOR TXU WORK RESPONSIBILITY SEE SHEET IL-1 THRU IL-5.

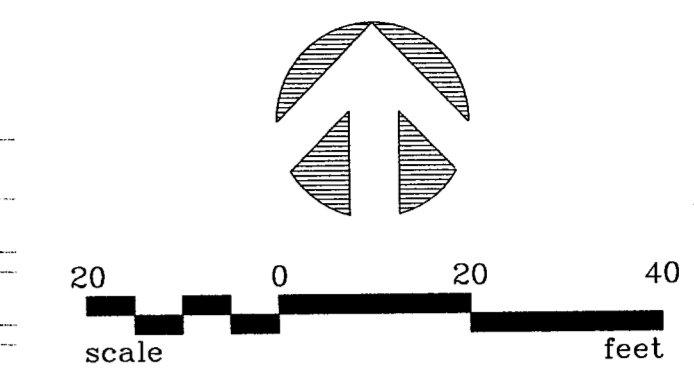

THE SEAL APPEARING ON THIS DOCUMENT WAS AUTHORIZED BY:
 BRUCE R. GRANTHAM
 ON 02/14/02
 ALTERATION OF A SEALED DOCUMENT WITHOUT PROPER NOTIFICATION TO THE RESPONSIBLE ENGINEER IS AN OFFENSE UNDER THE TEXAS ENGINEERING PRACTICE ACT.

| | | |
|---|-----------------|--|
| DATE: DECEMBER, 2001 | SCALE: 1" = 20' | JOB NO.: 00-249 |
| DRAWN: GBW | DESIGN: JFW | REVIEWED: BRG |
| ARAPAHO ROAD PHASE II | | |
| CONSTRUCTION SEQUENCE/TRAFFIC CONTROL PLAN | | |
| STA. 30+00 TO END (PHASE II) | | |
| TOWN OF ADDISON | | |
| Grantham, Burge & Waldbauer Engineers, Inc. 1919 S. SHILOH ROAD, SUITE 530, L.B. 27 GARLAND, TEXAS 75042 | | (972) 840-1916 (TEL) (972) 840-2156 (FAX) |
| SHT. CS-10 OF CS-11 | | 23 |