

LEGEND:

- 4" SCH 40 PVC CONDUIT, BORED UNDER RAILROAD TRACK
- STREET LIGHTING STANDARD, SEE NOTE 1
- PEDESTRIAN LIGHTING STANDARD
- COMBINATION STREET LIGHT STANDARD AND PEDESTRIAN LUMINAIRE
- CONDUIT, 2" SCH 40 PVC W/2#6, 1#6 GND (ROADWAY CIRCUIT)
- CONDUIT, 2" SCH 40 PVC W/2#6, 1#6 GND (PEDESTRIAN CIRCUIT)
- GROUND MOUNTED PULLBOX, TYPE A
- LIGHTING CONTROL CENTER

NOTES:

1. CONTRACTOR TO INSTALL POLE FOUNDATIONS, CONDUIT, CIRCUIT CONDUCTORS AND STREET LIGHTING STANDARDS.
2. SEE SPECIFICATIONS FOR TOWN OF ADDISON LIGHTING DETAILS.
3. CABLE TO PROVIDE POWER TO PEDESTAL VOICE COMMUNICATION UNIT SHALL SHARE PEDESTRIAN LIGHT POLE CONDUIT TO POWER SOURCE AT STA 85+70±. CONTRACTOR SHALL PROVIDE CABLE SIZE THAT IS ADEQUATE FOR LENGTH OF RUN. CABLE SHALL BE SUBSIDIARY TO ITEM PEDESTAL VOICE COMMUNICATION UNIT.

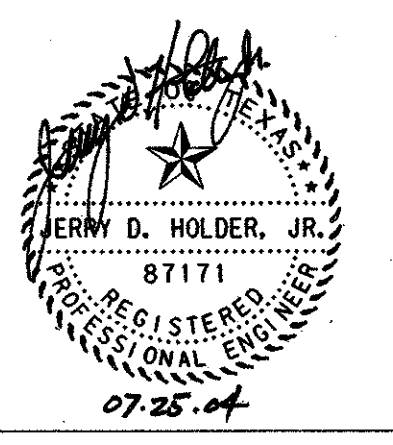

PARK B NOTES:

4. CONTRACTOR SHALL PLACE CONDUIT AND PULL BOXES ALONG BRICK PAVERS AS PART OF BASE BID.
5. AS AN ALTERNATE BID, CONTRACTOR SHALL REMOVE PULL BOXES AND REPLACE WITH PEDESTRIAN LIGHT POLE, 2#6, 1#6GND CABLES SHALL BE RUN THROUGH CONDUIT. REMOVAL OF PULL BOXES IS SUBSIDIARY TO ITEM ALTERNATE BID PEDESTRIAN LIGHT POLE FOUNDATION.

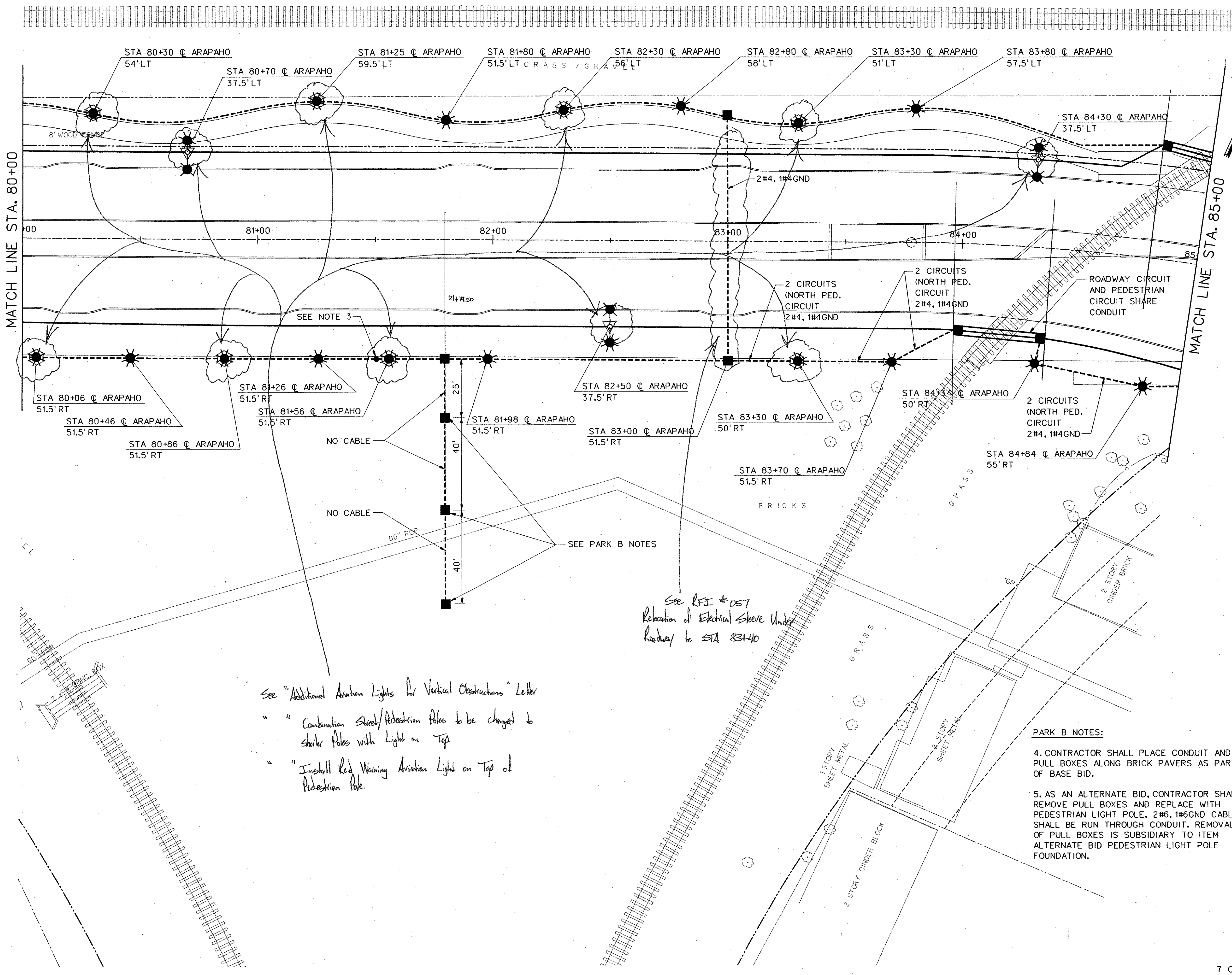

See "Additional Aviation Lights for Vertical Obstructions" Letter
 "Combination Street/Pedestrian Poles to be changed to street poles with light on top"
 "Install Red Warning Aviation Light on top of Pedestrian Pole."

See RFI #057
 Relocation of Electrical Sleeve Under Roadway to STA 83+40

29-JUN-2004 13:02 G:\25768-ph3\m\cds\31107.dgn

				159	
NO.	DATE	REVISION	APPROV.		
HNTB ARCHITECTS ENGINEERS PLANNERS The HNTB Companies					
ARAPAHO ROAD - PHASE III					
SURVEYOR BOULEVARD TO ADDISON ROAD					
ILLUMINATION PLAN					
STA 80+00 TO STA 85+00					
TOWN OF ADDISON, TEXAS					
Design JSN	Drawn GFS	DATE	SCALE	PROJECT NO.	SHEET NO.
Check JQH	Check JSN	APRIL 04	1" = 20'	25768	1L-7