

LAYOUT COORDINATE TABLE

11	N 10148.49 E 7172.22	16	N 9971.16 E 7015.20	21	N 9938.98 E 7149.37
12	N 10136.26 E 7180.90	17	N 9936.45 E 7025.60	22	N 9938.98 E 7167.70
13	N 10125.53 E 7179.20	18	N 9963.05 E 7098.36	23	N 10019.49 E 7166.91
14	N 10108.18 E 7154.84	19	N 9938.98 E 7098.36		
15	N 9985.51 E 7004.65	20	N 9938.98 E 7116.69		

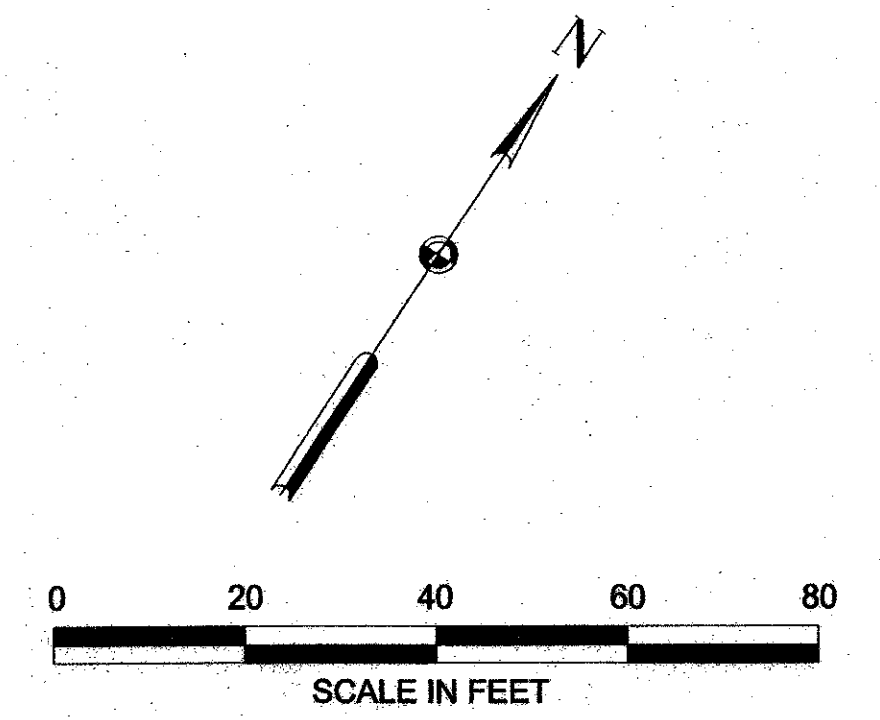

MATCH LINE STA. 37+00

MATCH LINE STA. 40+00

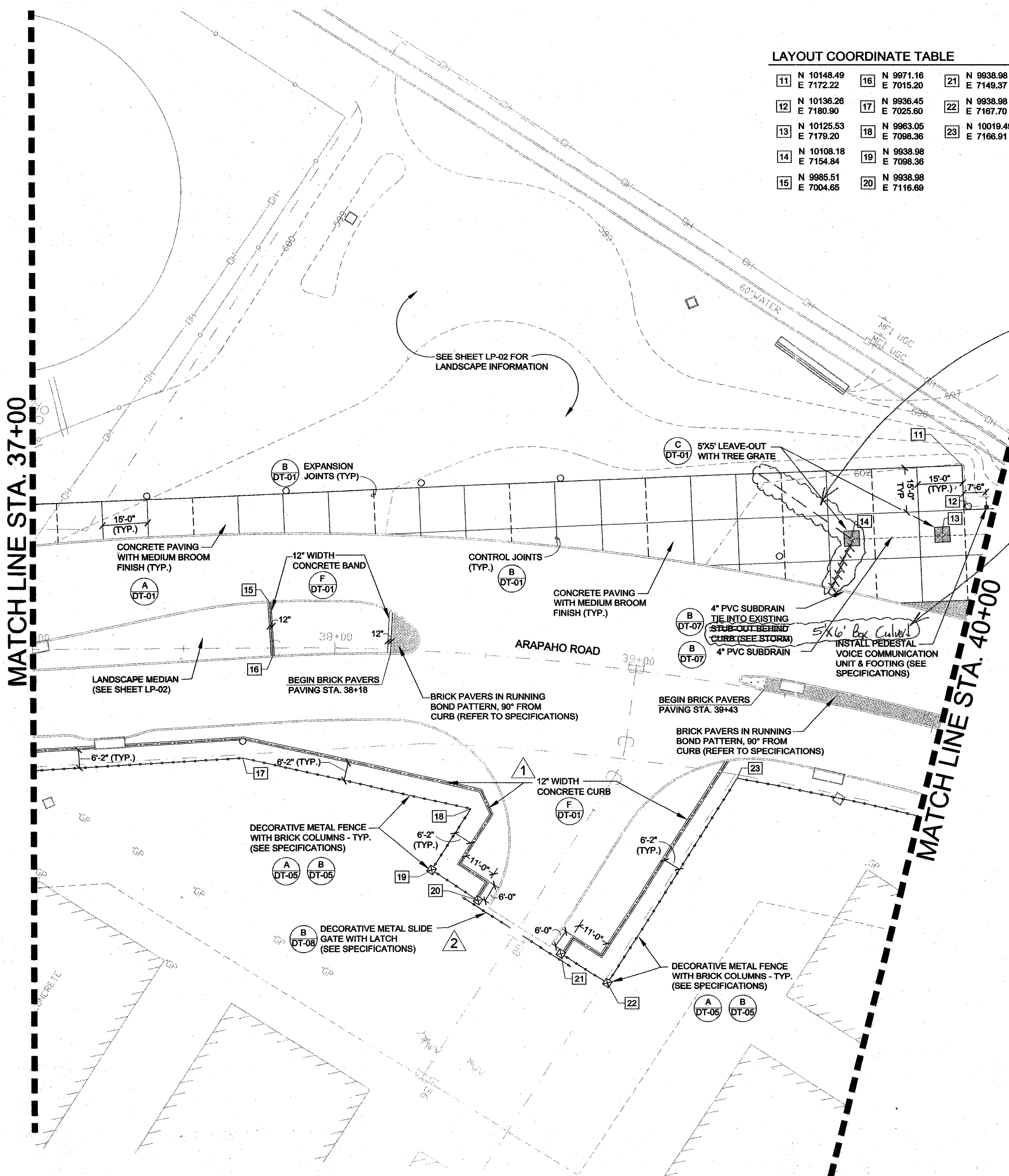

See RFI #043
Run 4" PVC Subdrain System in Trench into the 5'x6' Culvert. (Material B-2) Install 4" Pipe at Minimum of 1% Slope and connect to Box in the Upper 2' of the sidewalk.

GENERAL NOTES:

- WRITTEN DIMENSIONS AND COORDINATE DATA SHALL GOVERN OVER SCALED DIMENSIONS.
- SEE THE SURVEY CONTROL PLAN SHEETS WITHIN THIS SET FOR COORDINATE CONTROL POINT INFORMATION.
- ALL IMPROVEMENTS SHALL BE STAKED IN THE FIELD BY THE CONTRACTOR AND APPROVED BY THE LANDSCAPE ARCHITECT AND OWNER'S REP. PRIOR TO CONSTRUCTION OR INSTALLATION.
- THE CONTRACTOR SHALL VERIFY ALL EASEMENT LINES IN THE FIELD PRIOR TO BEGINNING WORK.
- CONTRACTOR SHALL VERIFY ALL UTILITIES SHOWN ON THESE PLANS AS WELL AS ANY OTHERS IN FIELD PRIOR TO START OF CONSTRUCTION.
- ALL CONSTRUCTION WILL CONFORM TO THE TOWN OF ADDISON STANDARDS AND SPECIFICATIONS, AS WELL AS, ANY GOVERNING TXDOT OR RAILROAD STANDARDS AND SPECIFICATIONS RELATED TO THIS PROJECT.
- ALL DIMENSIONS ARE TO BACK OF CURB OR EDGE OF PAVEMENT UNLESS OTHERWISE NOTED.
- REINFORCEMENT SHOULD BE CONTINUOUS THROUGH CONTROL JOINTS.
- THE CONTRACTOR WILL COORDINATE INSTALLATION OF ALL SIGNS, PAVEMENT MARKINGS AND OTHER TRAFFIC CONTROL DEVICES BY THE CITY DURING CONSTRUCTION
- ALL PROPOSED GRADES INDICATED ARE FINISHED GRADES.
- ALL LAND FORMS, SWALES, AND GRADES SHALL BE FINISHED TO BE A SMOOTH, FLOWING, ROUNDED SURFACE PROVIDING POSITIVE DRAINAGE AND VISUAL LANDFORM CONTINUITY.
- GRADING FOR THE IMPROVEMENTS SHALL OCCUR AS DIRECTED BY LANDSCAPE ARCHITECT WITH THE FOLLOWING GUIDELINES:
 - ALL WALKS SHALL HAVE A CROSS SLOPE OF 2% IN THE DIRECTION OF THE DOWNHILL SIDE.
 - THE LONGITUDINAL SLOPE OF THE WALKS SHALL NOT EXCEED 5%.
- NO EARTHEN SLOPES SHALL BE GREATER THAN 3:1.

LEGEND:

- BRICK PAVERS IN RUNNING BOND PATTERN (SEE SPECIFICATIONS)
- EXPANSION JOINTS
- CONTROL JOINTS
- 2'x10'x18" CONCRETE BENCH
- 2'x10' CONCRETE STRIP
- TREE GRATE
- EXISTING CONTOURS
- DECORATIVE METAL FENCE

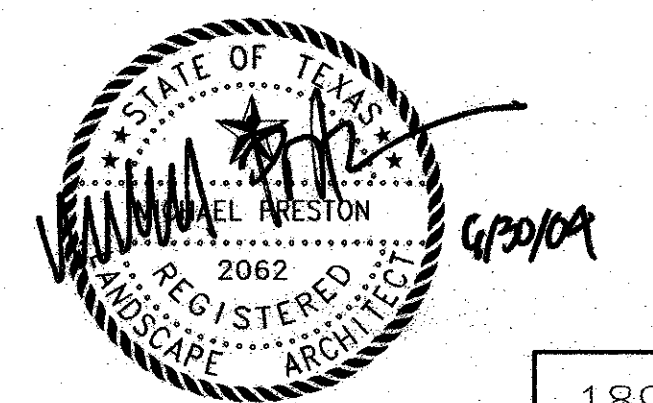

				189	
NO.	DATE	REVISION	APPROV.		
6/2/04		REPLACEMENT OF SWING GATE WITH SLIDING GATE			
5/27/04		ADDITION OF 12" CONC. CURB FOR SCREEN PLANTING			
HNTB ARCHITECTS ENGINEERS PLANNERS The HNTB Companies					
ARAPAHO ROAD EXTENSION					
SURVEYOR BOULEVARD TO ADDISON ROAD					
STA 37+00 TO 40+00					
SITWORK LAYOUT & DIMENSIONING PLAN					
TOWN OF ADDISON, TEXAS					
Design	DAB	Drawn	DAB	DATE	SCALE
Check	MP	Check	MP	6/3/04	VARIES
PROJECT NO.	25768	SHEET NO.	LA-02		