

DISCLAIMER: The use of this standard is governed by the "Texas Engineering Practice Act". No warranty of any kind is made by TxDOT for any purpose whatsoever. TxDOT assumes no responsibility for the conversion of this standard to other formats or for incorrect results or damages resulting from its use.

ACC:	LEVELS DISPLAYED
	1 2
(LW)-1, 2 for English	
	63

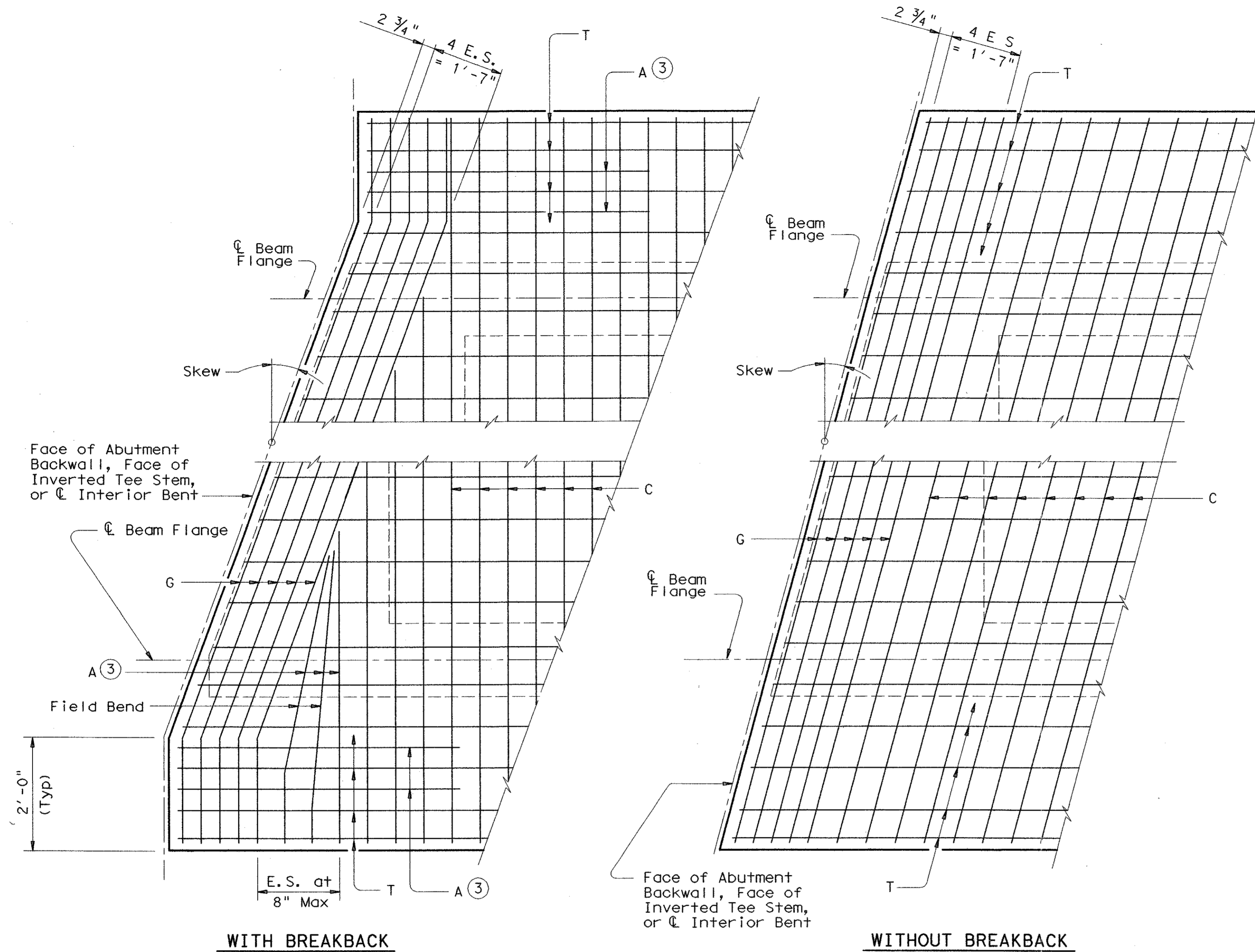

WITH BREAKBACK

WITHOUT BREAKBACK

**TOP SLAB CORNER REINFORCING AT EXPANSION JOINT**

(See PCP(U) for bottom slab reinforcing)

③ Length of Bars A = 5'-0"

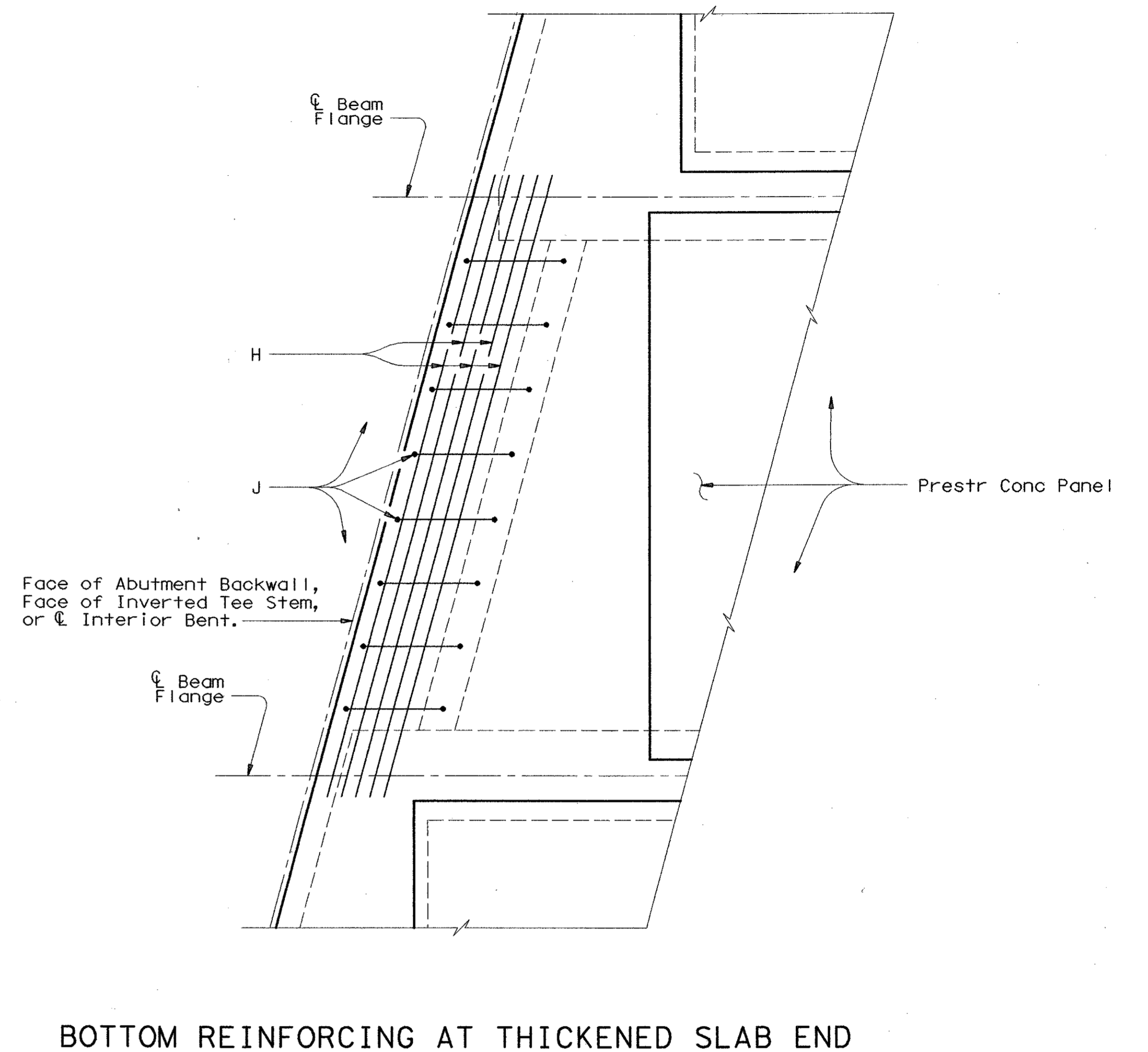

**BOTTOM REINFORCING AT THICKENED SLAB END**

Showing parallel beams. For non-parallel beams, equally flare Bars J between the edges of the beams.

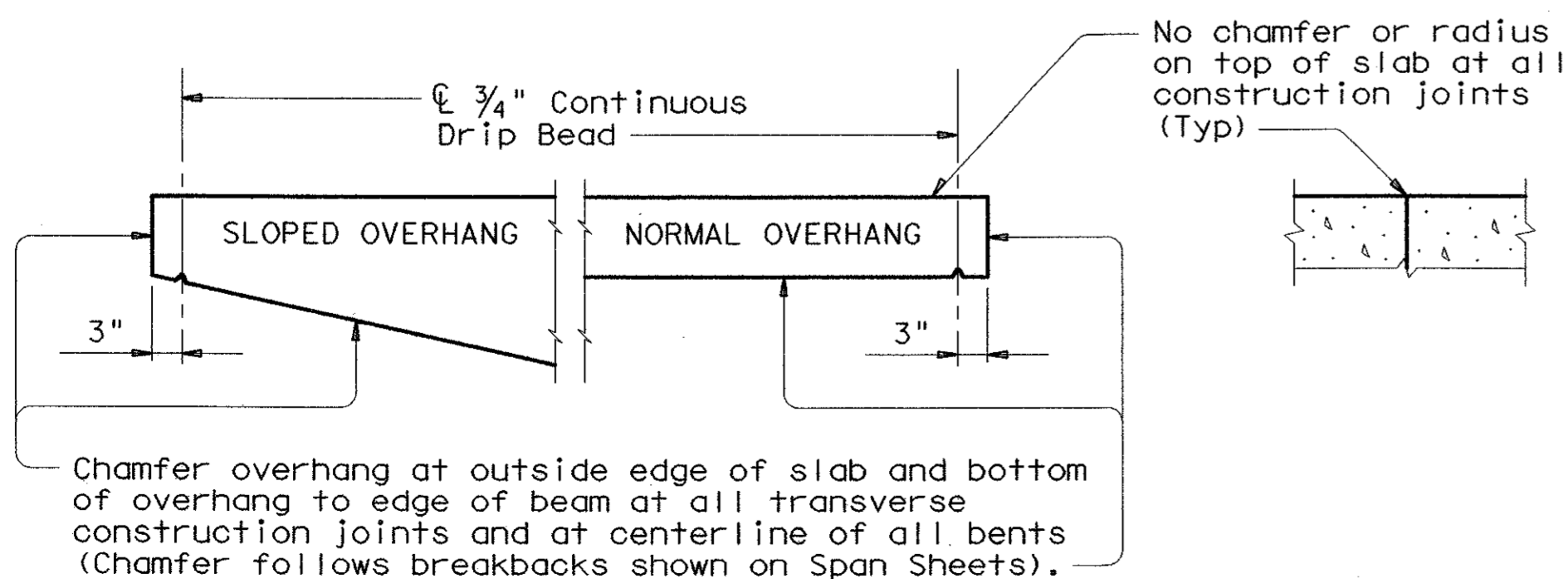

**CHAMFER AND DRIP BEAD DETAIL**

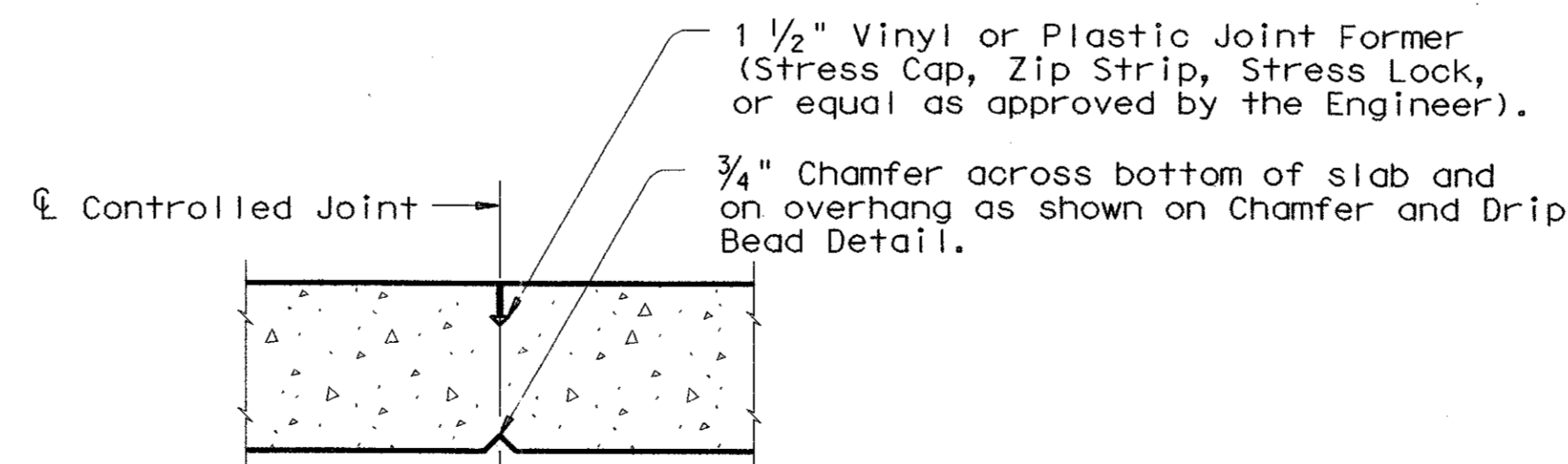

**CONTROLLED JOINT DETAIL**

(Joint Former shall be placed in accordance with manufacturer's recommendations and shall be subsidiary to the Item, "Reinforced Concrete Slab.")

Note: For continuous placement, the minimum rate of concrete placing and finishing shall not be less than 30 linear feet of bridge deck per hour.

HS20 LOADING SHEET 2 OF 3 315

Texas Department of Transportation  
Design Division (Bridge)

**MISCELLANEOUS  
SLAB DETAILS  
(FOR PRESTR CONC U-BEAMS)**

**UBMS**

FILE: ubstd003.dgn	DN: TxDOT	CK: TGA	DW: BWH	CK: TGA	STD: B541
© TxDOT March 1998	DIST	FED REG	FEDERAL AID PROJECT	•	SHEET
REVISIONS	6	COUNTY	CONTROL SECT	JOB	BS-7