

NO.	DATE	REVISION	APPROV.
1			
2			
3			

NOTE:
1. SEE SHEET ST-7 FOR DETAILS OF LANE LINES AND TURN LANE STRIPING.

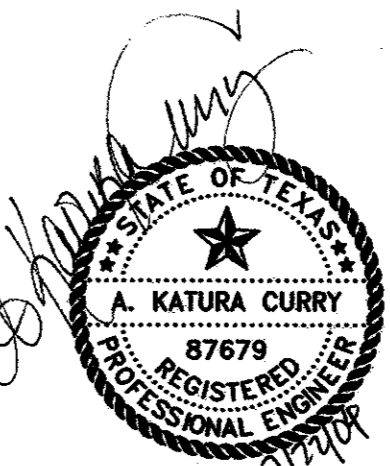
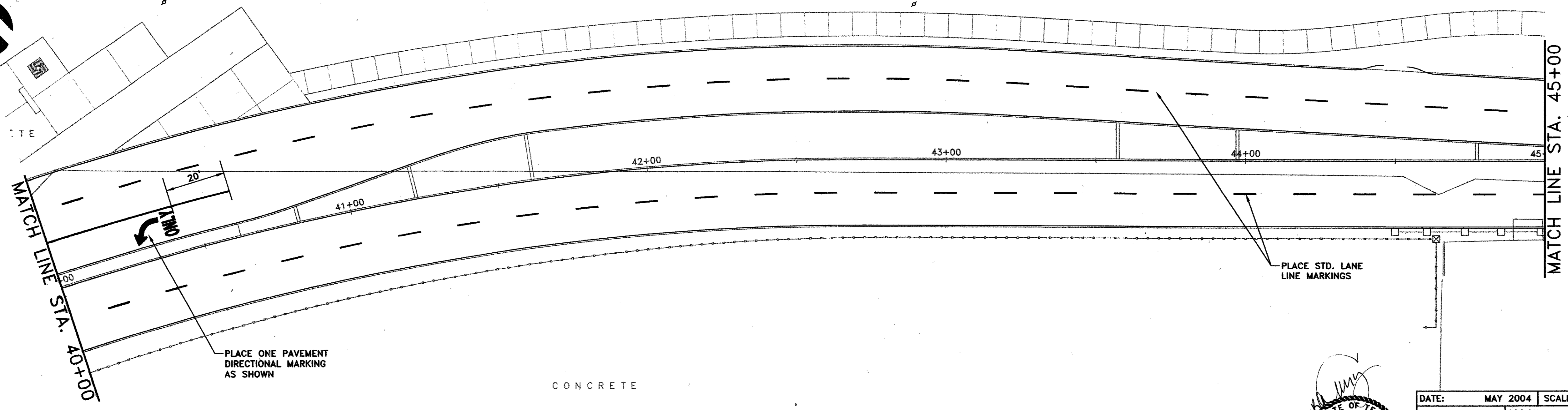
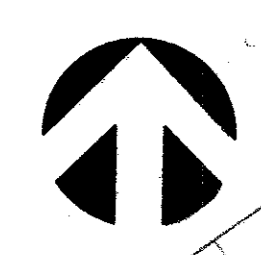
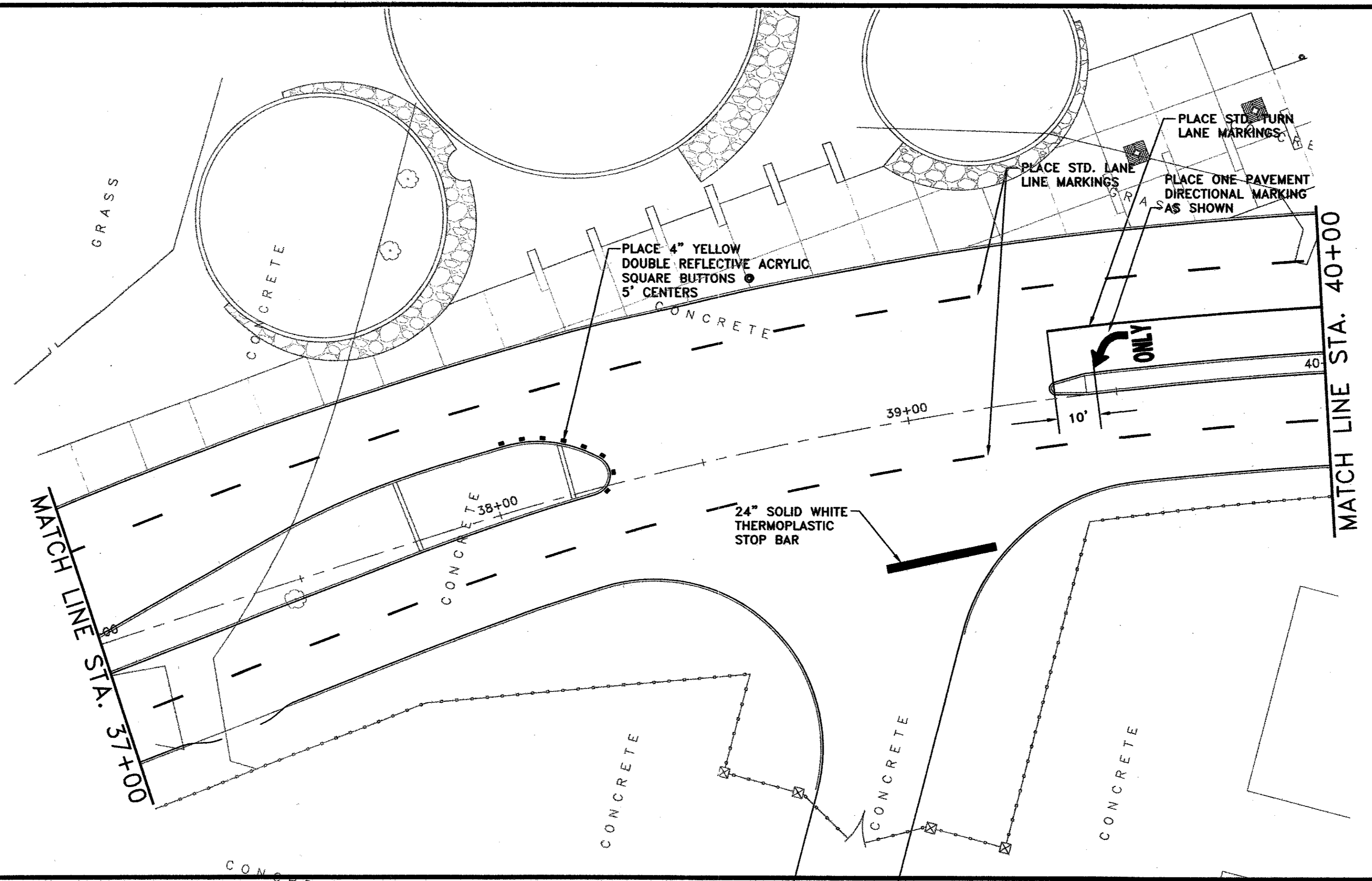
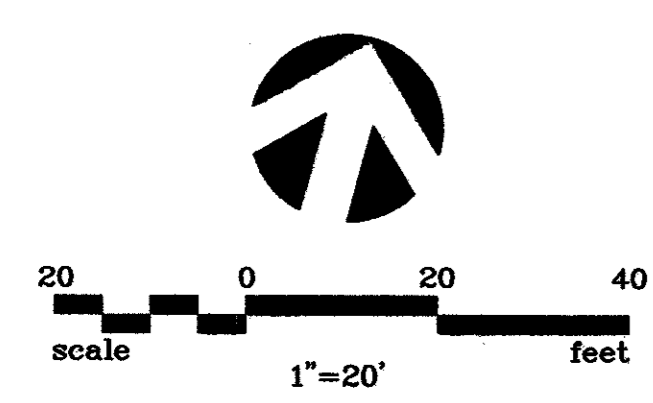

THE SEAL APPEARING ON THIS DOCUMENT WAS AUTHORIZED BY:
A. KATURA CURRY
ON 7-21-04.
ALTERATION OF A SEALED DOCUMENT WITHOUT PROPER NOTIFICATION TO THE RESPONSIBLE ENGINEER IS AN OFFENSE UNDER THE TEXAS ENGINEERING PRACTICE ACT.

DATE:	MAY 2004	SCALE:	1"=20'	JOB NO.:	02-320
DRAWN:	G&A	DESIGN:	AKC	REVIEWED:	DWG: 320STRPE01.DWG

**ARAPAHO ROAD PHASE III
STRIPING PLAN
STA. 37+00 TO STA. 45+00**

TOWN OF ADDISON

g&a Grantham & Associates, Inc.
1919 S. SHILOH ROAD, SUITE 310, L.B. 8
GARLAND, TEXAS 75042

SHT. ST-2