

NO.	DATE	REVISION	APPROV.
1			
2	07/21/04	REVISED PER G & A	A.K.C.
3			

DALLAS AREA RAPID TRANSIT
PROPERTY ACQUISITION CORPORATION

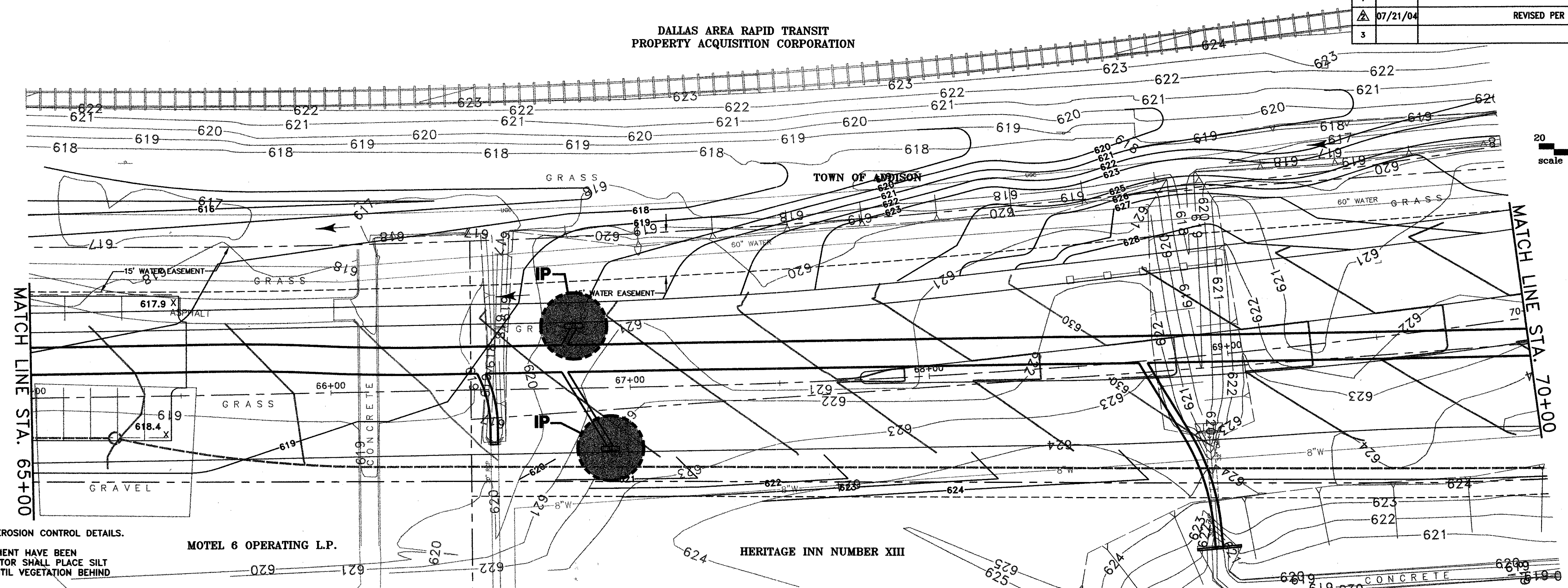
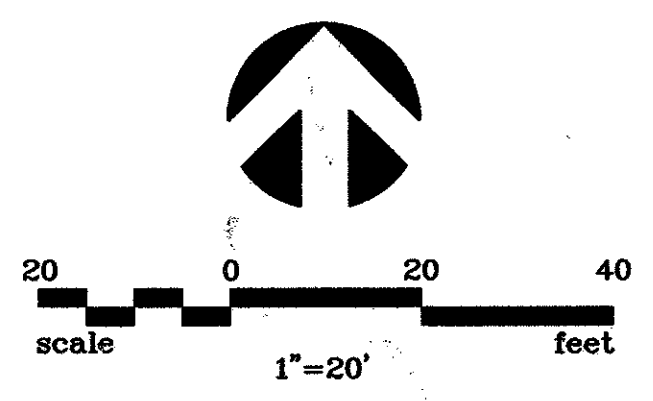

- NOTES:
- SEE SHEET EC-7 FOR EROSION CONTROL DETAILS.
 - AFTER CURB AND PAVEMENT HAVE BEEN CONSTRUCTED, CONTRACTOR SHALL PLACE SILT FENCE BEHIND CURB UNTIL VEGETATION BEHIND CURB HAS STABILIZED.

MOTEL 6 OPERATING L.P.

HERITAGE INN NUMBER XIII

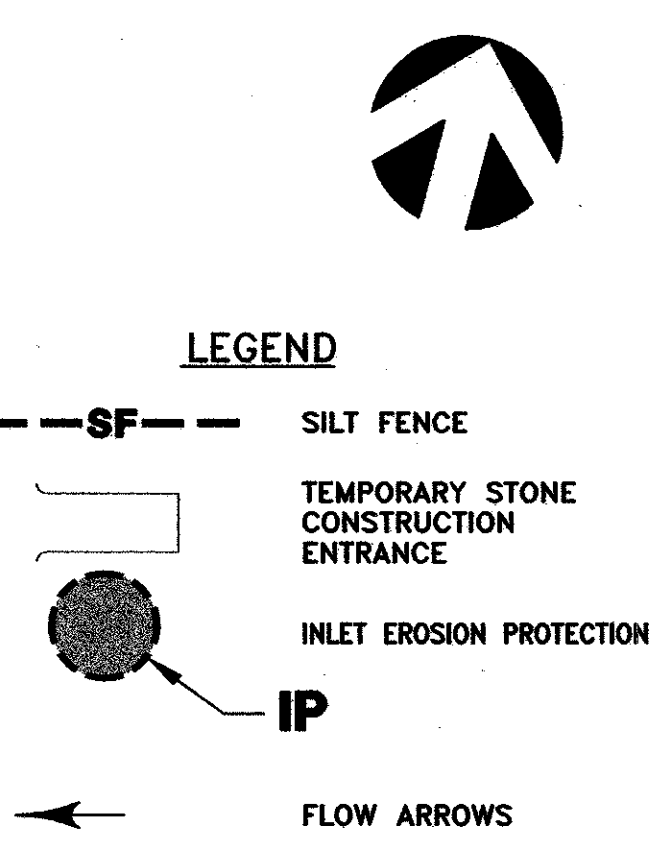
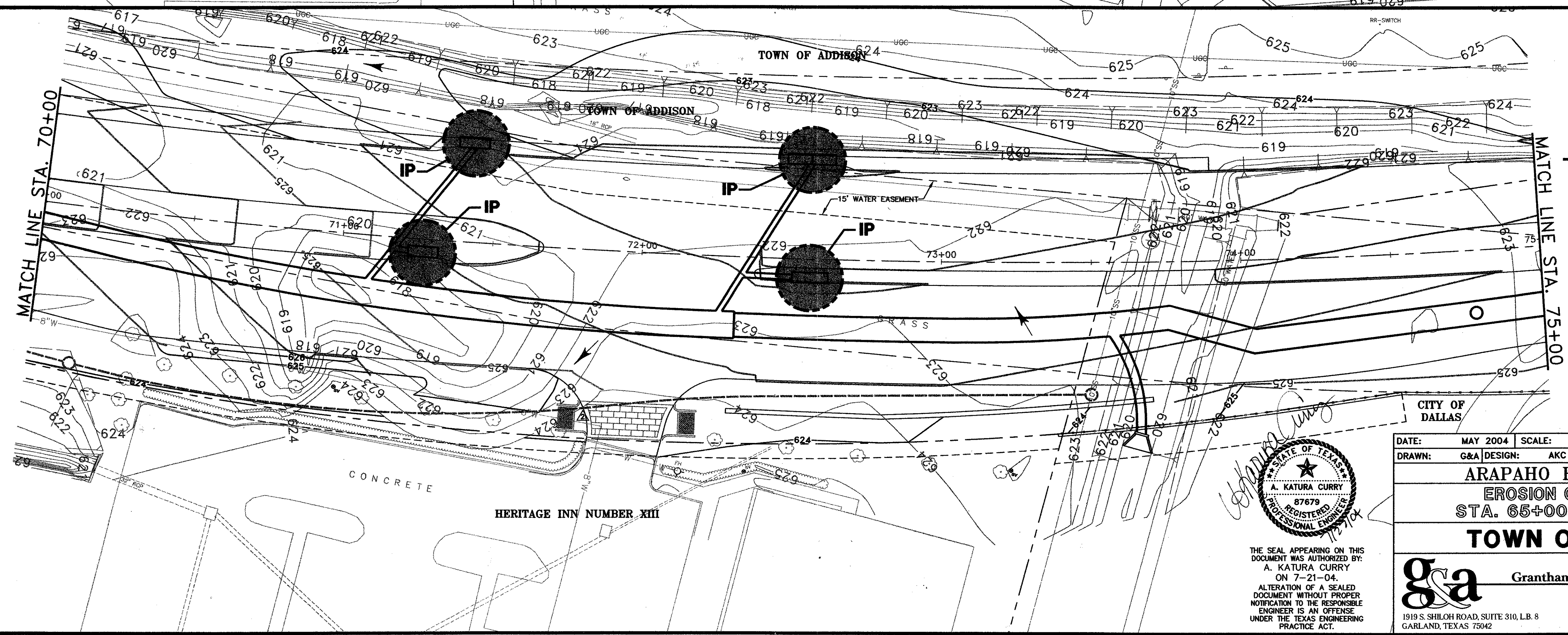

DATE:	MAY 2004	SCALE:	1"=20'	JOB NO.:	02-320
DRAWN:	G&A	DESIGN:	AKC	REVIEWED:	DWG-320EROSION01.DWG

ARAPAHO ROAD PHASE III
EROSION CONTROL PLAN
STA. 65+00 TO STA. 75+00
TOWN OF ADDISON

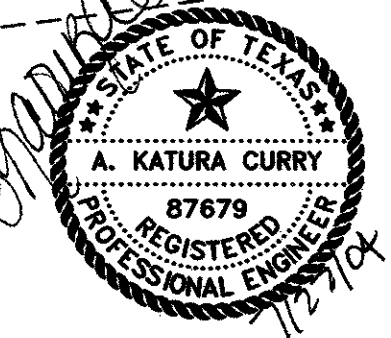

THE SEAL APPEARING ON THIS DOCUMENT WAS AUTHORIZED BY:
A. KATURA CURRY
ON 7-21-04.
ALTERATION OF A SEALED DOCUMENT WITHOUT PROPER NOTIFICATION TO THE RESPONSIBLE ENGINEER IS AN OFFENSE UNDER THE TEXAS ENGINEERING PRACTICE ACT.

g&a Grantham & Associates, Inc. SHT. EC-5

1919 S. SHILOH ROAD, SUITE 310, L.B. 8 GARLAND, TEXAS 75042 (972) 864-2333 (TEL) (972) 864-2334 (FAX)