

LAT. 'A-6' CURVE DATA

NUMBER	RADIUS	DELTA	ARC LENGTH	CHORD BEARING	CHORD LENGTH
C1	40.00	30°00'00"	20.94	S 16°00'30" E	20.71

LAT. 'A-7' CURVE DATA

NUMBER	RADIUS	DELTA	ARC LENGTH	CHORD BEARING	CHORD LENGTH
C1	65.00'	41°05'33"	46.62'	S 25°27'43" E	45.63'

LINE 'A' CURVE DATA

NUMBER	RADIUS	DELTA	ARC LENGTH	CHORD BEARING	CHORD LENGTH
C7	550.00'	03°51'49"	37.09'	S 89°04'36" E	37.08'
C8	550.00'	03°51'49"	37.09'	S 89°04'36" E	37.08'

**DALLAS AREA RAPID TRANSIT
PROPERTY ACQUISITION CORPORATION**

NO.	DATE	REVISION	APPROV.
1	06/28/04	REVISED PER G & A	A.K.C.
2	9/01/04	ADDED GRATE INLET	A.K.C.

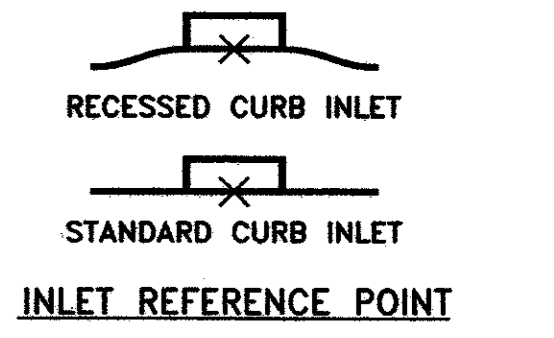
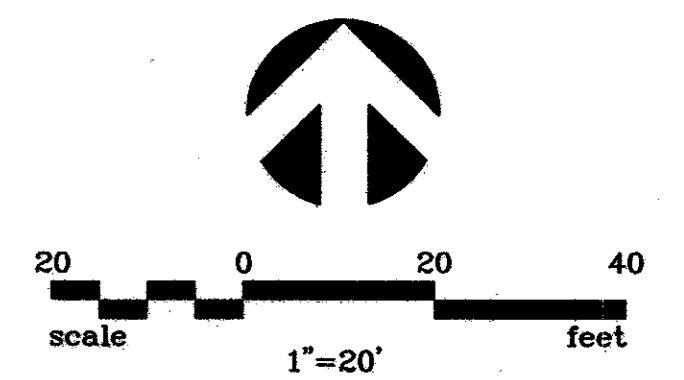

NOTE
REFER TO SW-1 FOR
STORM SEWER NOTES

THE SEAL APPEARING ON THIS DOCUMENT WAS AUTHORIZED BY:
A. KATURA CURRY
ON 9-3-04.
ALTERATION OF A SEALED DOCUMENT WITHOUT PROPER NOTIFICATION TO THE RESPONSIBLE ENGINEER IS AN OFFENSE UNDER THE TEXAS ENGINEERING PRACTICE ACT.

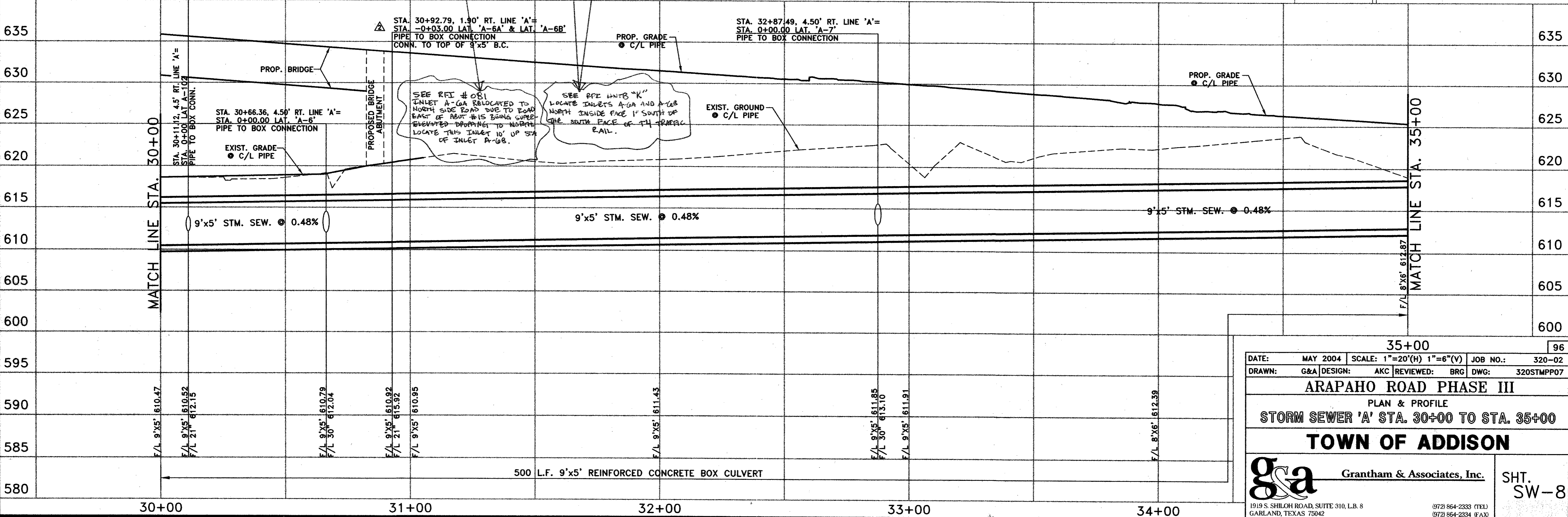
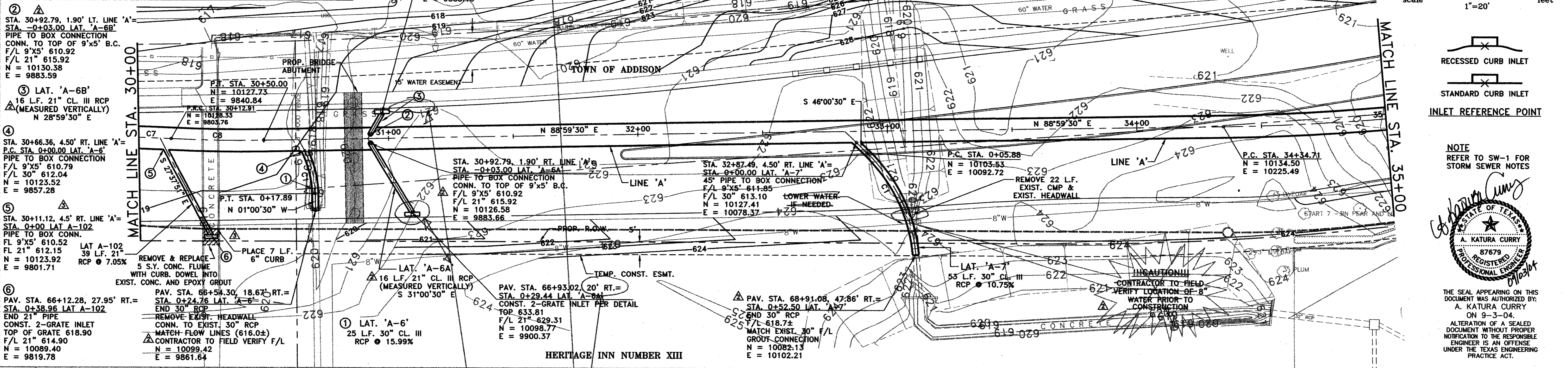

DATE:	MAY 2004	SCALE:	1"=20'(H) 1"=6'(V)	JOB NO.:	320-02
DRAWN:	G&A	DESIGN:	AKC	REVIEWED:	BRG
ARAPAHO ROAD PHASE III					
PLAN & PROFILE					
STORM SEWER 'A' STA. 30+00 TO STA. 35+00					
TOWN OF ADDISON					
g&a			Grantham & Associates, Inc.		
1919 S. SHILOH ROAD, SUITE 310, L.B. 8 GARLAND, TEXAS 75042			(972) 864-2333 (TEL) (972) 864-2334 (FAX)		

SHT. SW-8