

LINE TABLE			
LINE	BEARING	DIST	
L1	S 89°58'49"E	162.80'	
L2	S 00°08'05" W	78.95	
L3	N 89°58'49" W	162.76'	
L4	N 00°06'08" E	78.95'	

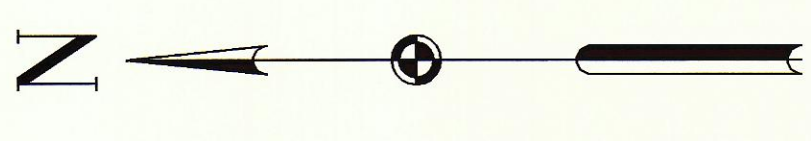

SCALE:  
1 INCH=20 FEET

**LEGEND**

PROPOSED  
ARAPAHO ROAD

PROPOSED  
PARCEL

PROPOSED ROW  
EXISTING ROW

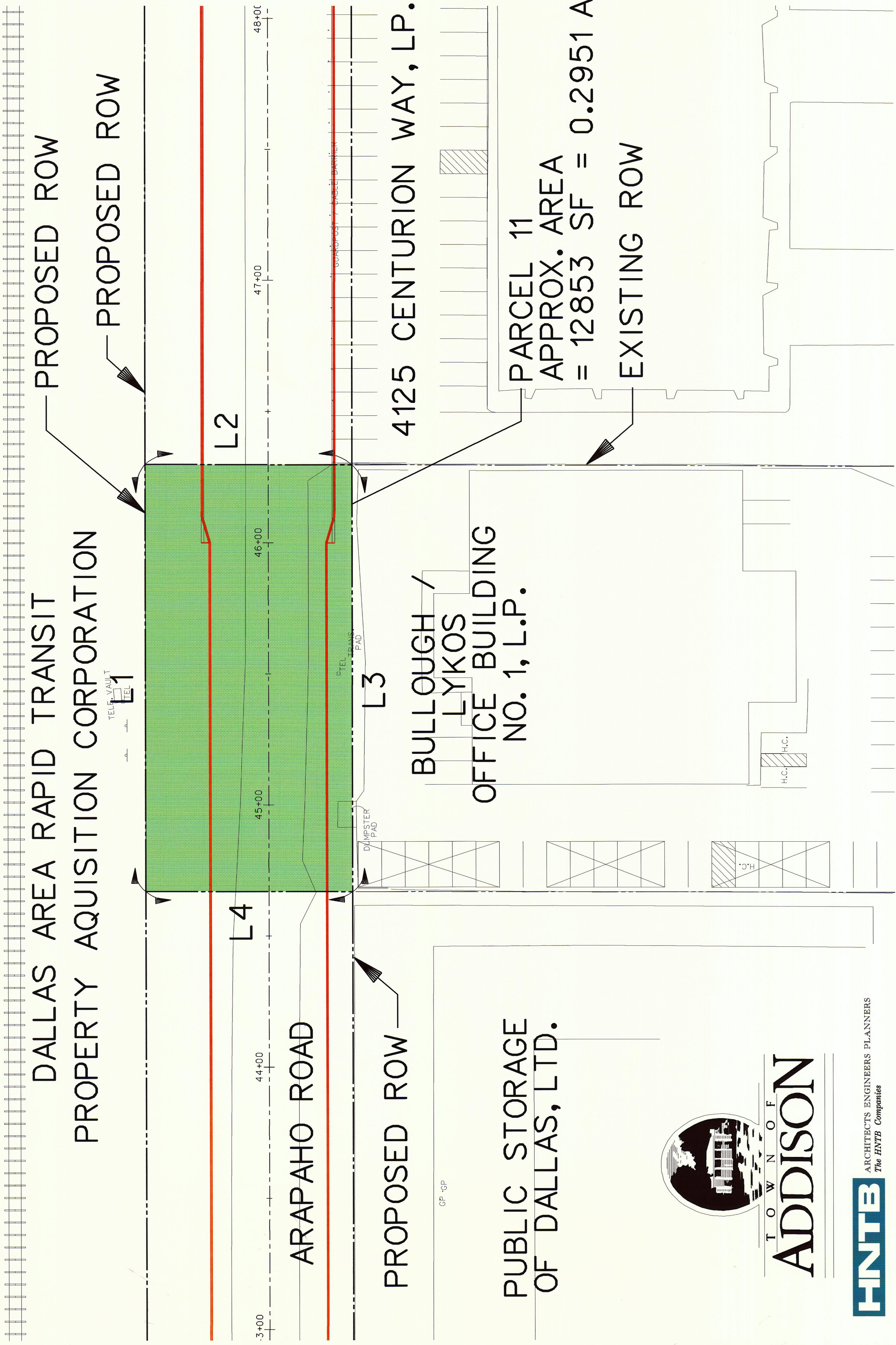

PARCEL 11  
R.O.W. EXHIBIT  
OCTOBER 2002

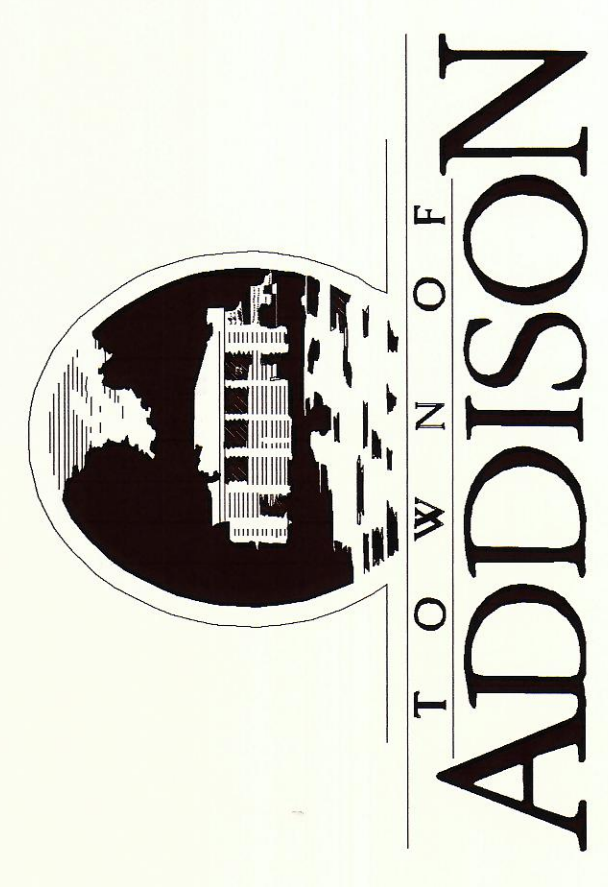

**HNTB**  
ARCHITECTS ENGINEERS PLANNERS  
The HNTB Companies