

GENERAL NOTES:

WRITTEN DIMENSIONS AND COORDINATE DATA SHALL GOVERN OVER SCALED DIMENSIONS.

SEE THE SURVEY CONTROL PLAN SHEETS WITHIN THIS SET FOR COORDINATE CONTROL POINT INFORMATION.

ALL IMPROVEMENTS SHALL BE STAKED IN THE FIELD BY THE CONTRACTOR AND APPROVED BY THE LANDSCAPE ARCHITECT AND OWNERS REP. PRIOR TO CONSTRUCTION OR INSTALLATION.

THE CONTRACTOR SHALL VERIFY ALL EASEMENT LINES IN THE FIELD PRIOR TO BEGINNING WORK.

CONTRACTOR SHALL VERIFY ALL UTILITIES SHOWN ON THESE PLANS AS WELL AS ANY OTHERS IN FIELD PRIOR TO START OF CONSTRUCTION.

ALL CONSTRUCTION WILL CONFORM TO THE TOWN OF ADDISON STANDARDS AND SPECIFICATIONS, AS WELL AS ANY GOVERNING TxDOT OR RAILROAD STANDARDS AND SPECIFICATIONS RELATED TO THIS PROJECT.

ALL DIMENSIONS ARE TO BACK OF CURB OR EDGE OF PAVEMENT UNLESS OTHERWISE NOTED.

REINFORCEMENT SHOULD BE CONTINUOUS THROUGH CONTROL JOINTS.

THE CONTRACTOR WILL COORDINATE INSTALLATION OF ALL SIGNS, CITY DURING CONSTRUCTION.

ALL PROPOSED GRADES INDICATED ARE FINISHED GRADES.

ALL LAND FORMS, SWALES, AND GRADES SHALL BE FINISHED TO BE A SMOOTH, FLOWING, ROUNDED SURFACE PROVIDING POSITIVE DRAINAGE AND VISUAL LANDFORM CONTINUITY.

GRADING FOR THE IMPROVEMENTS SHALL OCCUR AS DIRECTED BY LANDSCAPE ARCHITECT WITH THE FOLLOWING GUIDELINES:

- ALL WALKS SHALL HAVE A CROSS SLOPE OF 2% IN THE DIRECTION OF THE DOWNHILL SIDE.

- THE LONGITUDINAL SLOPE OF THE WALKS SHALL NOT EXCEED 5%.

- NO EARTHEN SLOPES SHALL BE GREATER THAN 3:1.

**LEGEND:**

|  |   |
|--|---|
|  | BRICK PAVERS IN RUNNING BOND PATTERN (SEE SPECIFICATIONS) |
|  | STONE PAVING (SEE SPECIFICATIONS)                         |
|  | EXPANSION JOINTS  |
|  | CONTROL JOINTS  |
|  | 2'x10'x18" CONCRETE BENCH                                 |
|  | 2'x10'x22" CONCRETE BENCH                                 |
|  | 2'x10" CONCRETE STRIP                                     |
|  | EXISTING CONTOURS   |
|  | PROPOSED CONTOURS   |

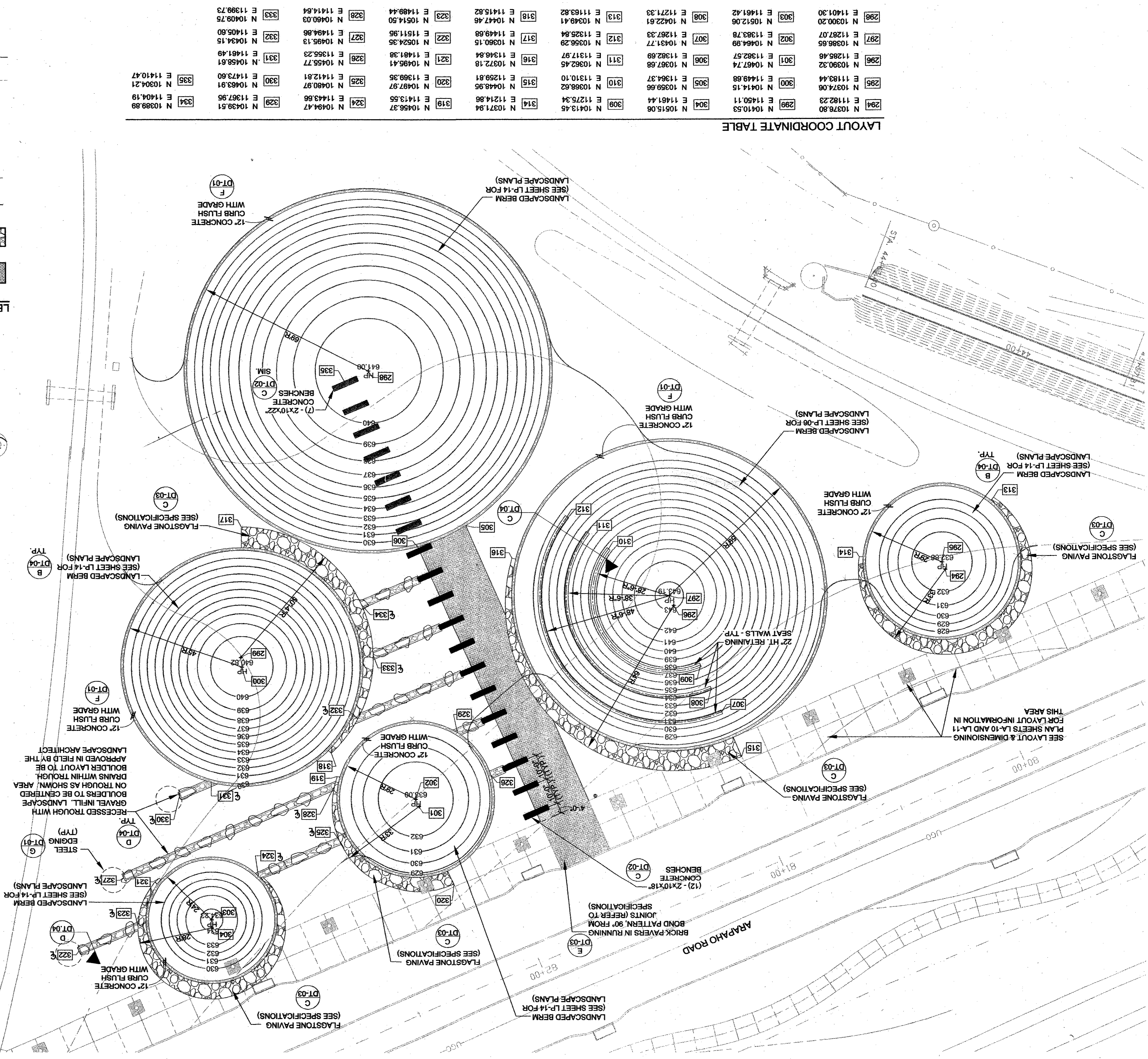

**LAYOUT COORDINATE TABLE**

|     |            |           |     |            |           |     |            |            |     |            |           |     |            |            |     |            |           |     |            |           |     |            |           |     |            |            |     |            |           |     |            |           |     |            |           |
|-----|------------|-----------|-----|------------|-----------|-----|------------|------------|-----|------------|-----------|-----|------------|------------|-----|------------|-----------|-----|------------|-----------|-----|------------|-----------|-----|------------|------------|-----|------------|-----------|-----|------------|-----------|-----|------------|-----------|
| 294 | N 10378.80 | E 1182.23 | 295 | N 10274.06 | E 1183.44 | 300 | N 10414.15 | E 1149.68  | 305 | N 10389.66 | E 1132.57 | 310 | N 10362.45 | E 1131.10  | 315 | N 10348.95 | E 1129.81 | 320 | N 10497.97 | E 1143.55 | 325 | N 10480.97 | E 1142.81 | 330 | N 10463.91 | E 1142.60  | 335 | N 10409.75 | E 1139.73 |     |            |           |     |            |           |
| 296 | N 10390.22 | E 1128.46 | 297 | N 10386.65 | E 1127.07 | 301 | N 10467.74 | E 1138.25  | 306 | N 10387.68 | E 1132.69 | 311 | N 10362.45 | E 1131.97  | 316 | N 10372.18 | E 1134.84 | 321 | N 10495.41 | E 1148.38 | 326 | N 10455.77 | E 1135.23 | 331 | N 10458.61 | E 11461.49 | 336 | N 10494.86 | E 1149.86 | 341 | N 10460.03 | E 1144.64 | 346 | N 10456.37 | E 1148.44 |
| 298 | N 10410.53 | E 1145.01 | 299 | N 10414.15 | E 1149.68 | 302 | N 10464.99 | E 1138.78  | 307 | N 10431.77 | E 1128.33 | 312 | N 10356.84 | E 1132.84  | 317 | N 10360.15 | E 1149.68 | 322 | N 10524.35 | E 1151.95 | 327 | N 10494.86 | E 1149.86 | 332 | N 10494.86 | E 1149.86  | 337 | N 10494.86 | E 1149.86 | 342 | N 10494.86 | E 1149.86 | 347 | N 10494.86 | E 1149.86 |
| 299 | N 10410.53 | E 1145.01 | 300 | N 10414.15 | E 1149.68 | 303 | N 10461.42 | E 11461.42 | 308 | N 10422.61 | E 1127.33 | 313 | N 10349.41 | E 11163.82 | 318 | N 10447.46 | E 1145.82 | 323 | N 10514.50 | E 1148.44 | 328 | N 10460.03 | E 1144.64 | 333 | N 10460.03 | E 1144.64  | 338 | N 10460.03 | E 1144.64 | 343 | N 10460.03 | E 1144.64 |     |            |           |

VOTED