

CAUTION!!!
LONE STAR GAS LINE IN AREA
CONTACT LONE STAR GAS 48 HOURS
PRIOR TO CONSTRUCTION

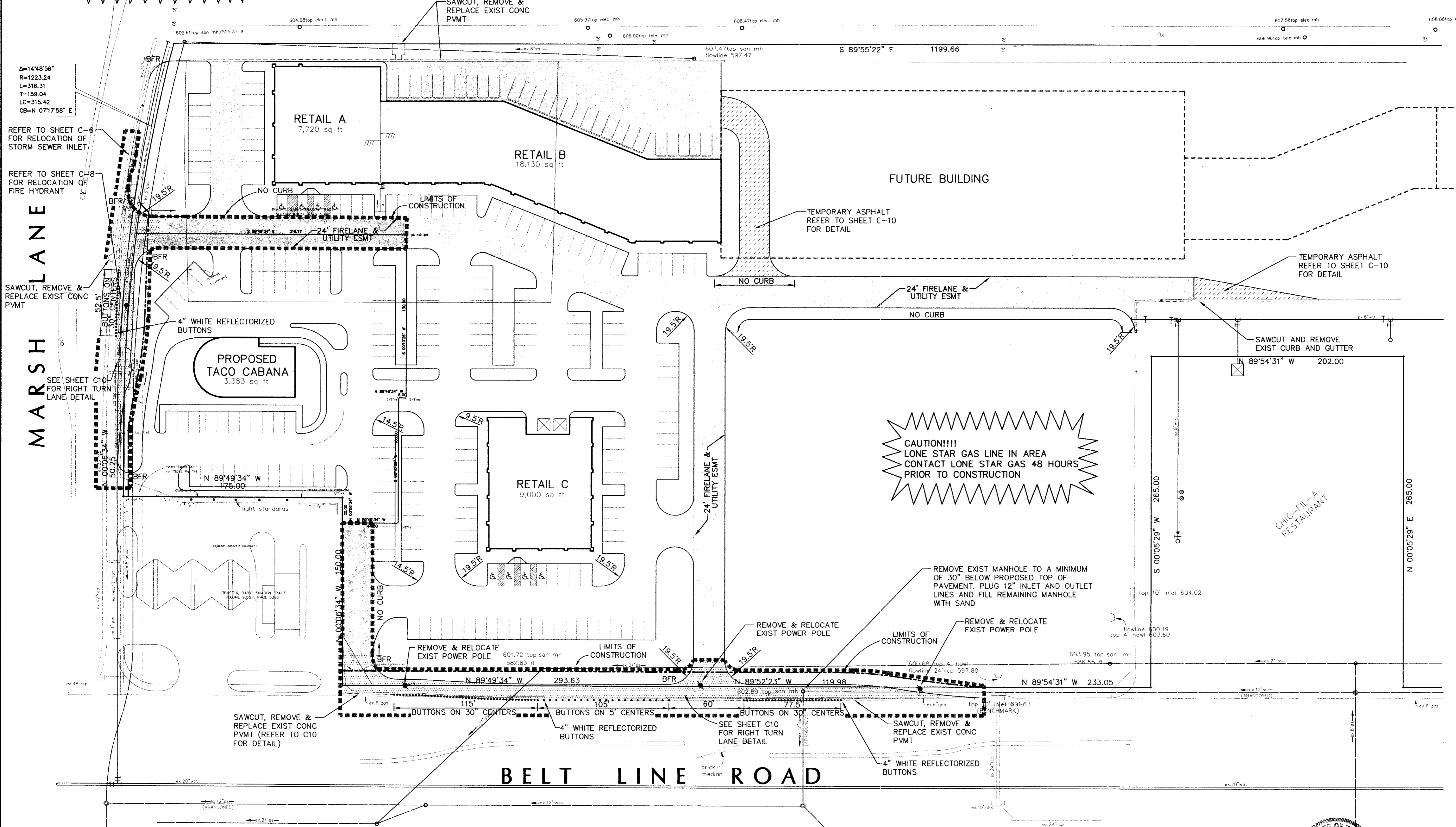

CAUTION!!!
LONE STAR GAS LINE IN AREA
CONTACT LONE STAR GAS 48 HOURS
PRIOR TO CONSTRUCTION

General Notes

- All materials and construction shall conform to the Town of Addison's standards and specifications.
- It will be the responsibility of the contractor to protect all public utilities in the construction of this project. All manholes, clean-outs, valve boxes, fire hydrants, etc. must be adjusted to proper line and grade by the Contractor prior to and after the placing of permanent paving. Utilities must be maintained to proper line and grade during construction of this project.
- The Contractor will be responsible for coordinating with all the appropriate utility companies for the location of all utilities within the construction area.
- The Paving Contractor shall coordinate with the Utility Contractor to insure all sleeving for irrigation has been installed prior to placement of permanent pavement.
- All dimensions are to back of curb unless otherwise noted.
- All curb return radii are 1.5' unless otherwise noted.
- All construction debris shall be legally disposed of offsite.
- All paving shall conform to the recommendations in the Geotechnical Report (HBC Engineering, Report #42-1749-97).

LEGEND

- 5" 3000 psi CONCRETE PAVEMENT
W/ #3 @ 18" OCEW ON
6" LIME TREATED SUBGRADE
- 6" 3500 psi CONCRETE PAVEMENT
W/ #3 @ 18" OCEW ON
6" LIME TREATED SUBGRADE
- 8" 3600 psi CONCRETE PAVEMENT
W/ #4 @ 18" OCEW ON
6" CEMENT TREATED SUBGRADE (7% PORTLAND)
(SEE SHEET C10)
- TEMPORARY ASPHALT
(SEE DETAIL SHEET C-10)
- BFR BARRIER FREE RAMP
(PER TOWN OF ADDISON STD'S)

BENCHMARK:
TOP CURB EXISTING 10' INLET ±100' WEST
OF CHIC-FIL-A RESTAURANT NORTH SIDE OF
BELT LINE ROAD.
ELEV. 601.63

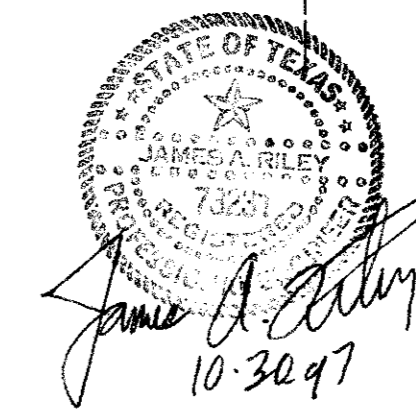

PAVING PLAN						
MARSH/BELT LINE SHOPPING CENTER						
TOWN OF ADDISON						
DALLAS COUNTY, TEXAS						
BROCKETTE · DAVIS · DRAKE, inc. consulting engineers Civil & Structural Engineering-Surveying 4144 North Central Expressway, Suite 1100 Dallas, Texas 75204 (214)824-3647, fax (214) 824-7064						
DESIGN	DRAWN	DATE	SCALE	NOTES	FILE	NO.
JAR	DJR	AUG 97	1"=40'	BDD	C97268	C-3