

MARSH LANE

BUSINESS AVENUE

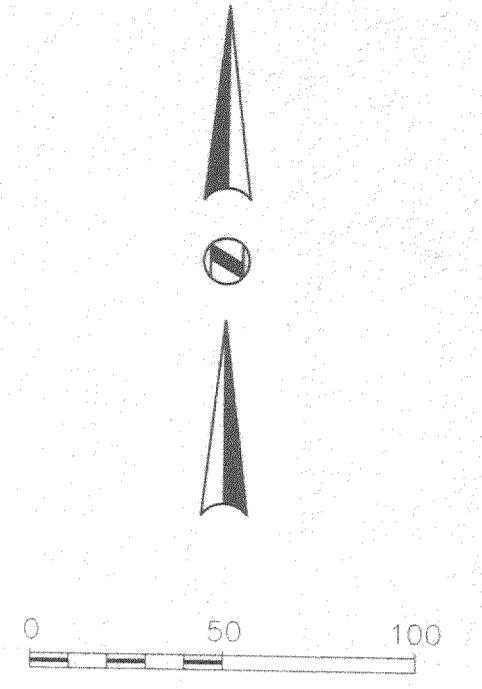
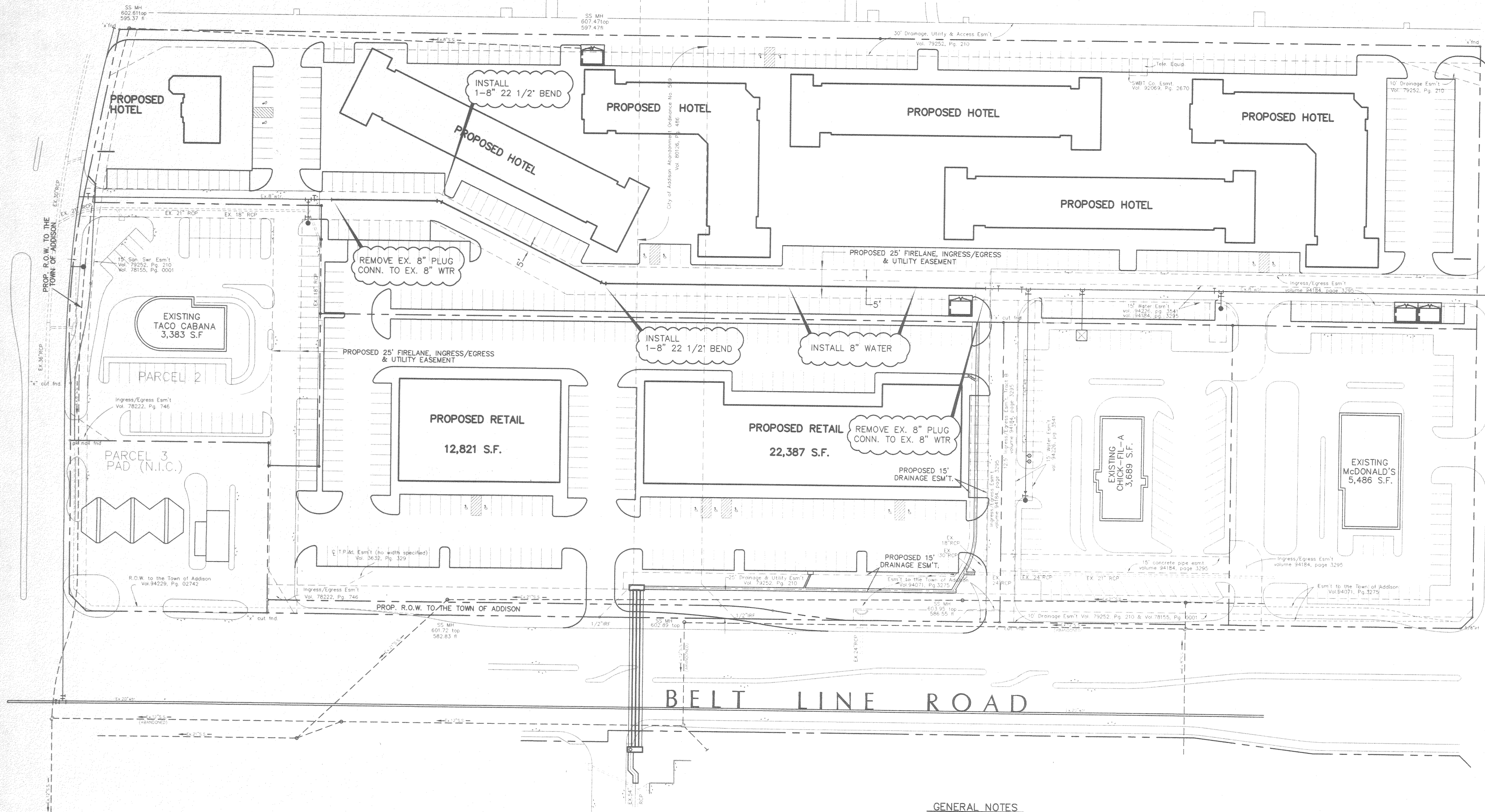

LEGEND

— Existing Water Line
 - - - Proposed Water Line
 - - - Existing Sanitary Sewer Line

GENERAL NOTES

- All construction shall be in accordance with these plans and Town of Addison's ordinances and specifications.
- All materials and workmanship shall conform to "Standard Specifications for Public Works", published by the North Texas Council of Governments, except as modified by the Town of Addison.
- The location of all utilities located on these plans are taken from existing public records. The exact location and elevation of all public utilities shall be determined by the Contractor prior to construction. Contractor shall have a trench safety plan prepared for all excavation in excess of 5 feet deep. It shall be the duty of Contractor to ascertain whether any additional facilities other than those shown on the plans may be present.
- Contractor shall secure all necessary permits and contracts prior to commencing construction.
- It shall be the responsibility of the Contractor to protect all public utilities and other property in the construction of this project. Property damaged during this construction shall be repaired or replaced at the contractor's expense to the satisfaction of the owner.
- Concrete blocking shall be provided on water mains at all bends and fire hydrant per City Standards.
- Pavement affected by construction shall be replaced to match existing. Graded areas affected shall be re-sodded with like materials.
- All public water mains shall be PVC-C900 water pipe.
- The water line shall be constructed with a minimum of 48" of cover.
- The Certificate of Acceptance (COA) will not be issued until all water appurtenances have been adjusted to their final position.

STATE OF TEXAS
 73231
 JAMES A. RILEY
 1-27-99

WATER & SANITARY SEWER PLAN
 SUITES OF AMERICA
 TOWN OF ADDISON
 DALLAS COUNTY, TEXAS

BROCKETTE • DAVIS • DRAKE , inc.
 consulting engineers
 Civil & Structural Engineering • Surveying
 4144 North Central Expressway, Suite 1100 Dallas, Texas 75204
 (214)824-3647, fax (214) 824-7064

DESIGN	DRAWN	DATE	SCALE	NOTES	FILE	NO.
JAR	FG	11/98	1"=50'	BDD	C97268	C-5