

INTEGRAL CURB AND PAVEMENT DETAIL

DETAILS 1-4 ~ CONCRETE PAVING
DETAILS 7-9 ~ ASPHALT PAVING

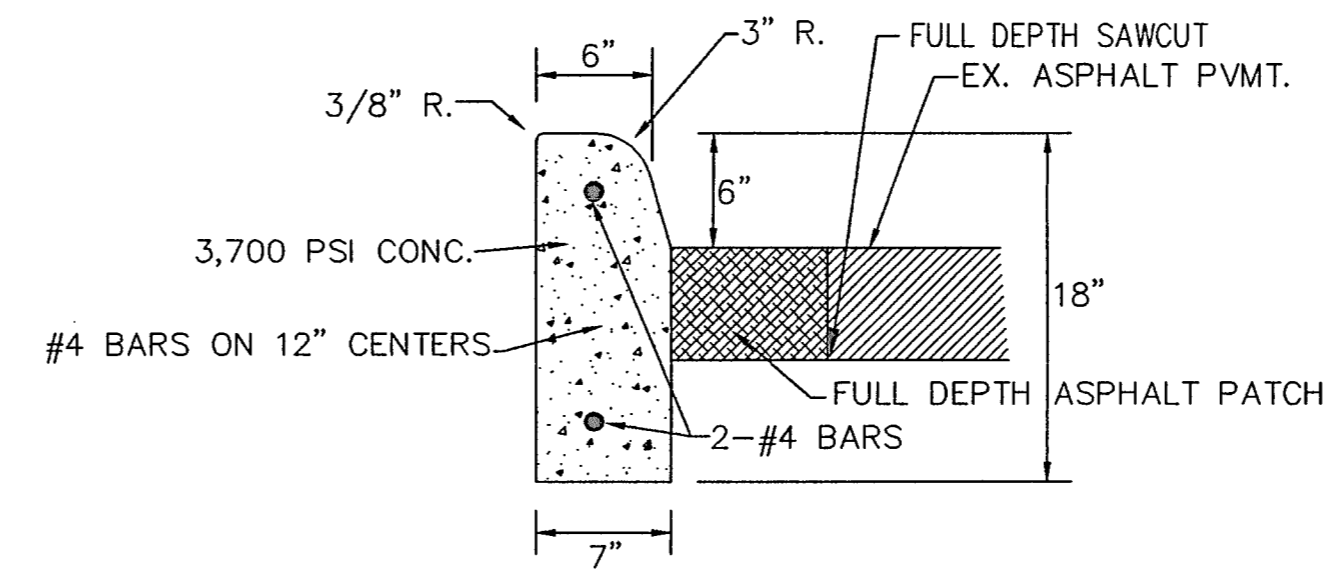

VERTICAL CURB

- NOTES:
1. SUB-GRADE SHALL BE COMPACTED TO 95% STANDARD PROCTOR DENSITY.
 2. CONCRETE SHALL BE 3,700 PSI @28 DAYS.
 3. SEPARATE CURB AND GUTTER SHALL BE MARKED 3/8" DEEP WITH AN APPROVED TOOL IN 20' SECTIONS. EACH FOURTH JOINT SHALL BE AN EXPANSION JOINT CONSTRUCTED WITH 3 DOWELS AND 3/4" PRE-MOLDED BITUMINOUS JOINT MATERIAL.

GENERAL PAVING NOTES:

1. REFERENCE GENERAL NOTES ON GRADING PLAN AND DEMOLITION PLAN FOR ADDITIONAL INFORMATION.
2. REFERENCE TOWN OF ADDISON STANDARD DETAILS AND SPECIFICATIONS FOR ADDITIONAL PAVING DETAILS AND SPECIFICATIONS NOT SHOWN ON THIS SHEET. REFERENCE CITY OF DALLAS DETAILS AND SPECIFICATIONS WHERE AN ITEM, SPECIFICATION, OR DETAIL IS NOT COVERED BY THE CITY OF ADDISON DETAILS AND SPECIFICATIONS.
3. CONTRACTOR SHALL NOT DEVIATE FROM THESE DETAILS WITHOUT AUTHORIZATION FROM THE OWNER OR ARCHITECT.
4. ALL DETAILS MAY NOT APPLY. CROSS-REFERENCE DETAILS WITH GRADING PLAN AND COORDINATE WITH ARCHITECT PRIOR TO CONSTRUCTION.
5. NOTIFY ARCHITECT OF ANY DISCREPANCIES PRIOR TO CONSTRUCTION. DO NOT PROCEED WITHOUT AUTHORIZATION FROM ARCHITECT.

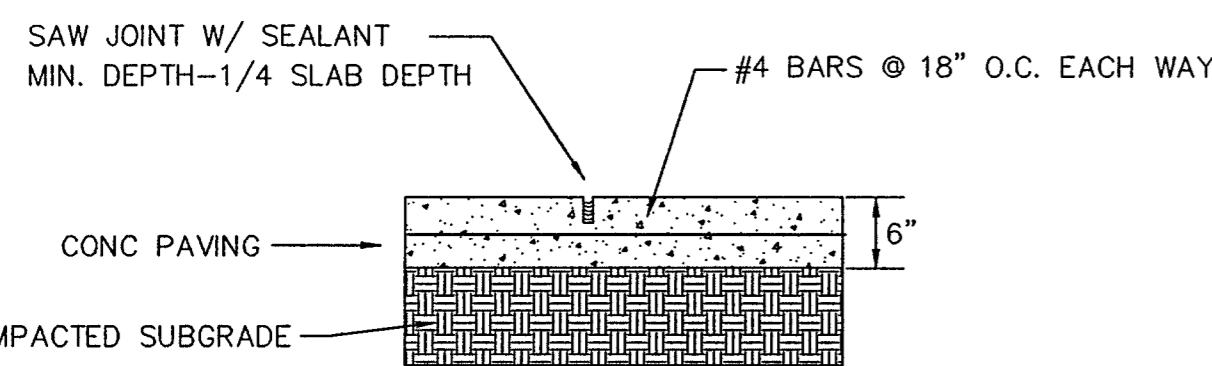

PAVING CONTROL JOINT DETAIL

MAXIMUM SPACING - 15 FT.

ALL DETAILS MAY NOT APPLY
CROSS-REFERENCE DETAILS WITH GRADING
PLAN AND COORDINATE WITH ARCHITECT
PRIOR TO CONSTRUCTION.

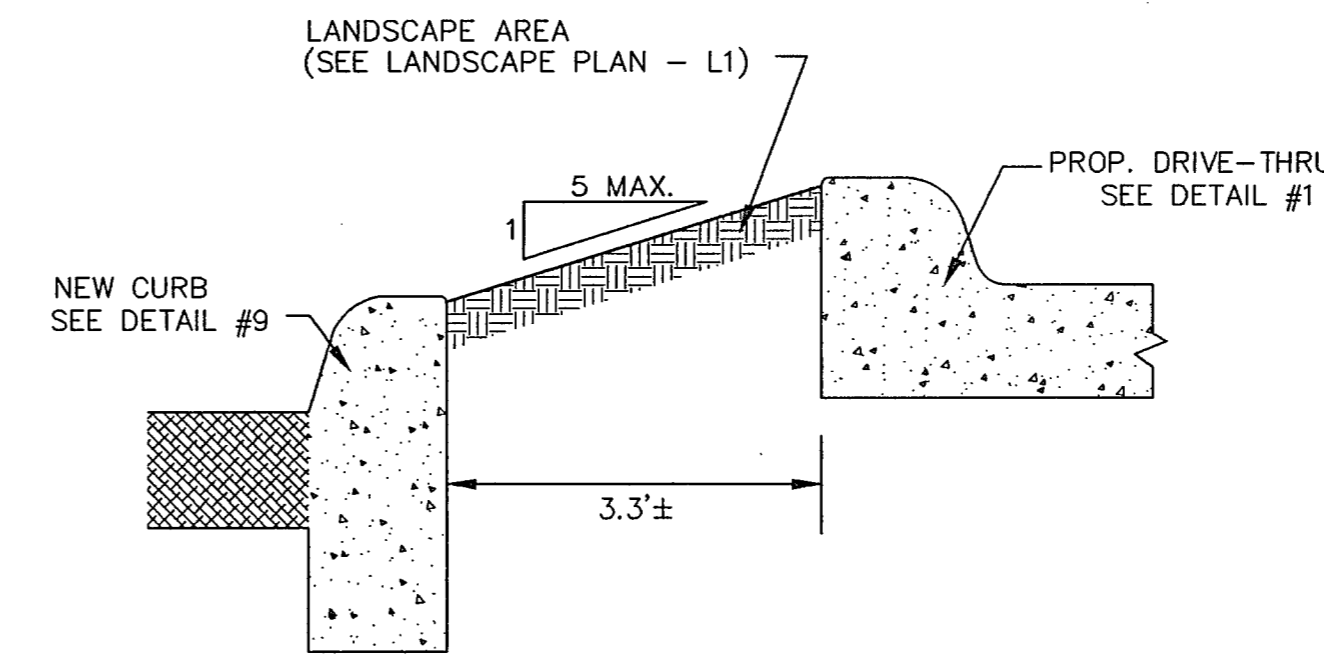

DRIVE-THRU SECTION @ SOUTH CURB

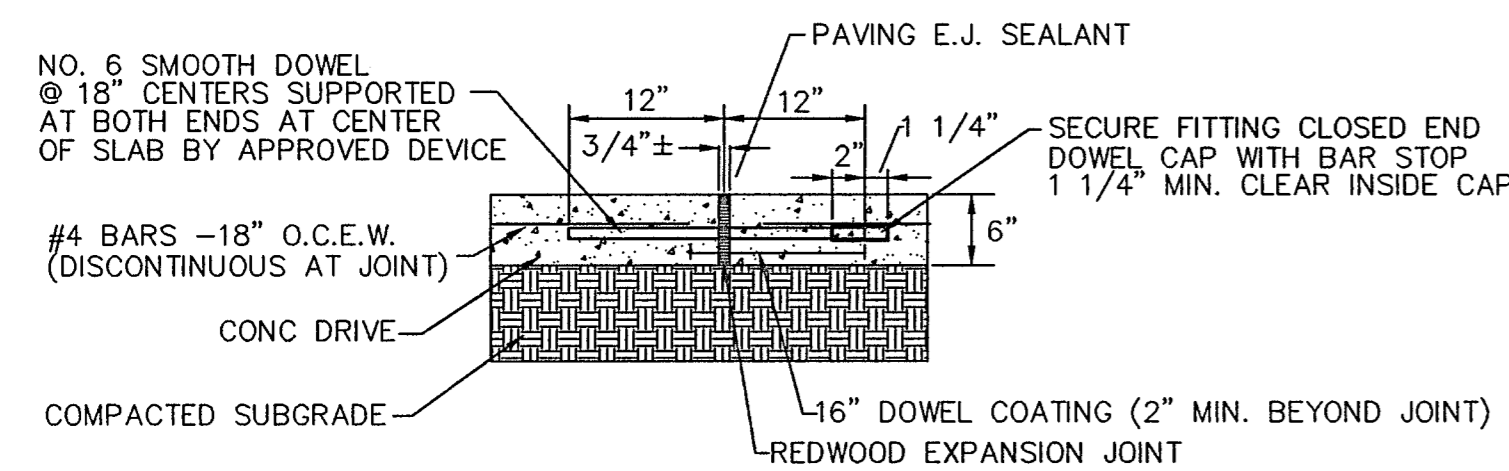

PAVING EXP. JOINT DETAIL

MAXIMUM SPACING - 45 FT.

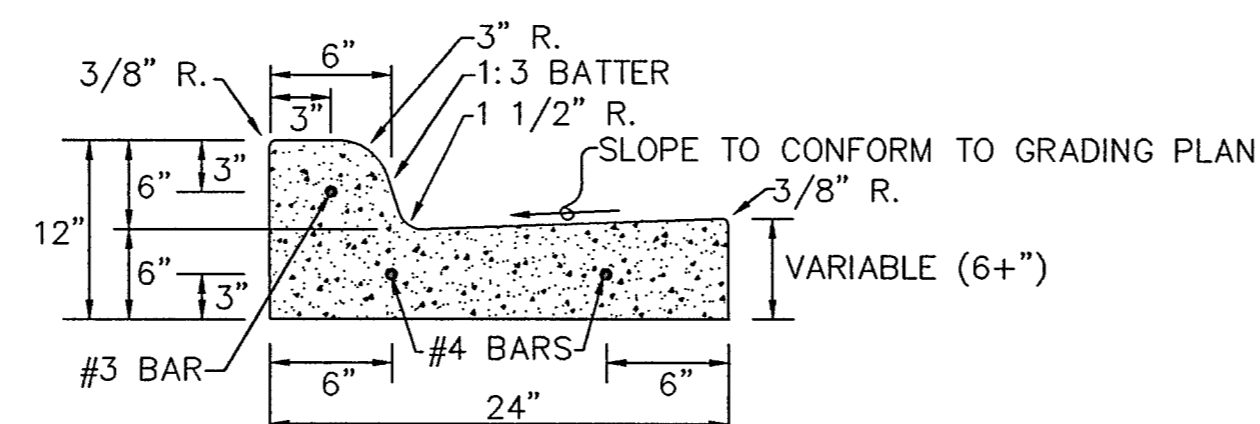

SEPARATE CURB AND GUTTER

- NOTES:
1. SUB-GRADE SHALL BE COMPACTED TO 95% STANDARD PROCTOR DENSITY.
 2. CONCRETE SHALL BE 3,700 PSI @28 DAYS.
 3. SEPARATE CURB AND GUTTER SHALL BE MARKED 3/8" DEEP WITH AN APPROVED TOOL IN 20' SECTIONS. EACH FOURTH JOINT SHALL BE AN EXPANSION JOINT CONSTRUCTED WITH 3 DOWELS AND 3/4" PRE-MOLDED BITUMINOUS JOINT MATERIAL.

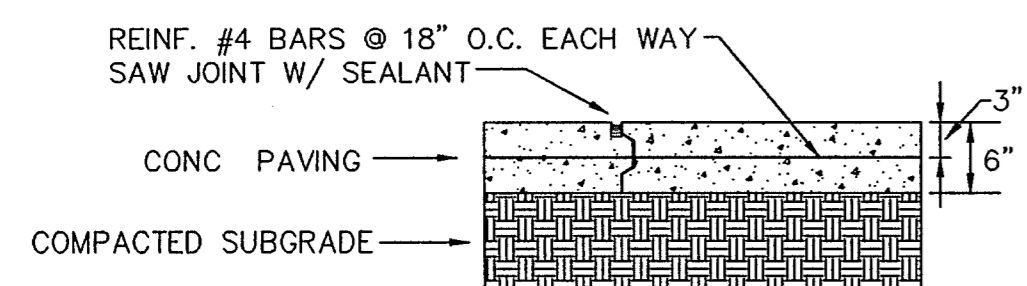

PAVING CONSTRUCTION JOINT

NOTE: KEYED CONSTRUCTION JOINT SHALL BE USED FOR ALL CONSTRUCTION INCLUDING END OF DAYS WORK AND BLOCKOUTS.

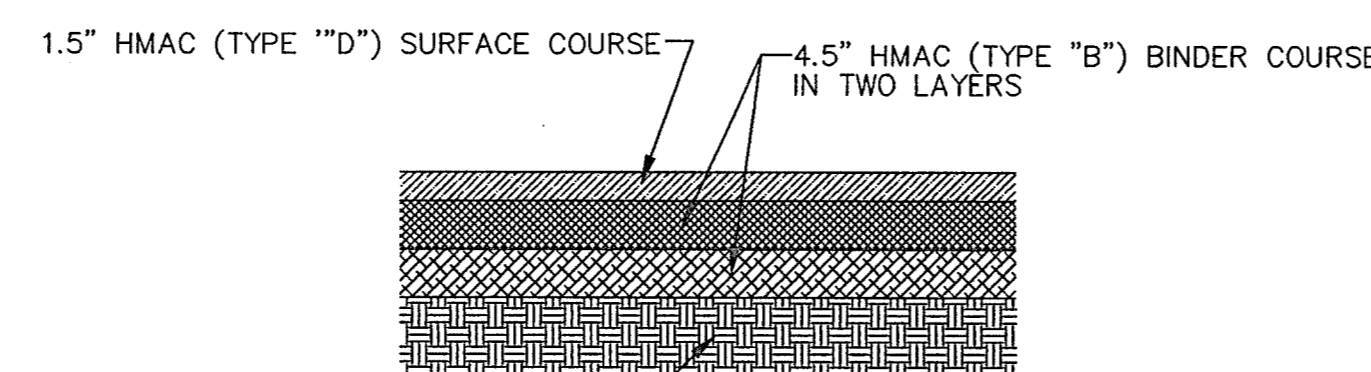

HMAC (ASPHALT) PAVEMENT

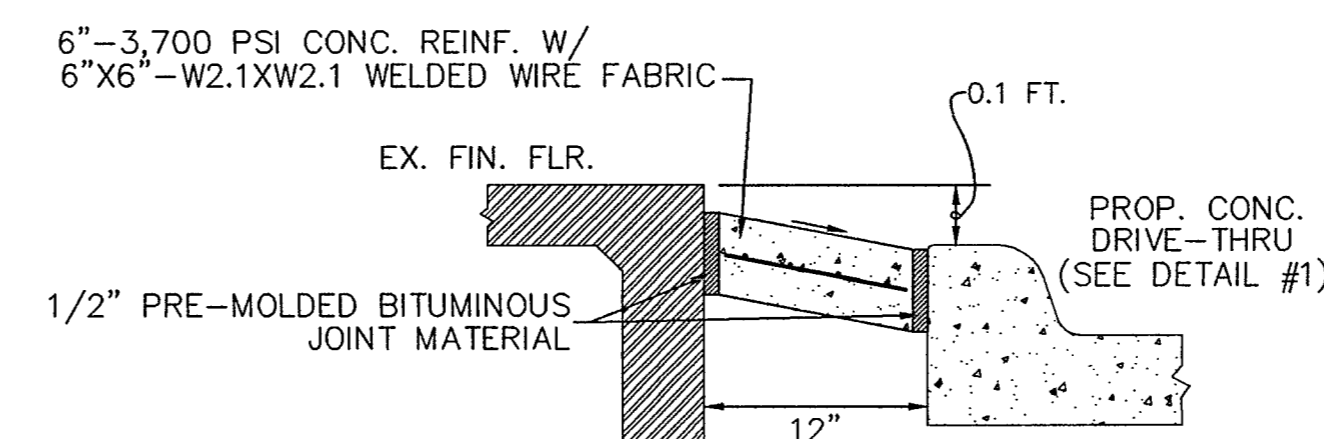

DRIVE-THRU SECTION @ BLDG.

NOTE:
THESE DOCUMENTS AND/OR SPECIFICATIONS MAY BE USED FOR PURPOSES AS INDICATED BELOW:

<input type="checkbox"/> COORDINATION/ PRELIMINARY	<input type="checkbox"/> PERMITTING
<input type="checkbox"/> BIDDING ONLY	<input checked="" type="checkbox"/> CONSTRUCTION

08/27/10

UNDER THE AUTHORITY OF KENNETH E. MORRISON
PROFESSIONAL ENGINEER

THESE DRAWINGS VALID FOR PERMITTING OR CONSTRUCTION ONLY WHEN DATED AND BEARING PROFESSIONAL'S SEAL, SIGNATURE, AND INDICATED IN THE APPROPRIATE BOXES ABOVE. ELECTRONIC FILES, IF PROVIDED, ARE NOT OFFICIAL DOCUMENTS AND ARE NOT WARRANTED AS TO ACCURACY OR COMPLETENESS.

MORRISON AND ASSOCIATES
CONSULTING CIVIL ENGINEERS & SURVEYORS
8911 LAKEWOOD DRIVE
IRVING, TX 75063 (972) 831-0044

PAVING DETAILS

ADDISON TOWN CENTER MODIFICATIONS
3740 BELTLINE ROAD
TOWN OF ADDISON, DALLAS COUNTY, TEXAS
JORDAN ARCHITECTS, LLC
402 W. WHEATLAND ROAD, SUITE 102
DUNCANVILLE, TEXAS 75116 (972) 572-6777

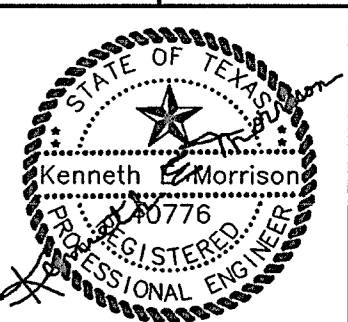

The seal appearing on this document was authorized by Kenneth E. Morrison, P.E. on Aug. 27, 2010. FIRM NO. F-8950

Scale: N.T.S.
Date: 06/15/10
Designed By: KEM
Drawn By: KEM
CAD File:
Project No.:

SHEET C-3
OF 4