

FROM	TO	DISTANCE	PVC CONDUIT T-TRENCH P-PUSH	CABLE										
				SWITCHING		DETECTOR		GRD		LOOP		PWR		
				12C	7C	7C	2C	3C	1C	1C	3C	1C	1C	3C
3	PB4	10'				25								
	PB9	15'	1-2" T				50					440		
	PB4	105'				115	230							
2	PB3	10'				25								
	PB3	50'				120	120							
	PB2	10'	1-2" T	25					25					
	PB2	40'		80	160	160			80					
1	PB1	6'				21								
	PB1	22'		32	96	64			32					
	PB6	8'		18	18	18	18	18	18	476				
	PB6	53'		63	63	63	63							
	PB7	5'	1-3" T	20	20	20	20							
TOTALS				101	137	663	642	101	238	916				

ITEM	Unit	Quan.
CONDUIT: 1-3" PVC TRENCH 1-2" PVC TRENCH	L.F.	5 25
PULL BOX	Ea	1
3M OPTICOM DETECTOR OPTICAL AMPLIFIER	Ea	1
PEDESTRIAN PUSH BUTTON W/ INTEGRAL SIGN	Ea	6
LOOP DETECTOR AMPLIFIER	Ea	3
CABLE-WIRE:	L.F.	
12 CONDUCTOR #12		101
7 CONDUCTOR #12		137
7 CONDUCTOR #12 (PED)		663
2 CONDUCTOR (DET)		642
3 CONDUCTOR (OPTICOM)		101
1 CONDUCTOR #8 (GROUND)		238
THHN DETECTOR LOOP (1c#12)	L.F.	788
FOUNDATIONS: CONTROLLER TYPE 30-A 24-A	Ea	1 1
POLES SIGNAL PEDESTAL MAST ARM POLE w/30' ARM	Ea	1 1
SIGNAL HEADS: 4 SECTION 12" LENS 3 SECTION " " " 1 SECTION PEDESTRIAN	Ea	3 2 6

NOTE TO CONTRACTOR:
1. PRIOR TO BEGINNING ANY CONSTRUCTION IN ADDISON, NOTIFY ROBIN JONES, DIRECTOR OF STREETS # 450-7244 AND DON PREECE, DIRECTOR OF UTILITIES # 450-72

HEAD NUMBERS	9, 10, 22	5, 11, 12	14, 17, 18	19, 20, 21
LENS SIZE	12"	12"	-	-
TYPE	CONV.	CONV.	PED.	PED.
LENS CONFIGURATION	R V G	R V G	DW/W	DW/W
TOTAL NO. OF UNITS	2	3		6

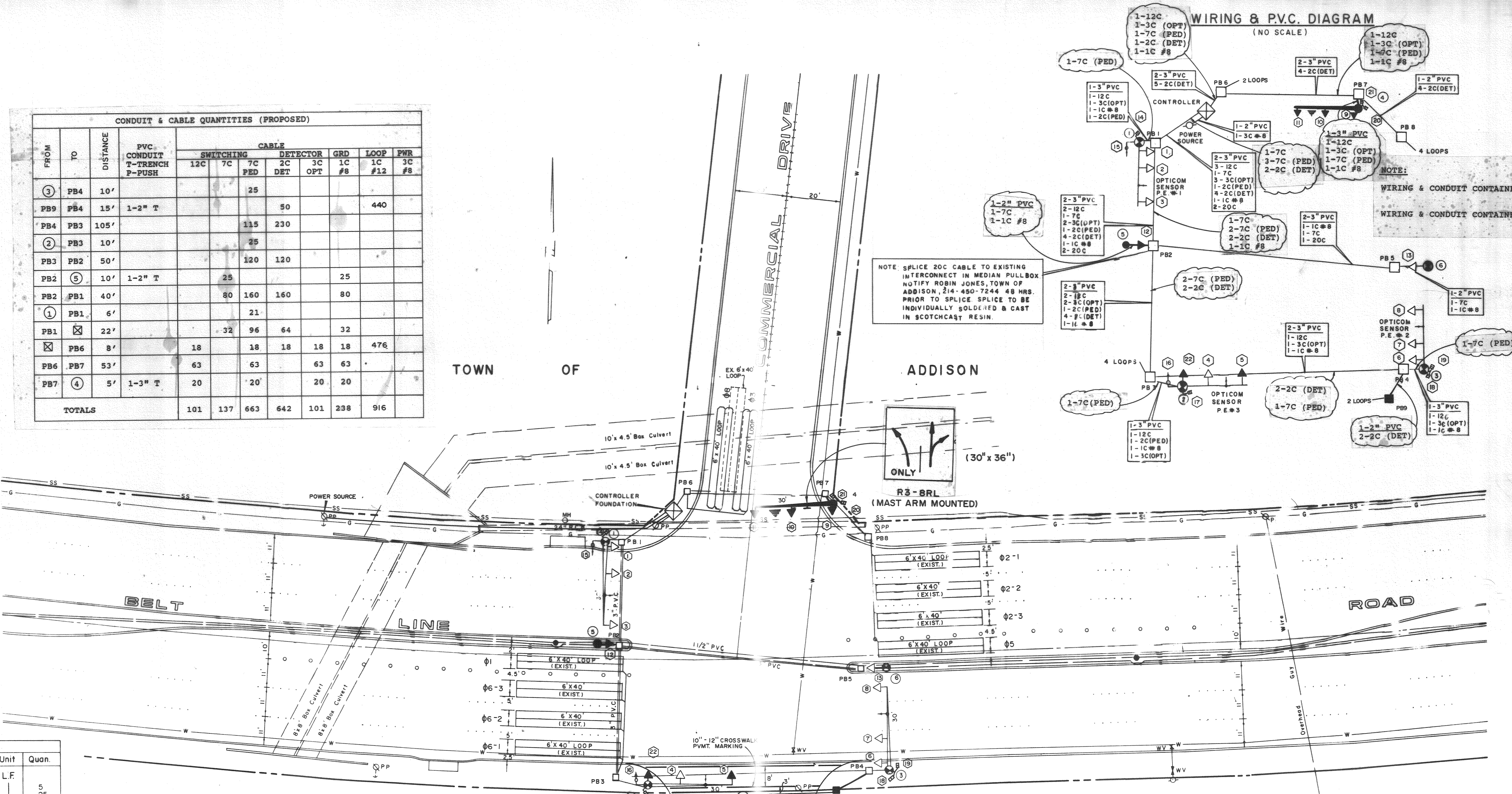

NOTE: SPLICE 20C CABLE TO EXISTING INTERCONNECT IN MEDIAN PULL BOX. NOTIFY ROBIN JONES, TOWN OF ADDISON, 214-450-7244 48 HRS. PRIOR TO SPLICE. SPLICE TO BE INDIVIDUALLY SOLDERED & CAST IN SCOTCHCAST RESIN.

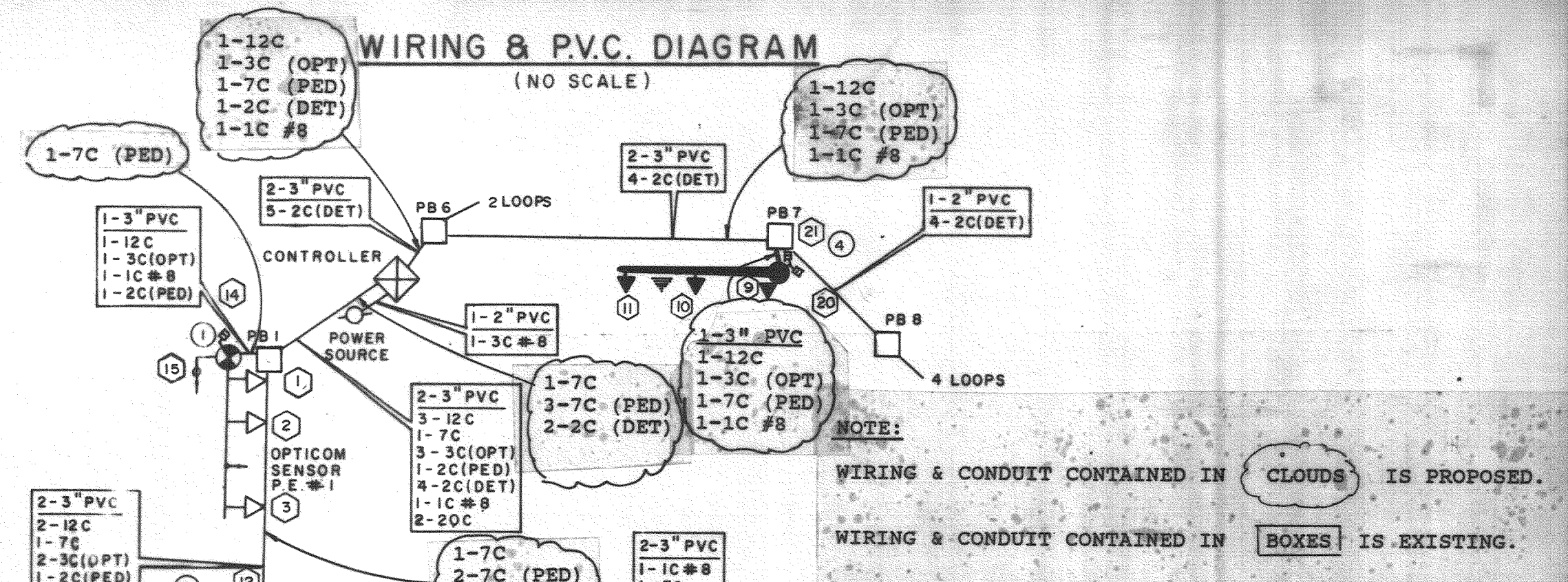

NOTE:
WIRING & CONDUIT CONTAINED IN CLOUDS IS PROPOSED.
WIRING & CONDUIT CONTAINED IN BOXES IS EXISTING.

- ⑤ INSTALL PEDESTAL SIGNAL POLE
- ④ 30' INSTALL SIGNAL MAST ARM & POLE
- ③ EXIST. SIGNAL MAST ARM & POLE
- ⑤ INSTALL TRAFFIC SIGNAL HEAD
- ④ EXIST. TRAFFIC SIGNAL HEAD
- ⑤ INSTALL PEDESTRIAN PUSH BUTTON & ILLUMINATED SIGN
- ⑥ EXIST. PEDESTRIAN PUSH BUTTON & ILLUMINATED SIGN
- ⑤ INSTALL OPTICOM DETECTOR ONE DIRECTION
- ⑤ EXIST. OPTICOM DETECTOR ONE DIRECTION
- INSTALL SIGNAL PULLBOX
- EXIST. SIGNAL PULLBOX
- ⊠ EXIST. CONTROLLER & FOUNDATION
- POWER POLE SERVICE SOURCE
- PVC CONDUIT
- - - U.G. UTILITIES
- == SEWER
- EXIST. PVC CONDUIT

NOTE 1. ALL PAVEMENT MARKINGS & SIGNS REQUIRED WITH THIS INSTALLATION TO MEET M.U.T.C.D. STANDARDS.
2. THE EXISTING 3 SECTION SIGNAL HEAD AT LOCATION ③ IS TO BE RELOCATED FOR USE AS POLE MOUNTED SIGNAL AT LOCATION ②

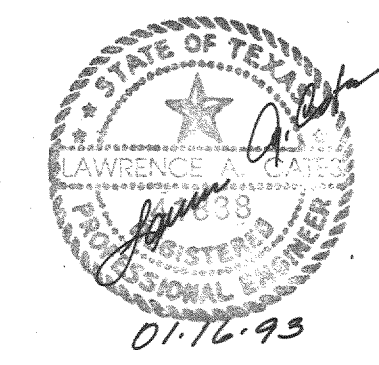

AS BUILTS
I CERTIFY THIS PROJECT WAS CONSTRUCTED IN GENERAL CONFORMANCE WITH THESE CONSTRUCTION PLANS AND WILL FUNCTION AS DESIGNED.

TOWN OF ADDISON, TEXAS					
LAWRENCE A. CATES & ASSOC. CONSULTING ENGINEERS DALLAS, TEXAS					
DESIGN	DRAWN	DATE	SCALE	NOTES	NO.
L.A.C.	L.A.C.	8/24/92	1" = 20'		TI