

GRADE Mon Dec 29 16:46:19 1997 EBP

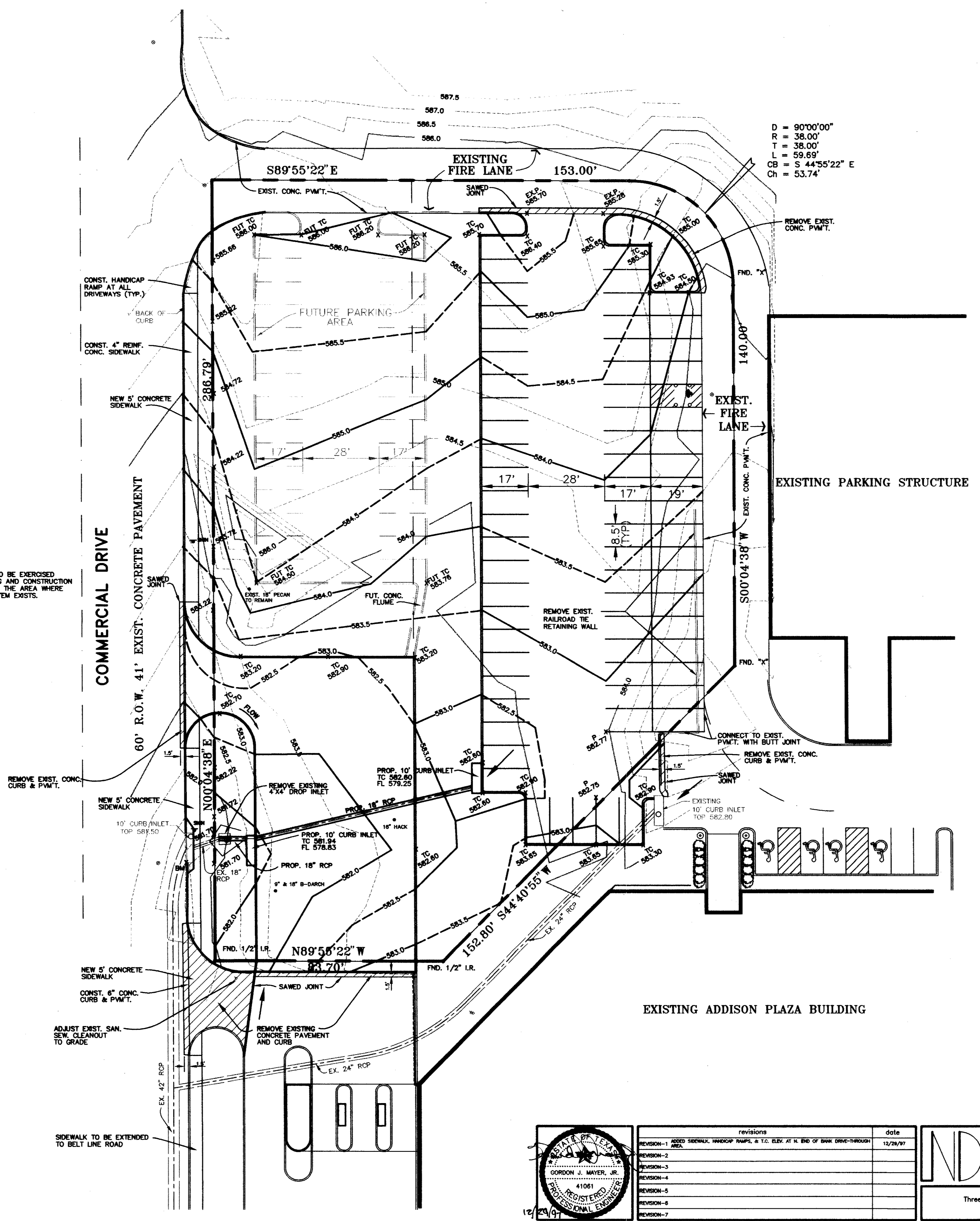

D = 90°00'00"
 R = 38.00'
 T = 38.00'
 L = 59.69'
 CB = S 44°55'22" E
 Ch = 53.74'

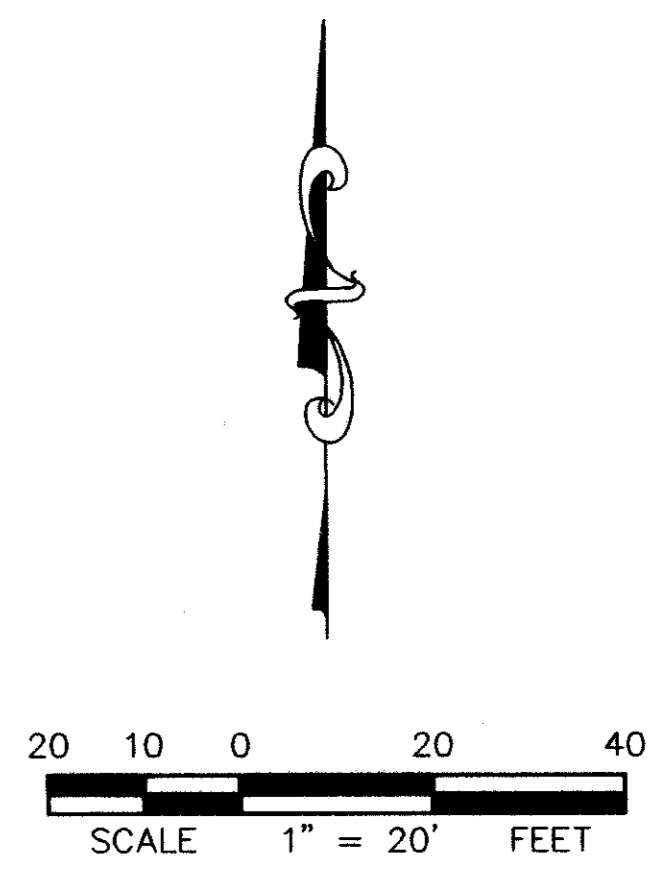

NOTE:
 CAUTION SHOULD BE EXERCISED
 DURING GRADING AND CONSTRUCTION
 OF SIDEWALK IN THE AREA WHERE
 SPRINKLER SYSTEM EXISTS.

BM: CUT ON BACK CURB AT S.W. CORNER OF
 CURB INLET ON E. SIDE OF COMMERCIAL DR.,
 50'± N. OF ENTRANCE TO ADDISON BANK,
 500'± N. OF BELT LINE RD.
 ELEV. 581.43

CONSTRUCTION SET
 ISSUED BY
 TOWN OF ADDISON
 PUBLIC WORKS DEPARTMENT
 B. Ellis DATE: 6 Jan 98

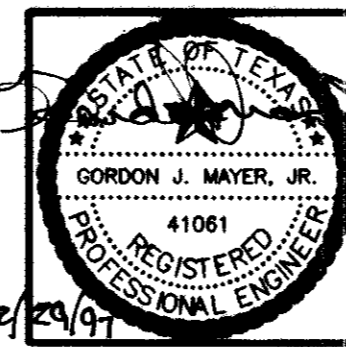

revisions	date
REVISION-1 ADDED SIDEWALK, HANDICAP RAMPS, & T.C. ELEV. AT N. END OF BANK DRIVE-THROUGH	12/29/97
REVISION-2	
REVISION-3	
REVISION-4	
REVISION-5	
REVISION-6	
REVISION-7	

NDM
 NATHAN D. MAIER
 CONSULTING ENGINEERS, INC.
 Three Northpark / 8800 N. Central Expwy. / Suite 300
 Dallas, Texas 75231 / (214) 738-4741

GRADING PLAN BELT LINE - MARSH BUSINESS PARK ADDISON PLAZA ADDISON, TEXAS					sheet no.
design	drawn	scale	date	notes	job number
GJM	SRH	1"=20'	4-97	NDM	97-02-017

4
8