

83-11

D = 90°00'00"  
R = 38.00'  
T = 38.00'  
L = 59.69'  
CB = S 44°55'22" E  
Ch = 53.74'

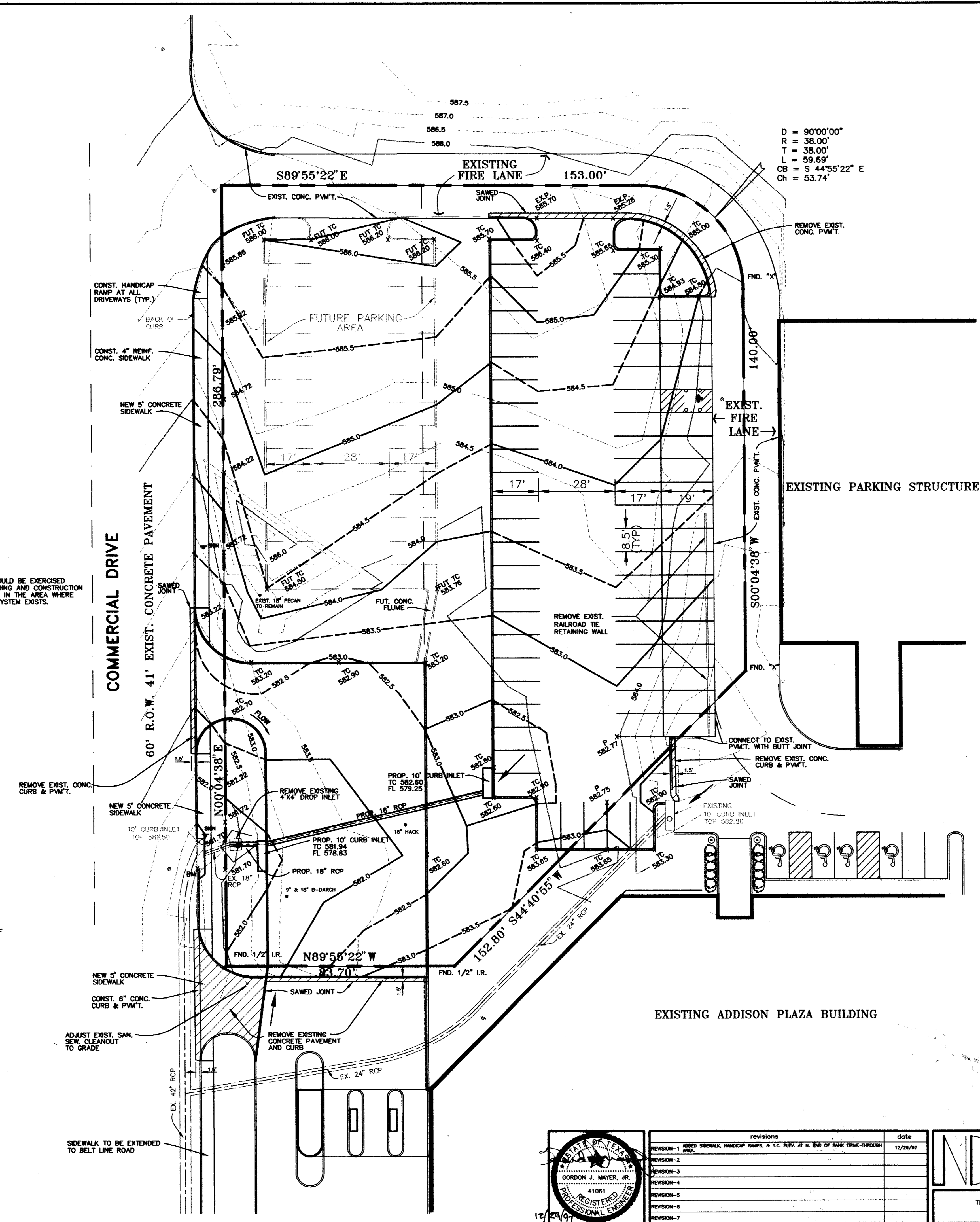
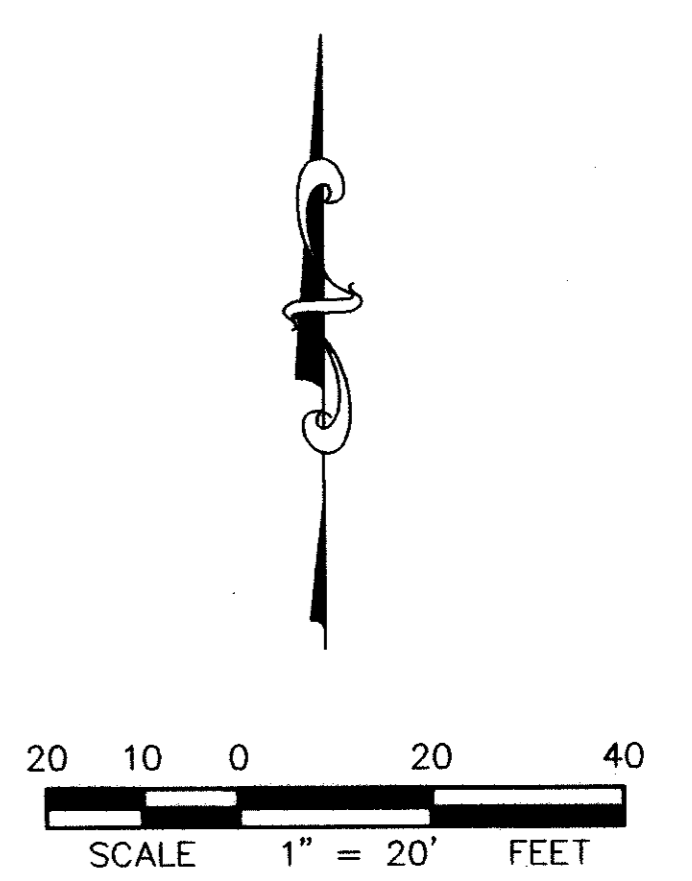

NOTE:  
CAUTION SHOULD BE EXERCISED  
DURING GRADING AND CONSTRUCTION  
OF SIDEWALK IN THE AREA WHERE  
SPRINKLER SYSTEM EXISTS.

BM:  CUT ON BACK CURB AT S.W. CORNER OF  
CURB INLET ON E. SIDE OF COMMERCIAL DR.,  
50± N. OF ENTRANCE TO ADDISON BANK,  
500± N. OF BELT LINE RD.  
ELEV. 581.43

**CONSTRUCTION SET**  
ISSUED BY  
TOWN OF ADDISON  
PUBLIC WORKS DEPARTMENT  
B. G. W. DATE: 4/29/98

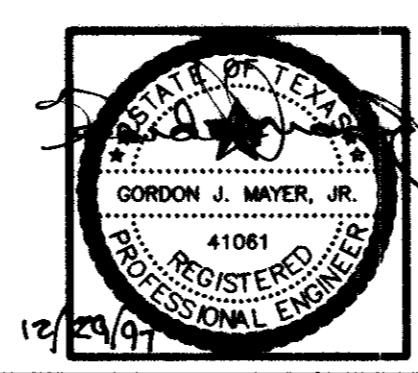

revisions	date
REVISION-1 ADDED SIDEWALK, HANDICAP RAMP, & T.C. ELEV. AT N. END OF BANK DRIVE-THROUGH	12/29/97
REVISION-2	
REVISION-3	
REVISION-4	
REVISION-5	
REVISION-6	
REVISION-7	

**NDM**  
NATHAN D. MAIER  
CONSULTING ENGINEERS, INC.  
Three Northpark / 8800 N. Central Expwy. / Suite 300  
Dallas, Texas 75231 / (214) 739-4741

**GRADING PLAN**  
**BELT LINE - MARSH BUSINESS PARK**  
**ADDISON PLAZA**  
**ADDISON, TEXAS**

sheet no.	job number
4 8	97-02-017