

- NOTE:
1. REINFORCEMENT TO BE #3 BARS AT 18" C-C.
  2. DOWEL WITH #4 BARS AT 18" C-C WHEN CONNECTING TO EXISTING SIDEWALKS, DRIVEWAYS, CURBS AND GUTTER - MINIMUM PENETRATION 6".
  3. INSTALL 1/2" Ø X 18" SMOOTH DOWELS @ 18" (GREASE ONE END & CAP) THROUGH EXPANSION JOINTS.
  4. CONCRETE FOR SIDEWALKS SHALL BE MIN 3000 PSI @ 28 DAYS
  5. ALL PROPOSED VALVES SHALL BE PLACED AT LEAST ONE FOOT OFF THE EDGE OF THE SIDEWALK. PROPOSED MANHOLES SHALL HAVE LIDS CENTERED IN THE SIDEWALK OR BLOCK OUT EXISTING VALVES/MANHOLES.
  6. SIDEWALK CROSS SLOPE 1/4"/FT (TYPICAL).

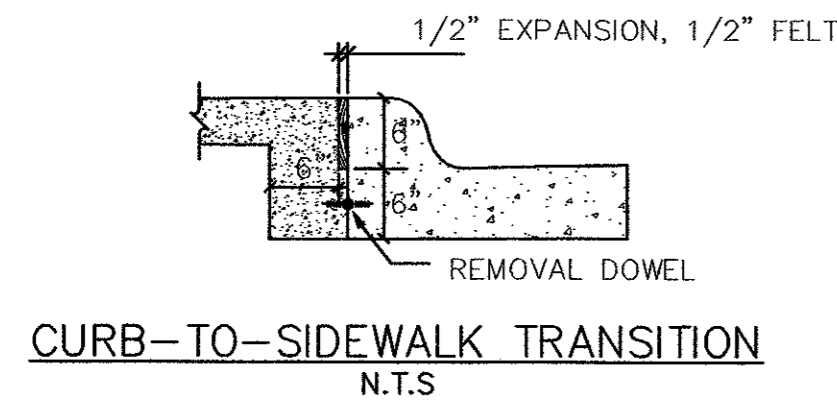

04 TYPICAL SIDEWALK DETAILS  
NOT TO SCALE

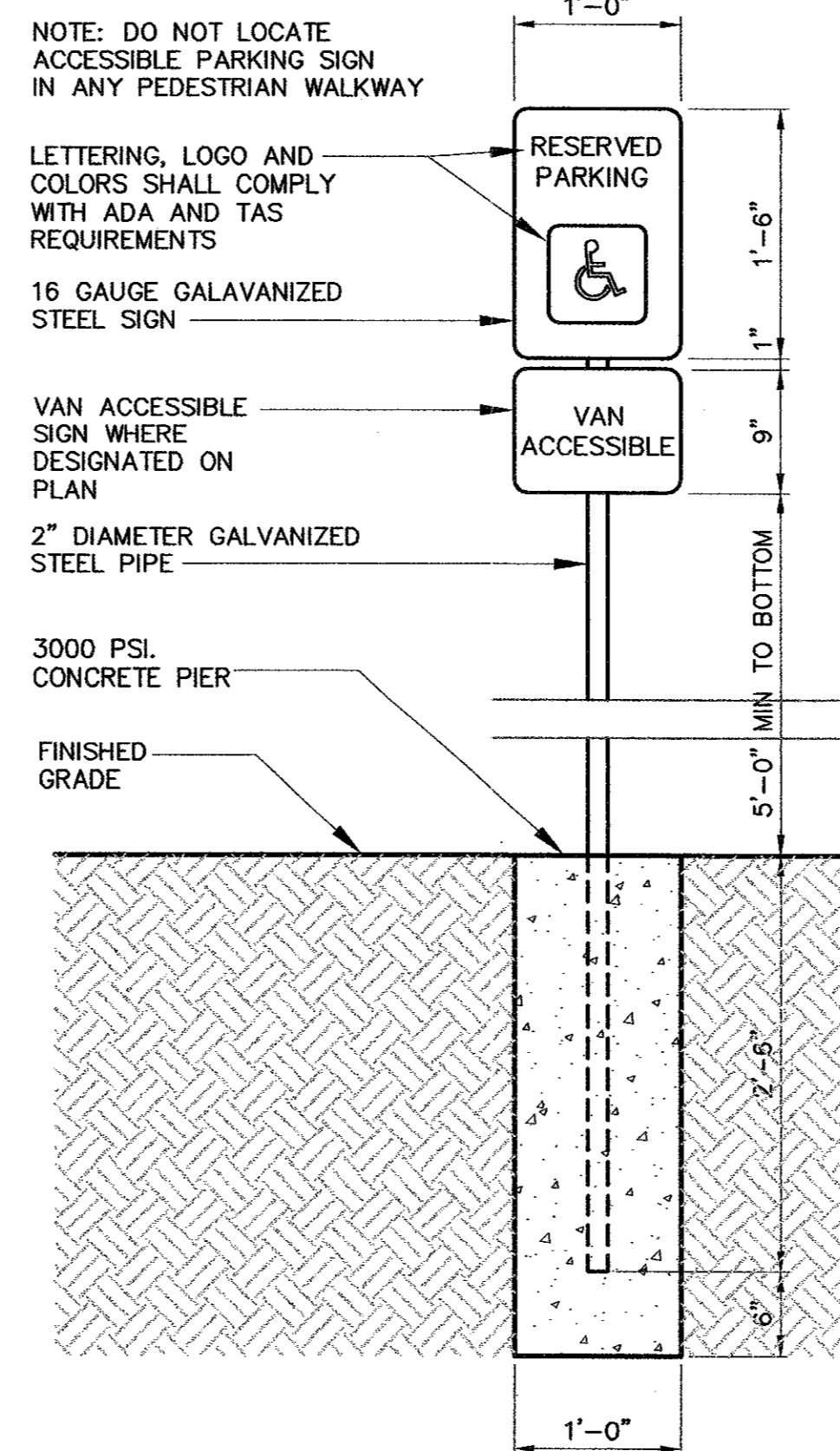

03 ADA PARKING SIGNAGE  
SCALE: 1"=1'-0"

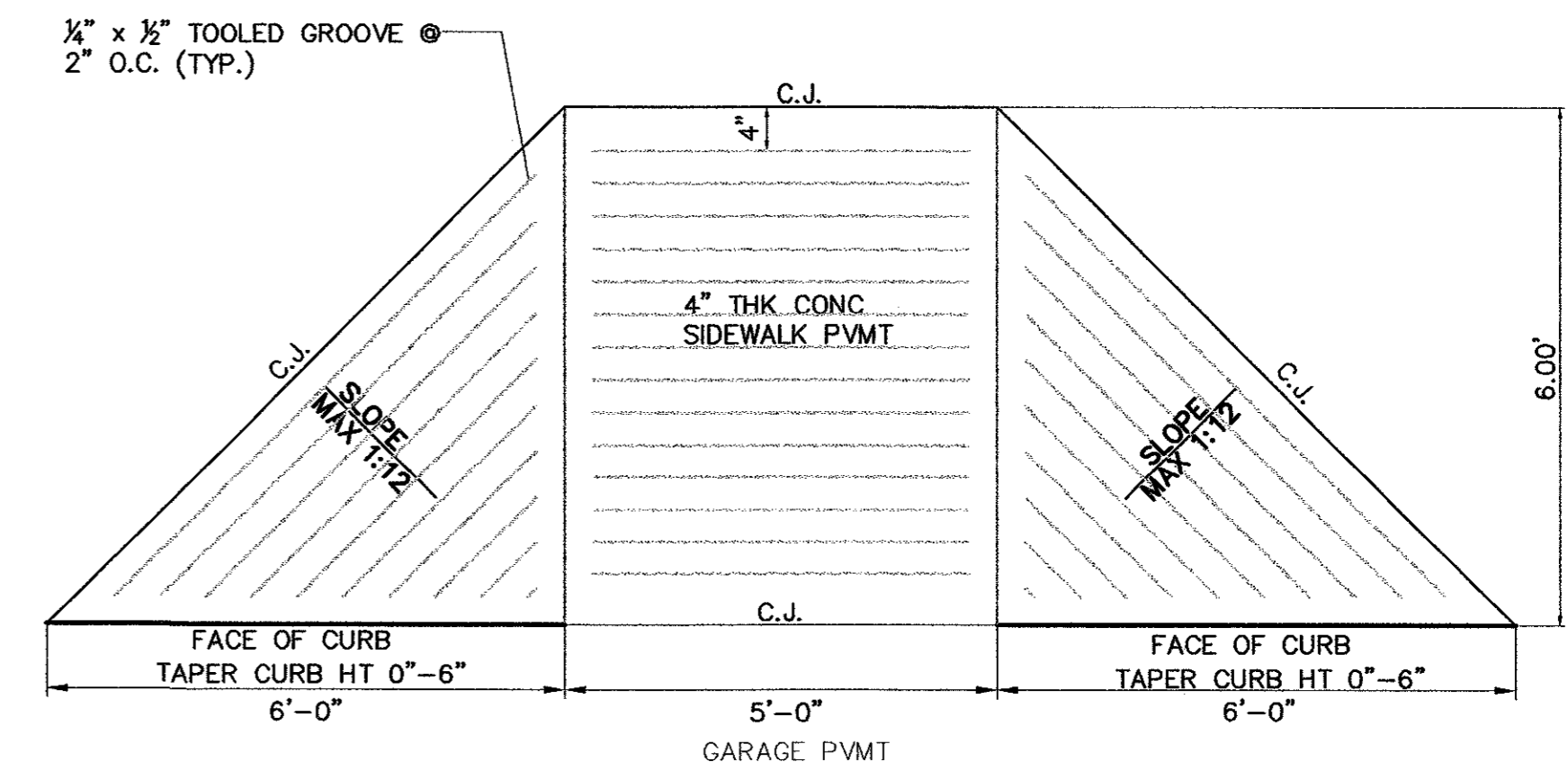

02 TYPE D BARRIER-FREE RAMP  
SCALE: 1/2"=1'-0"

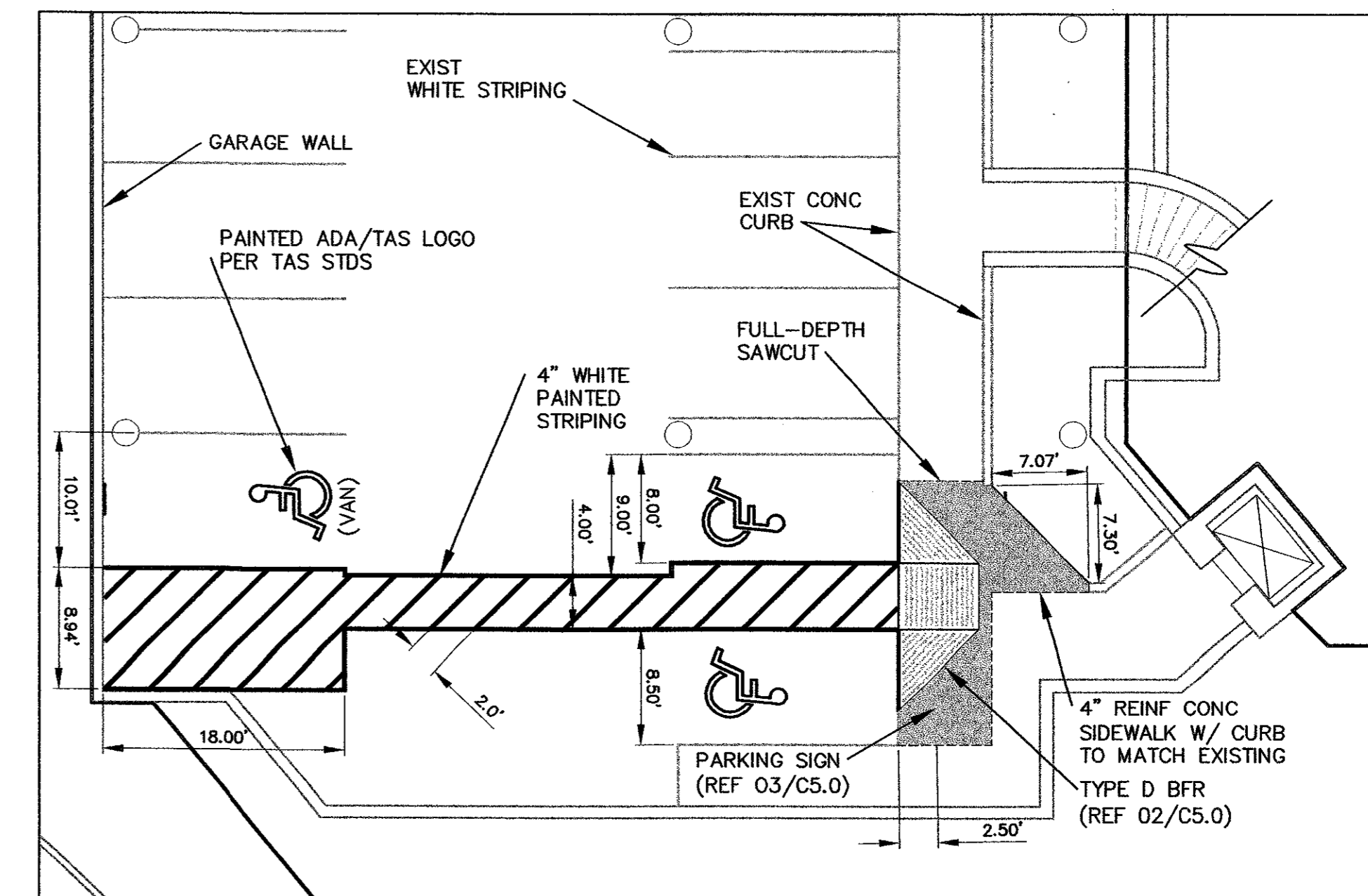

01 BUILDING II PARKING GARAGE MODIFICATIONS  
SCALE: 1"=10'

REV.	DESCRIPTION	DATE
1	INC. ADA PARKING DETAILS	9-3-04
2	RE-ISSUE	12-21-04

**NKR**  
ENGINEERING GROUP, INC.  
4004 BELT LINE RD  
SUITE 210  
ADDISON, TEXAS 75001  
PH: 972.818.6305  
FAX: 972.818.6306

WEST PARKING LOT IMPROVEMENTS  
FOR  
WINDSOR MANAGEMENT  
4002 BELT LINE ROAD, SUITE 100  
ADDISON, TEXAS 75001

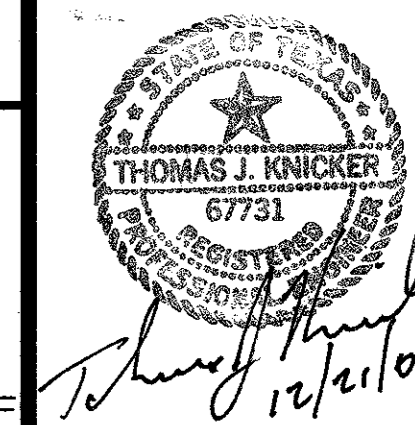

BID / PERMIT  
REVIEW SET  
DETAILS

Issue Date: 09-09-04  
Project No.: 8402  
Drawn By: TJK  
Reviewed By: TJK  
SHEET NUMBER:

C5.0