

# DEVELOPMENT PLANS

## FOR

# FRESH CHOICE

## TOWN OF ADDISON, TEXAS

**GENERAL NOTES**

- A. Prior to final acceptance by the Town of Addison:
- 1) A Texas Registered Professional Engineer shall certify that the project was constructed in accordance with the plans and specifications approved by the Town of Addison.
- The owner shall provide 1 reproduction set of as-builts (sealed and certified by a Texas Registered Engineer) and 2 blue line sets.
- 2) A five foot sidewalk shall be installed along Belt Line Road.
  - 3) A one year maintenance bond is required for the subdivision infrastructure.
  - 4) Contractor shall demonstrate that the water and sanitary sewer systems meet the proper pressure, bacteria, and mandrel tests. In addition, the owner shall provide a VHS format video tape of the sanitary sewer.
- B. Prior to starting construction, the contractor shall contract the utility companies to locate existing facilities. These include but may not be limited to the following:
- 1) Town of Addison
  - 2) Lone Star Gas
  - 3) Southwestern Bell
  - 4) Storer Cable
  - 5) Planned Cable Systems
  - 6) TU Electric
- C. Prior to beginning construction, the owner or his authorized representative shall convene a Pre-Construction Conference between the Town of Addison, Consulting Engineer, Contractor(s), utility companies and any other affected parties. Notify Bruce Ellis 450-2847 at least 48-hours prior to the time of the conference and 48-hours prior to beginning construction.
- D. Any existing pavement, curbs, and/or sidewalks damaged or removed will be repaired by the contractor at their expense.
- E. Lot pins shall be in place during construction and prior to final acceptance. Concrete monuments shall be placed on all boundary corners, block corners, curve points and angle points in public right-of-way. Concrete monuments shall be six (6) inches in diameter and twenty-four (24) inches long. A copper pin one-fourth inch in diameter embedded at least three (3) inches in the monument at the exact intersection point of the monument. The monuments shall be set at such an elevation that after construction, the top of the monument will not be less than twelve (12) inches below the ground surface.
- F. Contractor shall obtain a right-of-way permit by the Town of Addison for working within the public right-of-way.
- G. During construction, the owner shall provide a qualified geotechnical lab to perform materials testing during the construction, at the request of the Town of Addison.
- H. The contractor shall submit material sheets to the Town of Addison for approval prior to incorporating materials into the job.

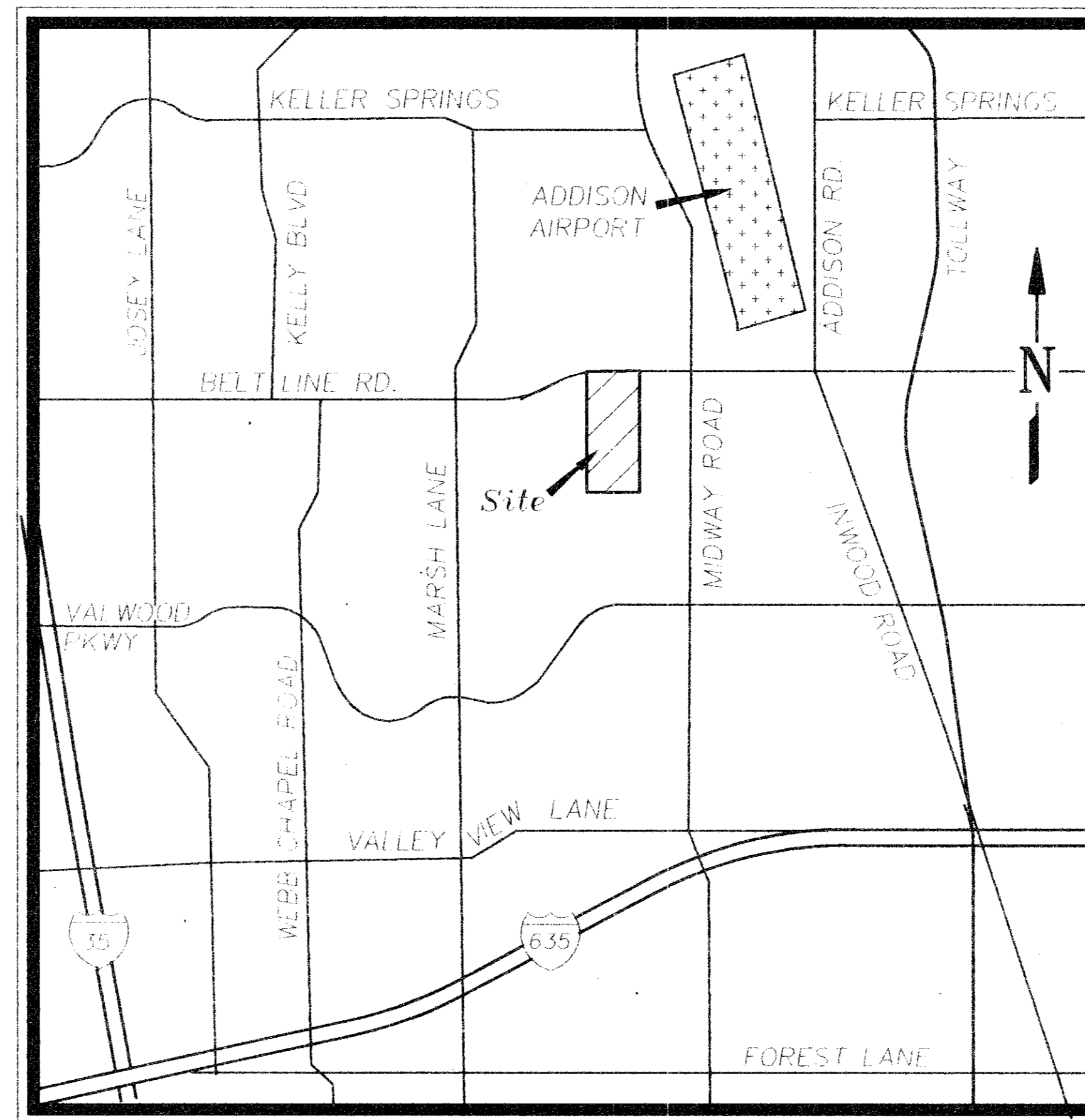

LOCATION MAP  
NOT TO SCALE

**INDEX**

Sheet No.	Description
1	Final Plat
2	Utility Plan
3	Drainage & Grading Plan
4	Pollution Prevention Plan
5-14	Detail Sheets

## PREPARED FOR

# FRESH CHOICE

2901 Tasman ~ Suite 109 ~ Santa Clara, California 95054

**A. H. ASSCIATES, INC.**

6330 Belt Line Road ~ Suite C ~ Garland, Texas 75043 (214) 226-2967