

# Paving, Drainage, and Utility Plans

## RAISING CANE'S #98

### Lot 4, Block A

## SAM'S CLUB ADDITION

## Town of Addison, Texas

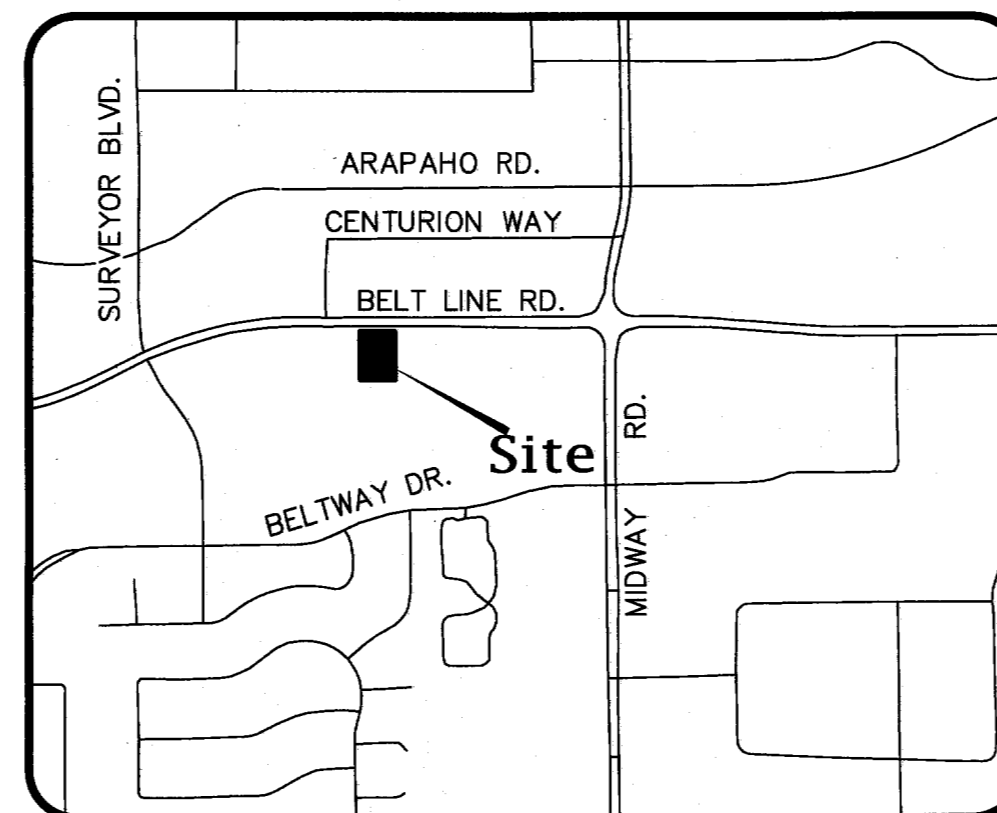

Vicinity Map  
N.T.S.

All responsibility for the adequacy of these plans remains with the Engineer who prepared them. In approving these plans, the Town of Addison makes no representation of adequacy of the work of the Design Engineer.

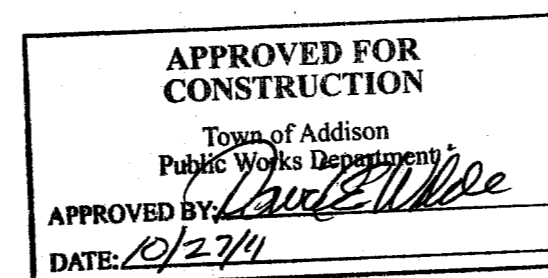

PW # 2011-05

### Index Of Drawings

	Cover Sheet
	Site Plan
	Demolition Plan
C 1	Horizontal Control Plan
C 2	Striping and Signage Plan
C 3	Paving Plan
C 4	Grading Plan
C 5	Drainage Area Map
C 6	Drainage Plan
C 7	Utility Plan
C 8	Erosion Control Plan
C 9	Storm Water Pollution Prevention Guidelines
C 10	Site Details
C 11-C 12	Existing Tree Plan
L 1.00	Landscape Plan
L 1.01	Landscape Specifications
L 1.02	Irrigation Plan
L 2.01	Irrigation Specifications
L 2.02	

Prepared For:



Restaurant Support Office  
5800 TENNYSON PARKWAY, SUITE 200  
Tele: 972 769-3357 Fax: 972 769-3101

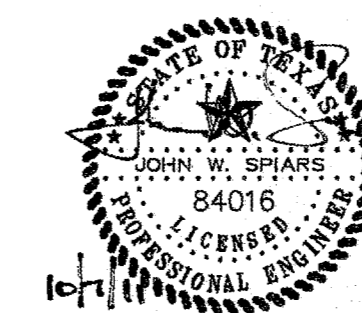

4100 BELT LINE

Sam's Club Addition (Raising Cane's #98)