

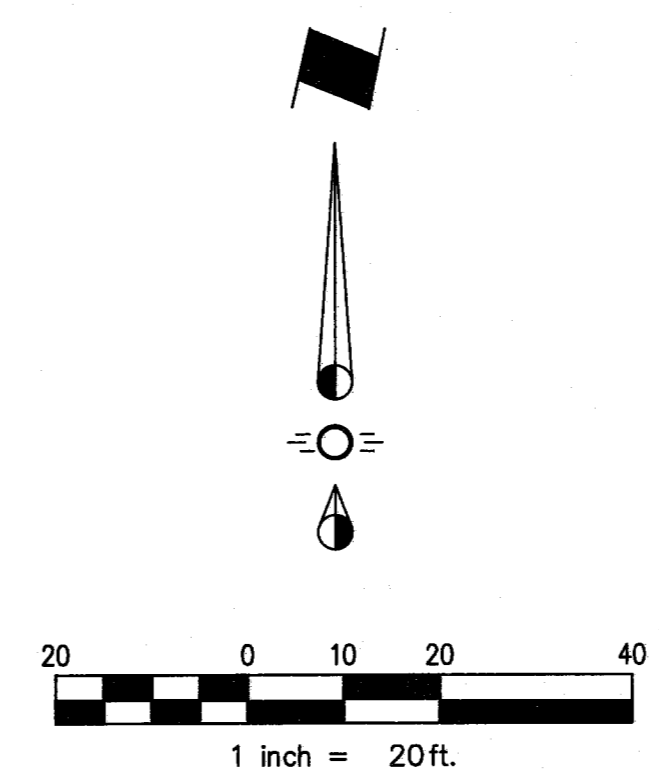

BELT LINE ROAD
(A called 120' RIGHT-OF-WAY)

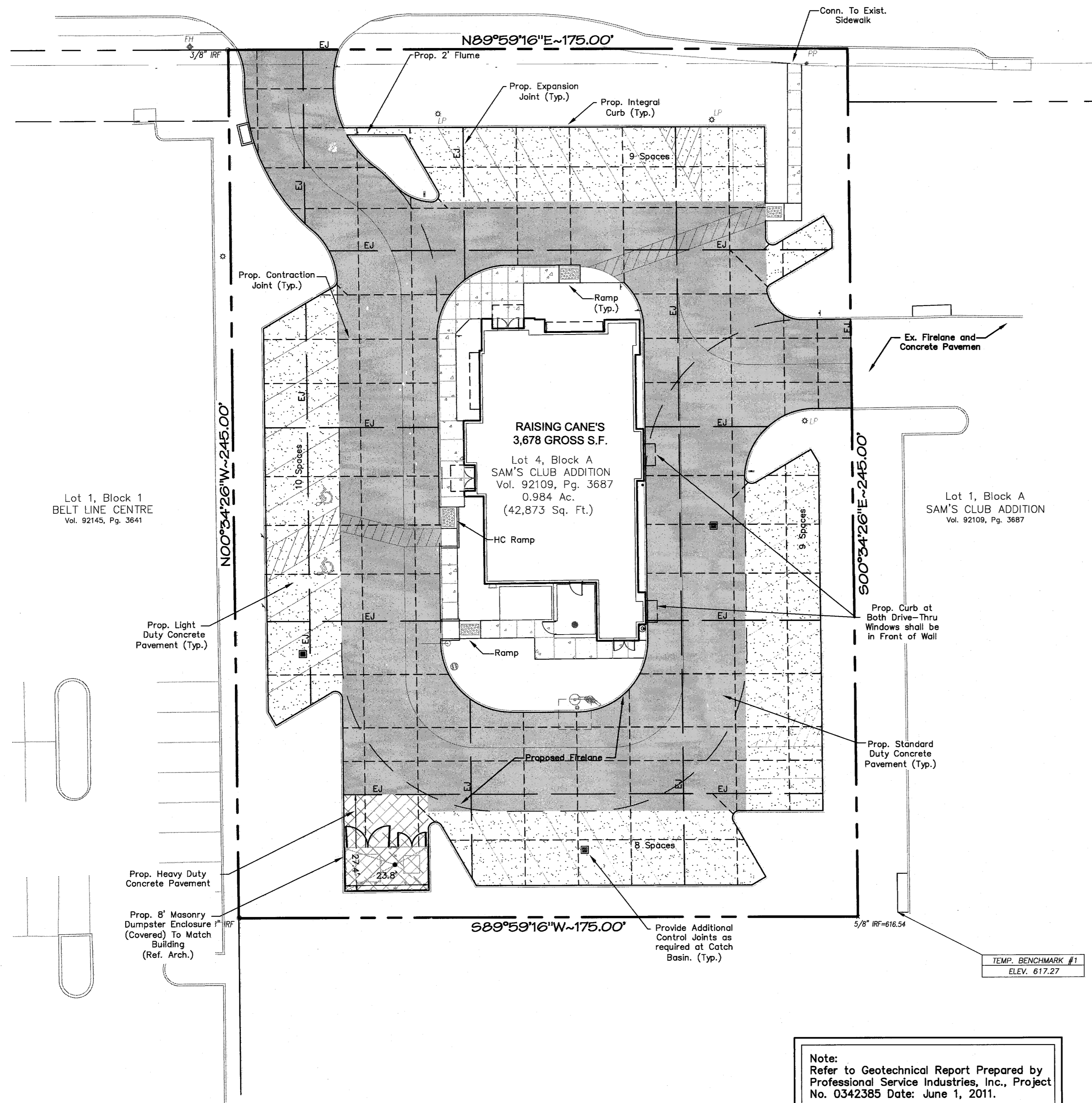

PAVING GENERAL NOTES

1. All materials and construction shall conform to the Town of Addison Standard Details and Specifications.
2. It shall be the responsibility of the Contractor to protect all public utilities in the construction of this project. All manholes, cleanouts, valve boxes, fire hydrants, etc. must be adjusted to proper line and grade by the Contractor prior to and after the placing of permanent paving. Utilities must be maintained to proper line and grade during construction of this project.
3. The Contractor shall be responsible for coordinating with all the appropriate utility companies for the location of all utilities within the construction area.
4. The Paving Contractor shall not place permanent pavement until all sleeving for irrigation, electric, gas, telephone, cable TV, site lighting, etc. has been installed. It shall be the Paving Contractor's responsibility to insure that all sleeving is in place prior to placing permanent paving.
5. All paving and earthwork operations shall conform to the recommendations in the Geotechnical Investigation and the Town of Addison Standard Construction Details.
6. All dimensions are to face of curb or edge of building unless otherwise noted.
7. Parking spaces are 8.5'x17'(Min.).
8. Fire lanes shall be striped in accordance with the Town of Addison requirements.
9. Irrigation sleeves shall be 4" PVC conduit. Ends shall be capped or temporarily plugged, red flag tied to each end and brought to surface 2' behind curb. Minimum depth shall be 18 inches below proposed grade.
10. Concrete shall have a minimum compressive strength at 28 days of 3500 psi for pavement and curbs; 3000 psi for sidewalks.
11. Refer to Architectural Plans for exact building and related sidewalk dimensions.
12. Fences, berms walls, shrubs, trees, signs, structures, etc. are limited to a maximum height of 2 feet above the adjacent curb within visibility easements.
13. Contractor shall install traffic control for any work within R.O.W. to conform to part VI of the "Texas Manual on Uniform Traffic Control Devices."
14. Reference Site Details (Sheet C11) for pavement section details.
15. Longitudinal (Key) Joints (5C11) shall be placed as necessary.
16. Contractor shall extend all paving joints through curbs.
17. Contractor shall verify building and parking lot layout with the Architect prior to forming of buildings, walks and parking lot areas.
18. Contractor shall back fill against top of curbs at 4:1 max. slope to existing grade unless noted otherwise.
19. Slope of paving shall not exceed 2% at handicap accessible spaces.
20. Contractor shall grade pavement around sidewalks & curbs for positive drainage to an inlet or designated drainage area.
21. All landings at doors to be flush with finish floor.

PAVEMENT LEGEND

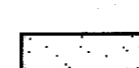
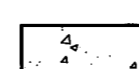
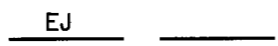
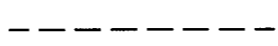
-  7" 3500 psi Conc. Pavement W/ #3 @ 18" O.C.E.W. with lime stabilized subgrade compacted at least 95% of standard proctor (ASTM D-698) maximum dry density at 0 to +4 percent of optimum moisture. (Heavy Duty Pavement)
-  6" 3500 psi Conc. Pavement W/ #3 @ 18" O.C.E.W. with lime stabilized subgrade compacted at least 95% of standard proctor (ASTM D-698) maximum dry density at 0 to +4 percent of optimum moisture. (Standard Duty Pavement)
-  5" 3500 psi Conc. Pavement W/ #3 @ 18" O.C.E.W. with lime stabilized subgrade compacted at least 95% of standard proctor (ASTM D-698) maximum dry density at 0 to +4 percent of optimum moisture. (Light Duty Pavement)
-  4" 3000 psi Conc. Pavement W/ #3 @ 18" O.C.E.W.
-  Expansion Joint (60' Max. Spacing)
-  Contraction Joint (15' Max. Spacing)

Note:
Refer to Geotechnical Report Prepared by
Professional Service Industries, Inc., Project
No. 0342385 Date: June 1, 2011.

TEMPORARY BENCHMARK #1:
SOUTHWEST CORNER OF INLET BEING 11.3' EAST OF
SOUTHEAST CORNER OF SUBJECT TRACT.
ELEVATION = 617.27

CITY BENCHMARK COA-11:
SOUTHWEST CORNER OF INLET 261' EAST AND 5.7'
NORTH OF NORTHEAST CORNER OF SUBJECT TRACT.
ELEVATION = 611.74



Restaurant Support Office
5900 TENNYSON PARKWAY, SUITE 200
Tel: 972 769-3357 Fax: 972 769-3101

Store:
**Raising Cane's
Store # 98
Belt Line Road
Addison, TX 75001
Prototype 2**

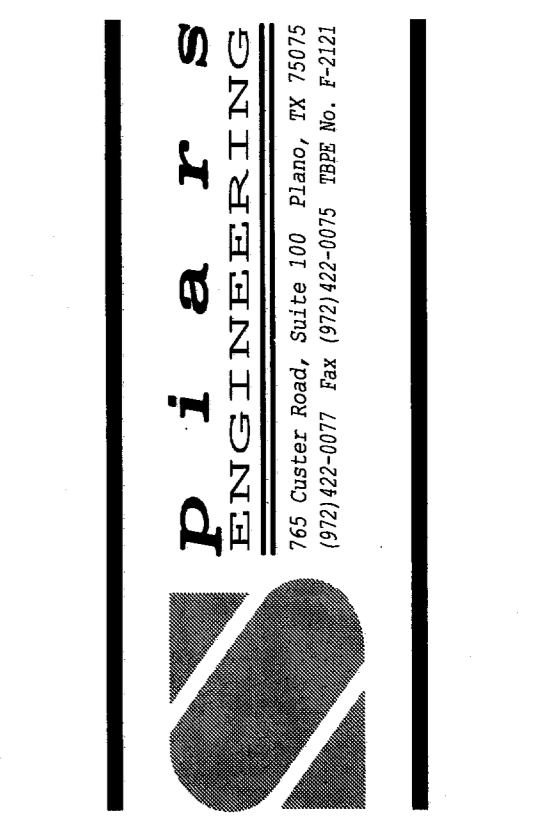
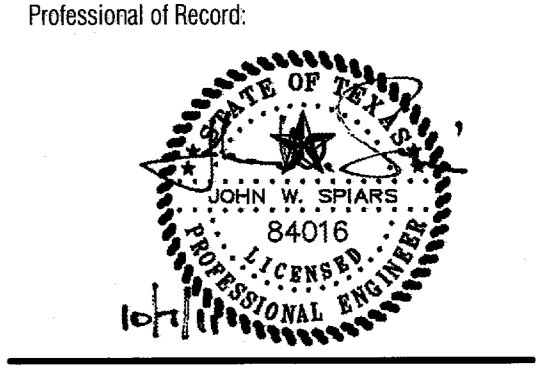

Architect Information:
CSRS
architects engineers

CSRS, Inc.
6767 Perkins Road Suite 200 Baton Rouge, LA 70808
Tele: 225 769-0546 Fax: 225 767-0060
www.csronline.com

Prototype Issue Date: August 1, 2010
Design Bulletin Updates:
Date Issued: Bulletin Number:

FOR CONSTRUCTION

Revisions:

#	Date	Description
1	10-07-2011	PERMIT/OWNER REVIEW

Sheet Title:
PAVING PLAN

Date: October 07, 2011
Project Number: SEI No. 11-101
Drawn By: MPC

Sheet Number:
C4