

10 sets
to CHAD
10/20/84
complete
Black
inc.

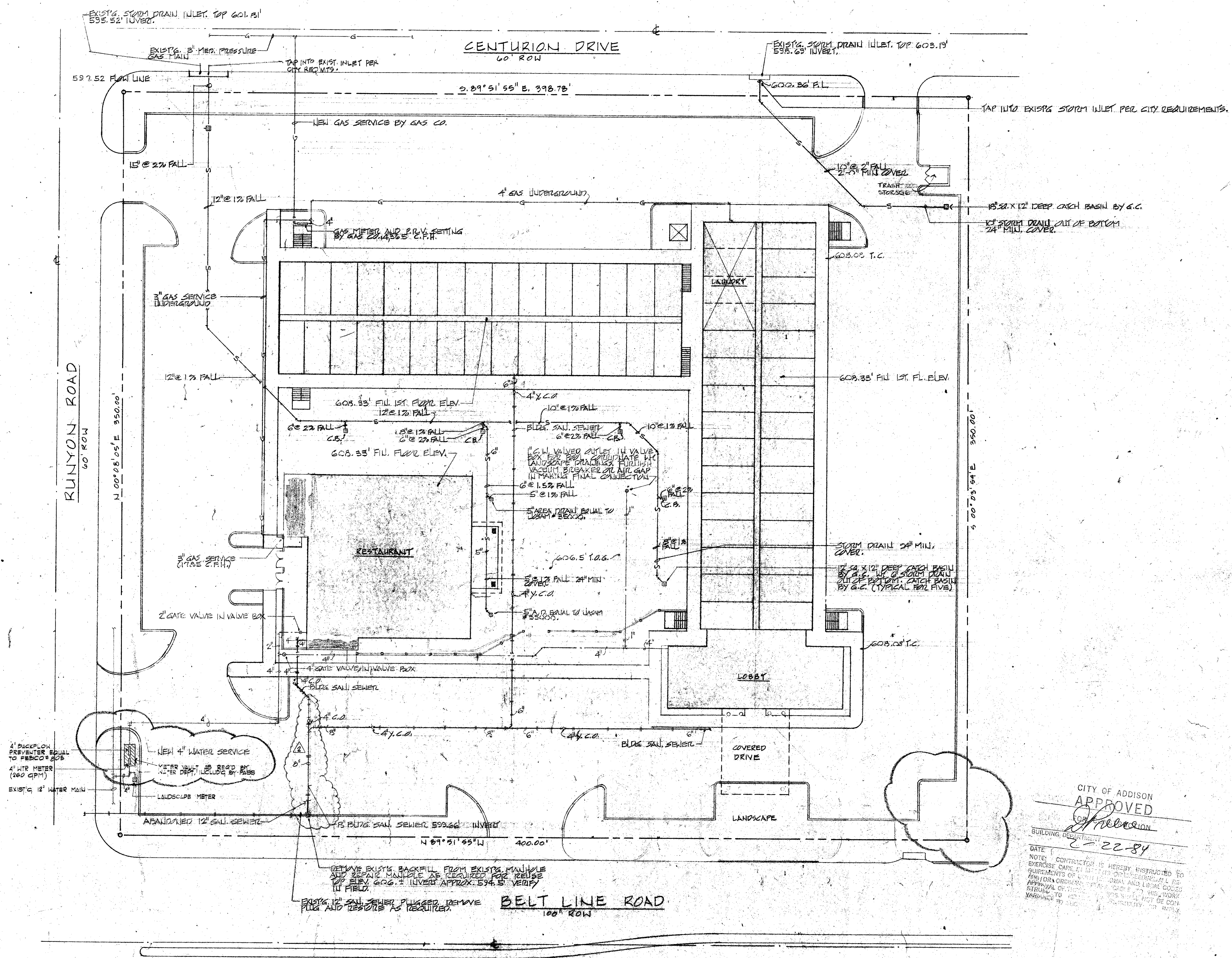

CITY OF ADDISON
APPROVED
DATE 2-22-84
BUILDING DEPARTMENT
NOTE: CONTRACTOR IS HEREBY INSTRUCTED TO EXERCISE CARE IN ALL WORK AND TO VERIFY ALL REQUIREMENTS OF LOCAL, STATE AND FEDERAL CODES PRIOR TO COMMENCEMENT OF WORK. HIS WORK SHALL BE SUBJECT TO INSPECTION AND APPROVAL BY THE CITY ENGINEER. HIS WORK SHALL NOT BE CONSIDERED COMPLETE UNTIL ALL REQUIREMENTS ARE MET.

SITE PLAN - PLUMBING

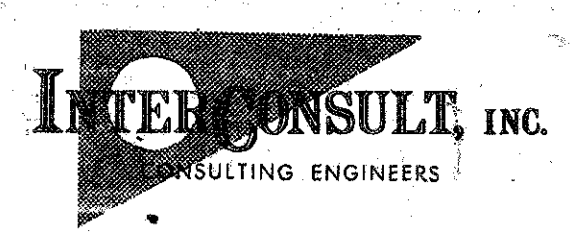

SITE PLAN
SCALE 3/8" = 1' - 20'



BEST WESTERN MOTOR INN
ADDISON, TEXAS

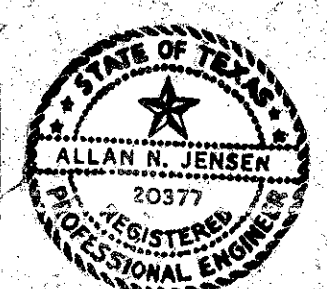

REV. 2-21-83 HAR
REV. 11-1-83

Job no. 143
drawn
date 10/10/83
sheet no. **P-1**
of 8

10 sets
to CHAR
10/20/84
complete
Black
Line

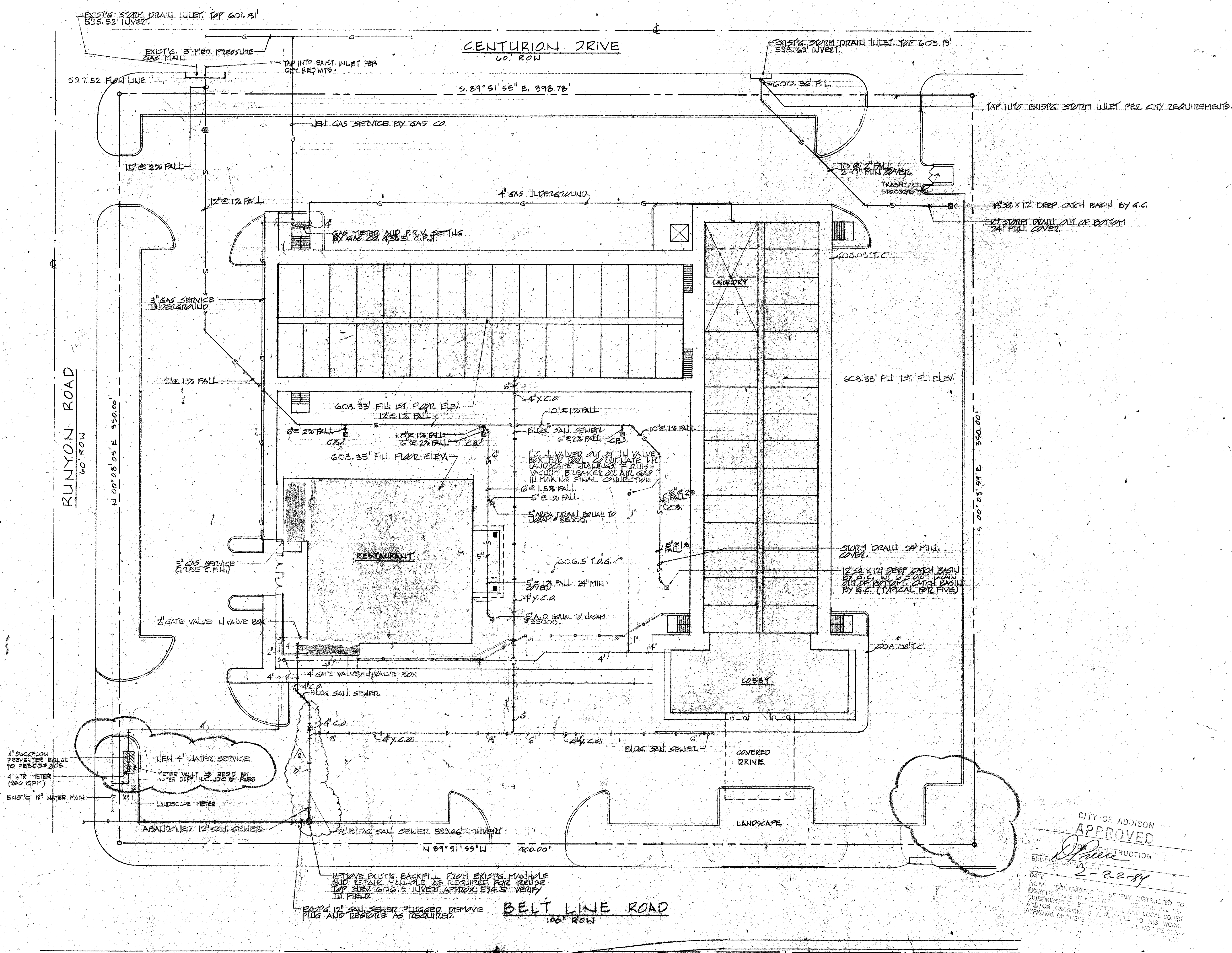

CITY OF ADDISON
APPROVED
CONSTRUCTION
DATE: 2-22-84
NOTE: CONTRACTOR IS HEREBY INSTRUCTED TO
PROCEED WITH THE WORK SHOWN ON THIS PLAN
AND TO OBTAIN ALL NECESSARY PERMITS AND
APPROVALS FROM THE CITY OF ADDISON AND
THE STATE OF TEXAS. THE CONTRACTOR SHALL
BE RESPONSIBLE FOR OBTAINING ALL NECESSARY
PERMITS AND APPROVALS.

SITE PLAN - PLUMBING

INTERCONSULT, INC.
CONSULTING ENGINEERS



SITE PLAN
SCALE 3/8" = 20'

ART WILLIAMS JR
ARCHITECT
INC
2880 LBJ Fwy., Suite 380
Dallas, Texas

BEST WESTERN MOTOR INN
ADDISON, TEXAS

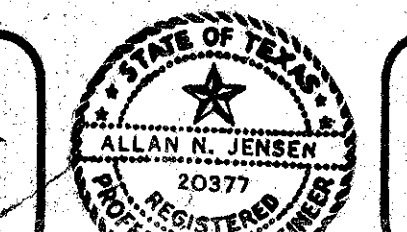

REV. 2-21-83 - HAR
REV. 11-1-83
Job no. 143
drawn
date 10/10/83
sheet no. P-1 of 2