

- ### STORM DRAIN LEGEND
- SANITARY SEWER AND MANHOLE
 - SANITARY SEWER AND CLEANOUT
 - EXISTING SANITARY SEWER AND MANHOLE
 - PROPOSED FIRE HYDRANT ASSEMBLY
 - PROPOSED WATERLINE WITH GATE VALVE AND BOX WITH 10' W.L.E.
 - EXISTING WATERLINE WITH GATE VALVE AND BOX
 - PROPOSED STORM SEWER WITH MANHOLE AND INLETS
 - PROPOSED PRIVATE STORM SEWER
 - EXISTING STORM SEWER AND MANHOLE
 - EXISTING INLET
 - PROPOSED TREE WELL
 - 2x6 TRUNCATED DOME PANEL

CONTRACTOR TO CONNECT 4" PERFORATED PVC DRAINAGE PIPE TO BACK OF STORM DRAIN INLETS. CONTRACTOR TO DETERMINE FREQUENCY AND LOCATION OF CONNECTIONS TO ALLOW ADEQUATE DRAINAGE OF STRUCTURAL SOIL.

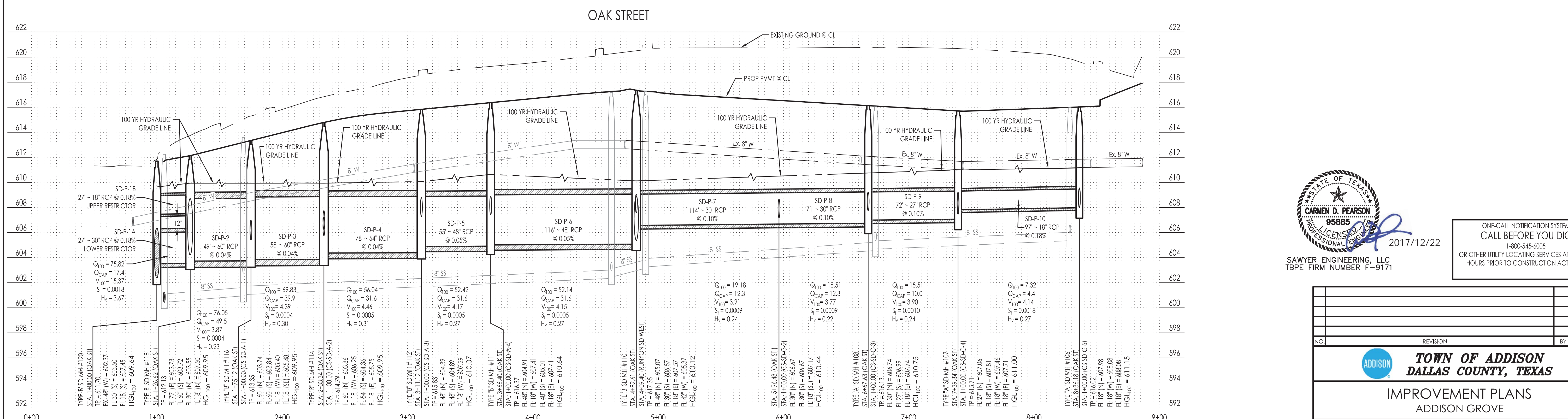

2017/12/22

SAWYER ENGINEERING, LLC
TBPE FIRM NUMBER F-9171

ONE-CALL NOTIFICATION SYSTEM
CALL BEFORE YOU DIG
1-800-545-6005
OR OTHER UTILITY LOCATING SERVICES AT LEAST 48 HOURS PRIOR TO CONSTRUCTION ACTIVITIES.

NO.	REVISION	BY	DATE

TOWN OF ADDISON
DALLAS COUNTY, TEXAS

IMPROVEMENT PLANS
ADDISON GROVE

STORM DRAIN PLAN & PROFILE
- OAK STREET

SAWYER ENGINEERING, LLC TBPE: F-9171		1520 OLIVER STREET HOUSTON, TEXAS 77007 (832) 553-5948	
PROJECT	DESIGN	DRAWN	DATE
	CDP	JDS	MAY 2017
FILE	SHEET		
	23		