

PLANS FOR THE CONSTRUCTION OF THE SITE IMPROVEMENTS TO SERVE SAM'S CLUB

BELTLINE + MIDWAY ADDISON, TEXAS

OWNER / DEVELOPER
WAL-MART STORES INC.
701 S. WALTON BLVD., HWY. 71
BENTONVILLE, ARKANSAS 72716-0095
PH. (501) 273-6711

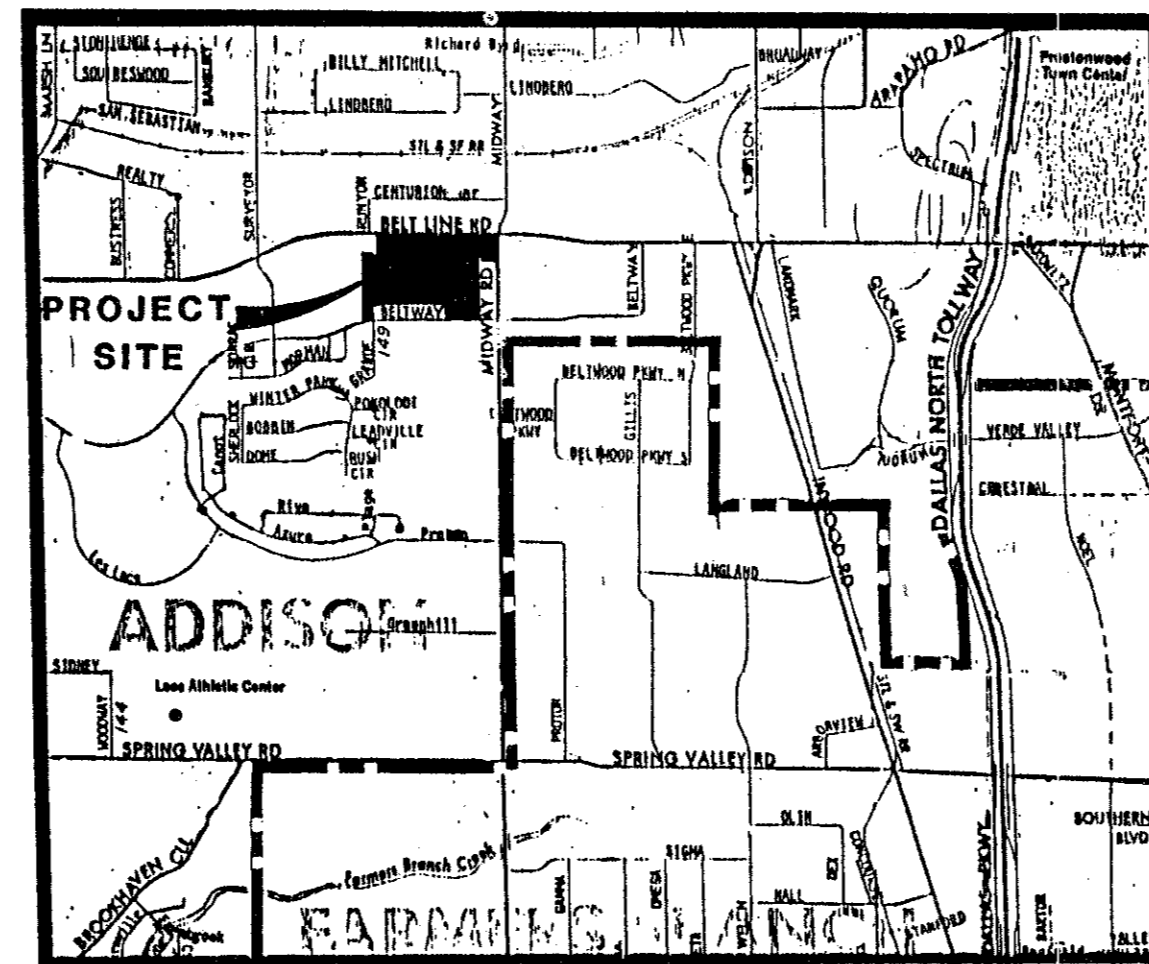

VICINITY MAP

ENGINEER
DUNAWAY ASSOCIATES, Inc.
1501 MERRIMAC CIRCLE, SUITE 100
FORT WORTH, TEXAS 76107-6512
PH: (817) 335-1121



Thomas O. Huffhines
THOMAS O. HUFFHINES, P.E.

"AS BUILT PLANS"

CERTIFICATION

I HEREBY CERTIFY THAT THIS PLAN, SPECIFICATION, OR REPORT WAS PREPARED BY ME OR UNDER MY DIRECT SUPERVISION, AND THAT I AM A DULY REGISTERED PROFESSIONAL ENGINEER UNDER THE LAWS OF THE STATE OF TEXAS.

BY: *Thomas O. Huffhines*
THOMAS O. HUFFHINES

DATE: 3/3/92 REGISTRATION No. 50981

APPROVAL: _____ DATE

APPROVAL: _____ DATE

GENERAL NOTES

- A. Prior to final acceptance by the Town of Addison.
A Texas Registered Professional engineer shall certify that the project was constructed in accordance with the plans and specifications approved by the Town of Addison.
The owner shall provide 1 reproducible set of as-builts (sealed and certified by a Texas Registered Engineer) and 2 blue line sets.
A one year maintenance bond is required for the internal subdivision infrastructure.
Contractor shall demonstrate that the water and sanitary sewer systems meet the proper pressure, bacteria, and mandrel tests. In addition, the owner shall provide a VIS format video tape of the sanitary sewer.
- B. Prior to starting construction, the contractor shall contract the utility companies to locate existing facilities. These include but may not be limited to the following:
1) Town of Addison
2) Lone Star Gas
3) Southwestern Bell
4) Storer Cable
5) Planned Cable Systems (MORCO)
6) TU Electric
- C. Prior to beginning construction, the owner or his authorized representative shall convene a Pre-Construction Conference between the Town of Addison, Consulting Engineer, Contractor(s), utility companies and any other affected parties. Notify Bruce Ellis 450-2847 at least 48-hours prior to the time of the conference and 48-hours prior to beginning of construction.
- D. Any existing pavement, curbs, and/or sidewalks damaged or removed will be repaired by the contractor at their expense.
- E. Lot pins shall be in place during construction and prior to final acceptance. Concrete monuments shall be placed as shown on the final plat and iron pins shall be placed at block corners, curve points and angle points in public right-of-way. Concrete monuments shall be six (6) inches in diameter and twenty-four (24) inches long. An iron rod one-half inch in diameter embedded at least three (3) inches in the monument at the exact intersection point of the monument. The monuments shall be set at such an elevation that after construction, the top of the monument will be not less than twelve (12) inches below the ground surface.
- F. The contractor shall stamp a 2-inch "S" in the curb at the location of the sewer service line.
- G. At intersections that have valley drainage, the crown of the intersecting streets will culminate in a distance of 40 feet from the intersecting curb line unless otherwise noted.
- H. Temporary of permanent street barricades shall remain at all points of ingress and egress to prevent public use until such street received final acceptance.
- I. Contractor shall obtain a right-of-way permit by the Town of Addison for working within the public right-of-way.
- J. During construction, the owner shall provide a qualified geotechnical lab to perform materials testing during the construction, at the request of the Town of Addison.
- K. The contractor shall submit material sheets to the Town of Addison for approval prior to incorporating materials into the job.
- L. The utility contractor shall submit to the Town of Addison for approval a trench safety plan sealed by a registered professional engineer for the installation of utilities greater than five (5) feet in depth.

UTILITIES / CONTACTS

TOWN OF ADDISON		
PLANNING AND ZONING	CARMEN MORAN	(214) 450-7018
BUILDING INSPECTION	LYNN CHANDLER	(214) 450-2889
ENGINEERING	JOHN BAUMGARTNER	(214) 450-2886
UTILITIES	BRUCE ELLIS	(214) 450-2847
STREETS	ROBIN JONES	(214) 450-2849
ENVIRONMENTAL SERVICES	NEIL GAYDEN	(214) 450-2821
LANDSCAPE	SLADE STRICKLAND	(214) 450-2869
SIGNS	LES FOLSE	(214) 450-2823
FIRE DEPARTMENT	VERNON GILMORE	(214) 450-7209
POLICE DEPARTMENT	BRAD FREIS	(214) 450-7153
CITY MANAGER'S OFFICE	RON WHITEHEAD	(214) 450-7028
TAX ASSESSOR	ELAINE DIFIGLIA	(214) 450-7080
CITY ATTORNEY	LARRY McCALLUM	(214) 233-2833
UTILITY COMPANIES		
SOUTHWESTERN BELL	TIM BEIDELMAN	(214) 739-7644
T.U. ELECTRIC	TIM BRANCHEAU	(214) 323-8921
LONE STAR GAS	JEAN HOOKER	(214) 248-6671
PLANNED CABLE SYSTEMS	MARK HOLLAND	(214)
STORER CABLE SYSTEMS	DON TEMPLE	(214) 840-2388

NOTE:
SIGNAL LIGHT PLANS AT RUNYON ROAD
ARE A SEPERATE SET OF DRAWINGS

SHEET INDEX

- COVER SHEET
- DEVELOPMENT PLAN (REQUIREMENTS RELATED TO THE ZONING PLANNED DEVELOPMENT)
- SITE PLAN
- GRADING AND DRAINAGE PLAN
- DRAINAGE MAP AND CALCULATIONS
- UTILITY PLAN
- 6A ONSITE SAN-SEWER & STORM DRAIN PROFILE
- IRRIGATION PLAN
- IRRIGATION DETAILS
- LANDSCAPE PLAN
- LANDSCAPE DETAILS
- SITE CONSTRUCTION DETAILS
- CONSTRUCTION DETAILS
- CONSTRUCTION DETAILS
- CONSTRUCTION DETAILS
- CONSTRUCTION DETAILS
- CONSTRUCTION DETAILS
- OFF SITE SEWER IMPROVEMENTS
- OFF SITE SEWER IMPROVEMENTS
- OFF SITE ACCESS ROAD IMPROVEMENTS
- TRAFFIC CONTROL PLAN
- WEST DECELERATION LANE
- EAST DECELERATION LANE
- BOUNDARY SURVEY
- TOPOGRAPHIC SURVEY

No.	DATE	REVISION DESCRIPTION
1	4/29/92	ADDED SHT. 6A SAN-SEWER & STORM DRAIN PROFILE & SHT. 20 TRAFFIC CONTROL PLAN
2	5/26/92	ADDED GENERAL NOTES
3	4/7/92	REVISED S.S. GRADES & M.H. LOCATIONS

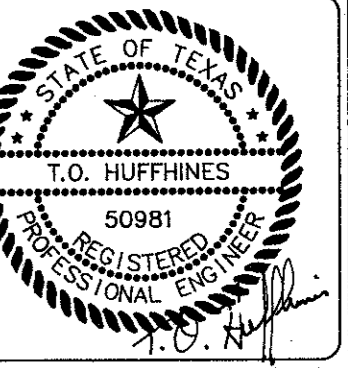

DATE: 3/3/92

COVER SHEET

WAL-MART
SAM'S CLUB
BELTLINE + MIDWAY
ADDISON, TEXAS

DUNAWAY ASSOCIATES, Inc.
ENGINEERS - PLANNERS - SURVEYORS
1501 MERRIMAC CIRCLE, SUITE 100
FORT WORTH, TEXAS 76107
PH: (817) 335-1121 FAX: (817) 335-1121

JOB No.	9102800
DESIGNED BY:	T.S.G.
CHECKED BY:	T.O.H.
DATE:	FEB. 6, 1992
SCALE:	1" = 50'-0"
SHEET	1 OF 24 SHEETS