

GENERAL NOTES

1. Reinforced concrete sidewalk shall be 5 or 7 feet wide, a minimum of four (4) inches thick and shall be 3000 psi at 28 days (5 sack mix). Unless noted otherwise.
2. Chamfer all exposed edges of concrete (1/4) inch.
3. All bar dimensions are given as center to center of bars and are located as shown.
4. All reinforcing steel shall be No. 3 on 18 inch centers longitudinally, 24 inch centers transversely and shall conform to the requirements of ASTM A-615, Grade 60.
5. 1" thick min. fine, washed sand cushion shall be free from organic materials or clays and shall be used for grade adjustment.
6. Subgrade shall be compacted to a density not less than 95% at optimum moisture.
7. Tooled joints (contraction joints) shall be on five (5) foot centers and shall be round one-fourth (1/4) inch radius.
8. A one-half (1/2) inch expansion joint shall be placed every eight (8) tooled joints, and where works abut old work, or where new work is constructed adjacent to other concrete, a one-half inch expansion joint shall be used where sidewalk is adjacent to curb, the expansion joint shall be made of pre-molded bituminous expansion joint filler or redwood with silicone sealant. See Specs.
9. Sidewalks shall be finished by lightly brooming surface transversely to direction of main traffic or where adjacent sidewalks differ from this standard, new sidewalks shall conform to adjacent sidewalk (e.g. exposed aggregate).
10. Cross slope walk one-fourth (1/4) inch per foot towards curb or as shown on the drawings to provide drainage.

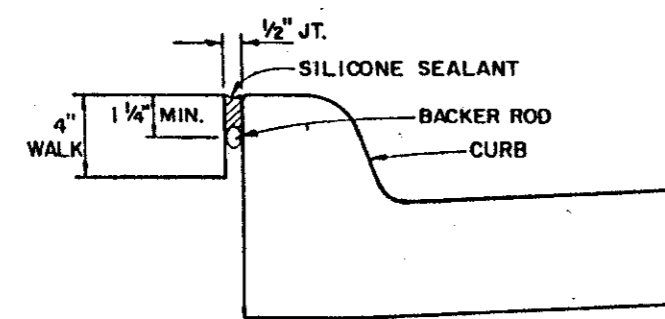

EXPANSION JOINT DETAIL

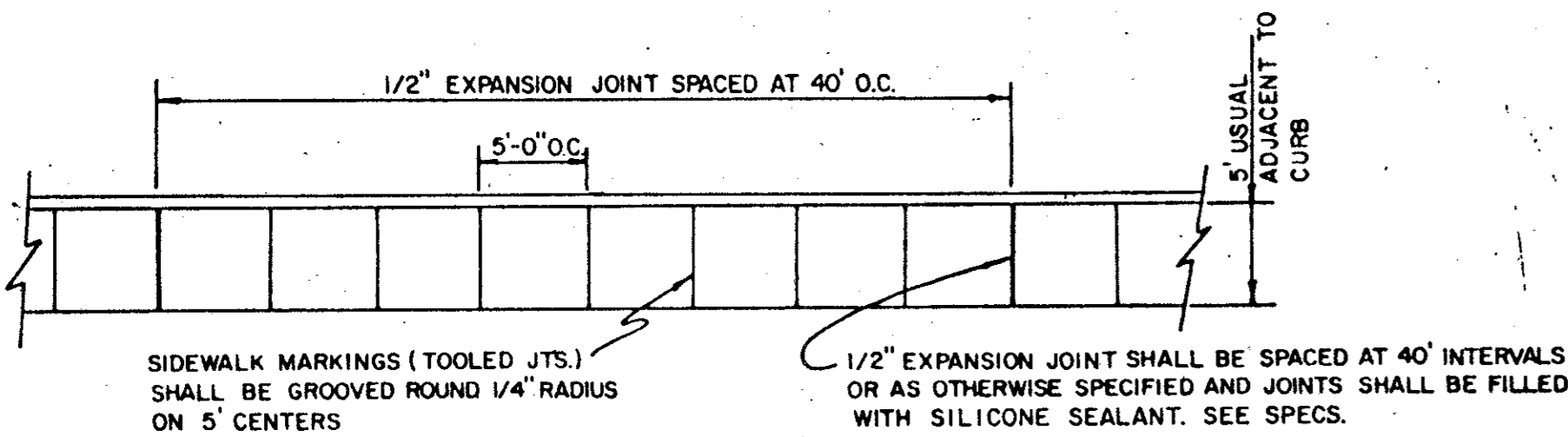

PLAN

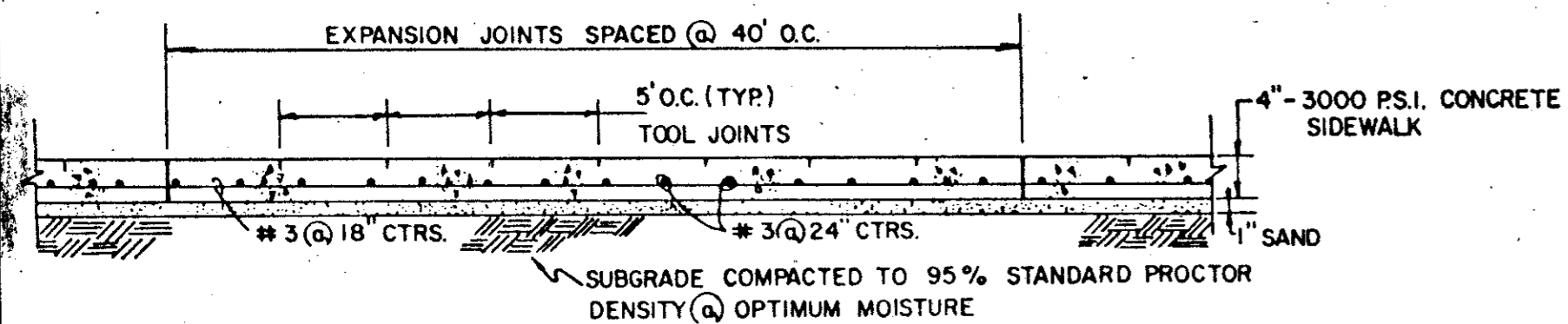

SIDE ELEVATION

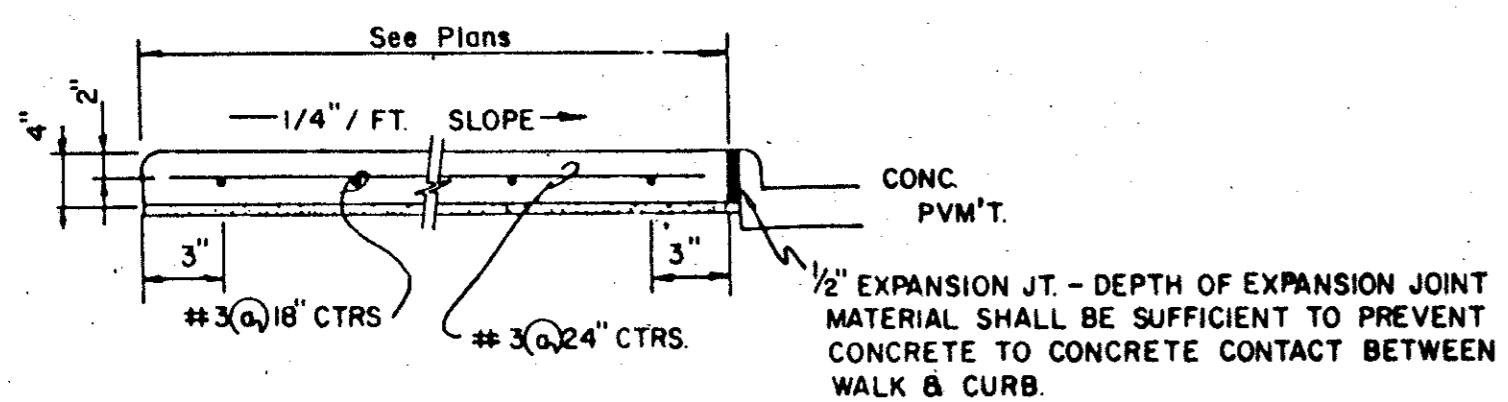

CONCRETE SIDEWALK DETAIL

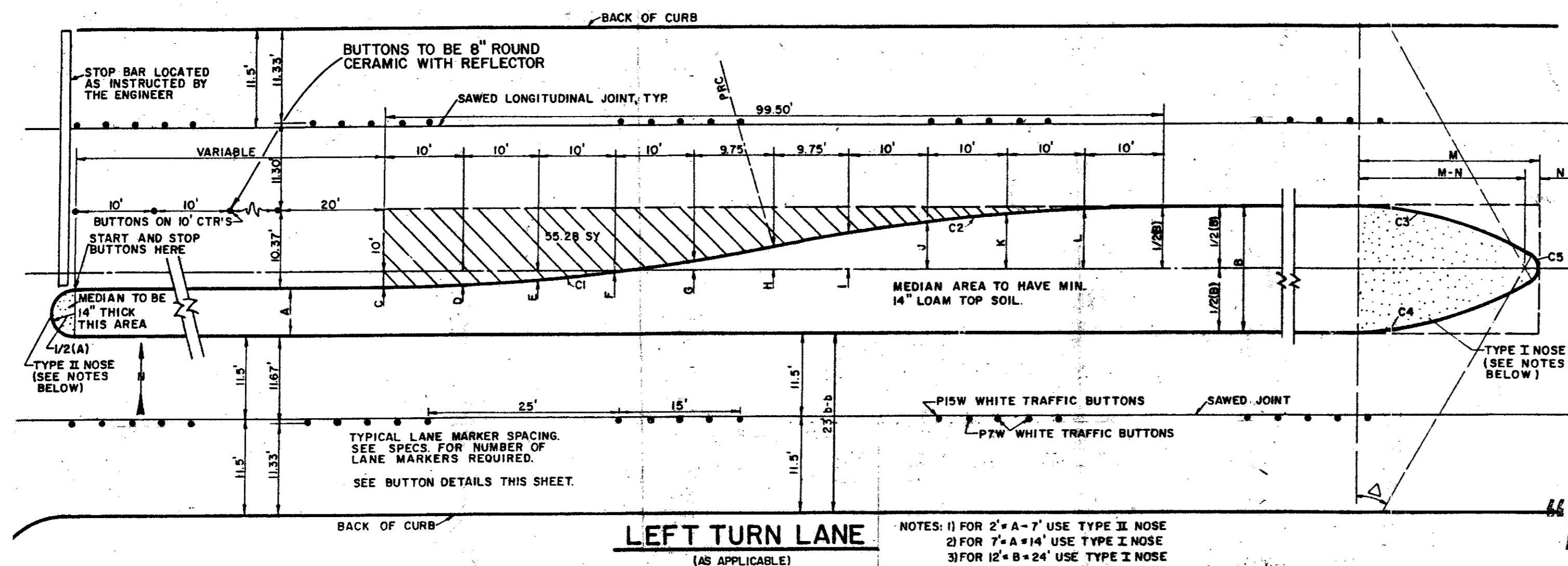

NOTES: 1) FOR 2'-A-7' USE TYPE II NOSE
2) FOR 7'-A-14' USE TYPE I NOSE
3) FOR 12'-B-24' USE TYPE I NOSE

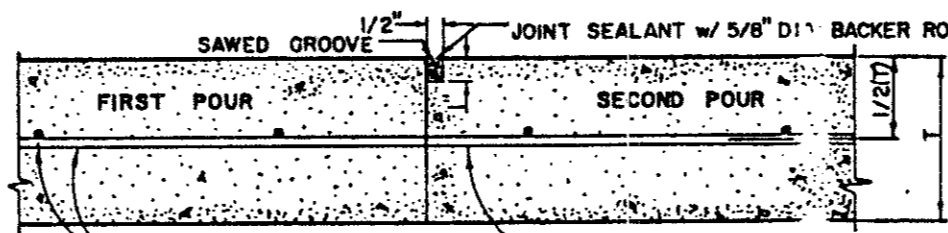
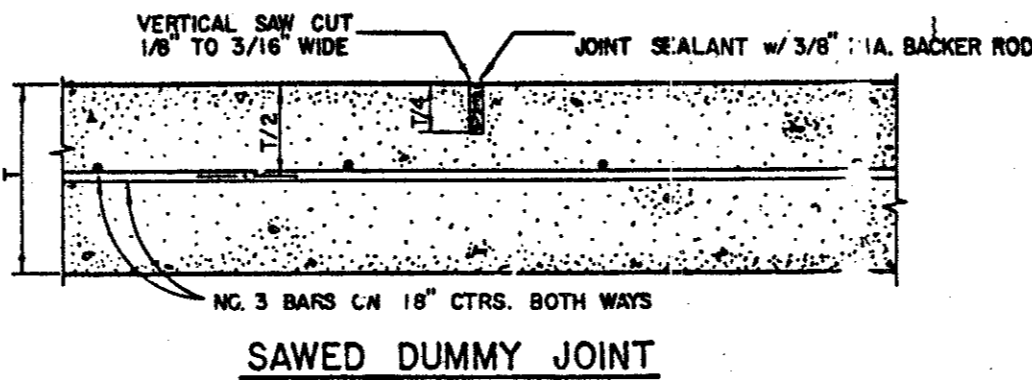

CONSTRUCTION JOINT FOR 6 INCH PAVEMENT

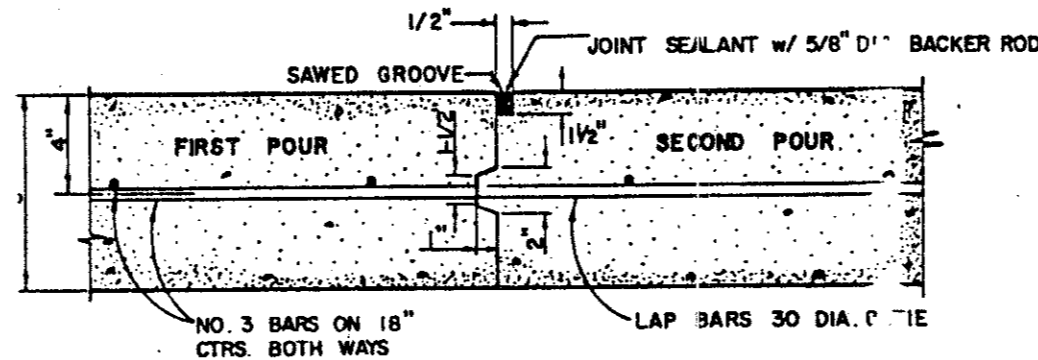

CONSTRUCTION JOINT FOR 8 INCH PAVEMENT

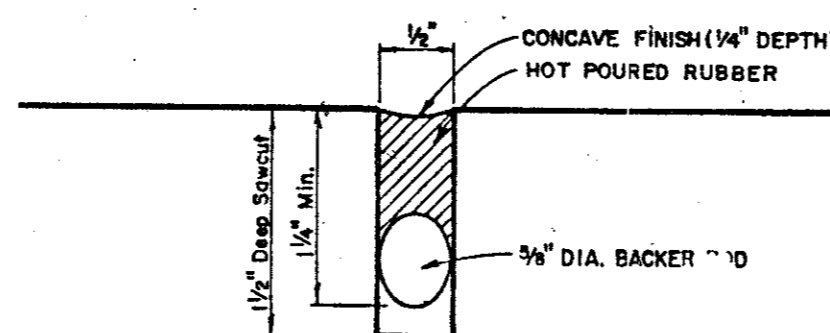

TYPICAL JOINT DETAIL

GENERAL NOTES

- A. GENERAL PAVEMENT THICKNESS FOR STREETS SHALL BE AS SPECIFIED BELOW IN SPECIAL NOTES.
- B. STANDARD SPECIFICATIONS REINFORCED CONCRETE PAVEMENTS
 1. ALL CURBS SHALL BE PLACED INTEGRAL WITH PAVEMENT
 2. CURBS SHALL HAVE THE SAME COMPRESSIVE STRENGTH AS SPECIFIED FOR THE CONCRETE PAVEMENT.
 3. DETAIL AND ARRANGEMENT OF JOINTS, ALL TYPES, SHALL BE AS SHOWN ON THE STANDARD CONSTRUCTION DETAILS, OR AS APPROVED BY ENGINEER.
 4. BAR LAPS SHALL BE 30 DIAMETERS.
- C. BAR CHAIRS OR AN APPROVED SUPPORTING DEVICE SHALL BE FURNISHED.
- D. SUBGRADE TO BE 6% CEMENT OR 7% LIME STABILIZATION
- E. TURN LANE JOINT SPACING SHALL MATCH THE EXISTING ROADWAY JOINT SPACING

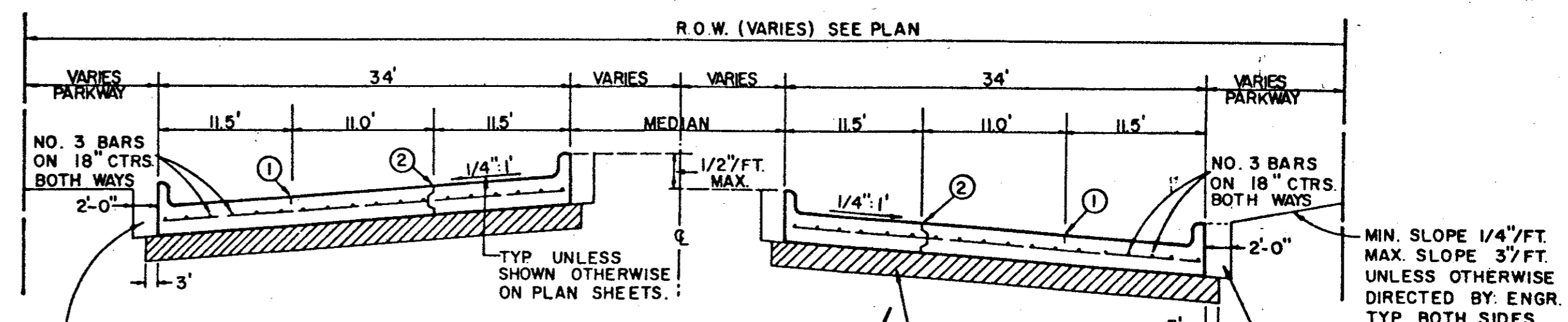

REGULAR SECTION

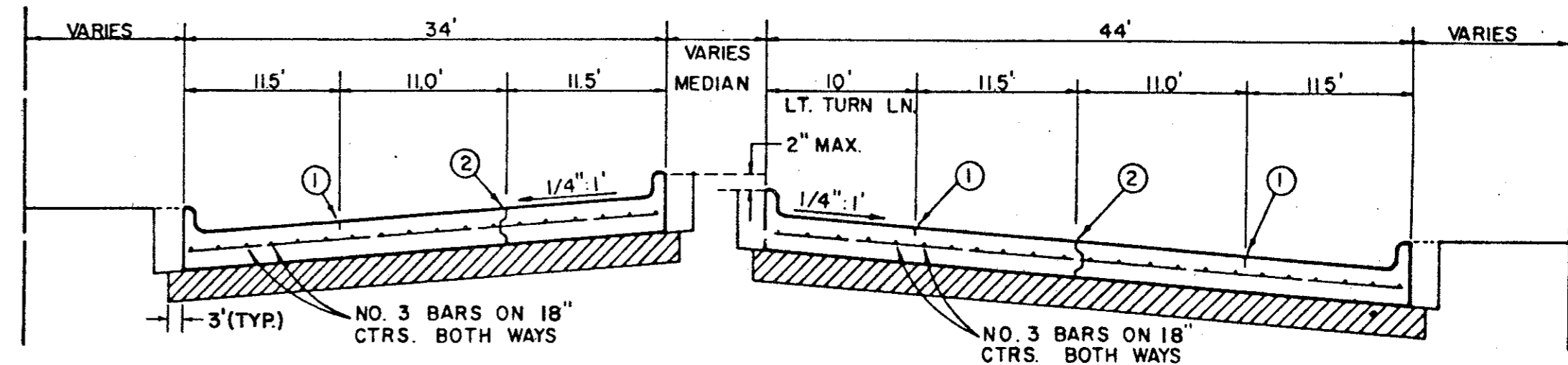

**LEFT TURN SECTION
MAJOR ARTERIAL**

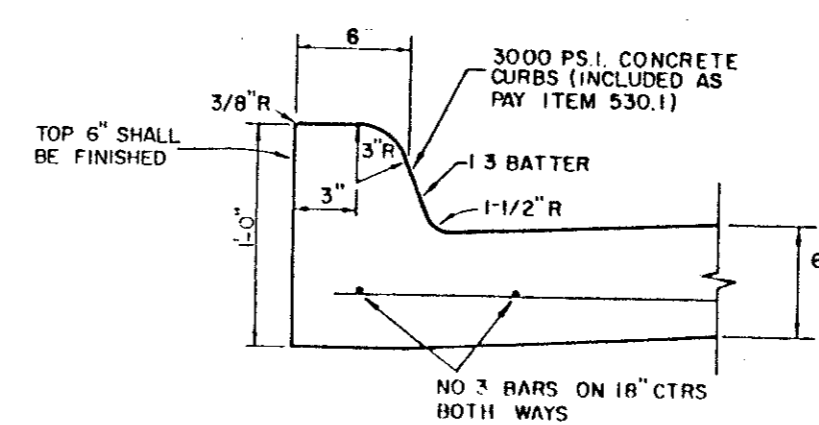

STANDARD CURB

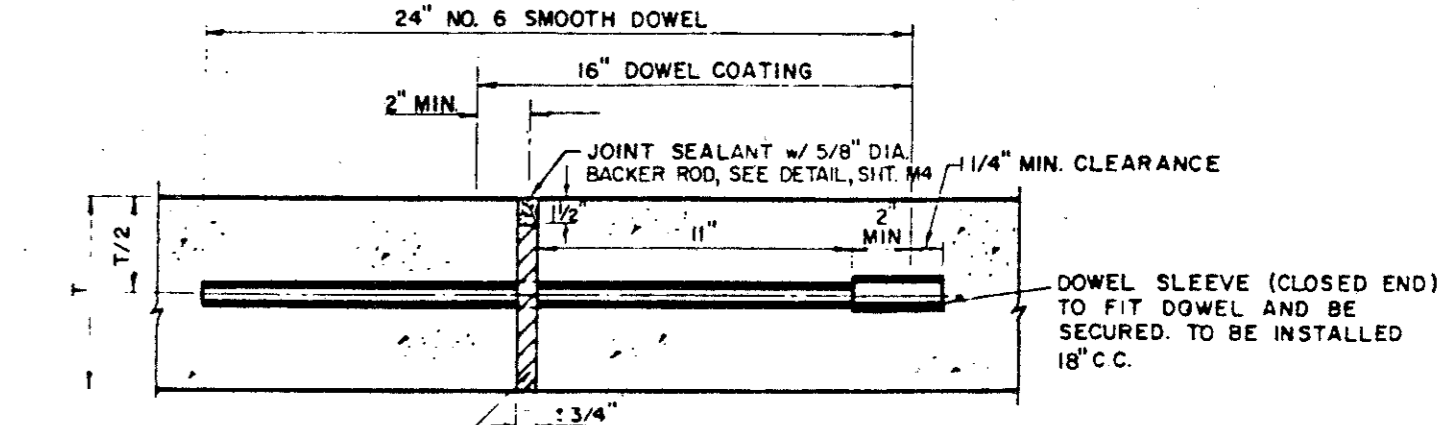

TRANSVERSE EXPANSION JOINT

NOTE: DOWELS AND REINFORCING BARS SHALL BE SUPPORTED BY AN APPROVED DEVICE

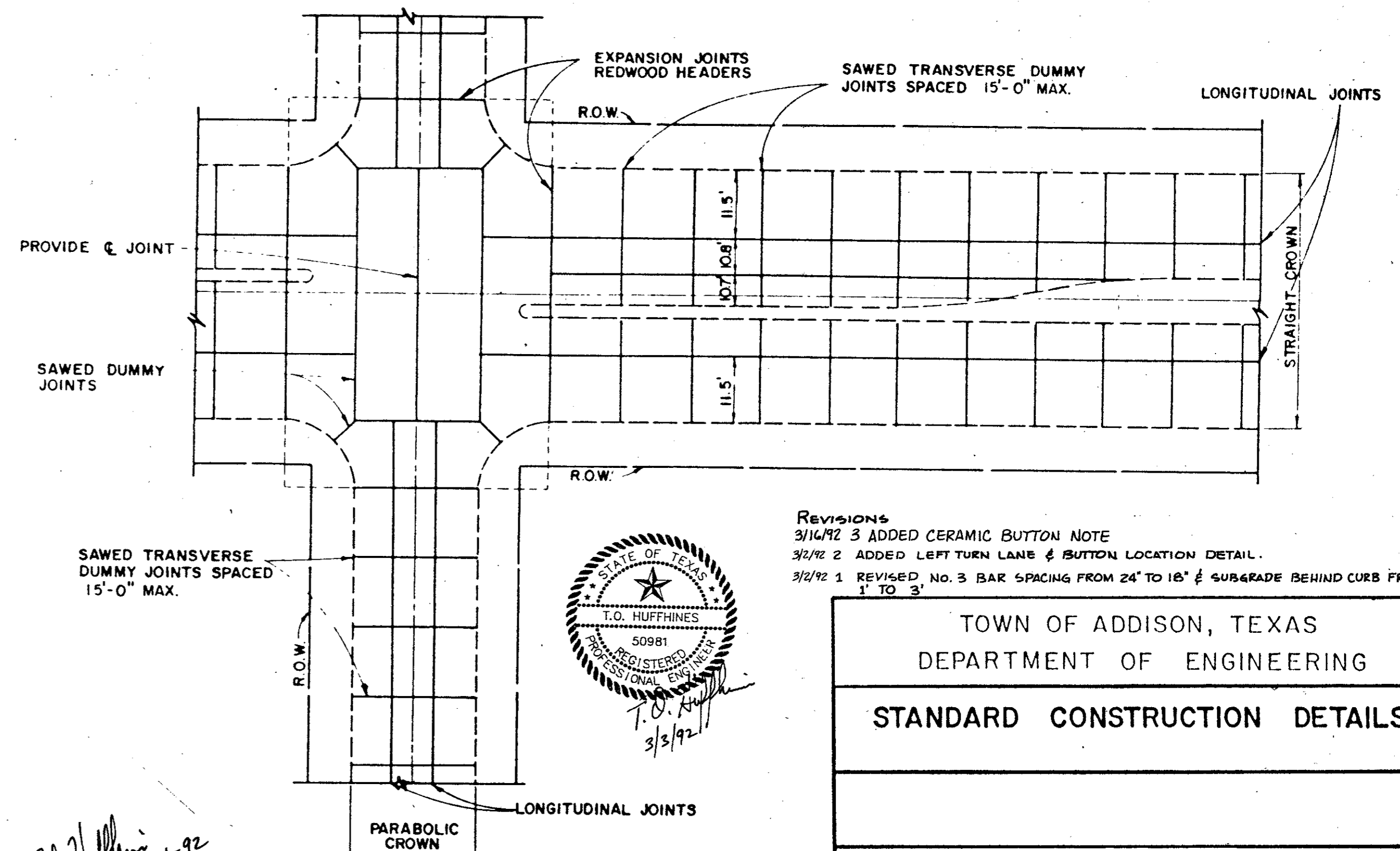

SPACING DIAGRAM FOR TRANSVERSE JOINTS

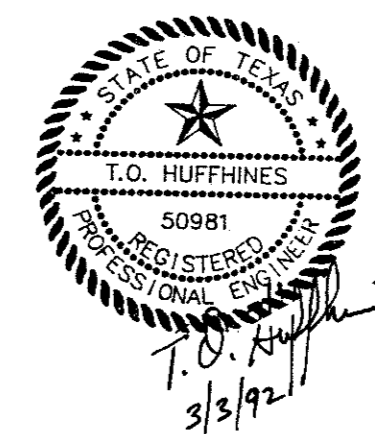

Revisions:
3/14/92 3 ADDED CERAMIC BUTTON NOTE
3/2/92 2 ADDED LEFT TURN LANE & BUTTON LOCATION DETAIL.
3/2/92 1 REVISED, NO. 3 BAR SPACING FROM 24" TO 15" & SUBGRADE BEHIND CURB FROM 1" TO 3"

TOWN OF ADDISON, TEXAS
DEPARTMENT OF ENGINEERING
STANDARD CONSTRUCTION DETAILS

Designed -	Drawn -	Date - AUGUST, 1991	Job No. -
Approved -	Checked -	Scale -	Sheet 12 of 24