

BELTLINE ROAD

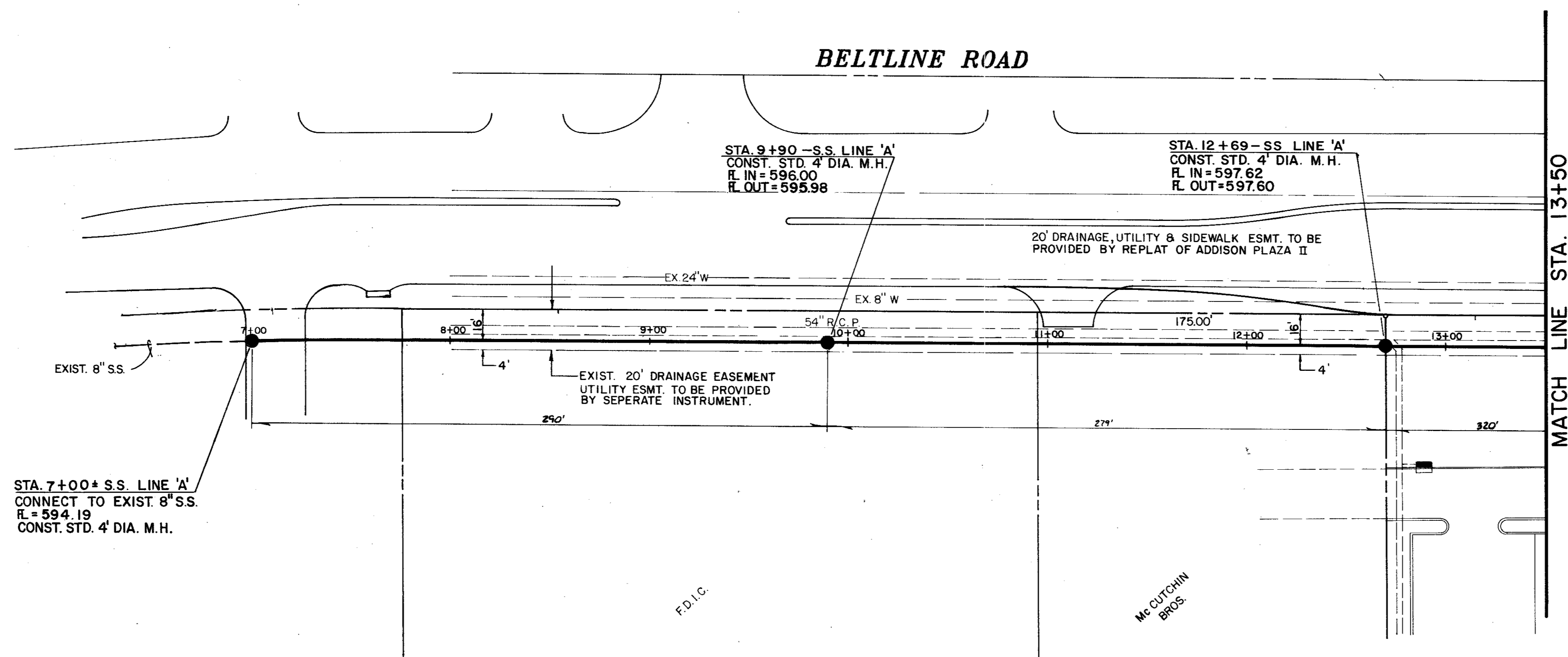

MATCH LINE STA. 13+50

STA. 7+00+ S.S. LINE 'A'  
CONNECT TO EXIST. 8" S.S.  
R.L. = 594.19  
CONST. STD. 4' DIA. M.H.

STA. 9+90 - S.S. LINE 'A'  
CONST. STD. 4' DIA. M.H.  
R. IN = 596.00  
R. OUT = 595.98

STA. 12+69 - S.S. LINE 'A'  
CONST. STD. 4' DIA. M.H.  
R. IN = 597.62  
R. OUT = 597.60

20' DRAINAGE, UTILITY & SIDEWALK ESMT. TO BE PROVIDED BY REPLAT OF ADDISON PLAZA II

EXIST. 20' DRAINAGE EASEMENT UTILITY ESMT. TO BE PROVIDED BY SEPERATE INSTRUMENT.

F.D.I.C.

Mc CUTCHIN BROS.

NOTE:  
TIE IN OF SANITARY SEWER SERVICE SUBJECT TO CITY APPROVAL

NOTE:  
ALL WATER LINES TO BE PUBLIC WITH DEDICATED EASEMENTS

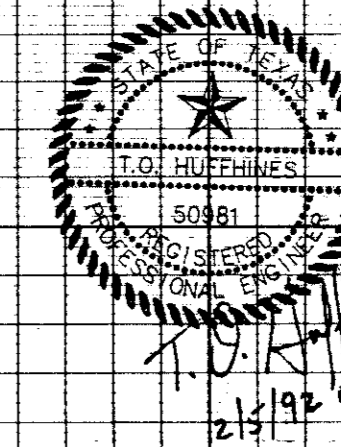
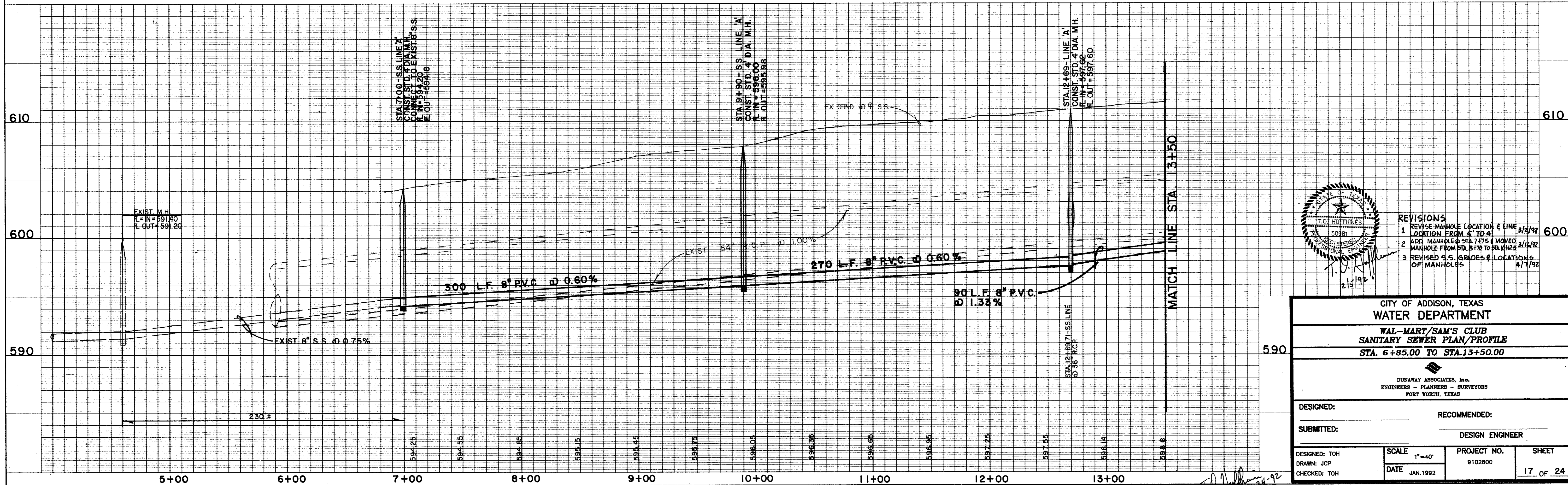
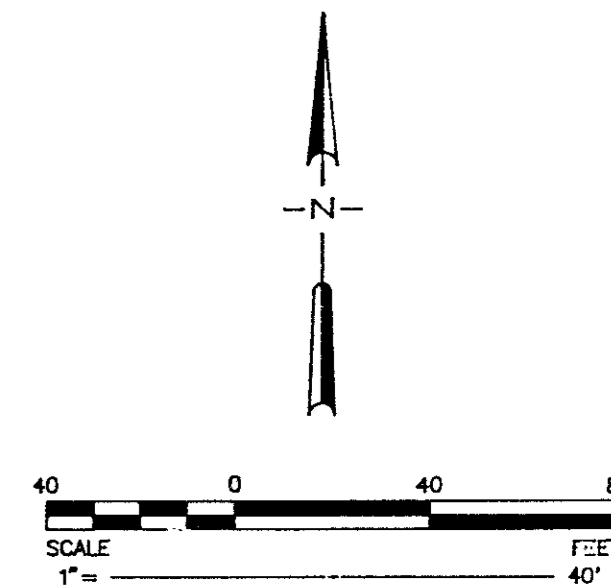

- REVISIONS
1. REVISE MANHOLE LOCATION & LINE LOCATION FROM 4' TO 4' 5/2/92
  2. ADD MANHOLE @ STA. 7+75 & MOVED MANHOLE FROM STA. 8+78 TO RA. H.H.S. 2/12/92
  3. REVISED S.S. GRADES & LOCATIONS OF MANHOLES 4/7/92

CITY OF ADDISON, TEXAS WATER DEPARTMENT			
WAL-MART/SAM'S CLUB SANITARY SEWER PLAN/PROFILE STA. 6+85.00 TO STA. 13+50.00			
DUNAWAY ASSOCIATES, Inc. ENGINEERS - PLANNERS - SURVEYORS FORT WORTH, TEXAS			
DESIGNED:	RECOMMENDED:		
SUBMITTED:	DESIGN ENGINEER		
DESIGNED: TOH	SCALE: 1"=40'	PROJECT NO. 9102800	SHEET 17 OF 24
DRAWN: JCP	DATE: JAN. 1992		
CHECKED: TOH			

**"AS BUILT PLANS"**  
REVISED SAN. SEWER MANHOLE LOCATIONS. 12-29-92