

SAM'S CLUB
136,187 S.F.
F.F.=623.00

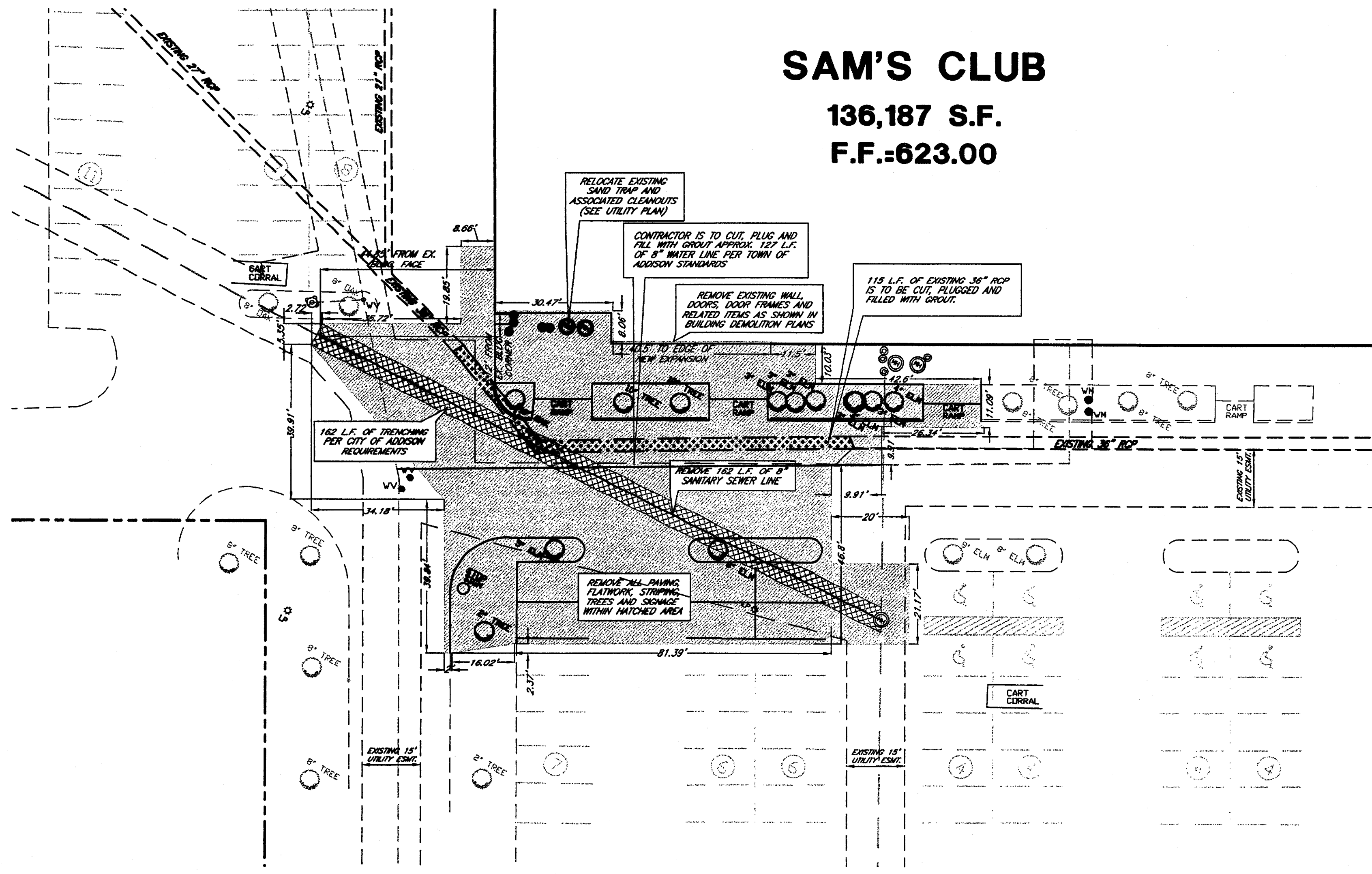
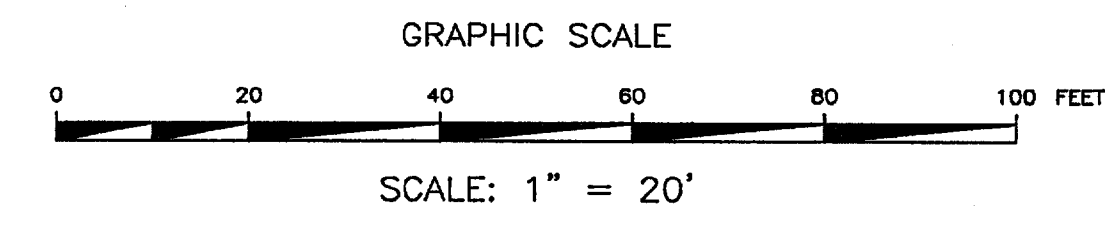

RECORD DRAWINGS
The intent of the owner and engineer was to construct these facilities according to these plans as approved by the Town of Addison. The lines and grades were set on the ground for construction according to said plans. The Town of Addison inspected the construction. Neither the owner nor the engineer verified lines or grades after construction. We are not aware of any changes or revisions to these plans during construction except as noted.

****CAUTION-NOTICE TO CONTRACTOR****
THE CONTRACTOR IS SPECIFICALLY CAUTIONED THAT THE LOCATION AND/OR ELEVATION OF EXISTING UTILITIES AS SHOWN ON THESE PLANS ARE BASED ON RECORDS OF THE VARIOUS UTILITY COMPANIES, AND, WHERE POSSIBLE, MEASUREMENTS TAKEN IN THE FIELD. THE INFORMATION IS NOT TO BE RELIED ON AS BEING EXACT OR COMPLETE. THE CONTRACTOR MUST CALL THE APPROPRIATE UTILITY COMPANY AT LEAST 48 HOURS BEFORE ANY EXCAVATION TO REQUEST EXACT FIELD LOCATION OF UTILITIES. IT SHALL BE THE RESPONSIBILITY OF THE CONTRACTOR TO RELOCATE ALL EXISTING UTILITIES WHICH CONFLICT WITH THE PROPOSED IMPROVEMENTS SHOWN ON THESE PLANS.

THESE PLANS SUBJECT TO REVIEW BY JURISDICTIONAL ENTITIES

BENCHMARK
SQUARE CUT ON HEADWALL NORTH OF RAILROAD, EAST SIDE OF MIDWAY.
ELEVATION=617.77

***** STOP! CALL BEFORE YOU DIG! *****
AS REQUIRED BY "THE TEXAS UNDERGROUND FACILITY DAMAGE PREVENTION AND SAFETY ACT" TEXAS ONE CALL SYSTEM MUST BE CONTACTED (800-245-4545) AT LEAST 48 HOURS PRIOR TO ANY EXCAVATION OPERATIONS BEING PERFORMED. IT IS THE CONTRACTOR'S RESPONSIBILITY TO CONTACT TEXAS ONE CALL SYSTEM.

****NOTICE TO CONTRACTOR****
TOPOGRAPHIC INFORMATION TAKEN FROM A TOPOGRAPHIC SURVEY BY A-1 SURVEYS, INC. THE CONTRACTOR(S) SHALL BE RESPONSIBLE FOR CONFIRMING THE LOCATION (HORIZONTAL AND VERTICAL) OF ANY BURIED CABLES, CONDUITS, PIPES AND STRUCTURES (STORM SEWER, SANITARY SEWER, WATER, GAS, TELEVISION, TELEPHONE, ETC.) WHICH IMPACT THE CONSTRUCTION SITE. THE CONTRACTOR(S) SHALL NOTIFY THE OWNER OF ANY DISCREPANCIES FOUND BETWEEN THE ACTUAL CONDITIONS VERSUS THE DATA CONTAINED IN THE CONSTRUCTION PLANS. ANY COSTS INCURRED AS THE RESULT OF NOT CONFIRMING THE ACTUAL LOCATION (HORIZONTAL AND VERTICAL) OF SAID CABLES, CONDUITS, PIPES, AND STRUCTURES SHALL BE BORNE BY THE CONTRACTOR. IF THE CONTRACTOR(S) DOES NOT ACCEPT THE EXISTING TOPOGRAPHY AS SHOWN ON THESE PLANS, WITHOUT EXCEPTION, HE SHALL HAVE MADE AT HIS EXPENSE A TOPOGRAPHIC SURVEY BY A REGISTERED PROFESSIONAL ENGINEER OR A REGISTERED PROFESSIONAL LAND SURVEYOR AND SUBMIT IT TO THE OWNER FOR REVIEW.

LEGEND

- LIMITS OF EXTERIOR DEMOLITION
- LIMITS OF SEWER TRENCHING
- TREES
- WATER VALVE
- LIGHT POLE
- MANHOLE
- WATER METER
- CLEANOUT
- FIRE HYDRANT
- EXISTING UTILITY BASEMENT TO BE ABANDONED BY SEPARATE INSTRUMENT

- DEMOLITION NOTES**
- CONTRACTOR IS RESPONSIBLE FOR PROTECTION OF ALL PROPERTY CORNERS AND PINS.
 - CONTRACTOR SHALL REMOVE PAVEMENT IN ACCORDANCE WITH SPECIFICATIONS.
 - CONTRACTOR IS RESPONSIBLE FOR REPAIRS OF DAMAGE TO ANY EXISTING IMPROVEMENTS DURING CONSTRUCTION, SUCH AS, BUT NOT LIMITED TO, DRAINAGE, UTILITIES, PAVEMENT, STRIPING, CURB, ETC. REPAIRS SHALL BE EQUAL TO OR BETTER THAN EXISTING CONDITIONS.
 - ALL WORK ON THIS PLAN SHALL BE DONE IN STRICT ACCORDANCE WITH SITEMARK SPECIFICATIONS.
 - CONTRACTOR SHALL COMPLY TO THE FULLEST EXTENT WITH THE LATEST STANDARDS OF OSHA DIRECTIVES OR ANY OTHER AGENCY HAVING JURISDICTION FOR EXCAVATION AND TRENCHING PROCEDURES. CONTRACTOR SHALL USE SUPPORT SYSTEMS, SLOPING, BENCHING OR OTHER MEANS OF PROTECTION. THIS IS TO INCLUDE, BUT NOT LIMITED, FOR ACCESS AND EGRESS FROM ALL EXCAVATION AND TRENCHING. CONTRACTOR IS RESPONSIBLE TO COMPLY WITH PERFORMANCE CRITERIA FOR OSHA.
 - CONTRACTOR SHALL BE RESPONSIBLE FOR PROTECTING THE PUBLIC DURING CONSTRUCTION, WHICH INCLUDES, BUT IS NOT LIMITED TO, CONSTRUCTION FENCING, BARRICADES, SIGNAGE, ETC.
 - CONTRACTOR IS RESPONSIBLE FOR VERIFYING ALL UTILITIES AND NOTIFYING THE APPROPRIATE UTILITY COMPANY PRIOR TO BEGINNING CONSTRUCTION.
 - CONTRACTOR SHALL VERIFY HORIZONTAL AND VERTICAL LOCATION OF ALL EXISTING UTILITIES PRIOR TO CONSTRUCTION.
 - ALL CONSTRUCTION SHALL BE IN ACCORDANCE WITH TOWN OF ADDISON SPECIFICATIONS.

| | | |
|-----------|---------|----|
| REVISIONS | DATE | BY |
| AS-BUILTS | 8/16/02 | JL |

ADAMS CONSULTING ENGINEERS, INC.
CIVIL - ENVIRONMENTAL ENGINEERS
2445 E Southlake Blvd., Suite 100 - Southlake, Texas 76082
Phone: (817) 928-8880 • Fax: (817) 928-7871

RAYMOND HARRIS AND ASSOCIATES ARCHITECTS
PROPOSED SAM'S CLUB BUILDING REMODEL
4150 BELTLINE ROAD
ADDISON, TEXAS
DEMOLITION PLAN

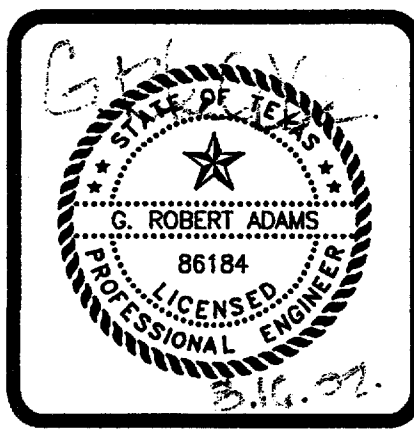

| | |
|---------------|----------|
| PROJECT MGR. | J.L. |
| PROJECT TECH. | J.S.H. |
| CHECKED BY | J.H.W. |
| JOB NO. | 2001.189 |
| SHEET NO. | 3 |