

REQUIREMENTS WITH

NEW TIRE SALES  
ADDITION  
2,340 S.F.

S 89°57'48" W 200.00'

REMOVE EXISTING PARKING LOT ISLANDS AS REQUIRED TO RELOCATE DRIVE AISLE

INSTALL NEW PARKING LOT LANDSCAPE ISLAND(S) TO MATCH EXISTING

TIRE SALES ADDITION

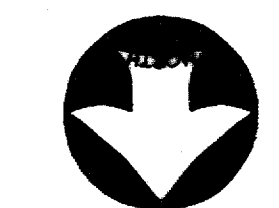

SCALE 1" = 20'-0"

LARGE TREES					
QUANTITY	SYMBOL	CALLOUT	COMMON NAME	SCIENTIFIC NAME	SIZE & CONDITION
10	+	LIVE OAK	Live Oak	<i>Quercus virginiana</i>	8" caliper, 10'-12' Ht / 4'-5' spread, B&B straight trunk
3	•	CEDAR ELM	Cedar Elm	<i>Ulmus crassifolia</i>	8" caliper, 10'-12' Ht / 4'-5' spread, B&B straight trunk
GROUNDCOVER / VINES					
QUANTITY	SYMBOL	CALLOUT	COMMON NAME	SCIENTIFIC NAME	SIZE AND CONDITION
AS SHOWN	■	SOD	Common Bermuda Grass	<i>Cynodon dactylon</i>	Sod refer to specifications

LANDSCAPE CONTRACTOR SHALL VERIFY ALL PLANT QUANTITIES

TABULATIONS	
TREE MITIGATION PROTECTED TREES REMOVED (4" L.O., 8" & 4" PEAR, 6", 7" C.E.)	34 CAL. INCHES
TREES TO BE PLANTED (18-3")	34 CAL. INCHES

RECORD DRAWINGS:  
THE INTENT OF THE OWNER AND ENGINEER WAS TO CONSTRUCT THESE FACILITIES ACCORDING TO THESE PLANS AS APPROVED BY THE CITY OF ADDISON. THE LINES AND GRADES WERE SET ON THE GROUND FOR CONSTRUCTION ACCORDING TO SAID PLANS. THE CITY OF ADDISON INSPECTED THE CONSTRUCTION. NEITHER THE OWNER NOR THE ENGINEER VERIFIED LINES OR GRADES AFTER CONSTRUCTION. WE ARE NOT AWARE OF ANY CHANGES OR REVISIONS TO THESE PLANS DURING CONSTRUCTION EXCEPT AS NOTED.

BY: *Michael Ramsey* MICHAEL RAMSEY, R.L.A. DATE: 8/16/02

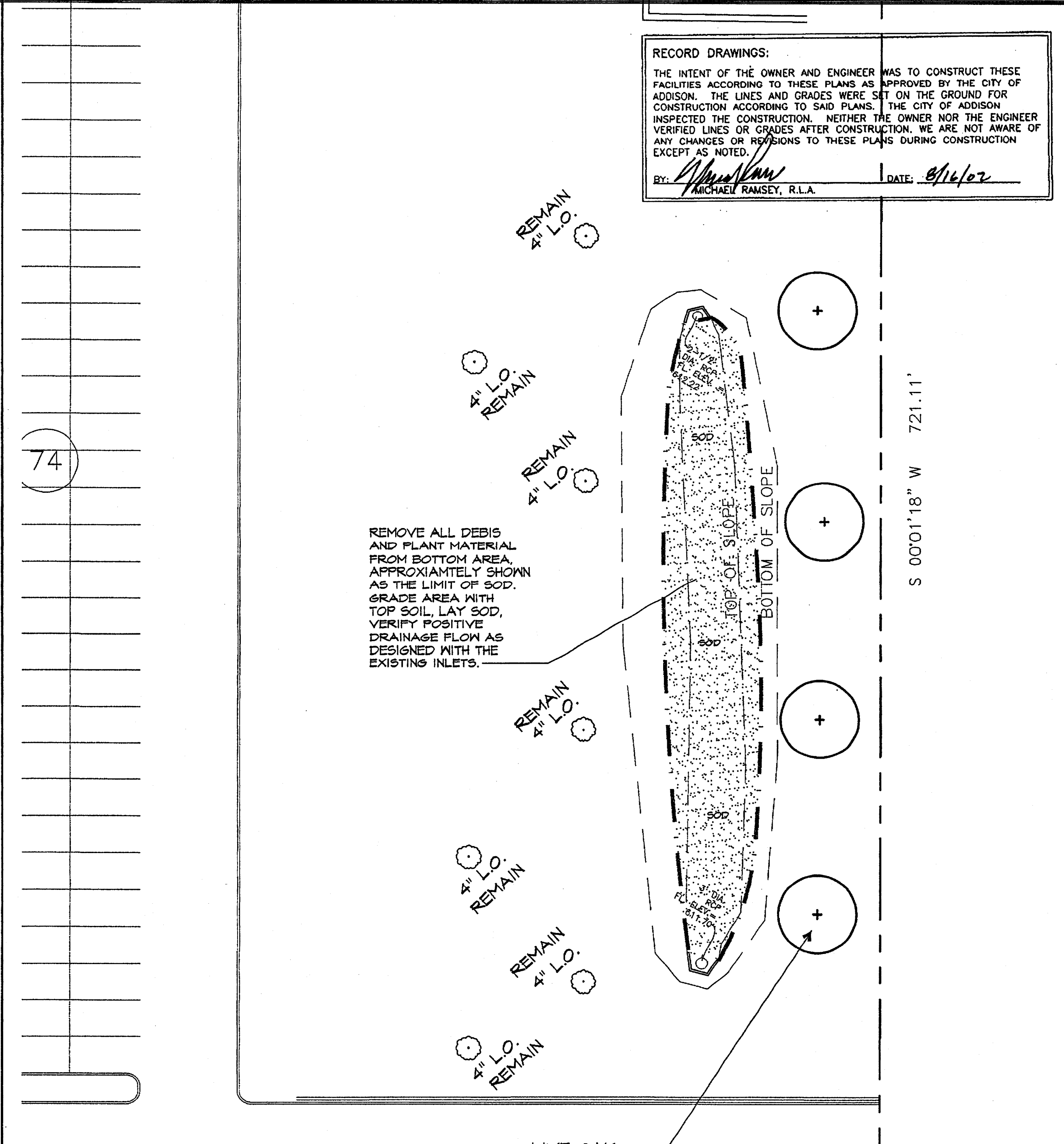

REMOVE ALL DEBRIS AND PLANT MATERIAL FROM BOTTOM AREA, APPROXIMATELY SHOWN AS THE LIMIT OF SOD. GRADE AREA WITH TOP SOIL, LAY SOD, VERIFY POSITIVE DRAINAGE FLOW AS DESIGNED WITH THE EXISTING INLETS.

REMOVE ALL DEBRIS AND PLANT MATERIAL FROM BOTTOM AREA, APPROXIMATELY SHOWN AS THE LIMIT OF SOD. GRADE AREA WITH TOP SOIL, LAY SOD, VERIFY POSITIVE DRAINAGE FLOW AS DESIGNED WITH THE EXISTING INLETS.

DETENTION PONDS



SCALE 1" = 20'-0"  
JAN. 3, 2002

REVISIONS	DATE	BY

GRUBBS RAMSEY, INC.  
17811 DALLAS PARKWAY, STE 220  
DALLAS, TEXAS 75248  
PHONE (972) 267-2574  
FAX (972) 267-2474

RAYMOND HARRIS AND ASSOCIATES ARCHITECTS  
PROPOSED SAM'S CLUB BUILDING REMODEL  
BELTLINE ROAD  
ADDISON, TEXAS

LANDSCAPE PLAN



PROJECT MGR. GFI  
PROJECT TECH. GFI  
CHECKED BY GFI  
JOB NO.  
SHEET NO. L2  
OF 5