

REQUIREMENTS WITH

**NEW TIRE SALES
ADDITION**
2,340 S.F.

EXISTING CONTROLLER LOCATED
UPSTAIRS, IF OPEN STATIONS AVAILABLE.

EXEMPT
6-3\" WAX MYRTLES

S 89°57'48\" W 200.00'

REMOVE EXISTING PARKING LOT
ISLANDS AS REQUIRED TO
RELOCATE DRIVE AISLE

INSTALL NEW PARKING LOT
LANDSCAPE ISLAND(S) TO MATCH
EXISTING

REPAIR AND CONNECT
TO EXISTING PIPING.

4' DIA. MANHOLE

EXISTING PARKING
POLE TO REMAIN

TIRE SALES ADDITION



SCALE 1\" = 20'-0\"

RECORD DRAWINGS:
THE INTENT OF THE OWNER AND ENGINEER WAS TO CONSTRUCT THESE FACILITIES ACCORDING TO THESE PLANS AS APPROVED BY THE CITY OF ADDISON. THE LINES AND GRADES WERE SET ON THE GROUND FOR CONSTRUCTION ACCORDING TO SAID PLANS. THE CITY OF ADDISON INSPECTED THE CONSTRUCTION. NEITHER THE OWNER NOR THE ENGINEER VERIFIED LINES OR GRADES AFTER CONSTRUCTION. WE ARE NOT AWARE OF ANY CHANGES OR REVISIONS TO THESE PLANS DURING CONSTRUCTION EXCEPT AS NOTED.

BY: *Michael Ramsey* DATE: 8/16/02
MICHAEL RAMSEY, R.L.A.

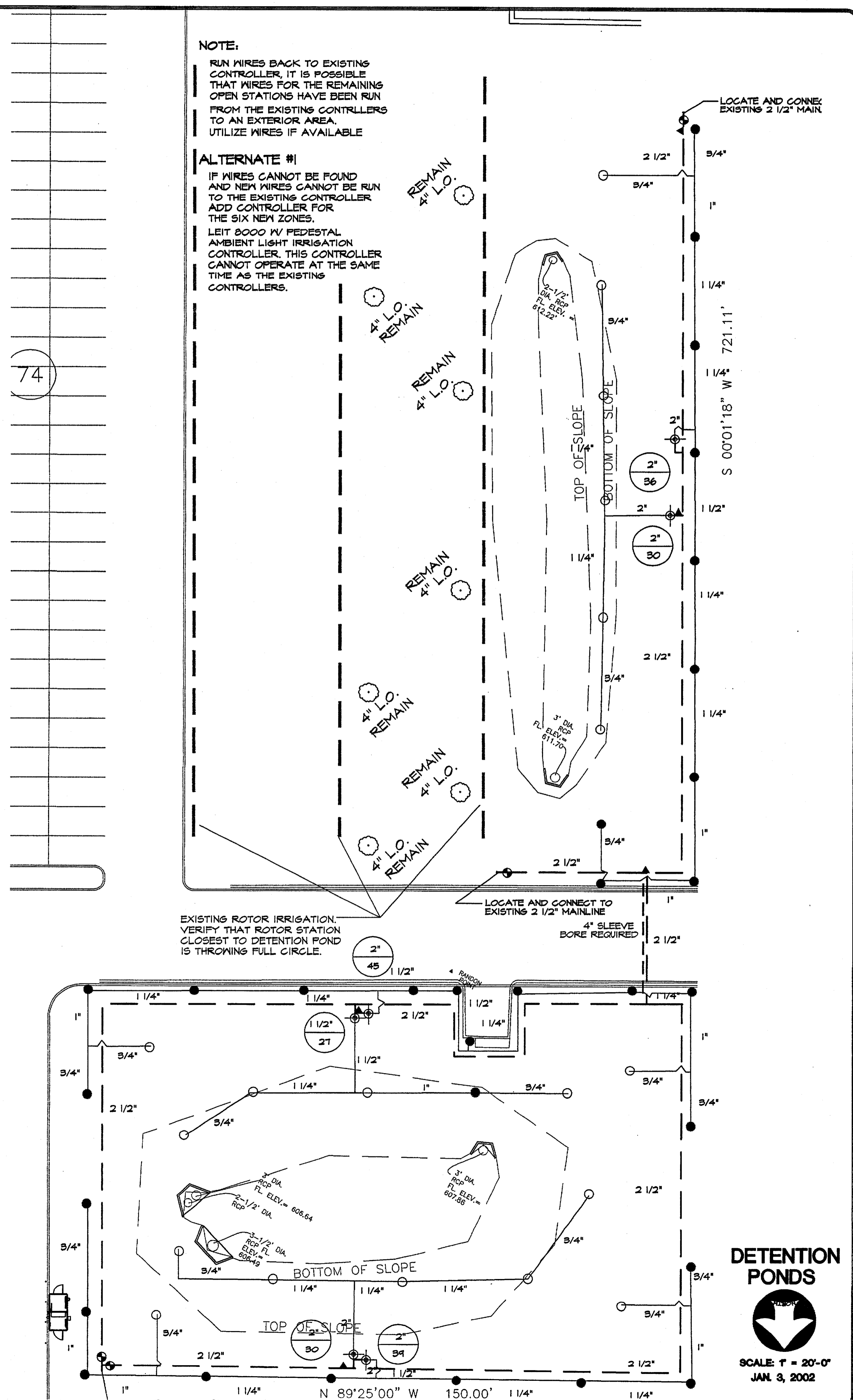

NOTE:
RUN WIRES BACK TO EXISTING CONTROLLER. IT IS POSSIBLE THAT WIRES FOR THE REMAINING OPEN STATIONS HAVE BEEN RUN FROM THE EXISTING CONTROLLERS TO AN EXTERIOR AREA. UTILIZE WIRES IF AVAILABLE.

ALTERNATE #1
IF WIRES CANNOT BE FOUND AND NEW WIRES CANNOT BE RUN TO THE EXISTING CONTROLLER, ADD CONTROLLER FOR THE SIX NEW ZONES. LEIT 8000 W/ PEDESTAL AMBIENT LIGHT IRRIGATION CONTROLLER. THIS CONTROLLER CANNOT OPERATE AT THE SAME TIME AS THE EXISTING CONTROLLERS.

EXISTING ROTOR IRRIGATION. VERIFY THAT ROTOR STATION CLOSEST TO DETENTION POND IS THROWING FULL CIRCLE.

LOCATE AND CONNECT TO EXISTING 2 1/2\" MAINLINE
4\" SLEEVE BORE REQUIRED

**DETENTION
PONDS**

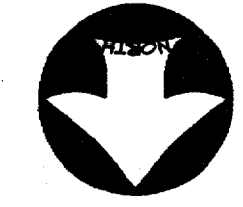

SCALE 1\" = 20'-0\"
JAN 3, 2002

BY	
DATE	
REVISIONS	

IRRIGATION SPECIALIST
JOHN WINGFIELD - (972) 601-3819

RAYMOND HARRIS AND ASSOCIATES ARCHITECTS
PROPOSED SAM'S CLUB BUILDING REMODEL
BELTLINE ROAD
ADDISON, TEXAS

FRIGATION PLAN

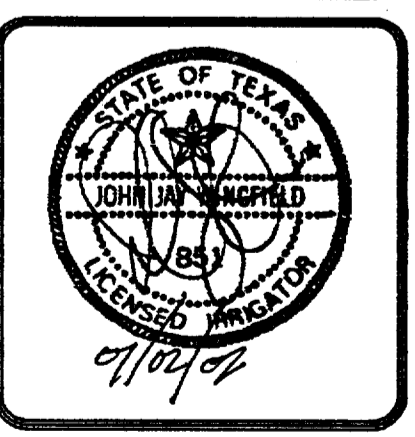

PROJECT MGR.	JW
PROJECT TECH.	JW
CHECKED BY	JW
JOB NO.	
SHEET NO.	L4

OF 5