

TIRE SALES ADDITION

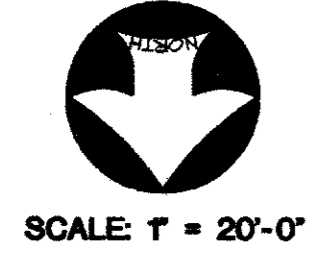

LARGE TREES					
QUANTITY	SYMBOL	CALLOUT	COMMON NAME	SCIENTIFIC NAME	SIZE & CONDITION
10	+	LIVE OAK	Live Oak	<i>Quercus virginiana</i>	3" caliper, 10'-12" Ht./ 4'-5" spread, B4B straight trunk
3	•	CEDAR ELM	Cedar Elm	<i>Ulmus crassifolia</i>	3" caliper, 10'-12" Ht./ 4'-5" spread, B4B straight trunk
GROUNDCOVER / VINES					
QUANTITY	SYMBOL	CALLOUT	COMMON NAME	SCIENTIFIC NAME	SIZE AND CONDITION
AS SHOWN	■	SOD	Common Bermuda Grass	<i>Cynodon dactylon</i>	Sod refer to specifications

LANDSCAPE CONTRACTOR SHALL VERIFY ALL PLANT QUANTITIES

TABULATIONS	
TREE MITIGATION	
PROTECTED TREES REMOVED (4" L.O., 8" & 9" PEAR, 6", T C.E.)	39 CAL. INCHES
TREES TO BE PLANTED (18-3")	39 CAL. INCHES

RECORD DRAWINGS:
 THE INTENT OF THE OWNER AND ENGINEER WAS TO CONSTRUCT THESE FACILITIES ACCORDING TO THESE PLANS AS APPROVED BY THE CITY OF ADDISON. THE LINES AND GRADES WERE SET ON THE GROUND FOR CONSTRUCTION ACCORDING TO SAID PLANS. THE CITY OF ADDISON INSPECTED THE CONSTRUCTION. NEITHER THE OWNER NOR THE ENGINEER VERIFIED LINES OR GRADES AFTER CONSTRUCTION. WE ARE NOT AWARE OF ANY CHANGES OR REVISIONS TO THESE PLANS DURING CONSTRUCTION EXCEPT AS NOTED.
 BY: *Michael Ramsey* DATE: 8/16/02
 MICHAEL RAMSEY, R.L.A.

74

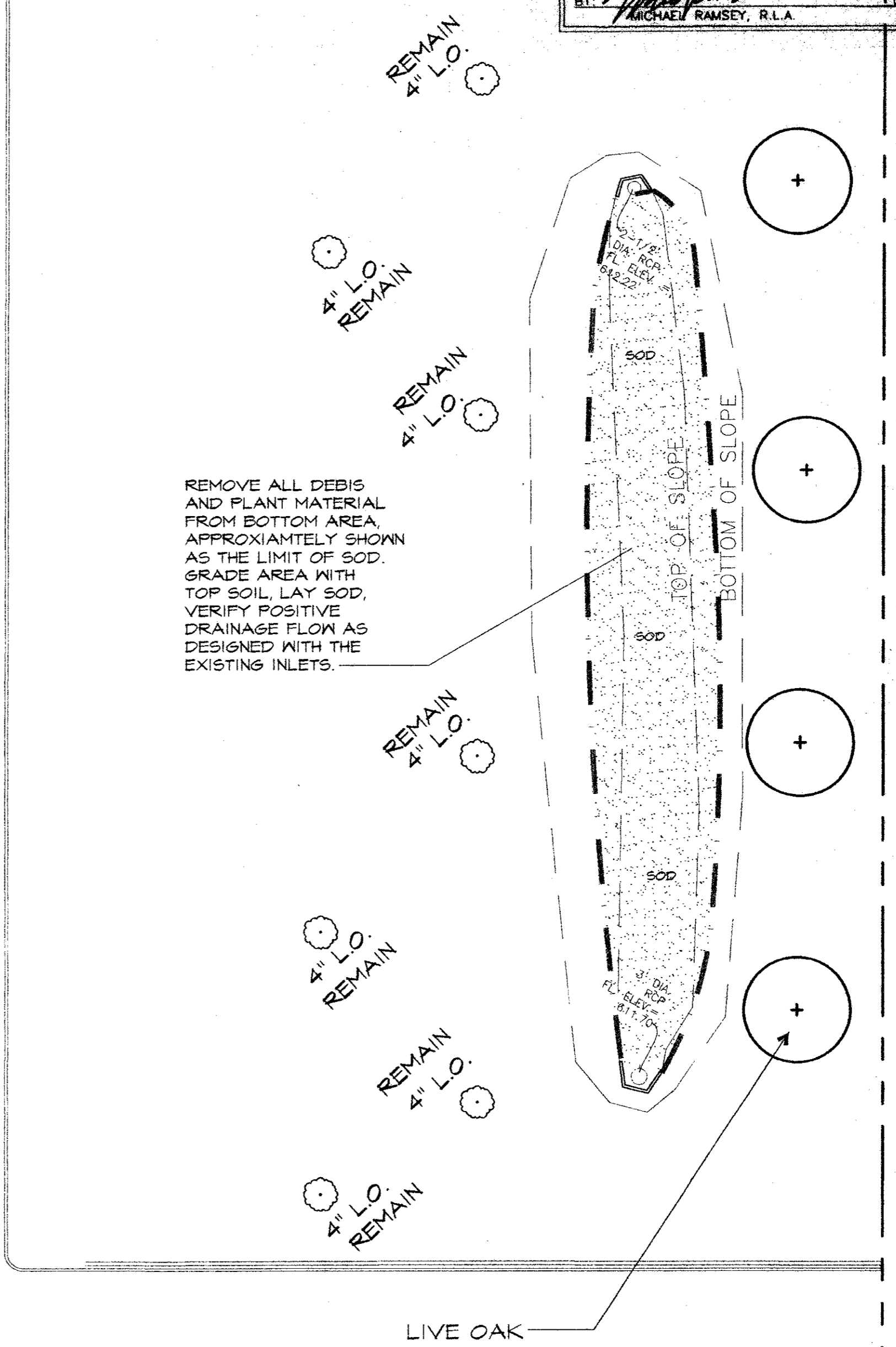

S 00'01'18" W 721.11'

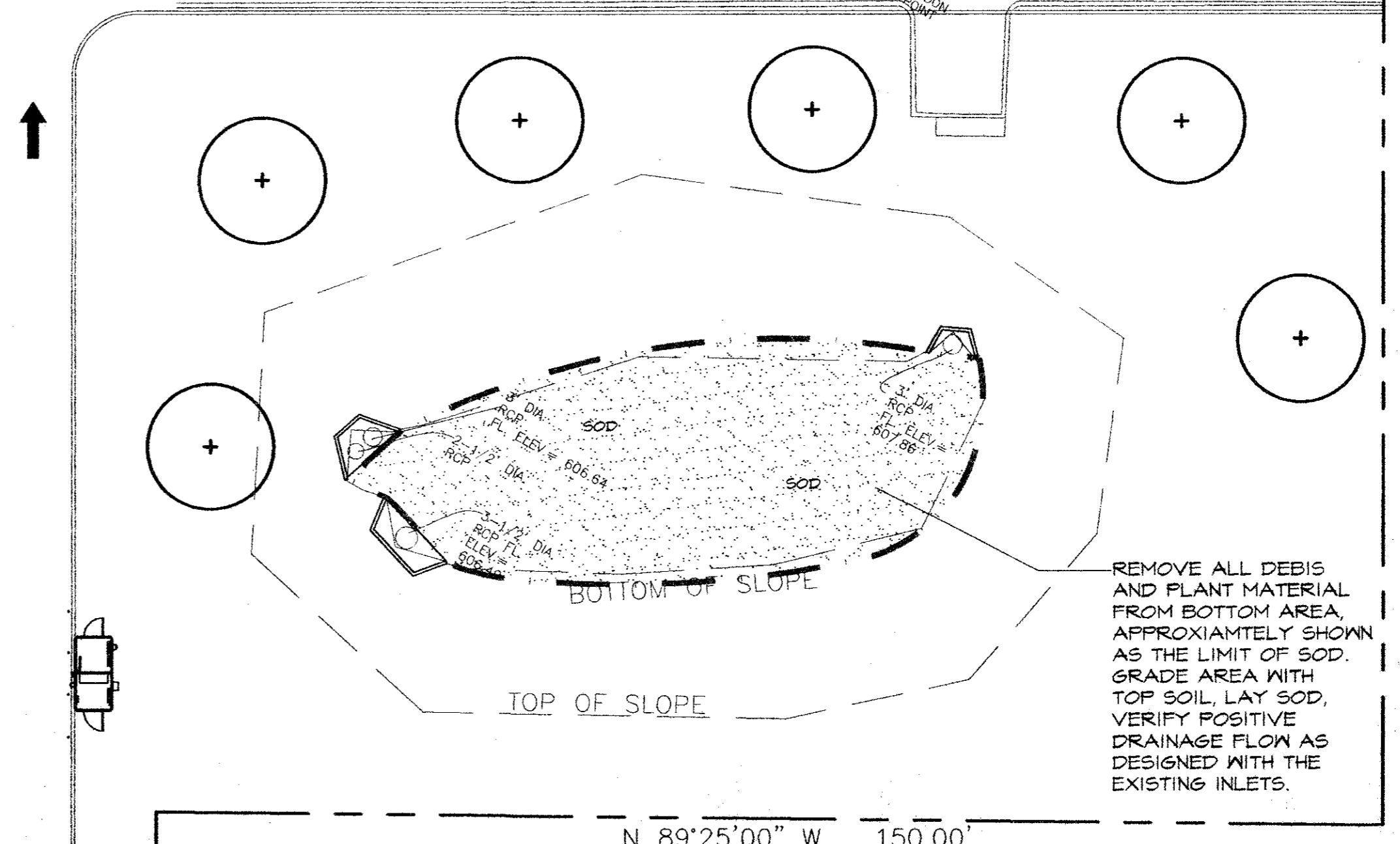

DETENTION PONDS



SCALE T = 20'-0"
 JAN. 3, 2002

REVISIONS	DATE	BY

GRUBBS RAMSEY, INC.
 17811 DALLAS PARKWAY, STE 220
 DALLAS, TEXAS 75248
 PHONE (972) 267-2519
 FAX (972) 267-2419

RAYMOND HARRIS AND ASSOCIATES ARCHITECTS
 PROPOSED SAM'S CLUB BUILDING REMODEL
 BELTLINE ROAD
 ADDISON, TEXAS

LANDSCAPE PLAN

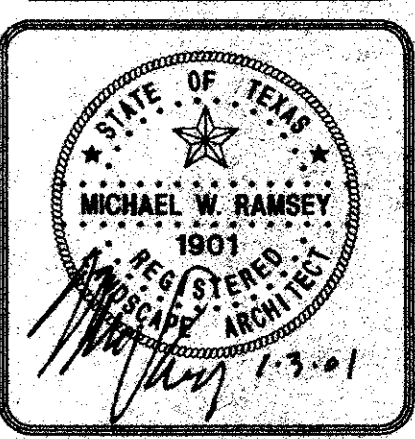

PROJECT MGR.	GRI
PROJECT TECH.	GRI
CHECKED BY	GRI
JOB NO.	
SHEET NO.	L2
OF 5	