

CAUTION!!!
 Underground Telephone Cable.
 Contact Southwestern Bell
 Telephone Company Prior To
 Construction.

SUBDIVISION Exxon Station - Belt Line Rd. & Midway Rd.
 DESIGNED Worrell & Associates, Inc. DATE June 19, 1981
 R.O.W. APPROVED _____ DATE _____
 ENGINEER OF DESIGN WATER UTILITIES DEPT. DATE _____
 CONTRACT NO. _____

NOTE: All construction shall be in accordance
 with the specifications of the City of
 Addison, Texas.

BENCH MARK:
 "□" Cut on southeast corner
 concrete walk to building at
 # 15101 Midway Road.
 Elevation 614.84

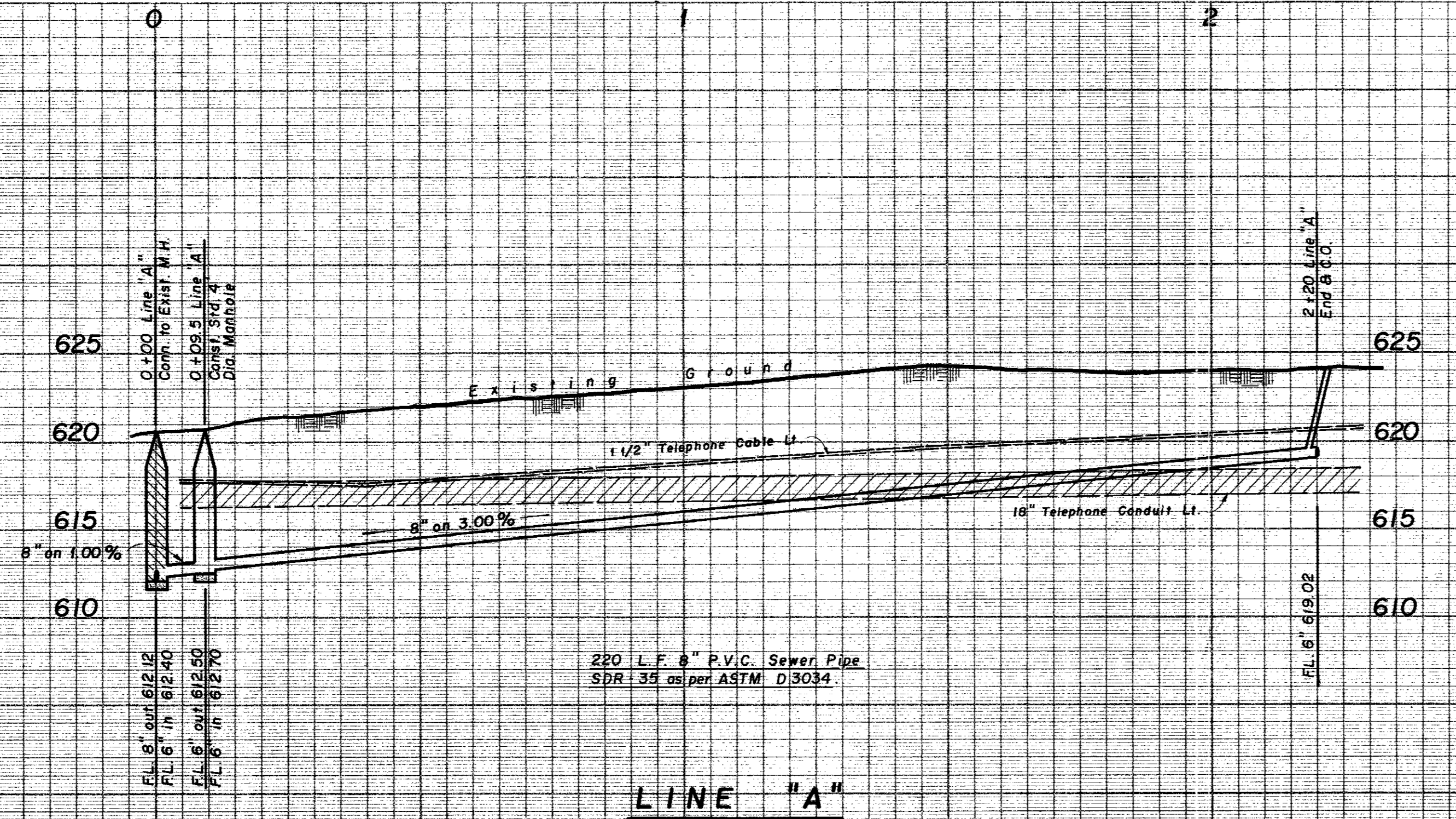

LINE "A"

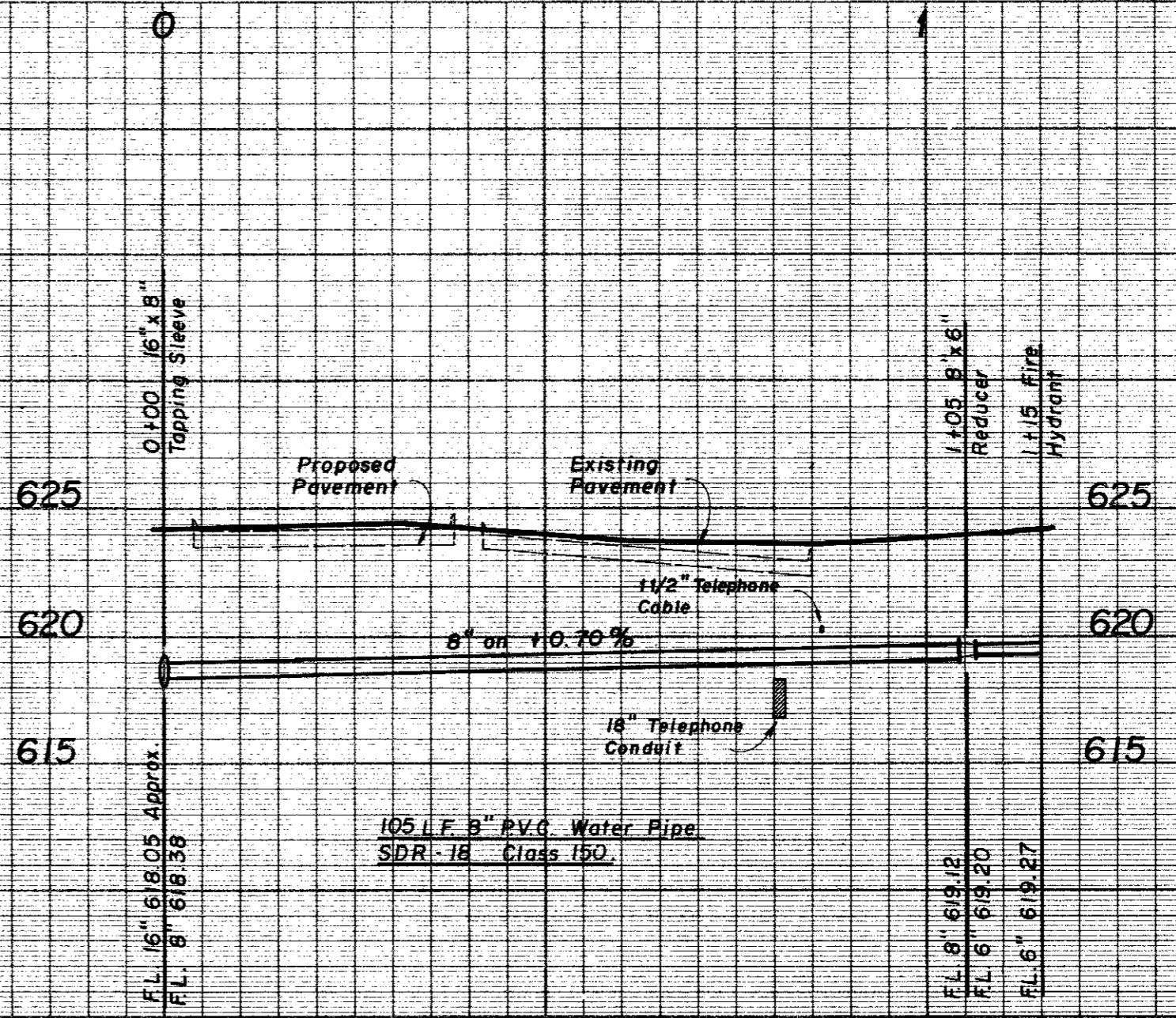

8" WATER MAIN

WATER & SEWER PLAN						
EXXON STATION - BELT LINE @ MIDWAY						
WORRELL & ASSOCIATES - ENGINEERS - PLANNERS 13619 INWOOD ROAD, SUITE 300 - DALLAS, TEXAS						
WATER UTILITIES DEPARTMENT						
CITY OF ADDISON, TEXAS						
DESIGN	DRAWN	DATE	SCALE	NOTES	FILE	NO
W & A	W & A	JUNE, '81	H: 1" = 20' V: 1" = 6'		6121	

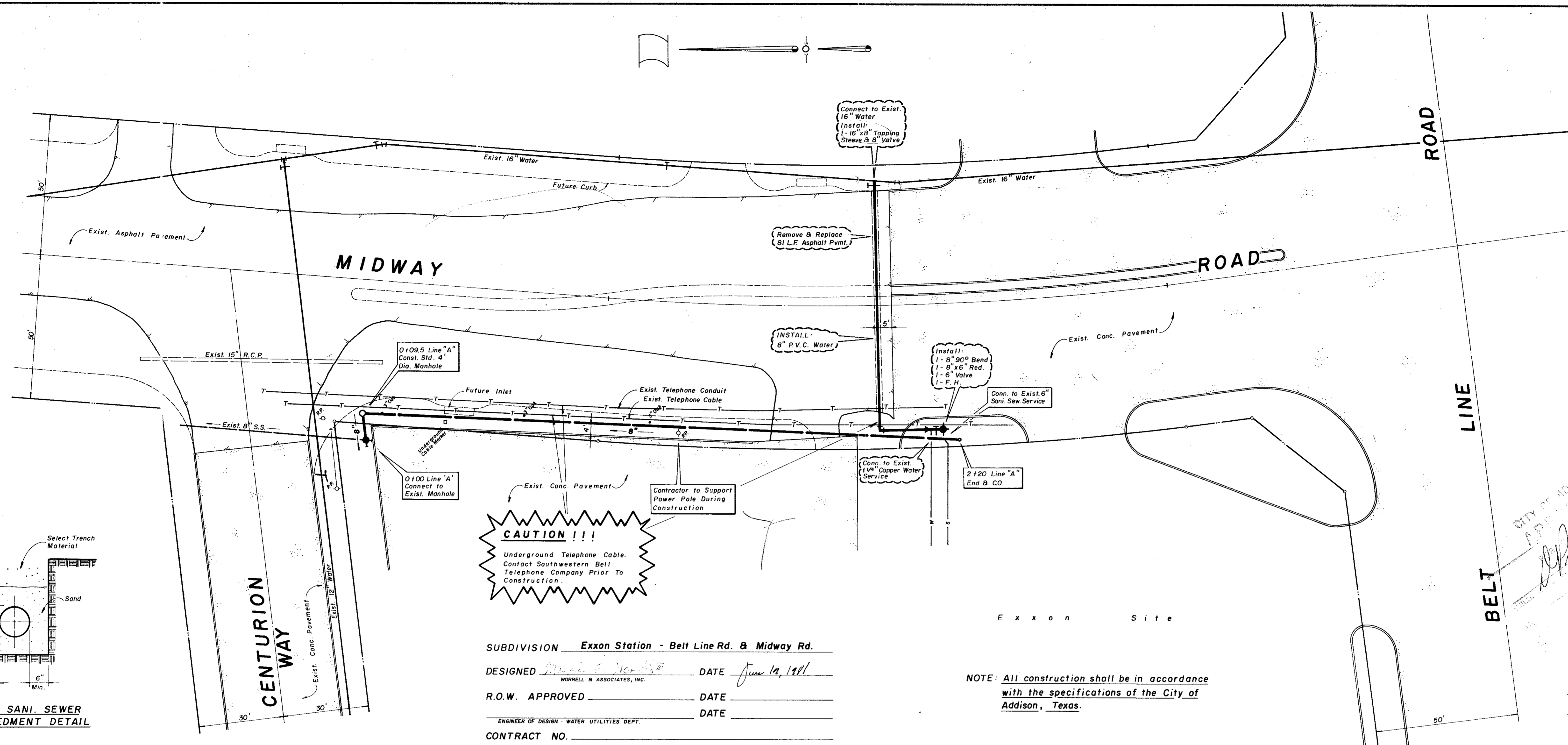
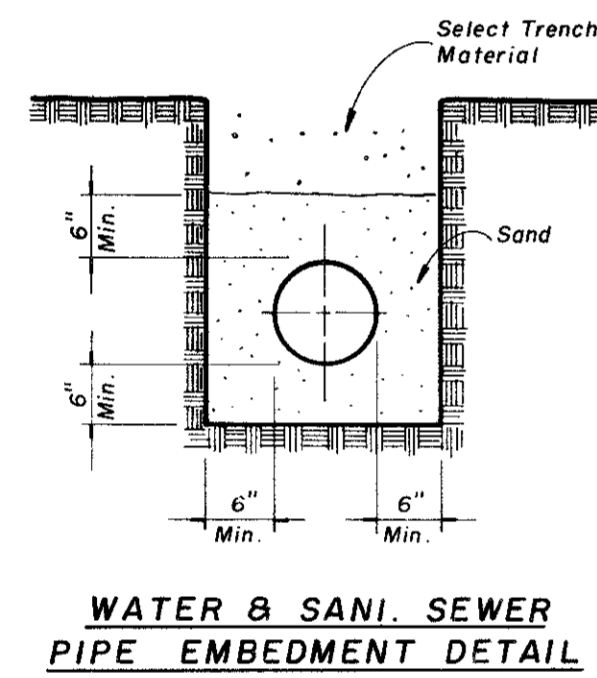

SUBDIVISION Exxon Station - Belt Line Rd. & Midway Rd.
 DESIGNED *[Signature]* DATE June 14, 1981
 WORRELL & ASSOCIATES, INC.
 R.O.W. APPROVED _____ DATE _____
 ENGINEER OF DESIGN - WATER UTILITIES DEPT. DATE _____
 CONTRACT NO. _____

NOTE: All construction shall be in accordance with the specifications of the City of Addison, Texas.

CITY OF ADDISON
APPROVED
6-19-81
THIS PROJECT IS HEREBY INSTRUCTED TO BE CONSTRUCTION OF LOCAL CDDDS TO HIS WORK. THE CONTRACTOR SHALL BE RESPONSIBLE FOR OBTAINING ALL NECESSARY PERMITS FROM THE CITY OF ADDISON.

BENCH MARK:
"□" Cut on southeast corner concrete walk to building at #15101 Midway Road.
Elevation 614.84

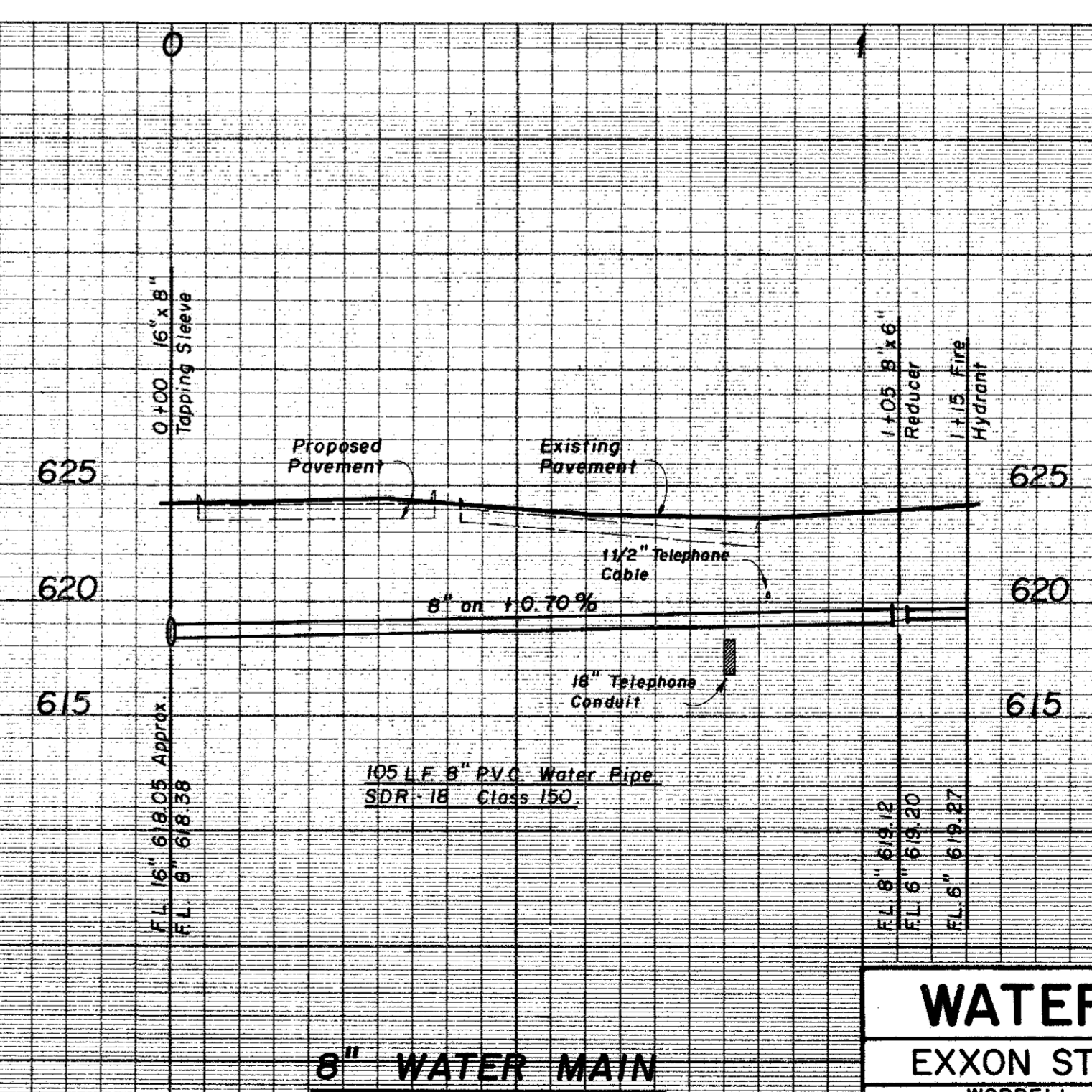
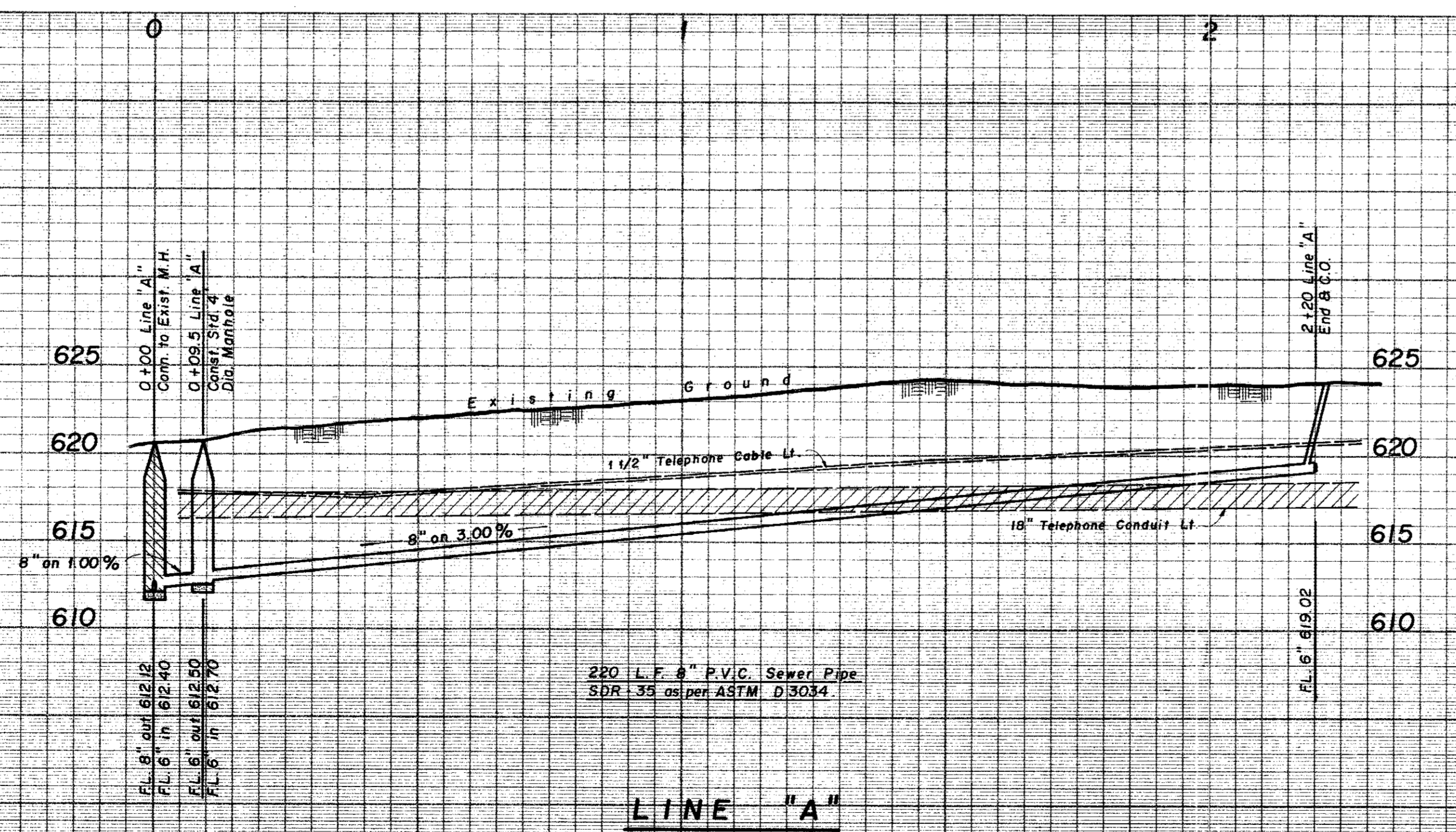

WATER & SEWER PLAN						
EXXON STATION - BELT LINE @ MIDWAY						
WORRELL & ASSOCIATES ENGINEERS - PLANNERS 13619 INWOOD ROAD, SUITE 300 - DALLAS, TEXAS						
WATER UTILITIES DEPARTMENT CITY OF ADDISON, TEXAS						
DESIGN	DRAWN	DATE	SCALE	NOTES	FILE	NO
W 8 A	W 8 A	JUNE, '81	H: 1" = 20' V: 1" = 6'			8121

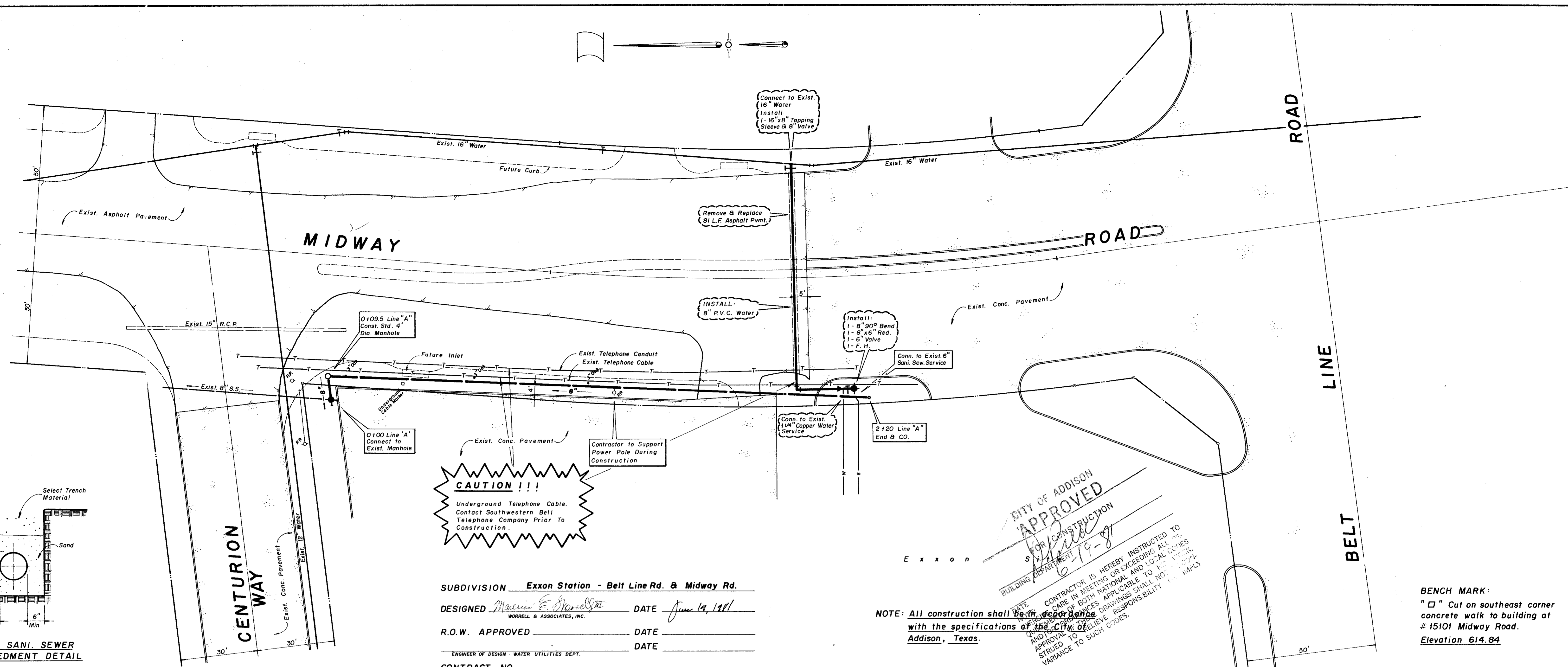
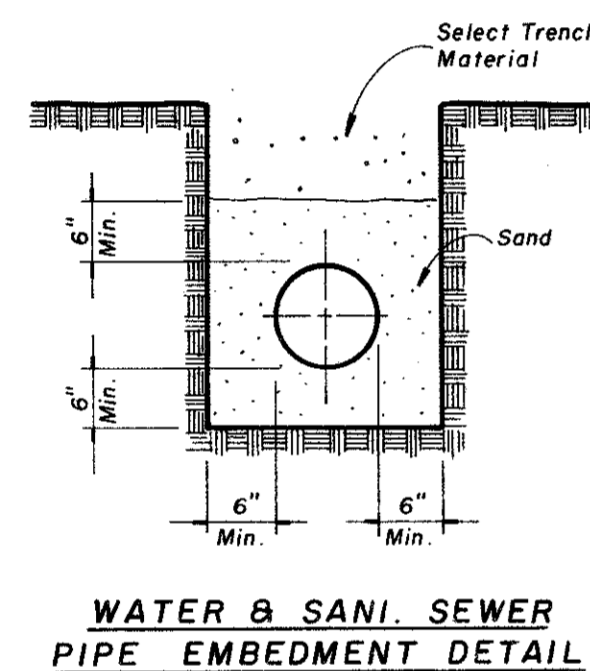

SUBDIVISION Exxon Station - Belt Line Rd. & Midway Rd.
 DESIGNED Martin E. Worrell DATE June 19, 1981
 R.O.W. APPROVED _____ DATE _____
 ENGINEER OF DESIGN - WATER UTILITIES DEPT.
 CONTRACT NO. _____

CONTRACTOR IS HEREBY INSTRUCTED TO TAKE CARE IN MEETING OR EXCEEDING ALL REQUIREMENTS OF BOTH NATIONAL AND LOCAL CODES AND ORDINANCES APPLICABLE TO HIS WORK. APPROVAL OF THESE DRAWINGS SHALL NOT BE CONSTRUED TO IMPLY RESPONSIBILITY ON THE PART OF THE CITY OF ADDISON TO SUCH CODES.

BENCH MARK:
"□" Cut on southeast corner concrete walk to building at #15101 Midway Road.
Elevation 614.84

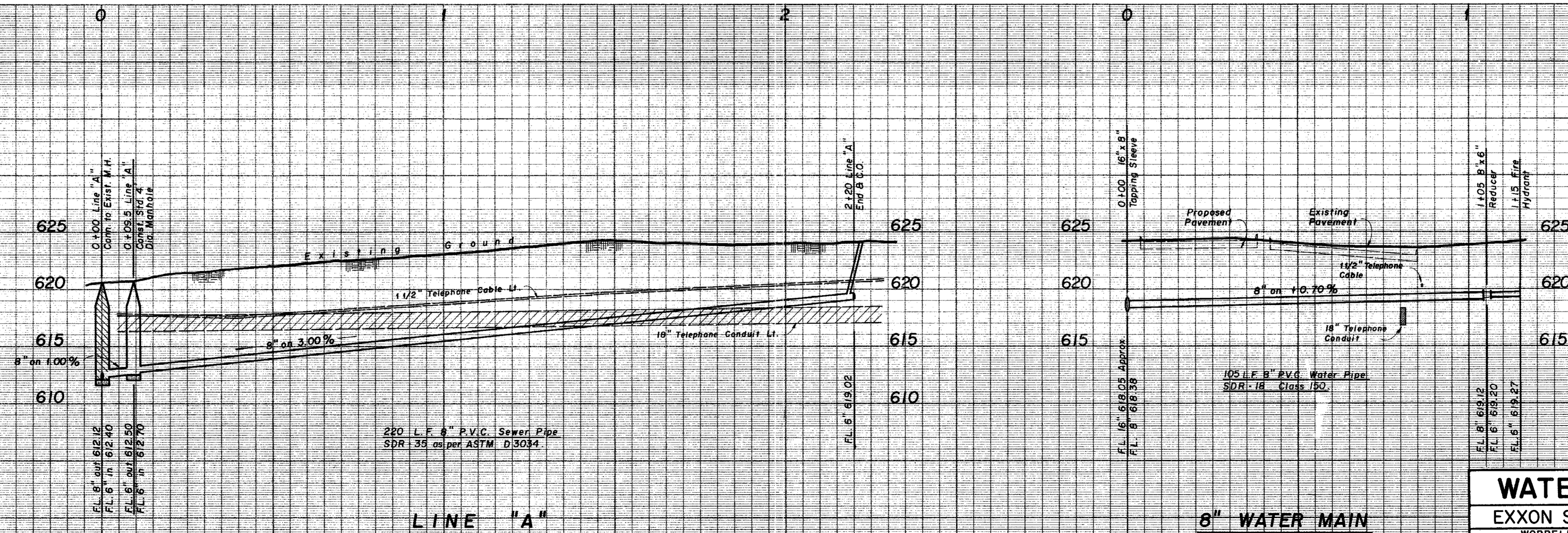

WATER & SEWER PLAN					
EXXON STATION - BELT LINE @ MIDWAY					
WORRELL & ASSOCIATES - ENGINEERS - PLANNERS 13619 INWOOD ROAD, SUITE 300 - DALLAS, TEXAS					
WATER UTILITIES DEPARTMENT					
CITY OF ADDISON, TEXAS					
DESIGN	DRAWN	DATE	SCALE	NOTES	FILE NO.
W & A	W & A	JUNE, '81	H. 1" = 20' V. 1" = 6'		8121