

ARCHITECTS  
VAN LOM /  
EDWARDS  
A.I.A., P.C.  
34 N.W. First Avenue, Suite 303  
Portland, Oregon 97209 503/226-0590

S.E. CORNER OF BELTLINE ROAD  
AND MIDWAY ROAD  
ITALIAN RESTAURANT  
ADDISON, TEXAS



Job No. 1498-01  
Date: 7/17/92  
Rev: 7/28/92  
10/05/92  
10/21/92

WATER AND  
SANITARY  
PLAN

Sheet No.

C8

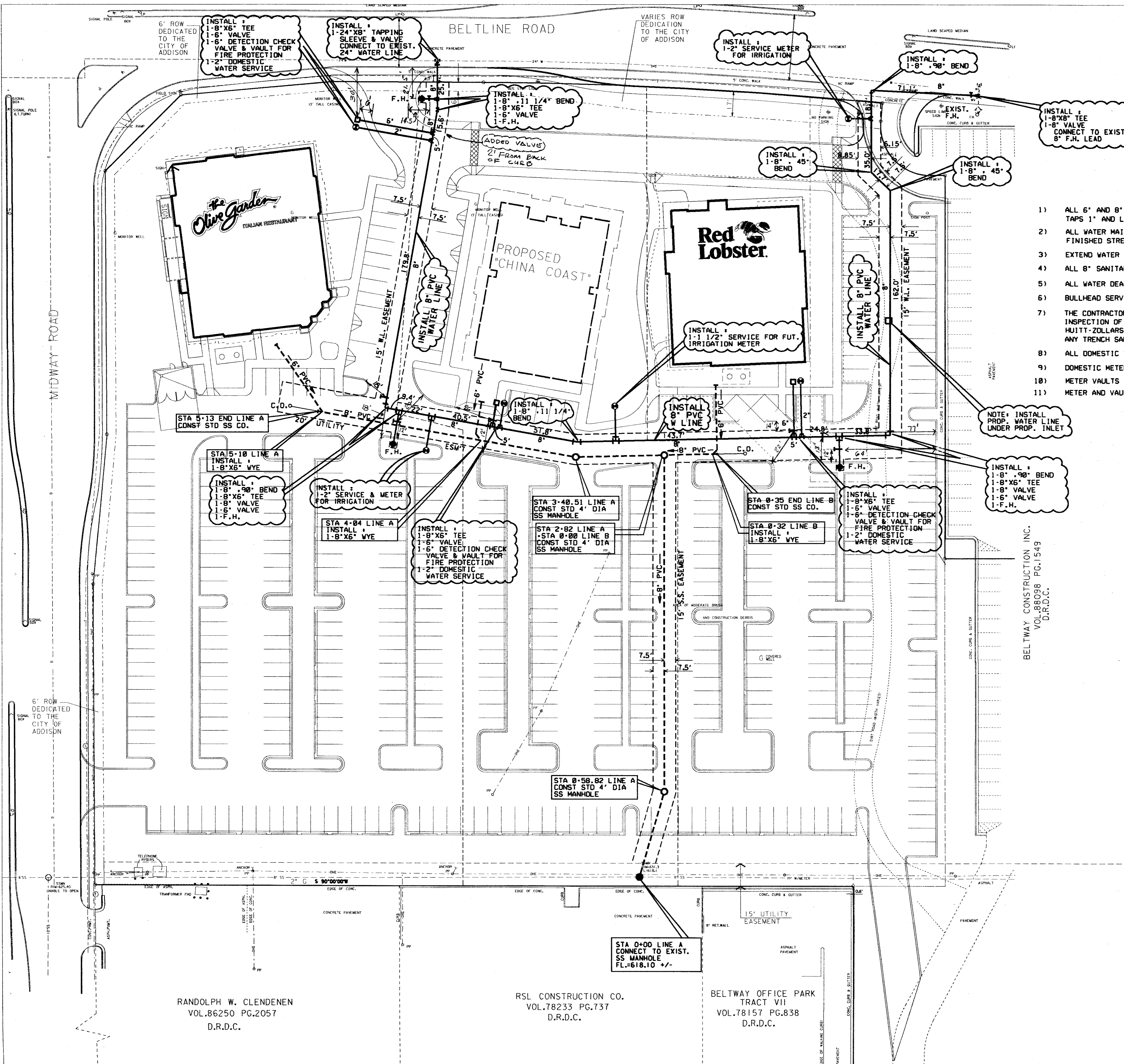

**GENERAL NOTES**

- 1) ALL 6" AND 8" WATER MAINS SHALL BE PVC CLASS 200 WATER PIPE. FOR PVC SERVICE TAPS 1" AND LARGER, TAPPING SADDLES SHALL BE USED.
- 2) ALL WATER MAINS SHALL HAVE MINIMUM COVER AS FOLLOWS: 6" AND 8" - 48" BELOW FINISHED STREET GRADE.
- 3) EXTEND WATER DEADHEADS AND SANITARY SEWER LATERALS 2' BEYOND PROPOSED CURBS.
- 4) ALL 8" SANITARY SEWER MAINS SHALL BE ASTM 3834 (SDR 35) OR ASTM F789/D3212.
- 5) ALL WATER DEADHEADS SHALL BE COPPER AND LOCATED AS SHOWN.
- 6) BULLHEAD SERVICES AND METER WILL BE INSTALLED BY THE UTILITY CONTRACTOR
- 7) THE CONTRACTOR WILL BE RESPONSIBLE FOR PROVIDING, MAINTAINING, DESIGNING AND INSPECTION OF TRENCH SAFETY DEVICES OR SHORING. HUITT-ZOLLARS, INC. WILL NOT BE RESPONSIBLE FOR DESIGNING OR INSPECTING ANY TRENCH SAFETY USED BY THE CONTRACTOR.
- 8) ALL DOMESTIC WATER METERS TO BE INSTALLED WITH DOUBLE CHECK VALVE ASSEMBLY.
- 9) DOMESTIC METER BOXES TO BE CONCRETE.
- 10) METER VAULTS TO BE INSTALLED WITH BILCO LIDS OR EQUAL.
- 11) METER AND VAULTS TO BE INSTALLED IN GREEN SPACES OR SIDEWALKS.

NOTE: INSTALL PROP. WATER LINE UNDER PROP. INLET

BELTWAY CONSTRUCTION INC.  
VOL. 88098 PG. 1549  
D.R.D.C.

RANDOLPH W. CLENDENEN  
VOL. 86250 PG. 2057  
D.R.D.C.

RSL CONSTRUCTION CO.  
VOL. 78233 PG. 737  
D.R.D.C.

BELTWAY OFFICE PARK  
TRACT VII  
VOL. 78157 PG. 838  
D.R.D.C.

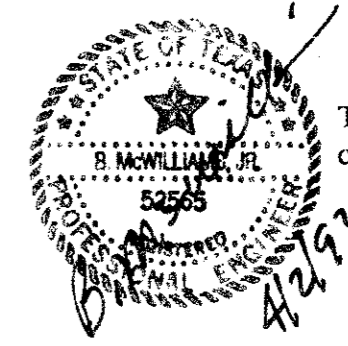

The construction of this Plan was completed according to the design.

"AS BUILT"

1" = 30'-0"

**HUITT - ZOLLARS**

3131 MCKINNEY AVENUE/SUITE 600  
DALLAS, TEXAS/214-871-3311