

RELOCATED F.D.C. n.t.s.

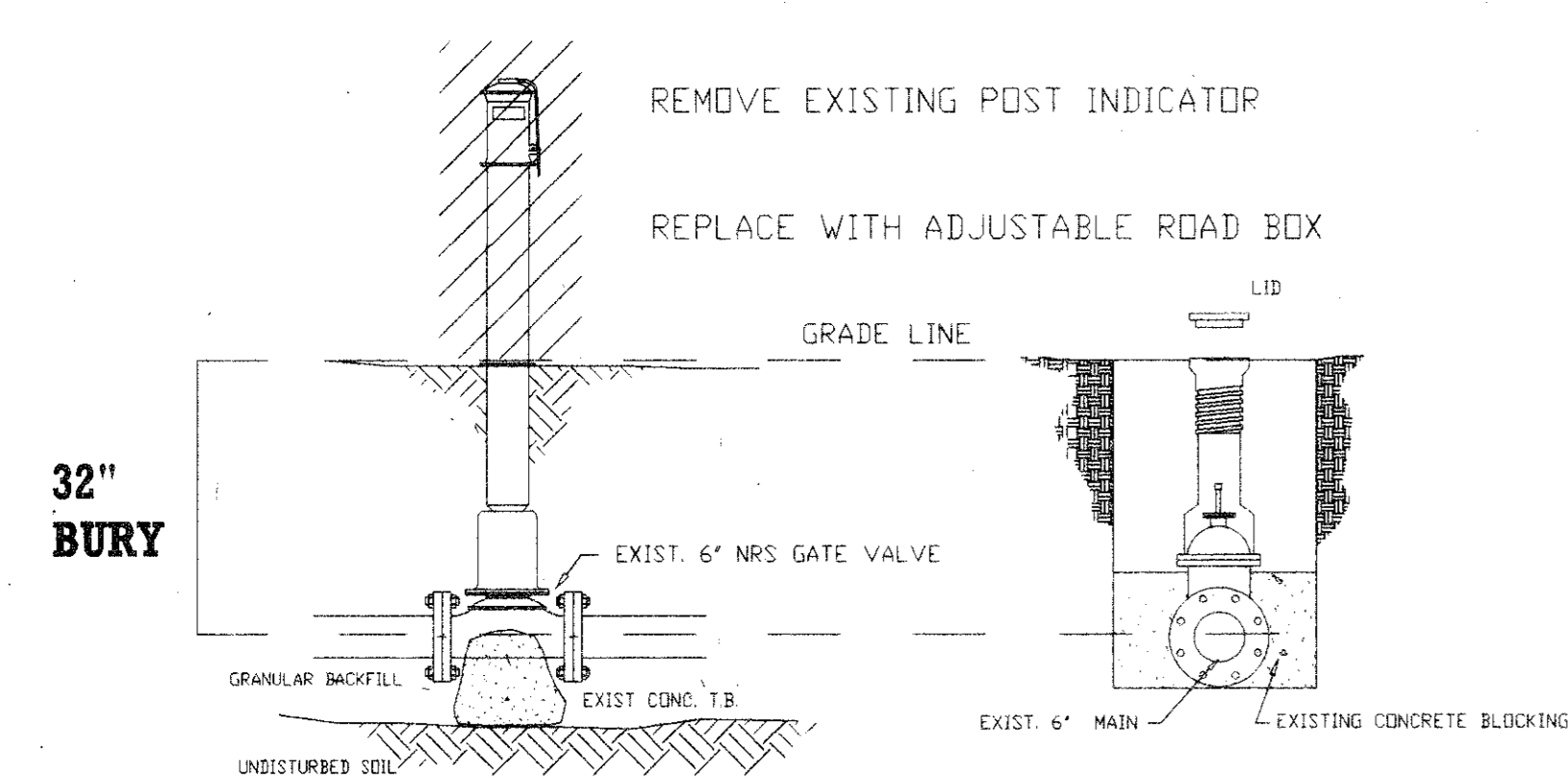

REMOVE EXIST. P.I.V. REPLACE W/ROAD BOX

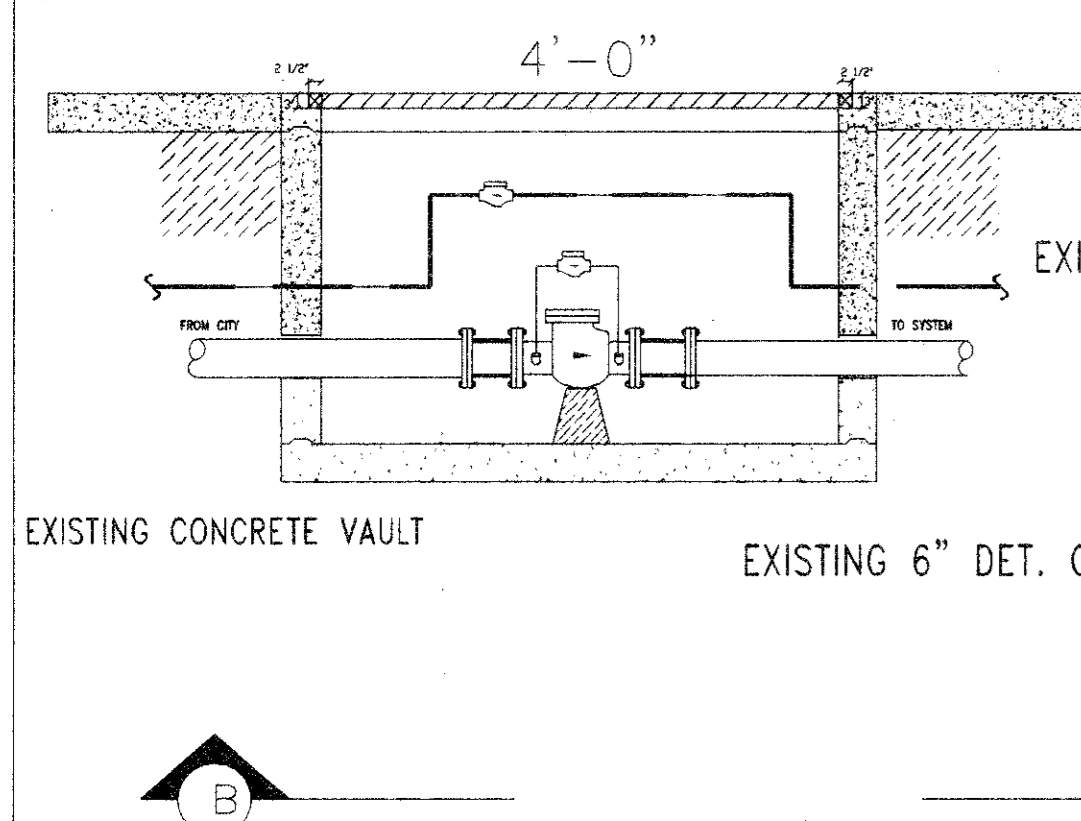

1) USC-REC 412 Approval
DCDA required (Fire service)
2) All water to have remote (back-pipe) registers/readers.
3) DCVA required on domestic service.
DEW 8/27/01

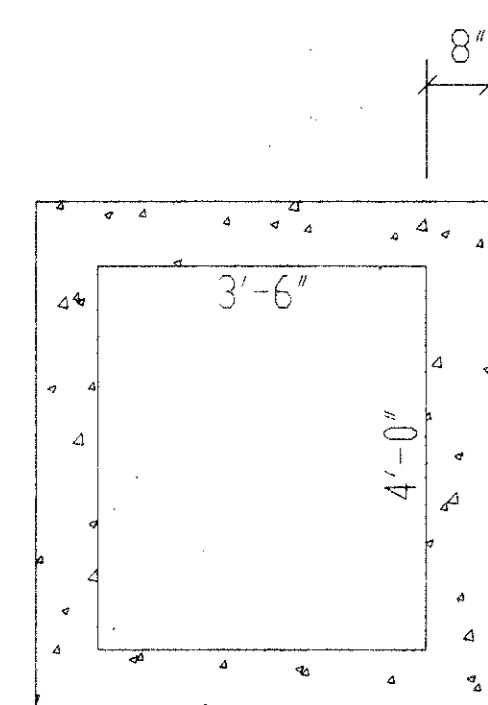

APPROVED

SIGNED *John Chisholm* DATE 8/27/01

TITLE ASST. CITY ENGINEER

TOWN OF ADDISON
PUBLIC WORKS DEPARTMENT

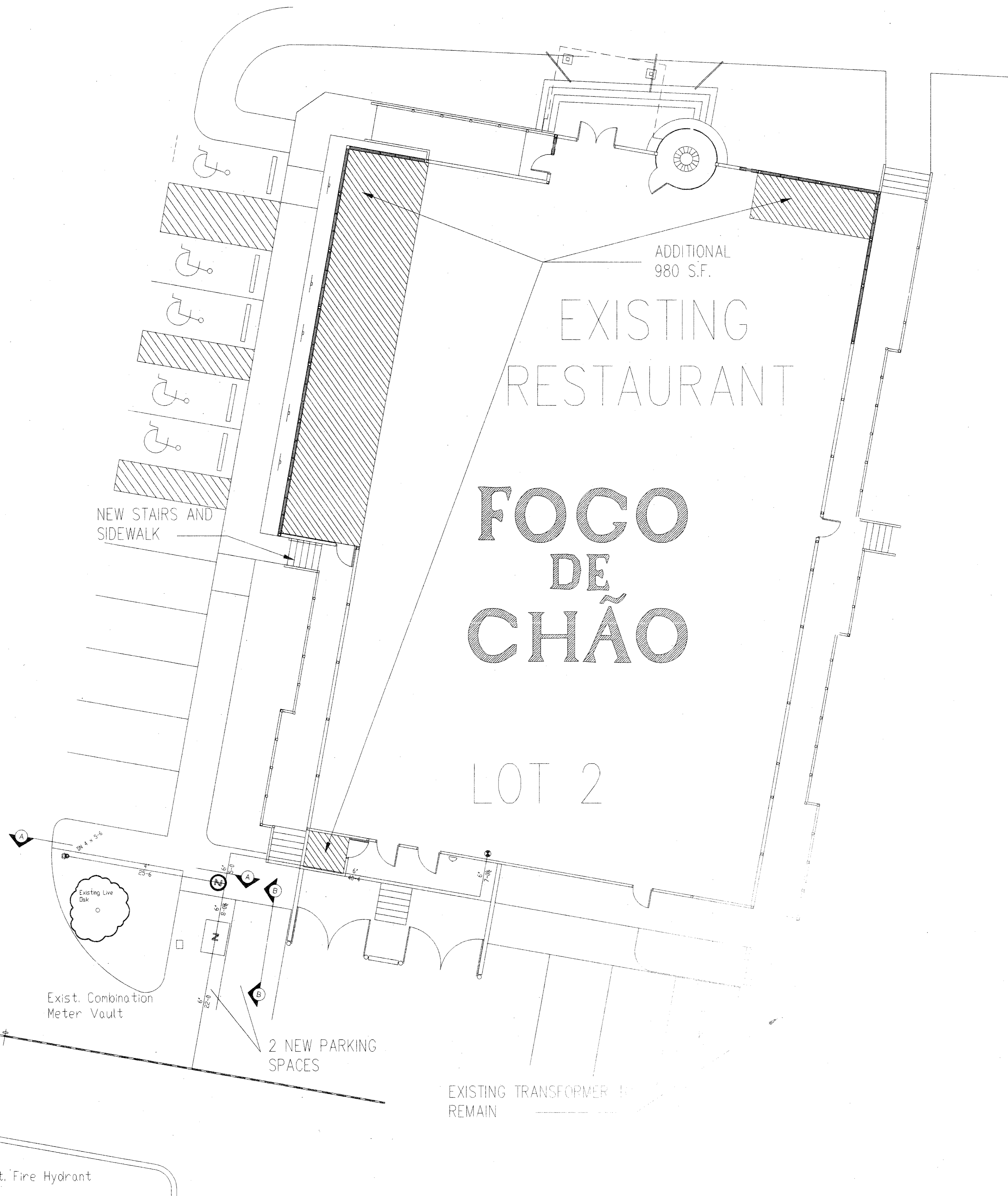

NOTES

- TRENCH SAFETY SYSTEM SHALL BE IN ACCORDANCE WITH OCCUPATIONAL SAFETY AND HEALTH ADMINISTRATION'S STANDARDS FOR TRENCH SAFETY THAT WILL BE IN EFFECT DURING THE PERIOD OF CONSTRUCTION OF THE PROJECT. CONTRACTOR'S ATTENTION IS DIRECTED TO THE REQUIREMENTS OF OCCUPATIONAL SAFETY AND HEALTH STANDARDS: EXCAVATING PROCESSES (29 CFR PART 1926) AS PUBLISHED IN THE FEDERAL REGISTER VOL. 50 NO. 60, SECTIONS 1926.650 AND 1926.651, AND 1926.654, APRIL 16, 1985, AND TO APPLICABLE STATE LAW ENACTED BY THE TEXAS LEGISLATURE IN S.B. NO. 1289, AND TO CITY OF ADDISON ORDINANCE 07-1807.
- CONTRACTOR SHALL PERFORM DAILY TRENCH SAFETY SYSTEM INSPECTIONS TO INSURE THAT THE SYSTEM MEETS OSHA REQUIREMENTS AND IS APPROPRIATE FOR SPECIFIC SITE CONDITIONS. IF ANY TRENCH INSPECTIONS ARE REQUIRED AFTER RAINFALL OR ANY CHANGE IN CONDITIONS THAT MAY INCREASE THE POSSIBILITY OF A CAVE-IN ON SITE.
- WHERE THE TRENCH SAFETY SYSTEM CROSSES A UTILITY, THE UTILITY LINE MUST BE INDICATED AND SUPPORTED TO PREVENT ANY DAMAGE. IN ADDITION, TRENCHES WITH CLOSED SHEETING, THE UPRIGHTS MUST SURROUND THE UTILITY. OPEN TRENCH SHEETING SPACING MUST BE ADJUSTED AS TO NOT EXCEED THE MAXIMUM ALLOWED SPACING.
- TRENCH SHALL BE DRAINED AS REQUIRED SO WORK MAY BE ACCOMPLISHED SAFELY AND EFFICIENTLY. IF NECESSARY, INITIAL DRAINAGE SYSTEM TO PROVIDE A DRY TRENCH MUST BE INSTALLED. DELIVER DISCHARGE FROM SYSTEM TO NATURAL DRAINAGE CHANNEL, OR TO STORM DRAINAGE.
- IN TRENCHES 4 FEET DEEP OR MORE, CONTRACTOR SHALL PROVIDE ADEQUATE MEANS OF TRENCH EXIT SUCH AS LADDERS OR STEPS AND THEY MUST BE LOCKED SO AS TO REQUIRE NO MORE THAN 25 FT. OF LATERAL TRAVEL.
- MEMBER SIZES AT SPACINGS OTHER THAN INDICATED ARE TO BE DETERMINED AS SPECIFIED IN 1926.650(b) "DESIGN OF PROTECTIVE SYSTEM".
- WHEN CONDITIONS ARE UNFAVORABLE OR OTHERWISE USE TIGHT SHEETING. TIGHT SHEETING ACCESS TO THE USE OF SPECIALLY-EDGED TIMBER PLANKS AT LEAST THREE TIMES THEIR THICKNESS SHEET PILING OR SIMILAR CONSTRUCTION THAT WHEN DRIVEN OR PLACED IN POSITION PROVIDE A TIGHT WALL TO RESIST THE LATERAL PRESSURE OF WATER. CLOSE SHEETING REFERS TO THE PLACEMENT OF PLANKS SIDE-BY-SIDE ALONG AS LITTLE SPACE AS POSSIBLE BETWEEN THEM.
- ALL SPACING INDICATED IS MEASURED CENTER TO CENTER.
- GREATER DIMENSIONS OF WALES TO BE HORIZONTAL.
- IF THE VERTICAL DISTANCE FROM THE CENTER OF THE LOWEST CROSSBRACE TO THE BOTTOM OF THE TRENCH EXCEEDS TWO AND ONE-HALF FEET, UPRIGHTS SHALL BE FINELY DIMENSIONED OR A MIDDLE SHALL BE USED WHERE UPRIGHTS ARE ENDED. THE VERTICAL DISTANCE FROM THE CENTER OF THE LOWEST CROSSBRACE TO THE BOTTOM OF THE TRENCH SHALL NOT EXCEED 18 INCHES. WHEN MIDDLE IS USED, THE VERTICAL DISTANCE SHALL NOT EXCEED 40 INCHES. NOTE: MIDDLE AND WALES THAT ARE INSTALLED AT THE TOP OF THE TRENCH.
- TRENCH WALES MAY BE USED IN LIEU OF OR IN COMBINATION WITH TIMBER CROSSBRACES.
- PLACEMENT OF CROSSBRACES: WHEN THE VERTICAL SPACING OF CROSSBRACES IS FOUR FEET, PLACE THE TOP CROSSBRACE NO MORE THAN TWO FEET BELOW THE TOP OF THE TRENCH. WHEN THE VERTICAL SPACING OF CROSSBRACES IS FIVE FEET, PLACE THE TOP CROSSBRACE NO MORE THAN 2.5 FEET BELOW THE TOP OF THE TRENCH.

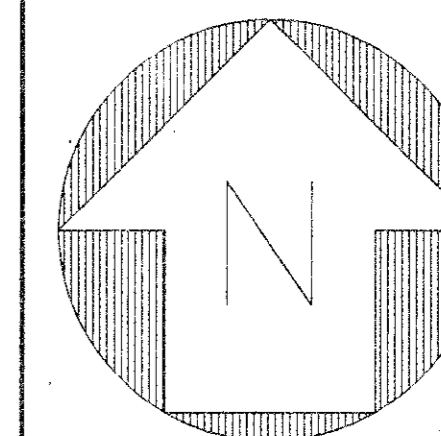

Symbol	Description
(H)	Hydraulic Reference Points
(E)	Elev. Below Top of Steel
(F)	Elev. Above Finished Floor
(H)	Denotes Hanger Location
(U)	Rise up or down

SCR# - 0119

Number of Sprinklers

Total This Sheet	Total This Job

PRINTING SITE PLAN

Contract No.	Revisions	Date
By CHAD SMITH		
Scale 1/8" = 1'-0"		
08-22-01		
TOWN OF ADDISON FIRE DEPARTMENT		

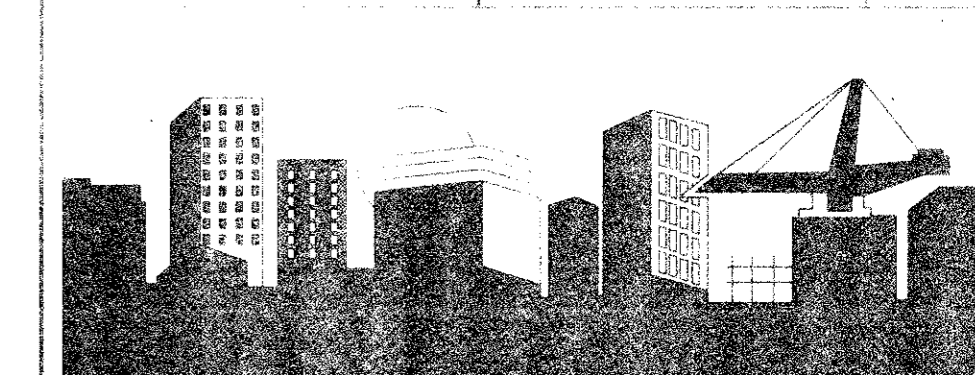

Northstar Fire Protection of Texas, Inc.

PROJECT	FOGO DE CHÃO	FOGO DE CHÃO
1500 E. Highway		
Deerfield Beach, FL 33442		
Ph (954) 428-1500		
Contractor	RCI Associates, Inc.	
422 SW 12th Avenue		
Deerfield Beach, FL 33442		
Ph (954) 428-1500		

SHEET 1 OF 3

B12-11

8/27/01

FIRE SERVICE

4300 BELT LINE

FOGO DE CHÃO

Const. Proposal

B12-11