

UNDERGROUND CONDUIT DETAIL

SCALE: NONE

BELT LINE ROAD

BELTWOOD PARKWAY EAST

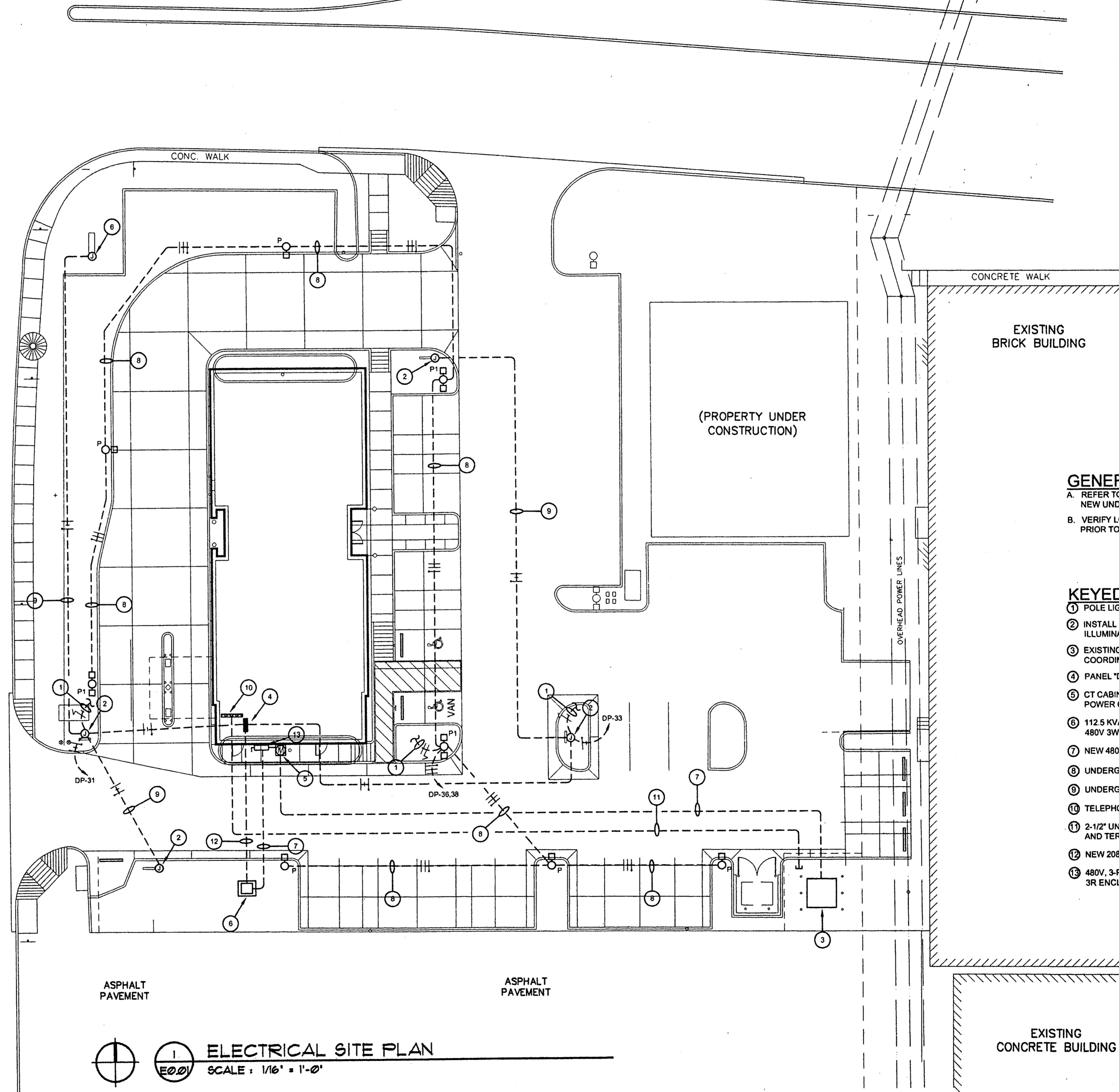

GENERAL NOTES:

- A. REFER TO MECHANICAL SITE PLAN FOR LOCATION OF ADDITIONAL NEW UNDERGROUND UTILITIES TO FACILITY.
- B. VERIFY LOCATION OF ALL NEW AND EXISTING UNDERGROUND UTILITIES PRIOR TO BEGINNING ANY EXCAVATION.

KEYED NOTES:

- ① POLE LIGHT TO BE CONTROLLED BY PHOTOCELL ON ROOF.
- ② INSTALL GRADE LEVEL J-BOX FOR CONNECTION TO NEW ILLUMINATED SIGN.
- ③ EXISTING 480V/277 PAD MOUNTED TRANSFORMER TO REMAIN. COORDINATE FINAL CONNECTIONS.
- ④ PANEL "DP".
- ⑤ CT CABINET AND METER BASE BY CONTRACTOR. INSTRUMENT BY POWER CO. VERIFY EXACT REQUIREMENTS WITH POWER CO.
- ⑥ 112.5 KVA DRY-TYPE TRANSFORMER IN WEATHER PROOF ENCLOSURE. 480V 3W PRIMARY / 208Y/120 3PH 4W SECONDARY.
- ⑦ NEW 480 UNDERGROUND SECONDARY.
- ⑧ UNDERGROUND LIGHTING CIRCUIT.
- ⑨ UNDERGROUND ILLUMINATED SIGN CIRCUIT.
- ⑩ TELEPHONE BACKBOARD.
- ⑪ 2-1/2" UNDERGROUND TELEPHONE CONDUIT. VERIFY ROUTING AND TERMINATION POINT WITH TELEPHONE CO.
- ⑫ NEW 208V UNDERGROUND SECONDARY.
- ⑬ 480V, 3-POLE, 200 AMP MAIN SERVICE DISCONNECT IN NEMA 3R ENCLOSURE. FUSE AT 175 AMPS.

① ELECTRICAL SITE PLAN
 E001 SCALE: 1/16" = 1'-0"

VOICE: 806.780.7475 CELL: 806.777.7775
 FAX: 806.780.0129 EMAIL: mtspe@door.net

STRAHAN ENGINEERING

4601 50TH STREET SUITE 212
 LUBBOCK, TEXAS 79414



R-F
 ROGERS-FORD
 ARCHITECTURE - INTERIOR DESIGN
 2616 THOMAS AVENUE
 DALLAS, TEXAS 75204
 TELEPHONE (214) 871-9388
 FAX (214) 871-3135

LONE STAR BANK
 Belwood Parkway East
 at Beltline Road
 Addison, TX
 Project # 1804

8-17-2000 ISSUED FOR BID

E0.01