

**PRELIMINARY DRAWINGS FOR
ENGINEER'S APPROVAL ONLY**

Date 4-5-74 By BH

- SPECIALS FOREMAN
- CONSTRUCTORS TRANS
- RAY DAVIS
- ENG. / EST.
- SALES
- CONTRACTOR
- ENGINEER
- CYL. FOREMAN
- LINE/COAT FOREMAN
- FIELD REP.
- COTTON MEYER
- LANCE REBSTOCK
- QUALITY CONTROL
- YARD FOREMAN
- OTHER

D-100 JOINT DETAIL
L-1 THRU L- LINE LAYOUT
D-101 THRU D-107 DETAILS
U.C.P.C. PERSONNEL (214) 638-6910
REFER TO JOB NO. 5281
SALES JOHN G. CASTER
ENGINEERING ROY E. STILLWELL
DELIVERY LANCE P. REBSTOCK

TABLE OF CONTENTS

OWNER: CITY OF ADDISON
LOCATION: ADDISON, TEXAS
ENGINEER: RUSSELL BETTS & ASSOCIATES
5526 DYER
DALLAS, TEXAS 75206
ATTENTION: MR. RUSSELL BETTS
CONTRACTOR: LEONARD HAZEL, INC.
P. O. BOX 48098
WATAUGA, TEXAS 76148
ATTENTION: MR. LEONARD HAZEL
DESCRIPTION: 24" WATER LINE ADDITION IN
BELT LINE ROAD

268 3642

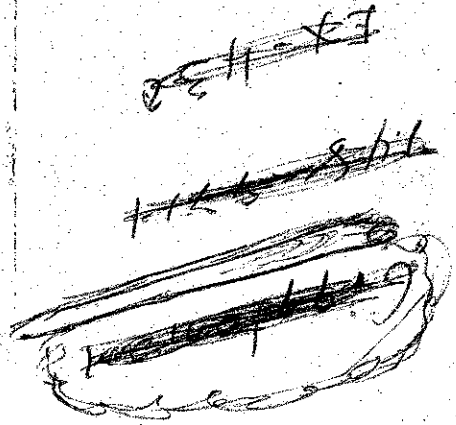

**U.S. PIPE & FOUNDRY COMPANY
CONCRETE PIPE DIVISION
DALLAS, TEXAS
CONCRETE PIPE PROJECT**

PROJECT LOCATION
(NO SCALE)

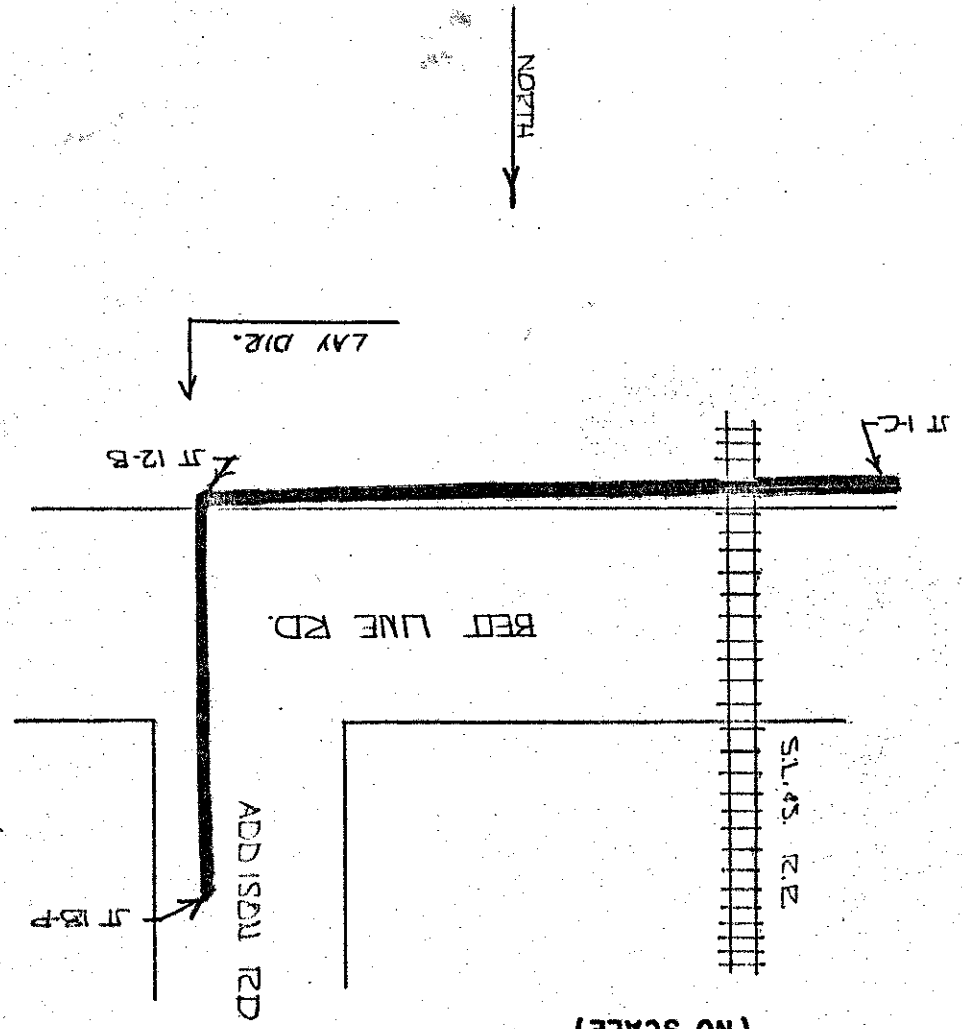

NORTH
↓