

LEGEND

	6"-3500 psi REINF. CONC. w/ #3 BARS @ 18" O.C.E.W.
	4"-3000 psi REINF. CONC. w/ #3 BARS @ 18" O.C. LONGITUDINALLY, 24" O.C. TRANSVERSELY.

*****NOTICES TO CONTRACTOR*****

THE CONTRACTOR(S) SHALL BE RESPONSIBLE FOR CONFIRMING THE LOCATION (HORIZONTAL & VERTICAL) OF ANY BURIED CABLES, CONDUITS, PIPES AND STRUCTURES (STORM SEWER, SANITARY SEWER, WATER, GAS, TELEVISION, ETC.) WHICH IMPACT THE CONSTRUCTION SITE. THE CONTRACTOR(S) SHALL NOTIFY THE OWNER OF ANY DISCREPANCIES FOUND BETWEEN THE ACTUAL CONDITIONS VERSUS THE DATA CONTAINED IN THE CONSTRUCTION PLANS. ANY COSTS INCURRED AS THE RESULT OF NOT CONFIRMING THE ACTUAL LOCATION (HORIZONTAL AND VERTICAL) OF SAID CABLES, CONDUITS, PIPES AND STRUCTURES SHALL BE BORNE BY THE CONTRACTOR(S). IF THE CONTRACTOR(S) DOES NOT ACCEPT THE EXISTING TOPOGRAPHY AS SHOWN ON THESE PLANS, WITHOUT EXCEPTION, HE SHALL MAKE AT HIS OWN EXPENSE A TOPOGRAPHIC SURVEY BY A REGISTERED PROFESSIONAL ENGINEER OR A REGISTERED PROFESSIONAL LAND SURVEYOR AND SUBMIT IT TO THE OWNER FOR REVIEW.

THE CONTRACTOR(S) SHALL CALL 1-800-NOTESS FOR UTILITY LOCATIONS AND MARKING AT LEAST 48 HOURS PRIOR TO ANY EXCAVATION OR CONSTRUCTION ON THE SITE.

LEGEND

PP	Power Pole
GW	Guy Wire
MH	Manhole
WV	Water Valve
TP	Telephone Pedestal
WM	Water Meter
FH	Fire Hydrant
LP	Light Pole
IV	Irrigation Valve
CO	Clean Out
AC	Air-Conditioner
TV	Cable Box
SB	Signal Box
SP	Signal Pole
SN	Sign
IRF	Iron Rod Found
IRS	Iron Rod Set
SS	Sanitary Sewer
SW	Storm Sewer
HC	Handicapped
Bol.	Bollard
GM	Gas Meter
EB	Electric Box
EM	Electric Meter
Δ	Control Monument
LA	Landscape Area

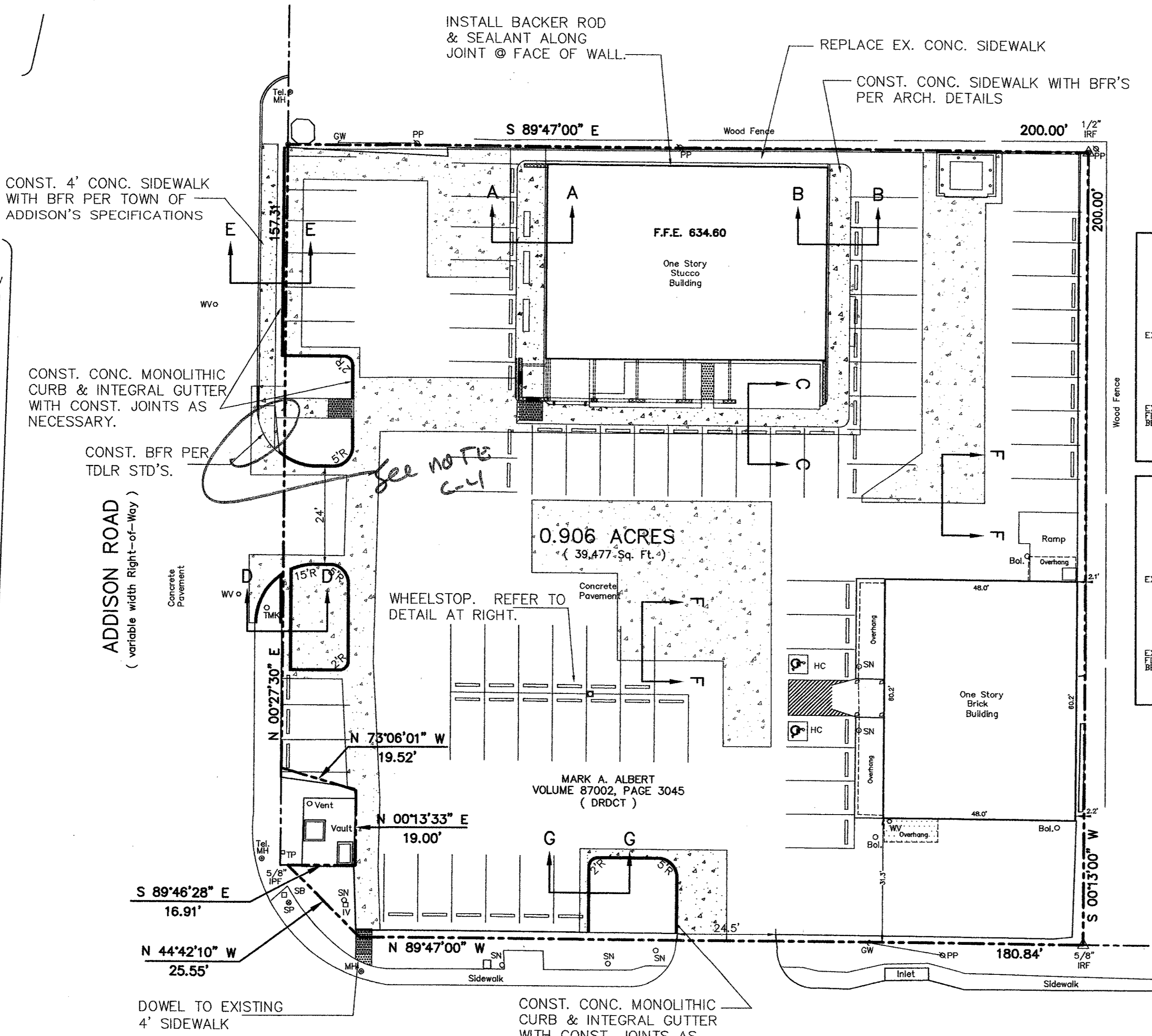

GW FISHER SURVEY ABSTRACT NO. 482

BENCHMARK

Coast and Geodetic Survey Monument stamped "E 921 1946". The mark is set vertically in the south wall of the brick grade school at Addison 4 feet east of the center of the entrance, 4.7 feet above the ground. A bronze disk set vertically in the south wall of brick school building known known as the Magic Time Machine Building. ELEVATION = 650.62 (NAVD88)

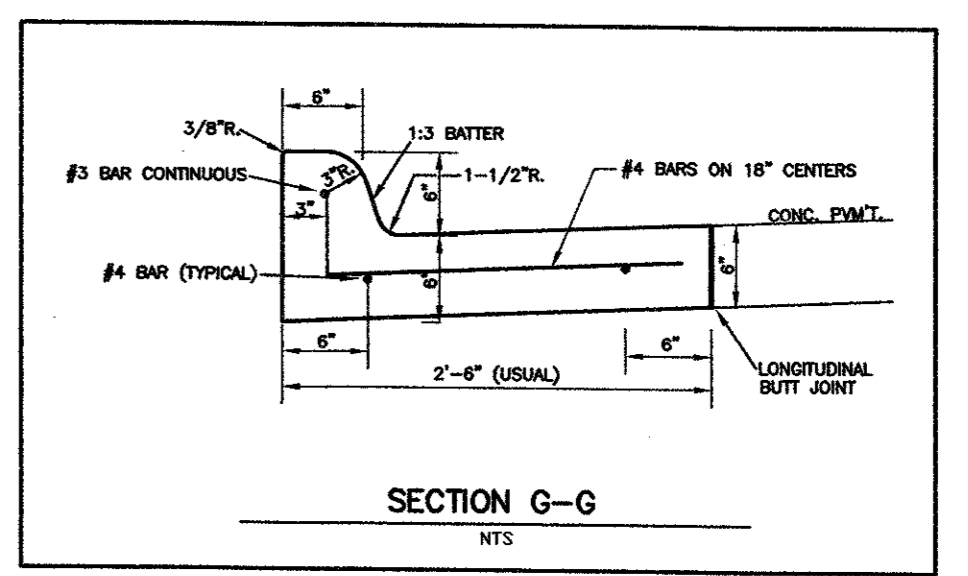
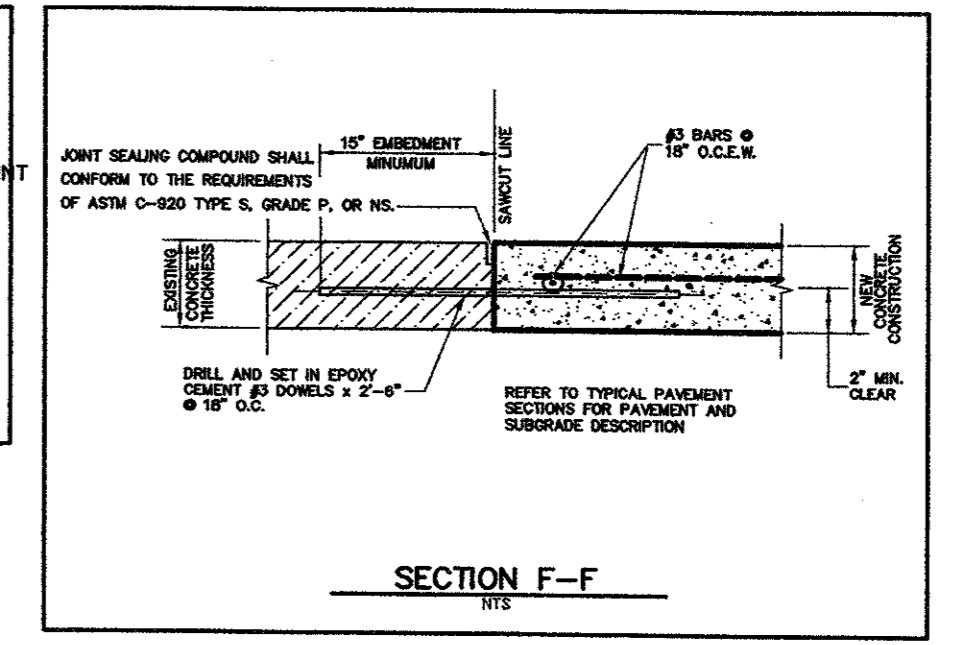
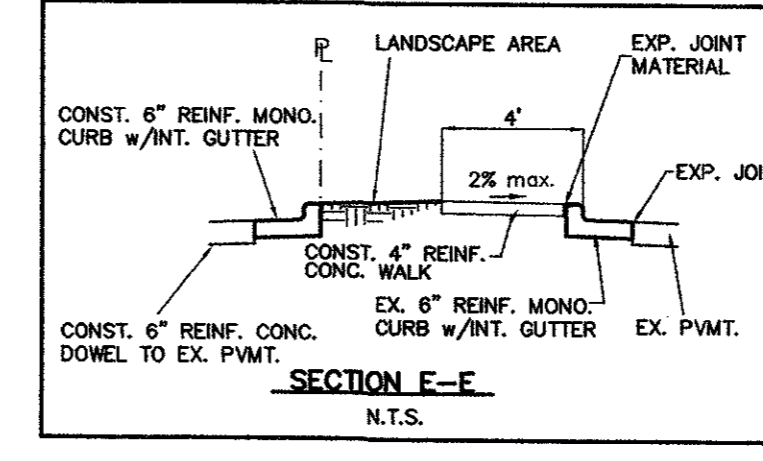
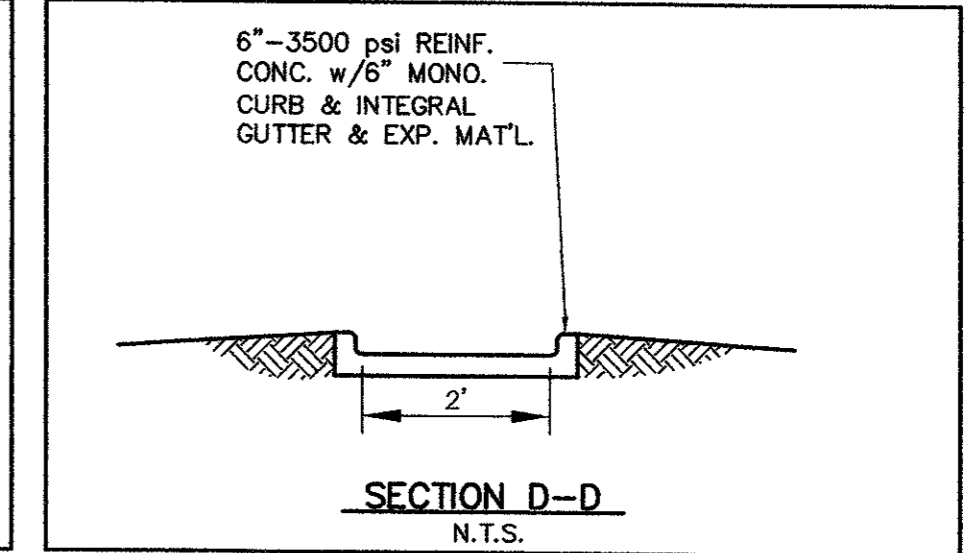
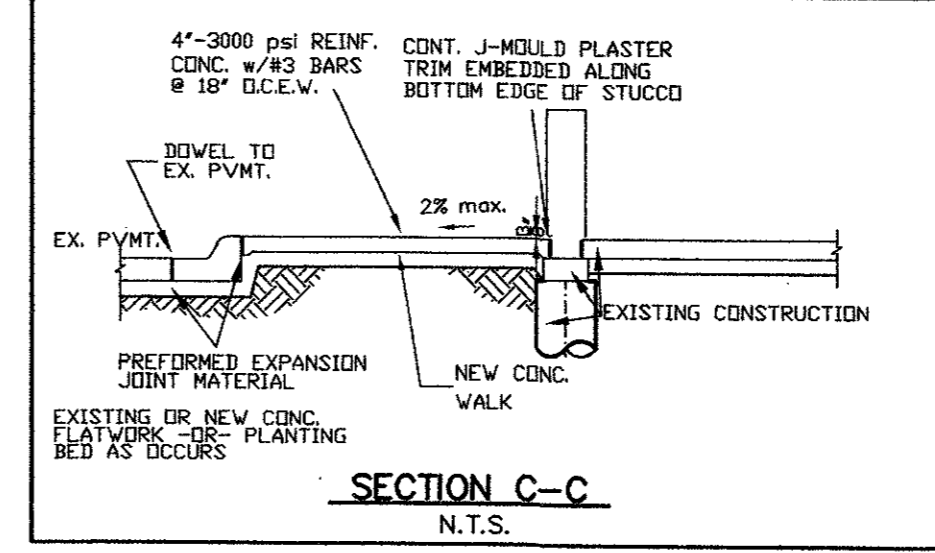
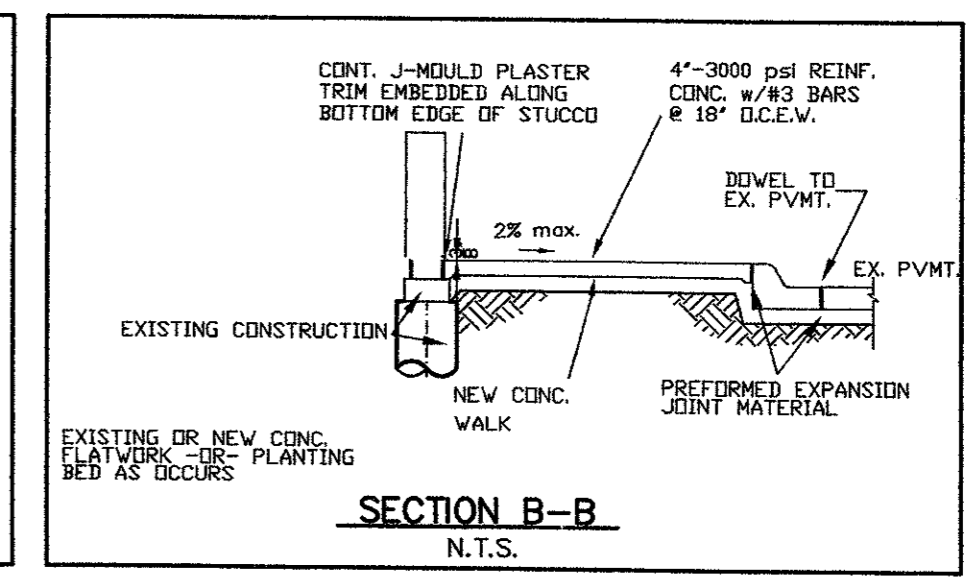
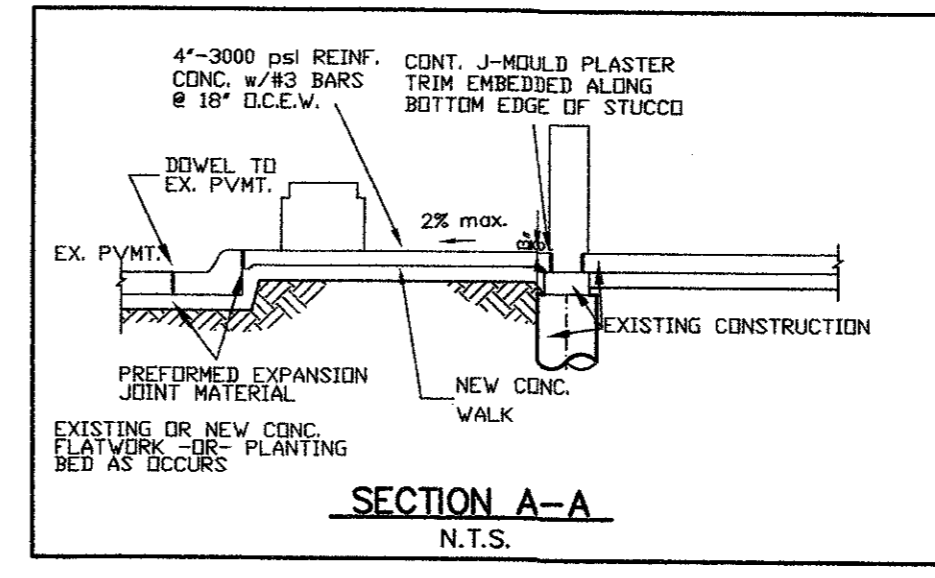
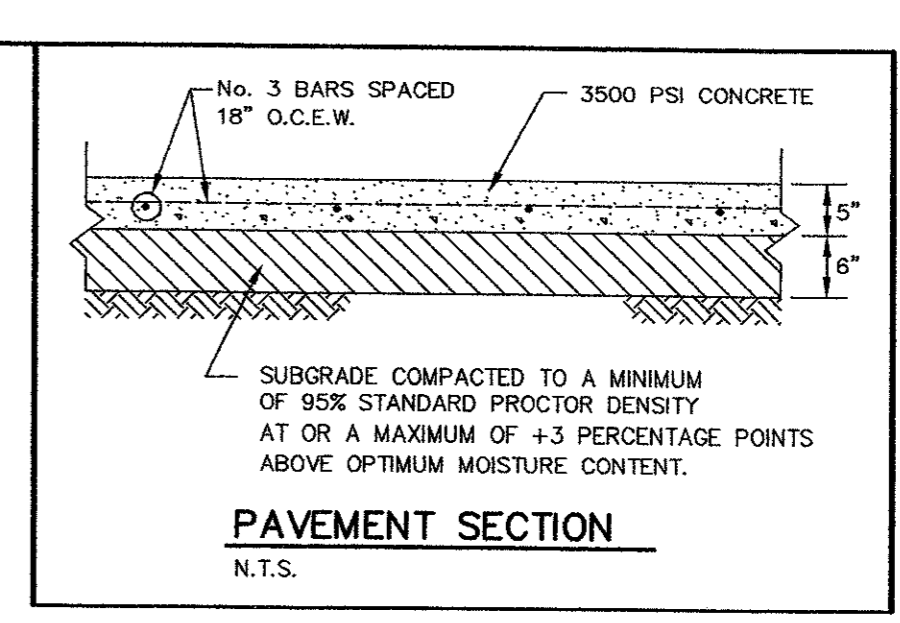
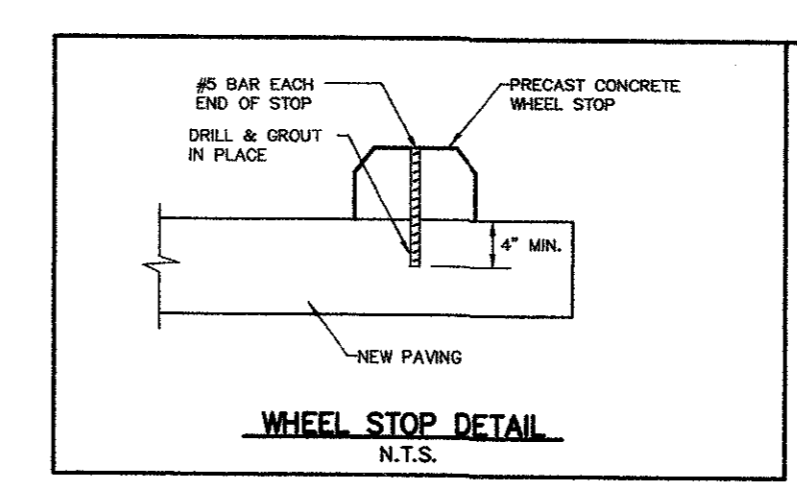

THESE CONSTRUCTION PLANS WERE PREPARED UNDER THE RESPONSIBLE SUPERVISION OF MICHAEL D. CLARK, A REGISTERED PROFESSIONAL ENGINEER NO. 63290

THE SEAL APPEARING ON THIS DOCUMENT WAS AUTHORIZED BY MICHAEL D. CLARK, P.E. #63290

Winkelmann & Associates, Inc.
 CONSULTING CIVIL ENGINEERS • SURVEYORS
 2220 W. WILSON AVE., SUITE 100
 DALLAS, TEXAS 75201
 (214) 462-7999 FAX
 (214) 462-7999

REGISTERED PROFESSIONAL ENGINEER
 MICHAEL D. CLARK
 63290

DATE	03/23/04
REVISION	
CITY COMMENTS	
APPROV.	
M.D.C.	

G.W. FISHER SURVEY, ABSTRACT NO. 482
 CITY OF ADDISON
 DALLAS COUNTY, TEXAS

BERNBAUM / MAGADINI ARCHITECTS
 4528 MCKINNEY AVENUE, SUITE 103
 DALLAS, TEXAS 75205

PAVING PLAN
ALBERT-ADDISON ADDITION
 LOT 1, BLOCK 1
 0.906 ACRES

Scale: 1" = 20' Date: 2/20/04
 Designed By: W.A.I.
 Drawn By: W.A.I.
 Checked By: M.D.C.
 File: 01407pav.dwg
 Project No.: 04107.01(20)

