

4.7 CURB RAMPS

TAS SECTIONS 4.7.2 - SLOPE
(REFERENCE DETAIL 3.1)
A. SLOPES OF CURB RAMPS SHALL COMPLY WITH 4.8.2.
B. MAXIMUM SLOPES OF ADJOINING OUTLETS, ROAD SURFACE IMMEDIATELY ADJACENT TO THE CURB RAMP, OR ACCESSIBLE ROUTE SHALL NOT EXCEED 1:20.

TAS SECTIONS 4.7.3 - WIDTH
(REFERENCE DETAIL 3.1)
A. THE MINIMUM WIDTH OF A CURB RAMP SHALL BE 36", EXCLUSIVE OF FLARED SIDES.

TAS SECTIONS 4.7.5 - SIDES OF CURB RAMPS
(REFERENCE DETAIL 3.1)
A. IF A CURB RAMP IS LOCATED WHERE IT IS NOT PROTECTED BY HANDRAILS OR GUARDRAILS, IT SHALL HAVE FLARED SIDES; THE MAXIMUM SLOPE OF THE FLARE SHALL BE 1:10.

TAS SECTIONS 4.7.10 - DIAGONAL CURB RAMPS
A. IF DIAGONAL CURB RAMPS HAVE RETURNED CURBS OR OTHER WELL-DEFINED EDGES, SUCH EDGES SHALL BE PARALLEL TO THE DIRECTION OF PEDESTRIAN FLOW. THE BOTTOM OF DIAGONAL CURB RAMPS SHALL HAVE 48" MINIMUM CLEAR SPACE. IF DIAGONAL CURB RAMPS ARE PROVIDED AT MARKED CROSSINGS, THE 48" CLEAR SPACE SHALL BE WITHIN THE MARKING. IF DIAGONAL CURB RAMPS HAVE FLARED SIDES, THEY SHALL ALSO HAVE AT LEAST A 24" LONG SEGMENT OF STRAIGHT CURB LOCATED ON EACH SIDE OF THE CURB RAMP AND WITHIN THE MARKED CROSSING.

TAS SECTIONS 4.7.11 - ISLANDS
A. ANY BARRIERS IN CROSSINGS SHALL BE CUT THROUGH LEVEL WITH THE STREET CURB RAMPS AT BOTH SIDES AND A LEVEL AREA AT LEAST 48" LONG BETWEEN THE CURB RAMPS IN THE PART OF THE ISLAND INTERSECTED BY THE CROSSINGS.

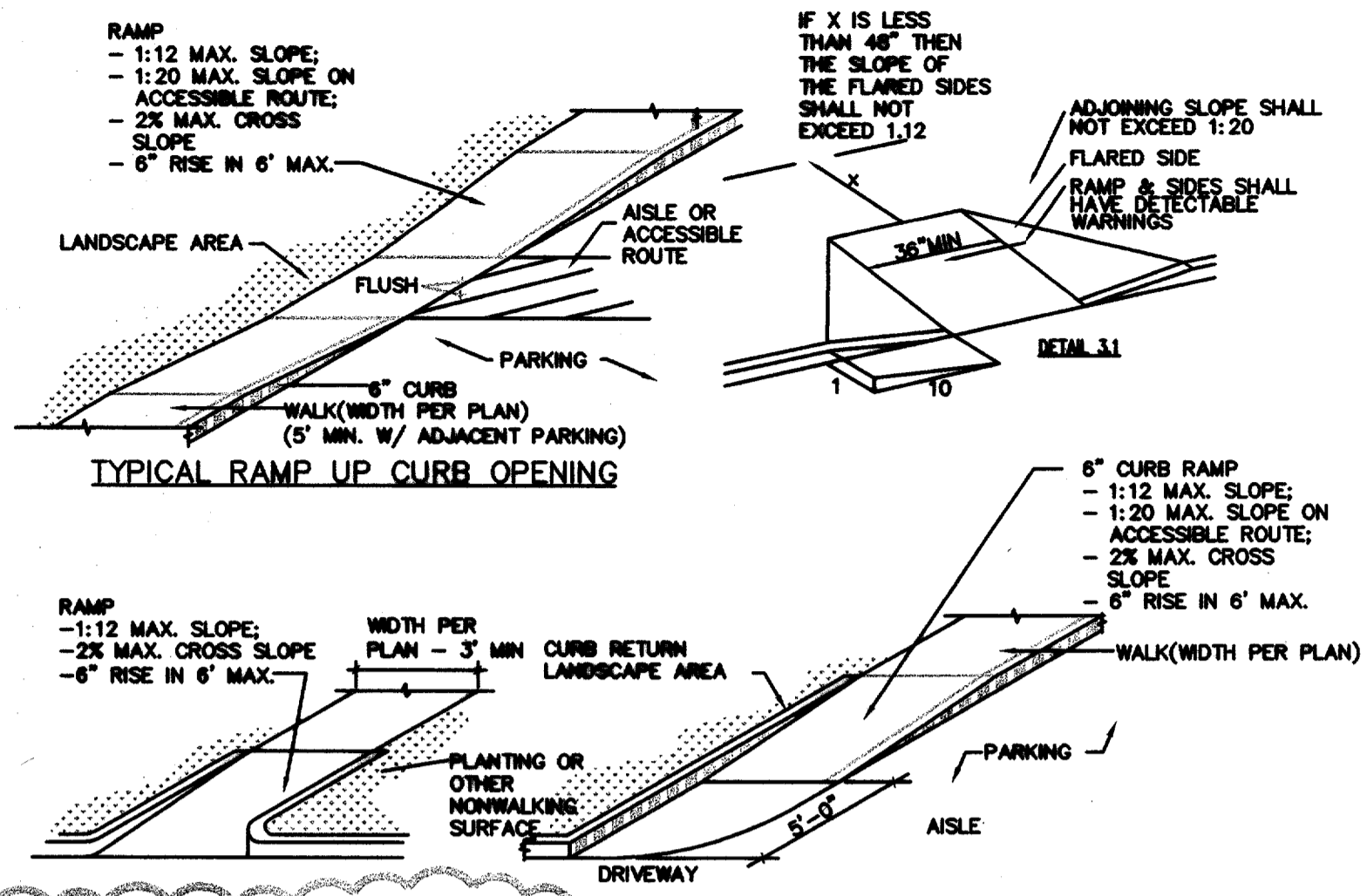

TYPICAL RAMP UP CURB OPENING

SECTION 4.7.4 TEXAS ARCHITECTURAL BARRIERS ACT:
SURFACES OF CURB RAMPS SHALL COMPLY WITH 4.5.
(1) TEXTURES SHALL CONSIST OF EXPOSED CURBED STONE AGGREGATE, ROUGHENED CONCRETE, RUBBER, RAISED ABRASIVE STRIPS OR GROOVES EXTENDING THE FULL WIDTH AND DEPTH OF THE CURB RAMP. SURFACES THAT ARE RAISED, ETCHED, OR GROOVED IN A WAY THAT WOULD ALLOW WATER TO ACCUMULATE ARE PROHIBITED.
(2) FOR PURPOSES OF WARNING, THE FULL WIDTH AND DEPTH OF CURB RAMPS SHALL HAVE A LIGHT REFLECTIVE VALUE AND TEXTURE THAT SIGNIFICANTLY CONTRASTS WITH THAT OF ADJOINING PEDESTRIAN ROUTES.

DETECTABLE WARNINGS SHALL CONSIST OF RAISED TRUNCATED DOMES WITH A DIAMETER OF NOMINAL 0.9 IN (23 MM), A HEIGHT OF NOMINAL 0.2 IN (5 MM) AND A CENTER-TO-CENTER SPACING OF NOMINAL 2.35 IN (60 MM) AND SHALL CONTRAST VISUALLY WITH ADJOINING SURFACES, EITHER LIGHT-ON-DARK, OR DARK-ON-LIGHT. THE MATERIAL USED TO PROVIDE CONTRAST SHALL BE AN INTEGRAL PART OF THE WALKING SURFACE. DETECTABLE WARNINGS USED ON INTERIOR SURFACES SHALL DIFFER FROM ADJOINING WALKING SURFACES IN RESILIENCY OR SOUND-ON-CAME CONTACT.

BARRIER FREE RAMPS
N.T.S.

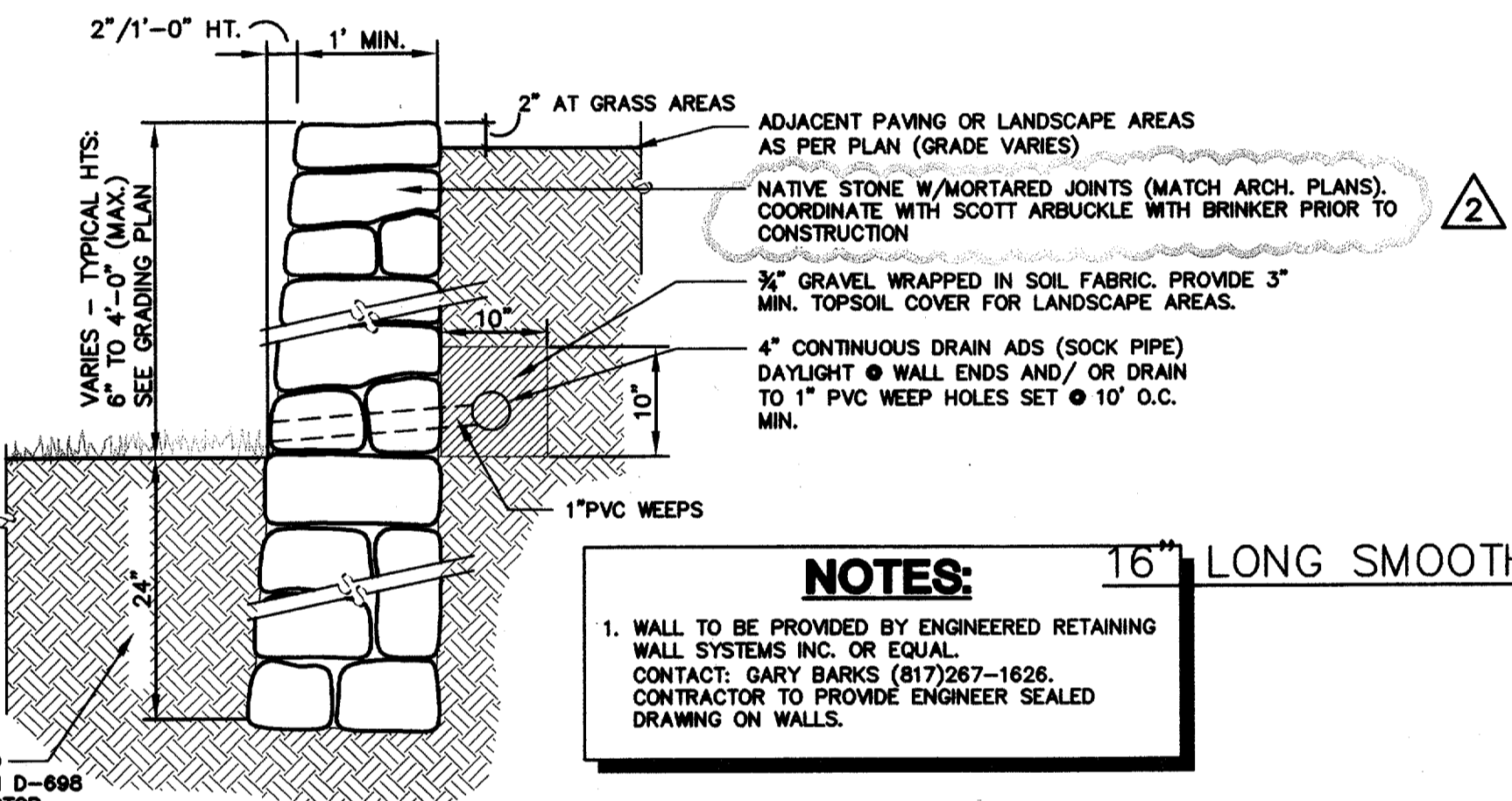

GRAVITY STONE WALL
N.T.S.

NOTES:
1. WALL TO BE PROVIDED BY ENGINEER RETAINING WALL SYSTEMS INC. OR EQUAL.
CONTACT: GARY BARKS (817)267-1626.
CONTRACTOR TO PROVIDE ENGINEER SEALED DRAWING ON WALLS.

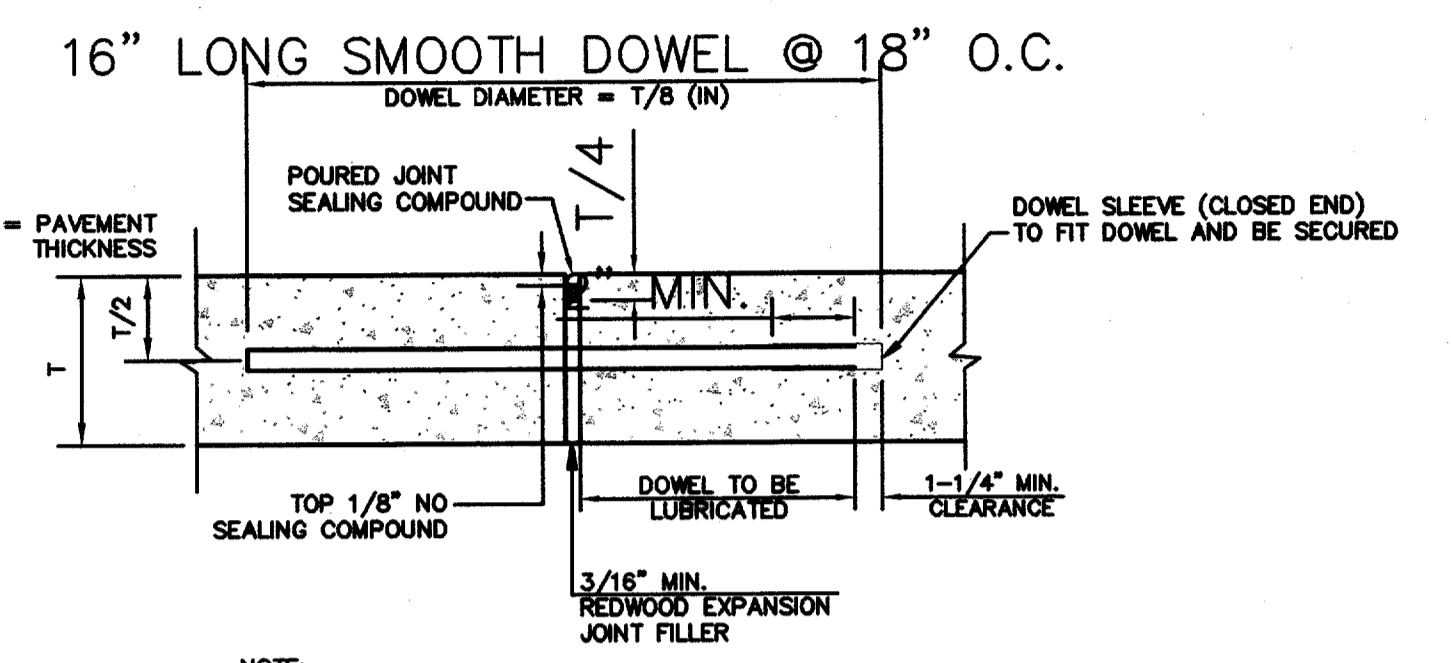

TRANSVERSE EXPANSION JOINT

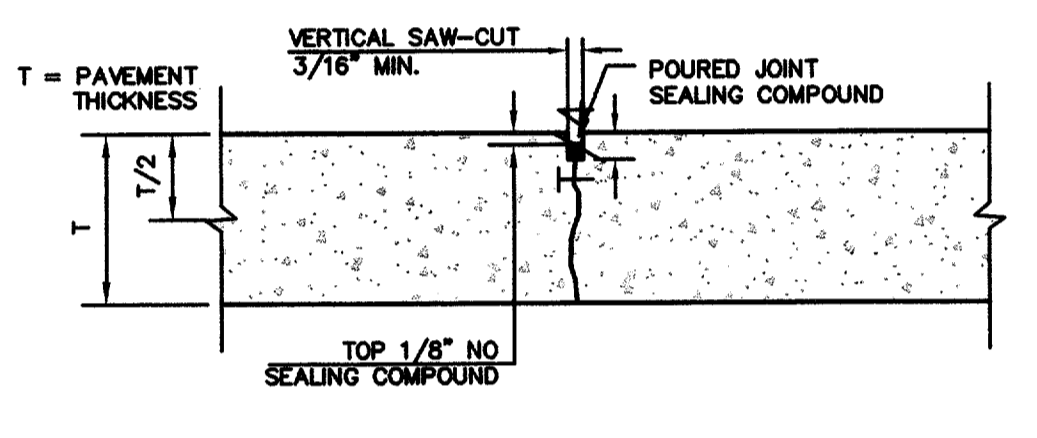

CONSTRUCTION JOINT

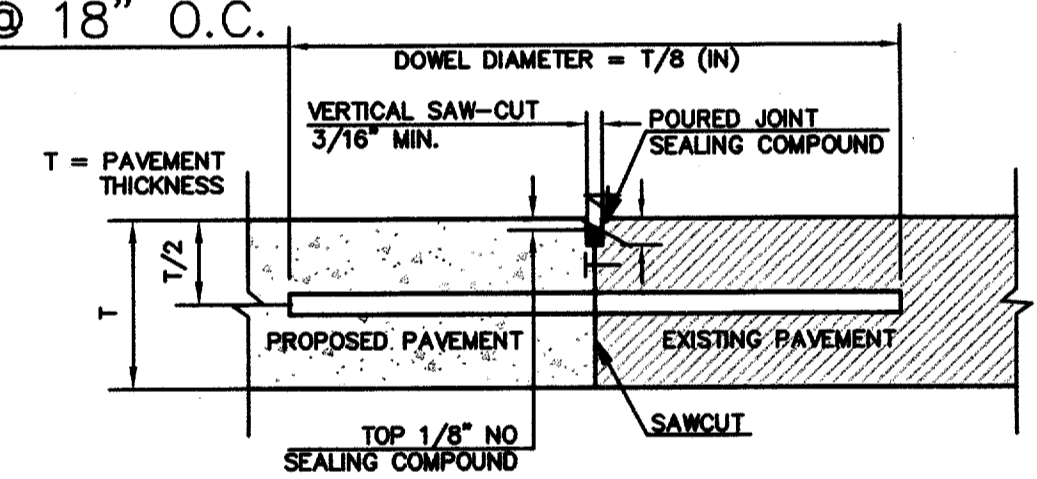

LONGITUDINAL BUTT JOINT

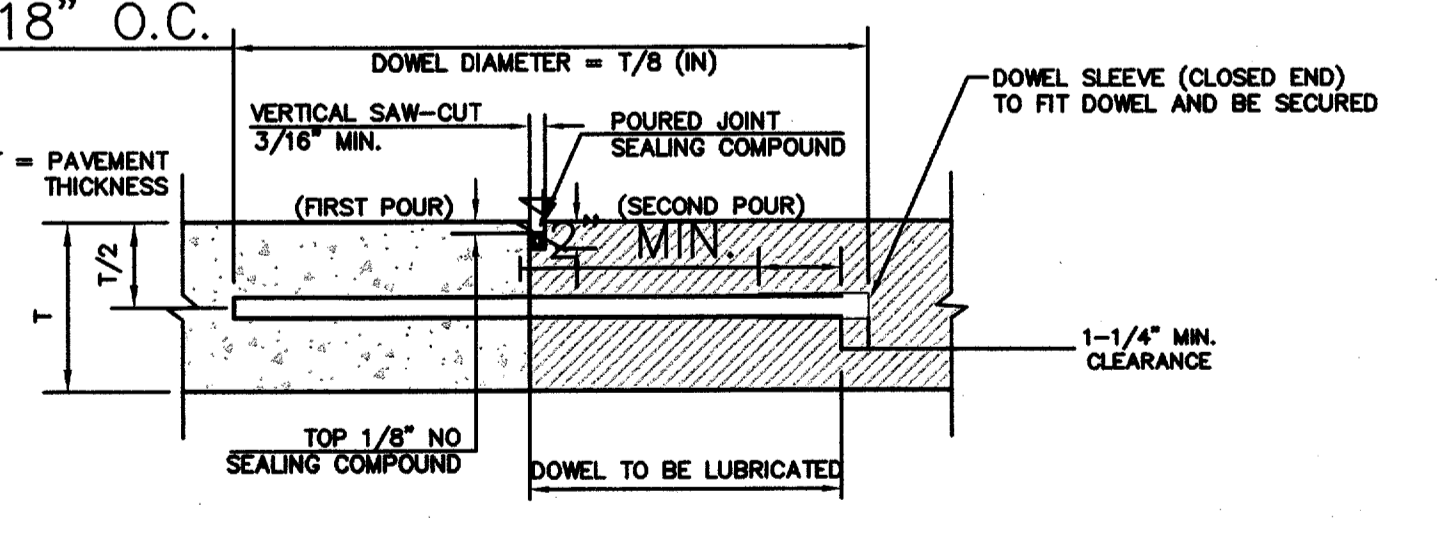

CONSTRUCTION JOINT

CONCRETE JOINT DETAILS
N.T.S.

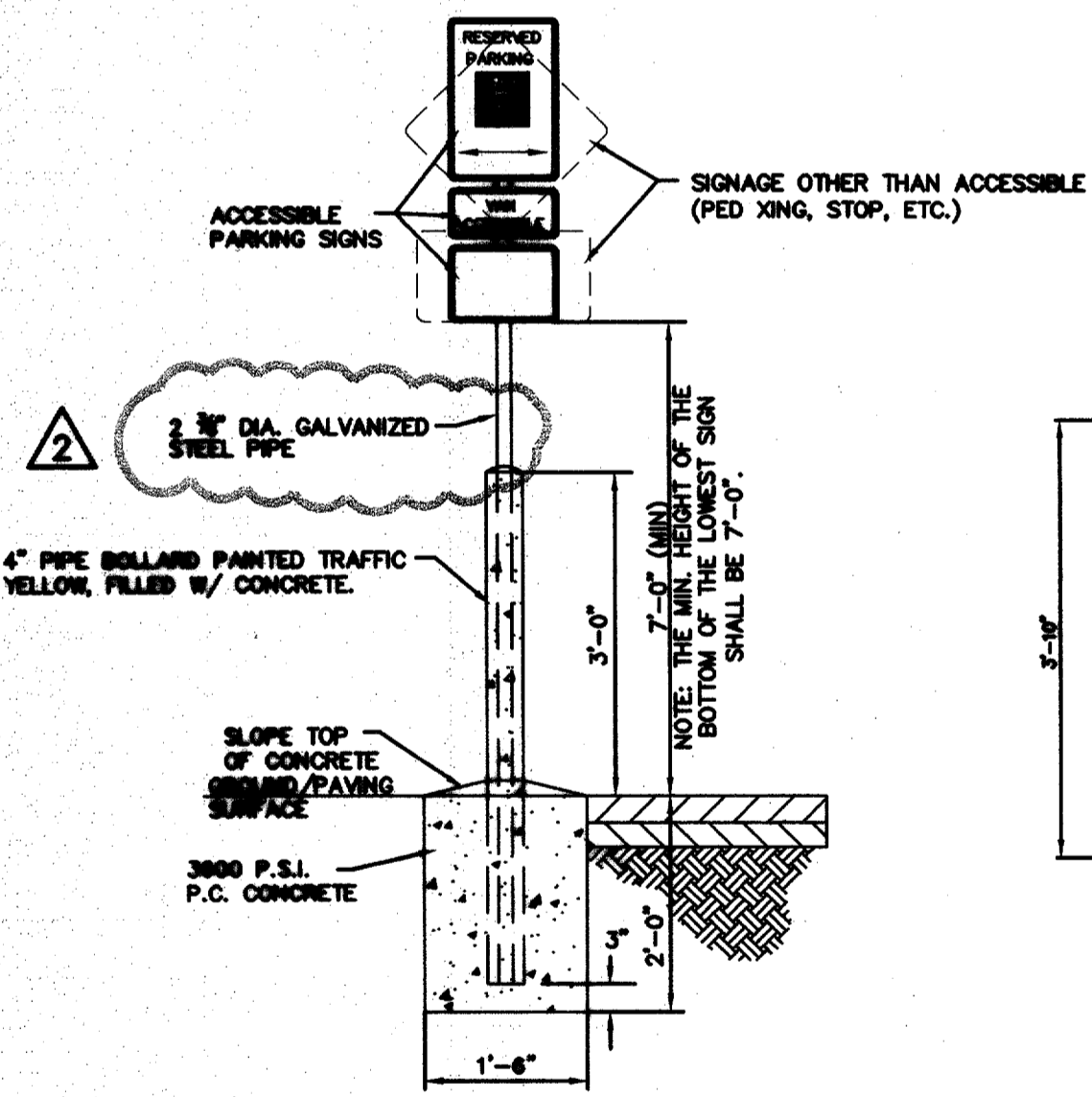

SITE SIGN BASE DETAIL
N.T.S.

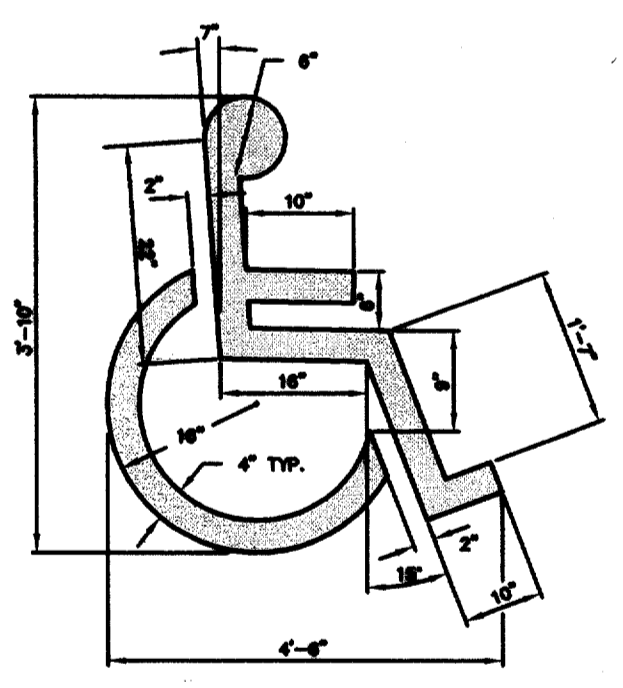

ACCESSIBLE PARKING SYMBOL
N.T.S.

ALL SIGNS SHALL COMPLY WITH U.S. DEPARTMENT OF TRANSPORTATION, FEDERAL HIGHWAY ADMINISTRATION'S "MANUAL OF UNIFORM TRAFFIC CONTROL DEVICES", LOCAL CODES AND AS SPECIFIED. MOUNT SIGNS TO POST IN ACCORDANCE WITH MANUFACTURER'S INSTRUCTIONS.

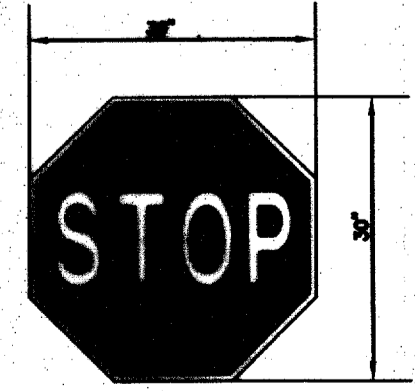

R1-1
WHITE LEGEND RED BACKGROUND

"STOP" SIGN
N.T.S.

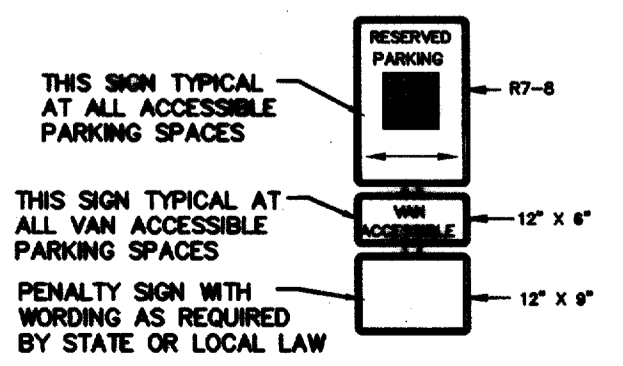

"ACCESSIBLE PARKING" SIGN
N.T.S.

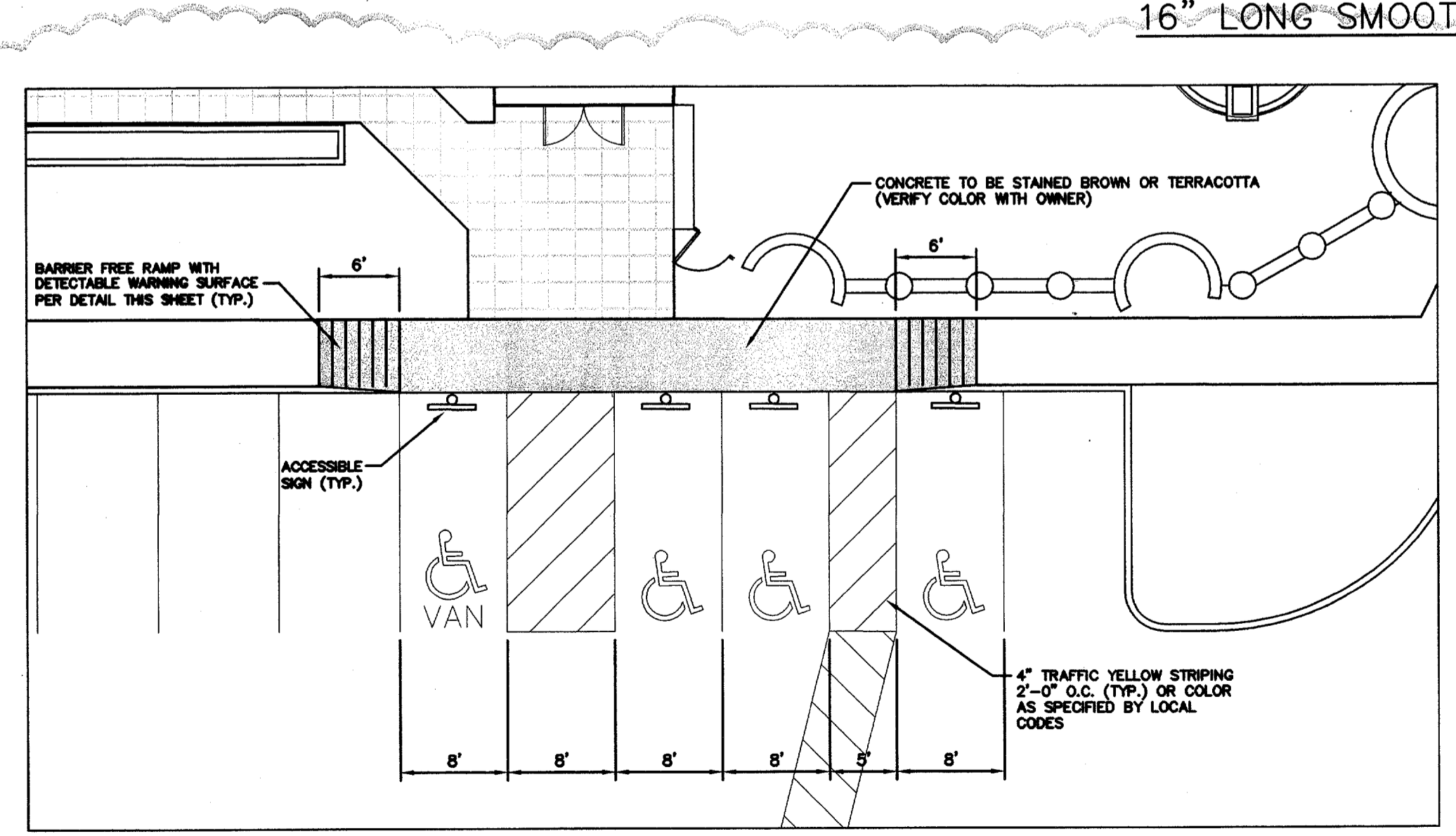

PARKING LOT STRIPING DETAILS
N.T.S.

"RECORD DRAWING"
THIS DRAWING HAS BEEN REVISED TO SHOW THOSE CHANGES DURING THE CONSTRUCTION PROCESS REPORTED BY THE CONTRACTOR TO KIMLEY-HORN AND ASSOCIATES, INC. AND CONSIDERED TO BE SIGNIFICANT. THIS DRAWING IS NOT GUARANTEED TO BE "AS-BUILT" BUT IS BASED ON THE INFORMATION MADE AVAILABLE.
DATE: 11-17-05 BY: [Signature]

Kimley-Horn and Associates, Inc.
Tel. No. (972) 770-1300
Fax No. (972) 239-3620
12700 Park Central Drive, Suite 1800
Dallas, Texas 75251

BRIAN J. PARKER
90248
REGISTERED PROFESSIONAL ENGINEER

PROTOTYPE 9.3
OTB RELOCATION
OTB ADDISON
BELTLINE ROAD
ADDISON, TEXAS

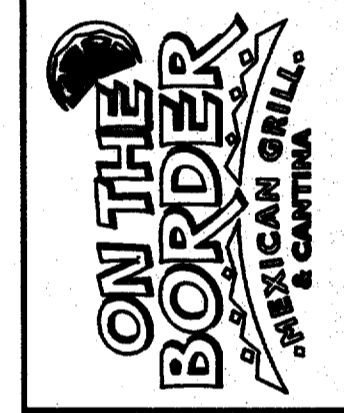

MISCELLANEOUS CONSTRUCTION DETAILS

Scale: AS SHOWN
Designed by: ABC
Drawn by: ABC
Checked by: BJP
Date: MAY 2005
Project No. 063984003

SHEET C-11 OF 12

File: C:\DATA\3384003\3384003.dwg 11/17/2005 8:11 AM
Plot: 3384003.dwg 11/17/2005 8:11 AM
Plotter: HP-GL/2 Plotter
Scale: 1/8" = 1'-0"