

ADDISON ROAD
(VARIABLE WIDTH PUBLIC RIGHT-OF-WAY)

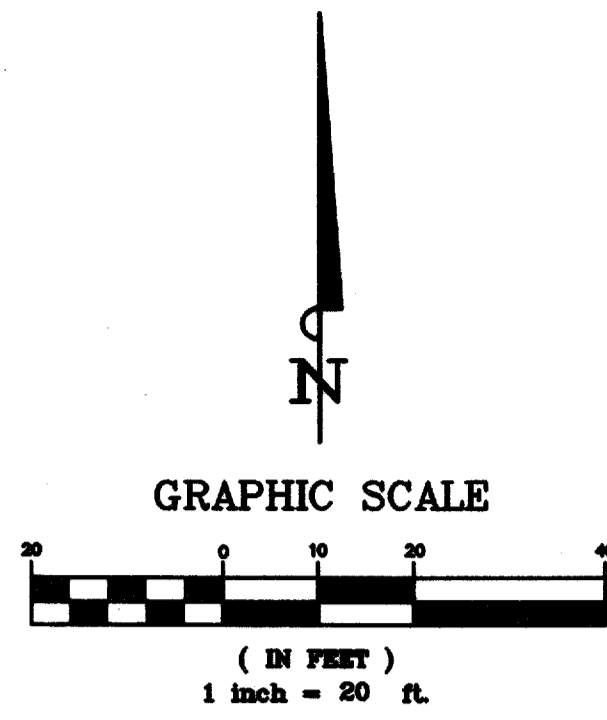

TOTAL SHEETFLOW FROM QUORUM DR. AND BELTLINE RD. TO THIS POINT = 37.4 cfs

REMAINDER OF LOT 1, BLOCK BELTWAY-CENTRE ADDITION VOL. 2004014, PG. 00009 D.R.D.C.T. (ZONED C-1)

LEGEND

- 635 — PROPOSED CONTOUR
- - - - - EXISTING CONTOUR
- FLOW ARROW
- - - - - DRAINAGE AREA BOUNDARY
- GRATE INLET
- ▣ CURB INLET
- — — — — PROPERTY BOUNDARY
- ① 1.0 10.35 DRAINAGE AREA DESIGNATION
- ② 0.07 0.55 DRAINAGE AREA (ACRES)
- ③ 0.10 0.79 QUANTITY OF FLOW (CFS)

DRAINAGE CALCULATIONS										
DRAINAGE AREA	C	Tc (min)	AREA (acres)	I25 (in/hr)	Q25 (cfs)	I50 (in/hr)	Q50 (cfs)	I100 (in/hr)	Q100 (cfs)	REMARKS
1	0.90	10	1.00	7.29	6.56	8.01	7.21	8.74	7.87	TO 5' CURB INLET
2	0.90	10	0.07	7.29	0.46	8.01	0.50	8.74	0.55	TO 5' CURB INLET
3	0.90	10	0.10	7.29	0.66	8.01	0.72	8.74	0.79	ROOF DRAIN
4	0.90	10	0.07	7.29	0.46	8.01	0.50	8.74	0.55	TO BELTLINE RD.
5	0.90	10	0.07	7.29	0.46	8.01	0.50	8.74	0.55	TO 6-12"x12" GRATE INLETS
6	0.90	10	0.04	7.29	0.26	8.01	0.29	8.74	0.31	ROOF DRAIN
7	0.90	10	0.04	7.29	0.26	8.01	0.29	8.74	0.31	TO 12"x12" GRATE INLET
8	0.90	10	0.02	7.29	0.13	8.01	0.14	8.74	0.16	SERVICE YARD TO SAN. SEW.
9	0.90	10	0.02	7.29	0.13	8.01	0.14	8.74	0.16	ROOF DRAIN
10	0.90	10	0.02	7.29	0.13	8.01	0.14	8.74	0.16	TO 2-12"x12" GRATE INLETS
11	0.90	10	0.75	7.29	4.92	8.01	5.41	8.74	5.90	OFFSITE TO THE NORTH
12	0.90	10	0.39	7.29	2.56	8.01	2.81	8.74	3.07	TO 2'x2' DROP INLET
13	0.90	10	0.12	7.29	0.79	8.01	0.86	8.74	0.94	TO EX. CURB INLET ON ADDISON RD.

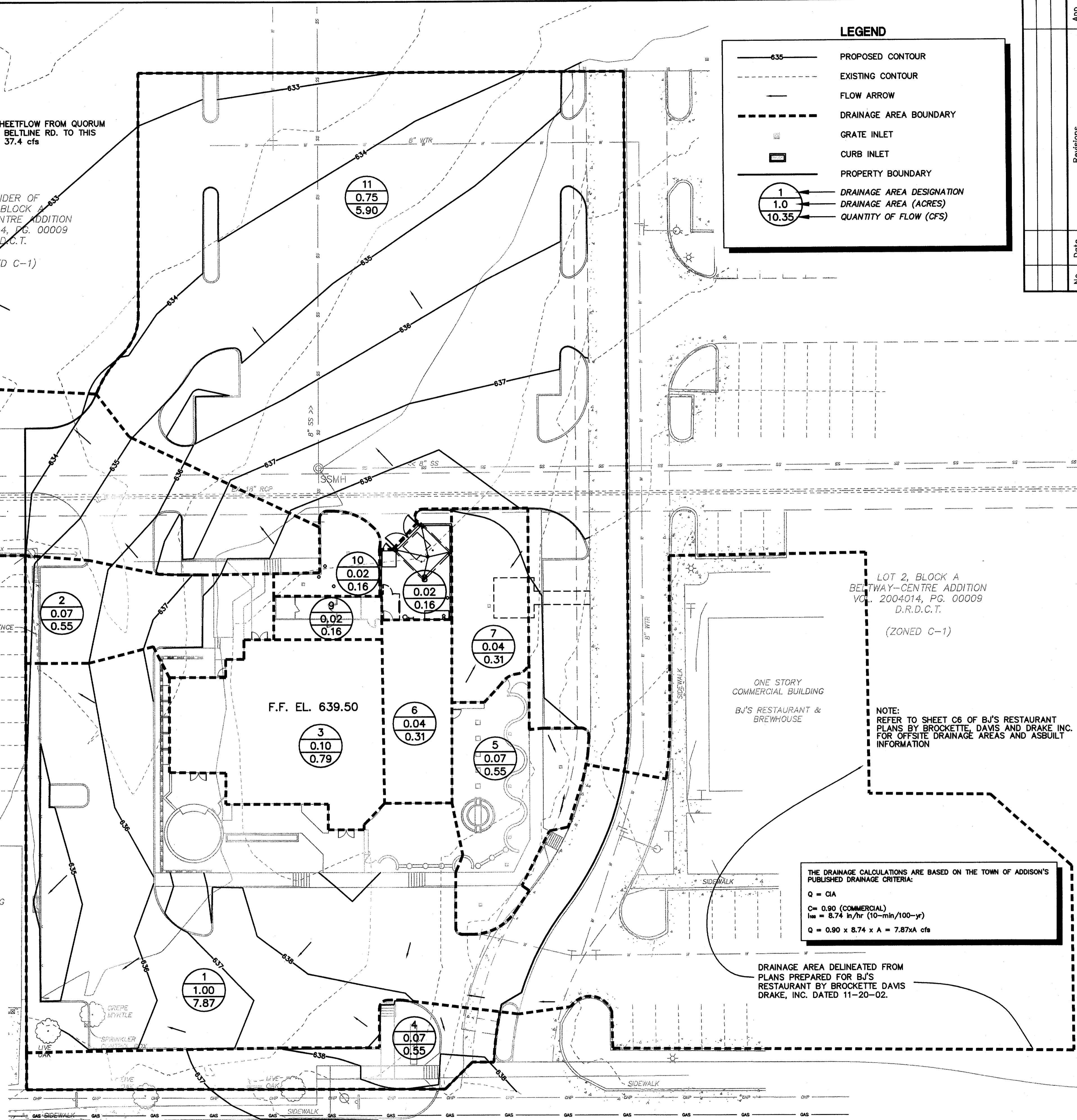

THE DRAINAGE CALCULATIONS ARE BASED ON THE TOWN OF ADDISON'S PUBLISHED DRAINAGE CRITERIA:
 Q = CIA
 C = 0.90 (COMMERCIAL)
 Ia = 8.74 in/hr (10-min/100-yr)
 Q = 0.90 x 8.74 x A = 7.874A cfs

DRAINAGE AREA DELINEATED FROM PLANS PREPARED FOR BJ'S RESTAURANT BY BROCKETTE DAVIS DRAKE, INC. DATED 11-20-02.

BELT LINE ROAD
(100-FOOT WIDE PUBLIC RIGHT-OF-WAY)

"RECORD DRAWING"
 THIS DRAWING HAS BEEN REVISED TO SHOW THOSE CHANGES DURING THE CONSTRUCTION PROCESS REPORTED BY THE CONTRACTOR TO KIMLEY-HORN AND ASSOCIATES, INC. AND CONSIDERED TO BE SIGNIFICANT. THIS DRAWING IS NOT GUARANTEED TO BE "AS-BUILT" BUT IS BASED ON THE INFORMATION MADE AVAILABLE.
 DATE: 11-17-05 BY: *[Signature]*

BENCHMARK:
 WATER DEPARTMENT BENCHMARK IN CENTER OF SOUTH CONCRETE HEADWALL OF A 6'X3'X46" CONCRETE BOX CULVERT ON SOUTH SIDE OF BELT LINE ROAD AND 22.7 FEET EAST OF CENTERLINE OF ST. LOUIS & SOUTHWESTERN RAILROAD AT ADDISON ROAD.
 ELEVATION = 634.15

Kimley-Horn and Associates, Inc.
 Tel. No. (972) 778-1300
 Fax No. (972) 258-6560
 12700 Park Central Drive, Suite 1800
 Dallas, Texas 75251

BRIAN J. PARKER
 90248
 REGISTERED PROFESSIONAL ENGINEER

PROTOTYPE 9.3
 OTB RELOCATION
 OTB ADDISON
 BELTLINE ROAD
 ADDISON, TEXAS

ON THE BORDER
 AMERICAN GRILL & CANTINA

DRAINAGE AREA MAP

Scale: AS SHOWN
 Designed by: ABC
 Drawn by: ABC
 Checked by: BJP
 Date: MAY 2005
 Project No. 063984-003

SHEET C-5 OF 12