

FIRE HYDRANT NOTES:

1. IN GENERAL ALL FIRE HYDRANTS SHALL CONFORM TO AWWA STANDARDS SPECIFICATIONS FOR FIRE HYDRANTS FOR ORDINARY WATER WORKS SERVICE FOR WATER AND SANITARY SEWER IMPROVEMENTS. FIRE HYDRANTS SHALL HAVE A 5-1/4" MINIMUM VALVE OPENING AND WITH A BARREL APPROXIMATELY 7" INSIDE DIAMETER. ALL HYDRANTS SHALL BE EQUIPPED WITH A BREAKAWAY FLANGE. ALL HYDRANTS SHALL BE APPROVED BY THE TOWN OF ADDISON.
2. ACCEPTABLE FIRE HYDRANTS IN ADDISON ARE MUELLER CENTURAN, OR APPROVED EQUAL.
3. FIRE HYDRANT PAINT:
VITRA-GARD
RUST NO MORE
HEAVY DUTY GLOSS
FOREST GREEN 3844-6 ----- ENAMEL
SATIN WHITE ----- POLY URETHANE

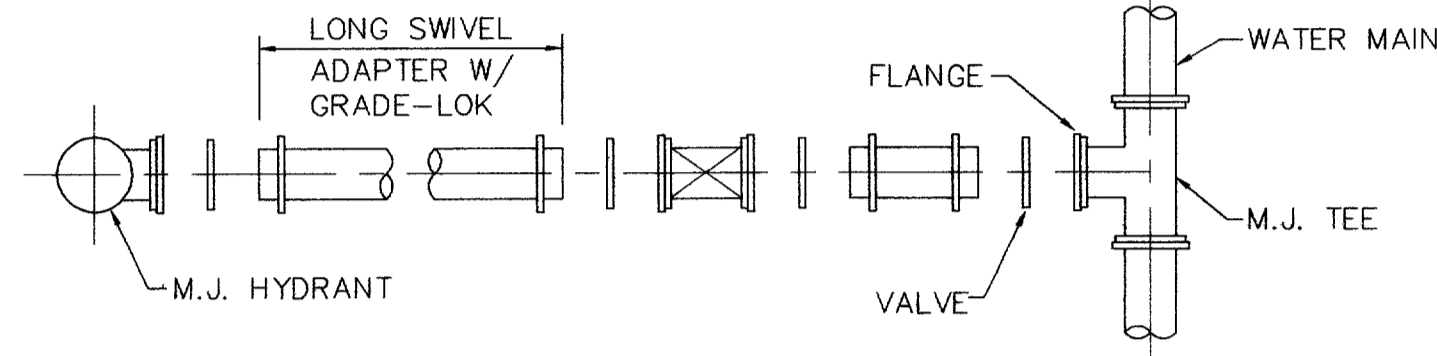

TYPICAL FIRE HYDRANT INSTALLATION
N.T.S.

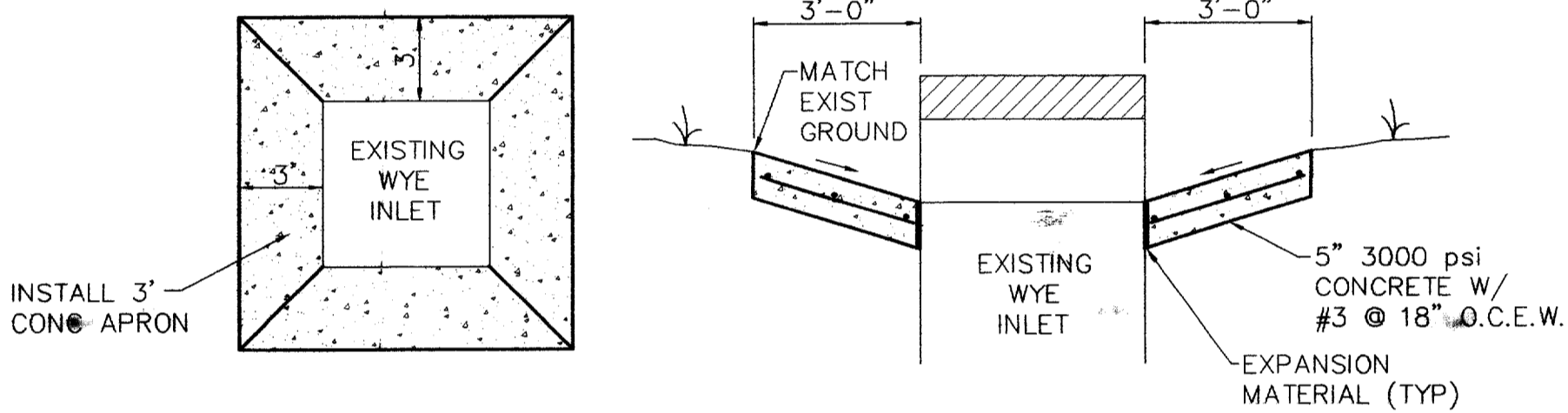

EXISTING WYE INLET CONCRETE APRON DETAIL
N.T.S.

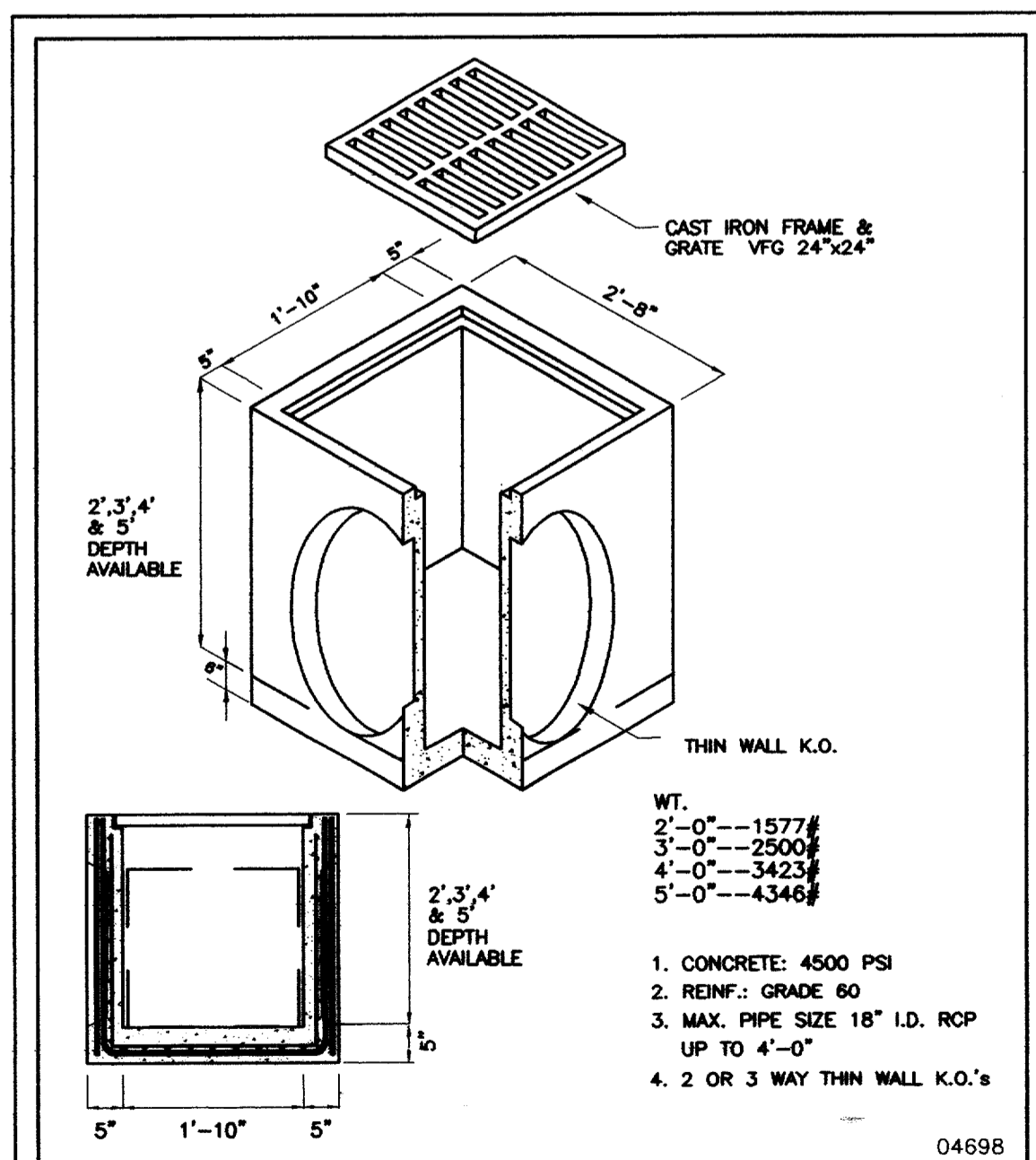

CATCH BASIN NO. 24



American Industrial Pre-Cast Products, Inc.
P.O. BOX 365 ALVARADO, TEXAS 76009. METRO: 817-477-5286
501 EAST BAXTER SEGUIN, TEXAS 78155 210-401-0555

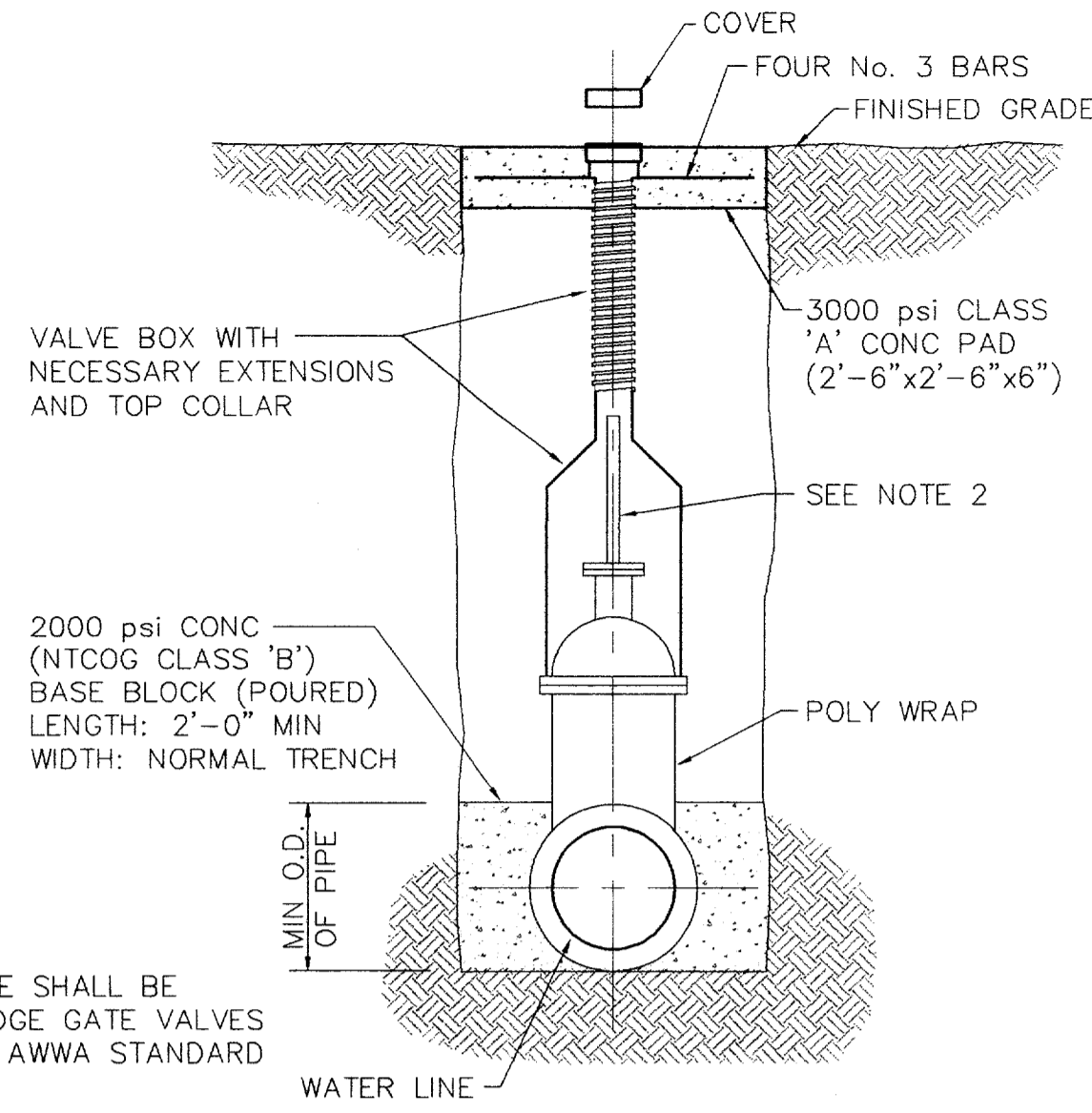

VALVE SETTING & BOX
N.T.S.

WATER VALVE NOTES:

1. 4" TO 12" GATE VALVE SHALL BE RESILIENT SEATED WEDGE GATE VALVES IN ACCORDANCE WITH AWWA STANDARD C-509
2. A PERMANENTLY ATTACHED VALVE EXTENSION STEM SHALL BE REQUIRED FOR ANY VALVE WHOSE OPERATING NOT IS LOCATED IN EXCESS OF 4 FEET BELOW THE TOP OF VALVE BOX. THIS EXTENSION SHALL BE OF SUFFICIENT LENGTH TO INSURE THAT ITS TOP IS WITHIN 4" OF THE VALVE BOX COVER.
3. VALVE SHALL BE WRAPPED IN POLY WRAP.
4. VALVE PAD SHALL BE 6 INCHES THICK AND BE 3000 PSI CONCRETE.

VALVE BOX PAD PLAN
N.T.S.

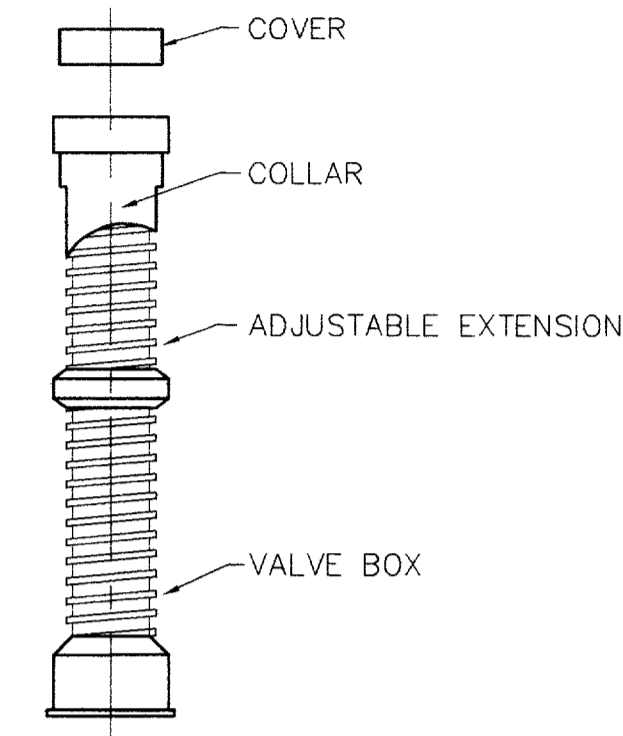
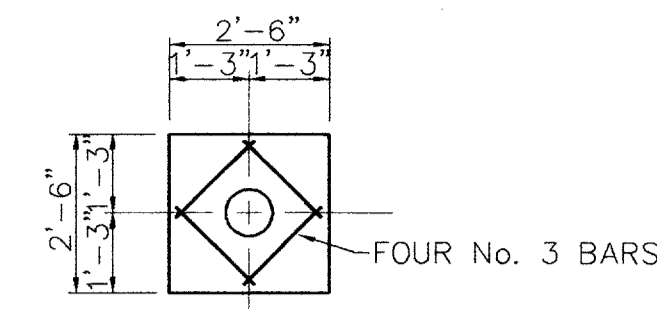

VALVE BOX WITH EXTENSION
N.T.S.

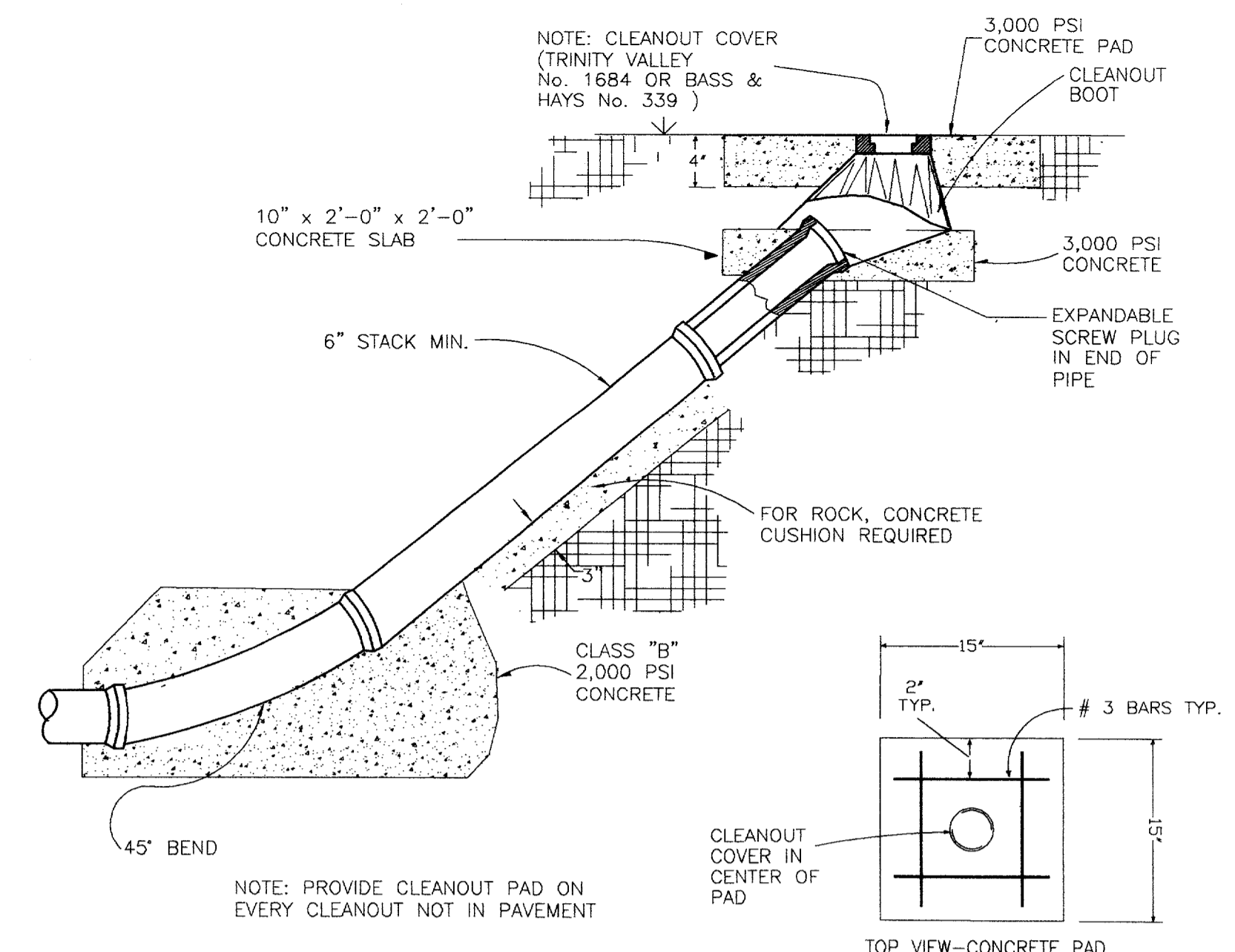

SANITARY SEWER CLEANOUT
N.T.S.

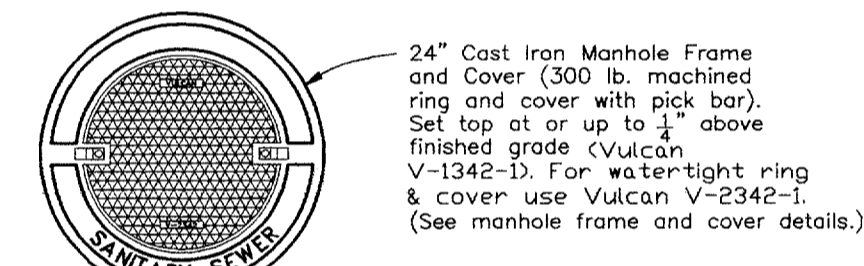

Manholes constructed within 100 year Flood plain shall have water-tight ring and lid.

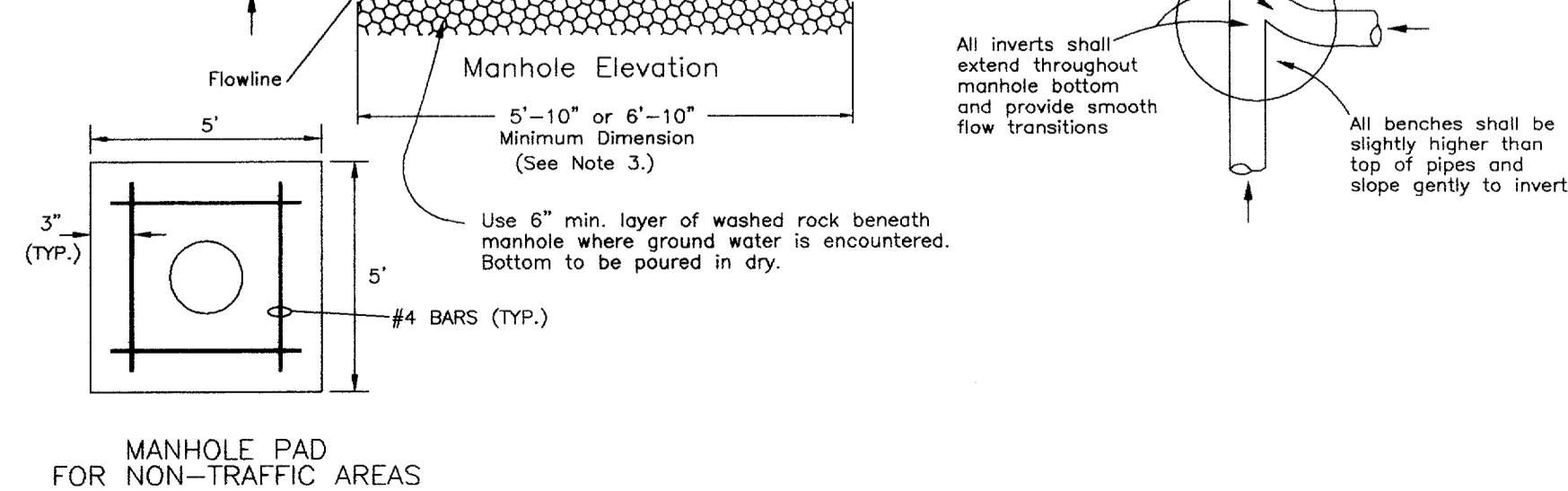
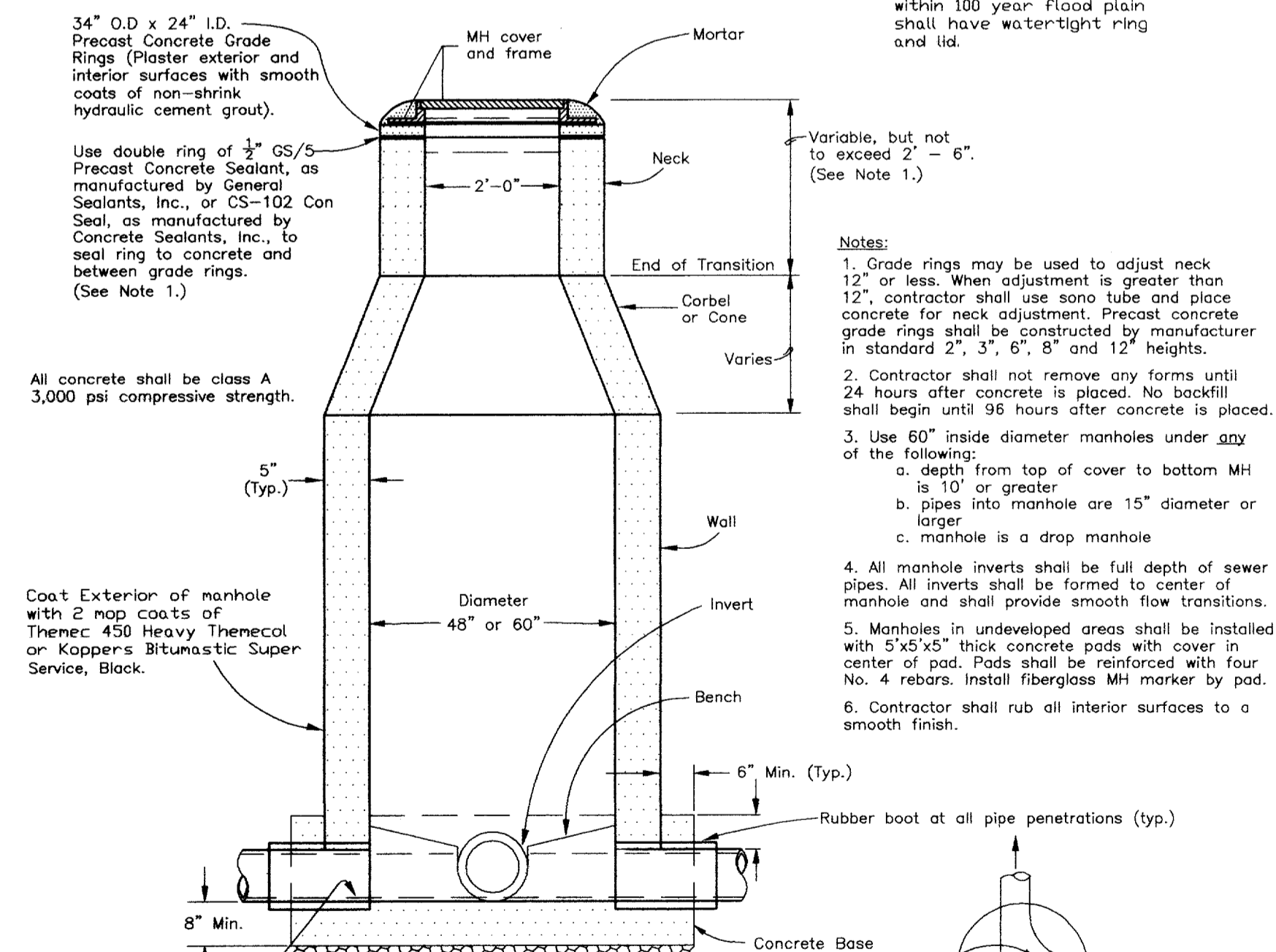

CAST-IN-PLACE SANITARY SEWER MANHOLE
N.T.S.

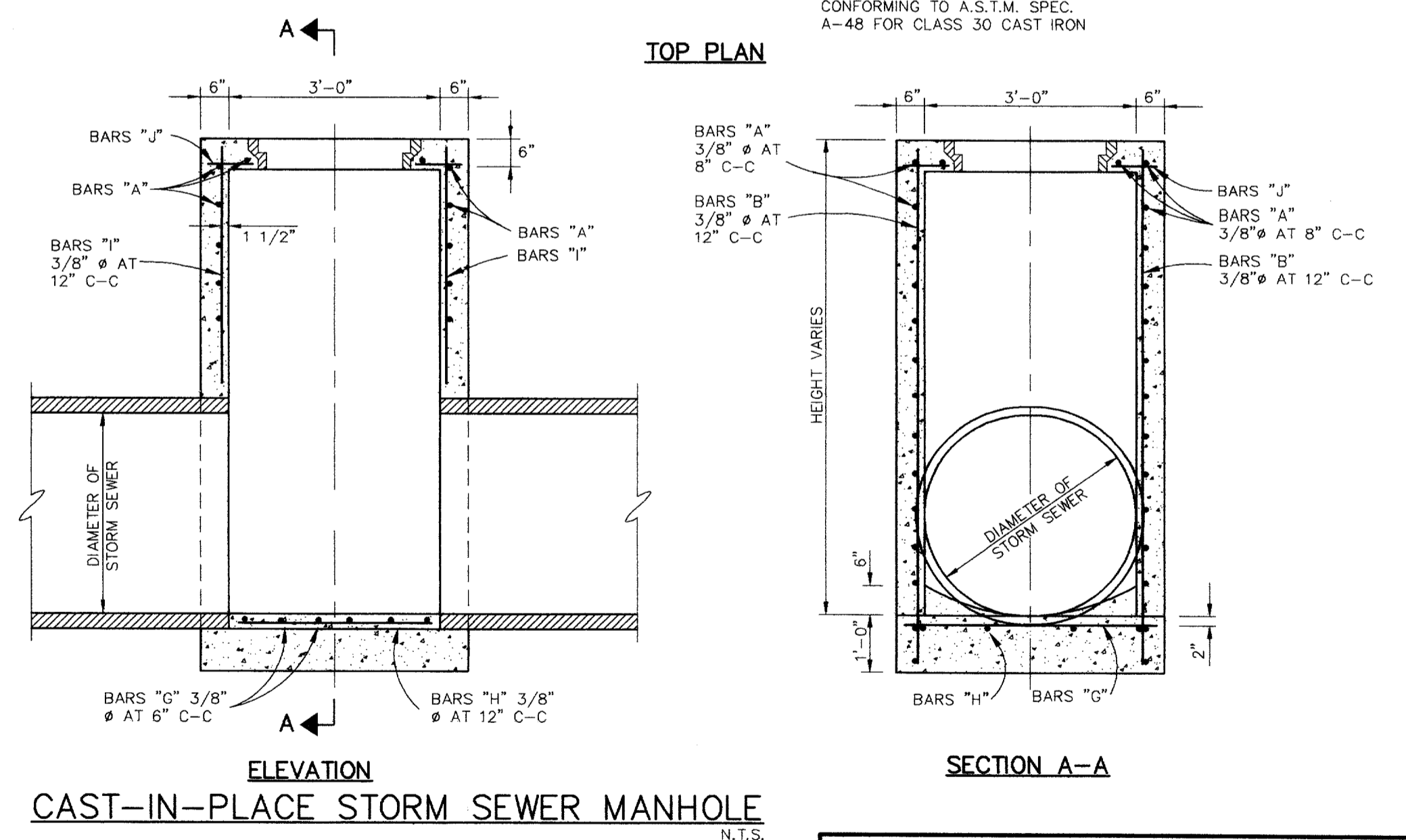
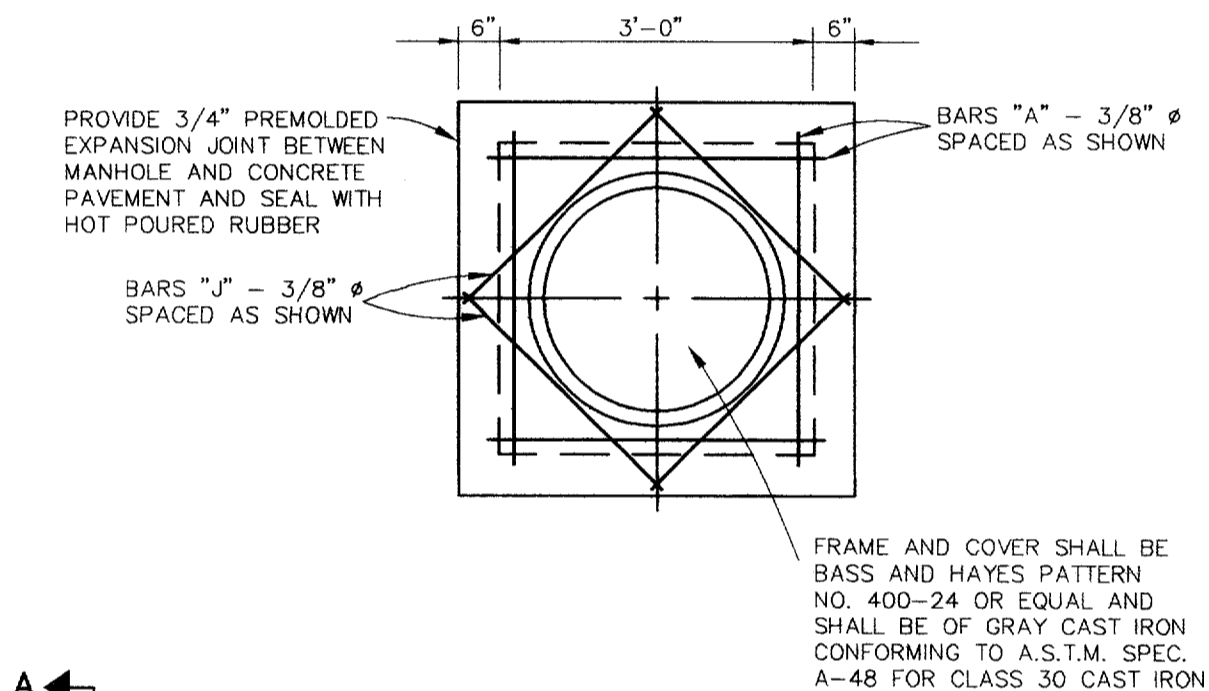

AS-BUILT

NOTE: THESE PLANS HAVE BEEN REVISED TO CONFORM WITH CONSTRUCTION RECORDS PROVIDED BY CONTRACTOR.

BENCHMARK: TOP OF BRASS DISK FOUND ON SOUTHWEST CORNER OF 8' RECESSED CURB INLET ON EAST SIDE OF ADDISON ROAD, 275± NORTH OF BELT LINE ROAD.
ELEV.=631.82'

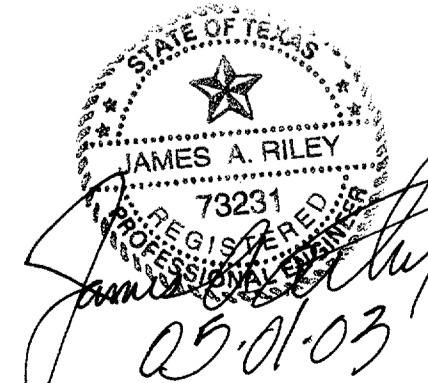

DETAILS						
BJ'S RESTAURANT						
LOT 2, BLOCK A OF						
BELTWAY CENTRE ADDITION						
TOWN OF ADDISON						
DALLAS COUNTY, TEXAS						
BROCKETTE • DAVIS • DRAKE, INC.						
consulting engineers						
Civil & Structural Engineering • Surveying						
4144 North Central Expressway, Suite 1100 • Dallas, Texas 75204						
(214) 824-3647 • fax (214) 824-7064						
DESIGN	DRAWN	DATE	SCALE	NOTES	FILE	NO.
JAR	BLM	11/19/02	NTS	BDD	C02132	C14

DET-BUILDING