

PAVING GENERAL NOTES

- All fill shall be compacted to 95% Standard Proctor Density in a maximum of 6" (six) inch lifts or per Geotechnical Engineers Report.
- Paving Contractor is responsible for all lay down curbs at intersections where barrier free ramps are to be constructed.
- The contractor shall provide, construct, and maintain barricades and signs in accordance with the Texas Manual of Uniform Traffic Control Devices.
- Sawed joints shall be every 15 feet for 6" thick concrete and every 20 feet for 8" thick concrete.

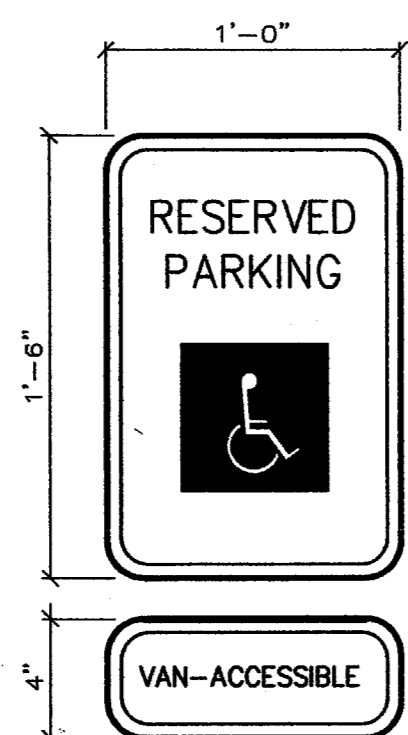
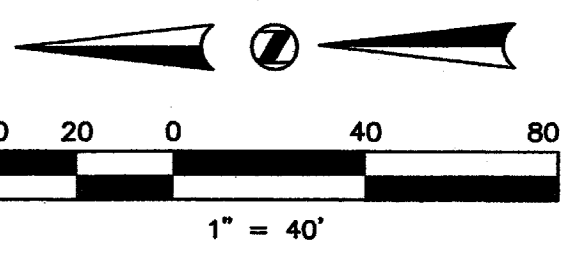

- NOTES:**
- SPACING BETWEEN LETTERS, COLORS, AND PROCESSES SHALL CONFORM STANDARD HIGHWAY AND SIGN DESIGNS FOR TEXAS.
 - INSTALL WHERE INDICATED ON PLANS.
 - VAN-ACCESSIBLE SIGNAGE ON VAN SPACES ONLY.

TYPICAL SIGNAGE DETAIL
N.T.S.

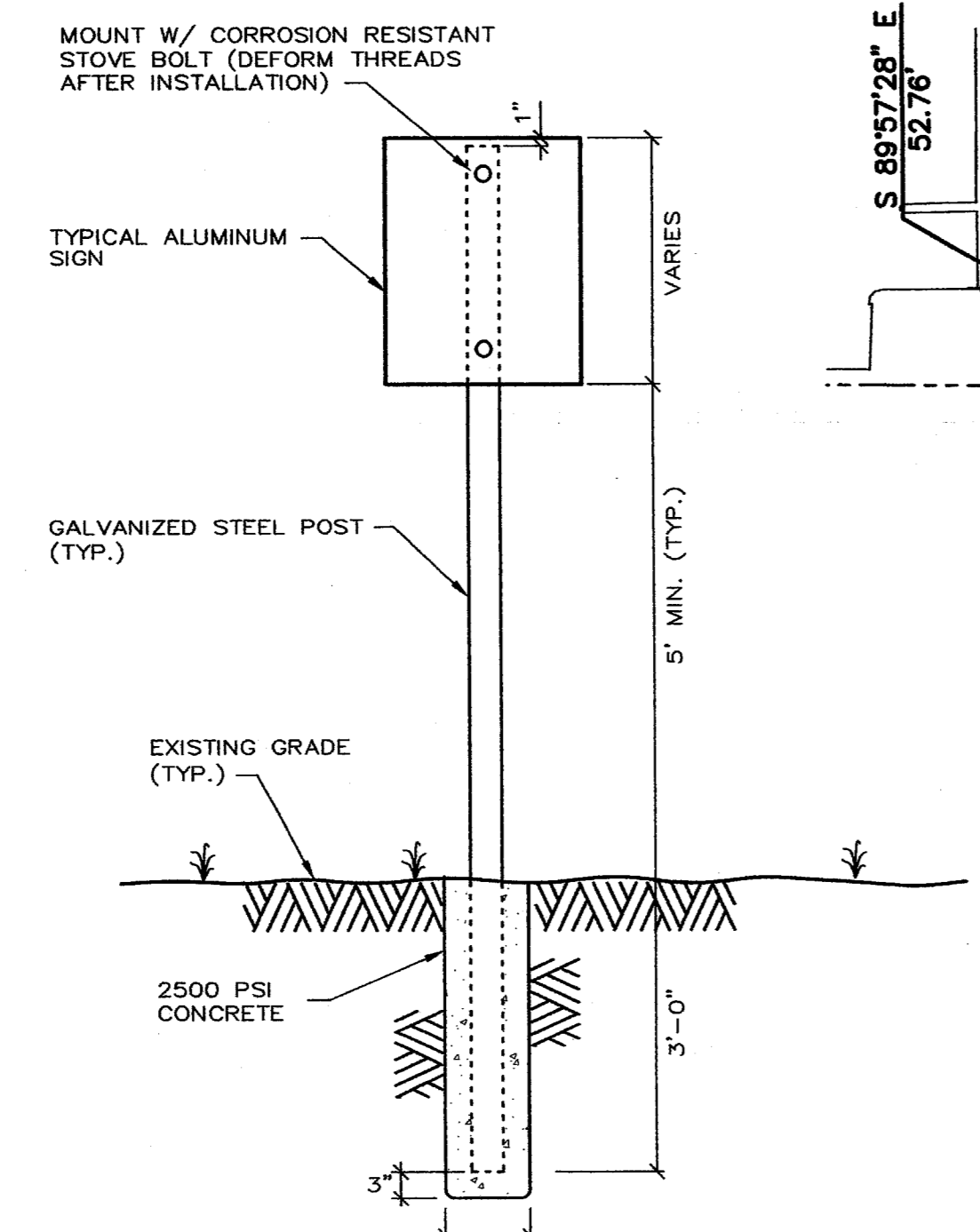

TYPICAL SIGNAGE MOUNTING DETAIL
N.T.S.

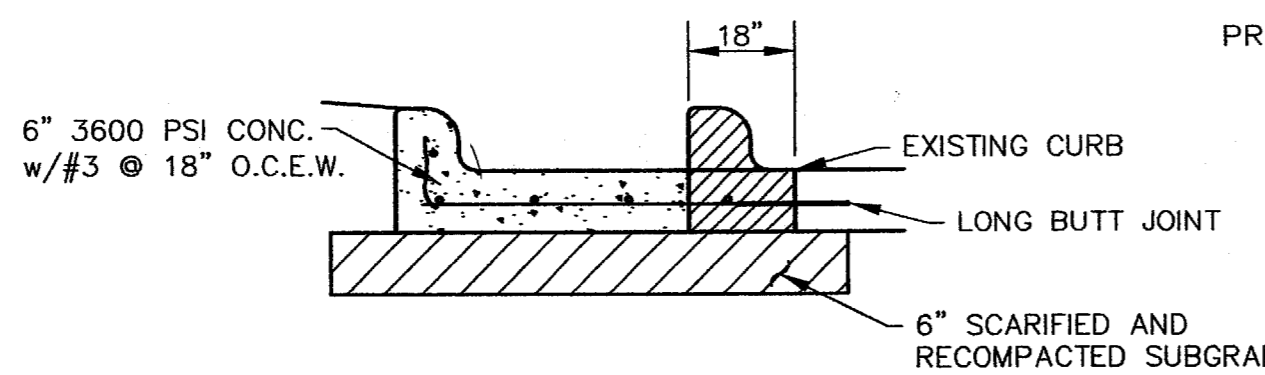

TYPICAL PAVEMENT SECTION @ EXISTING CURB
N.T.S.

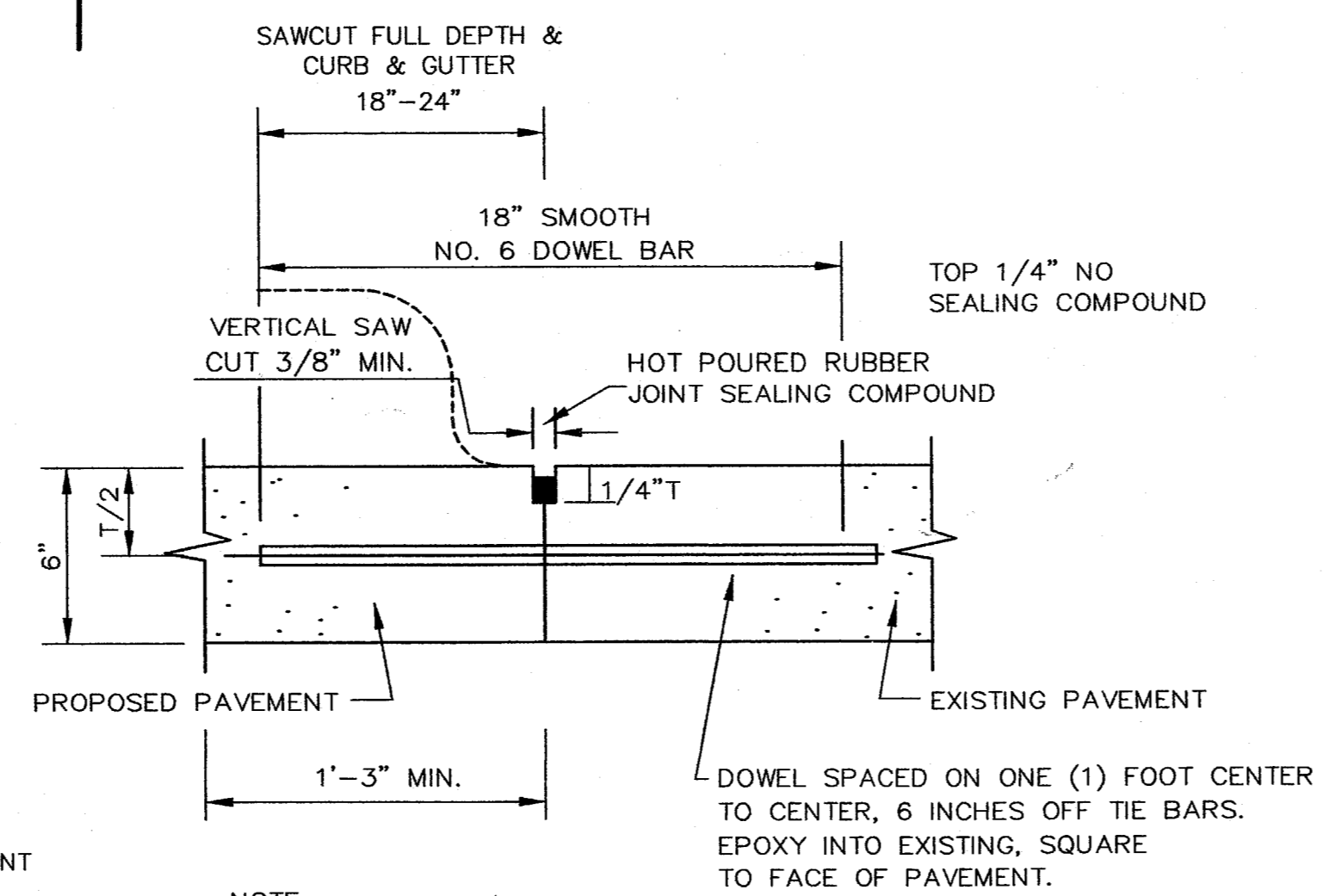

LONGITUDINAL BUTT JOINT
N.T.S.

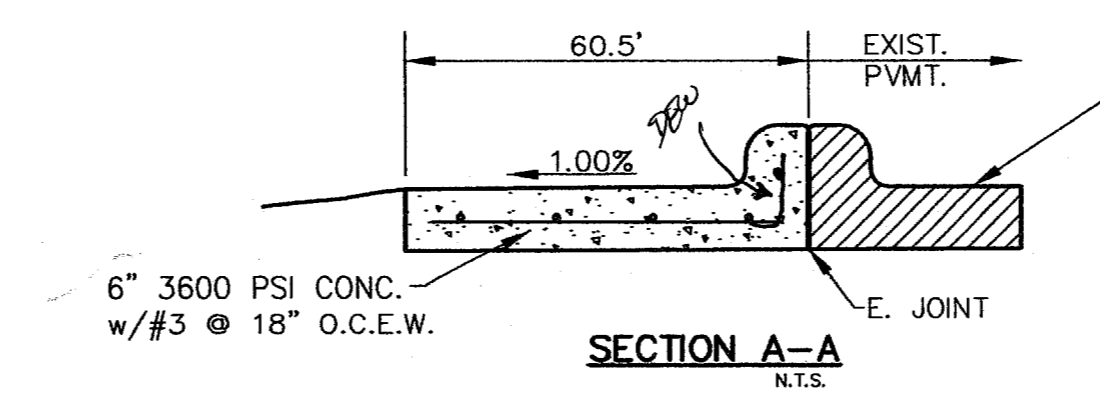

SECTION A-A
N.T.S.

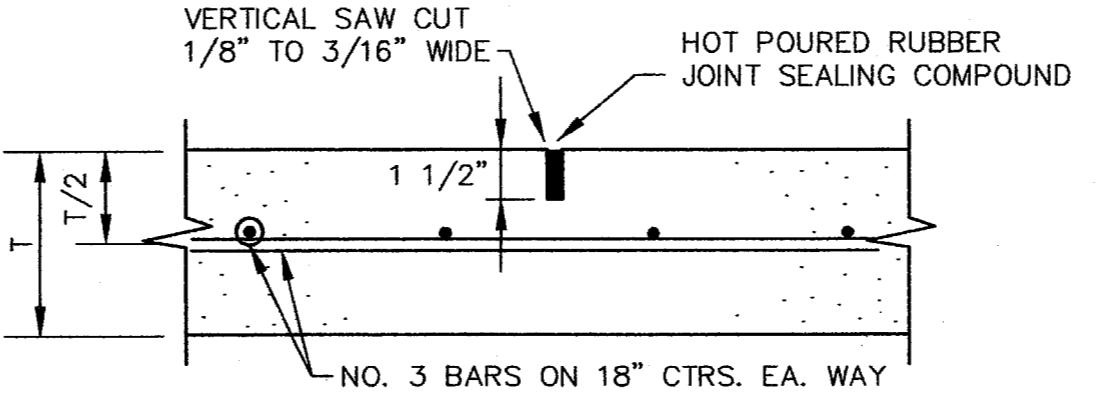

SAWED DUMMY (CONTROL) JOINT
N.T.S.

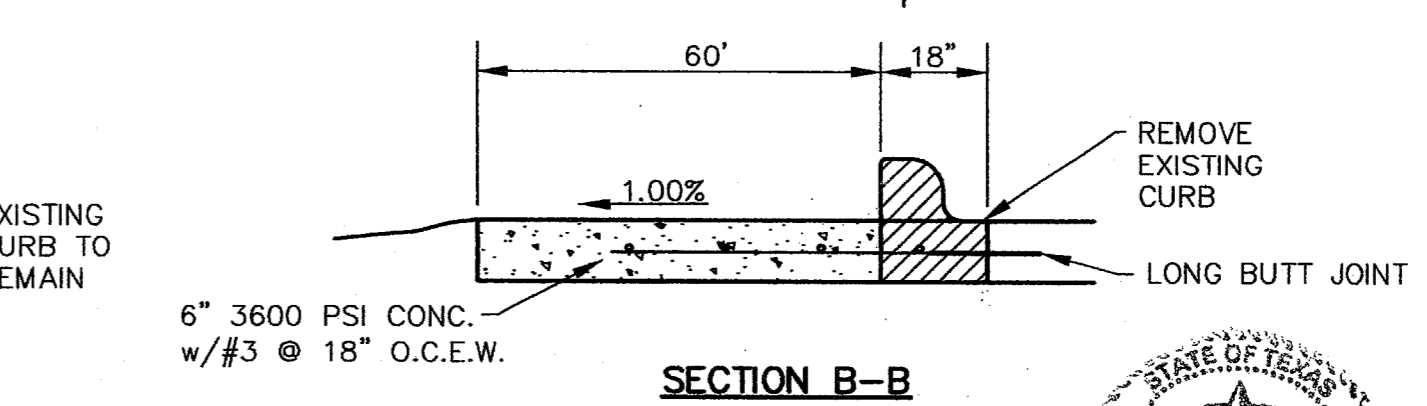

SECTION B-B
N.T.S.

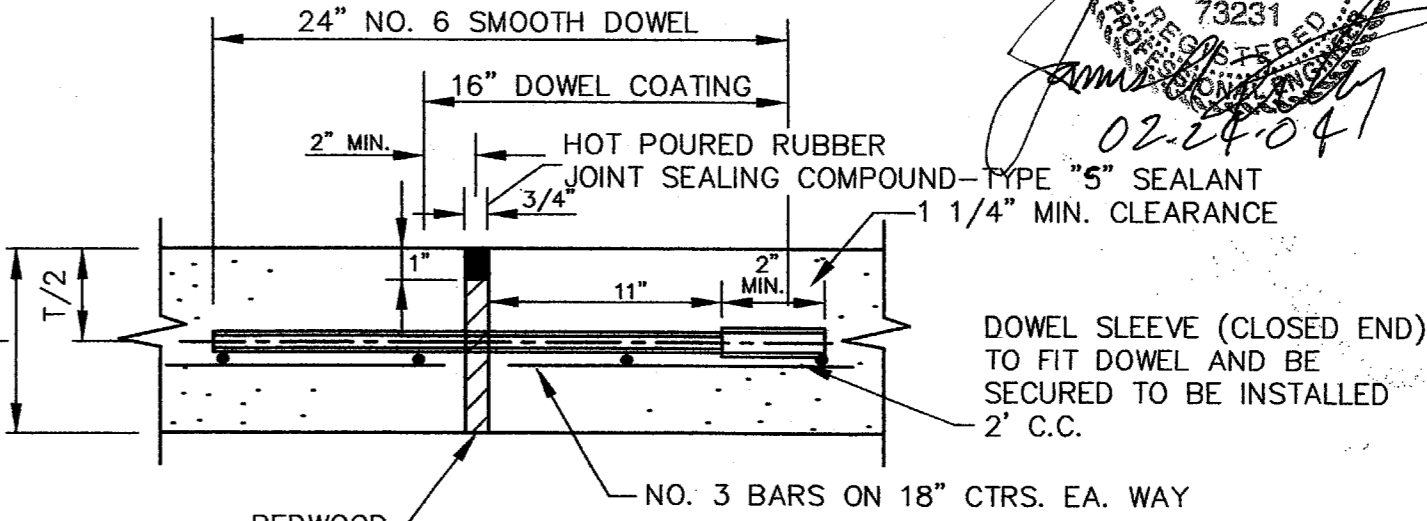

EXPANSION JOINT
N.T.S.

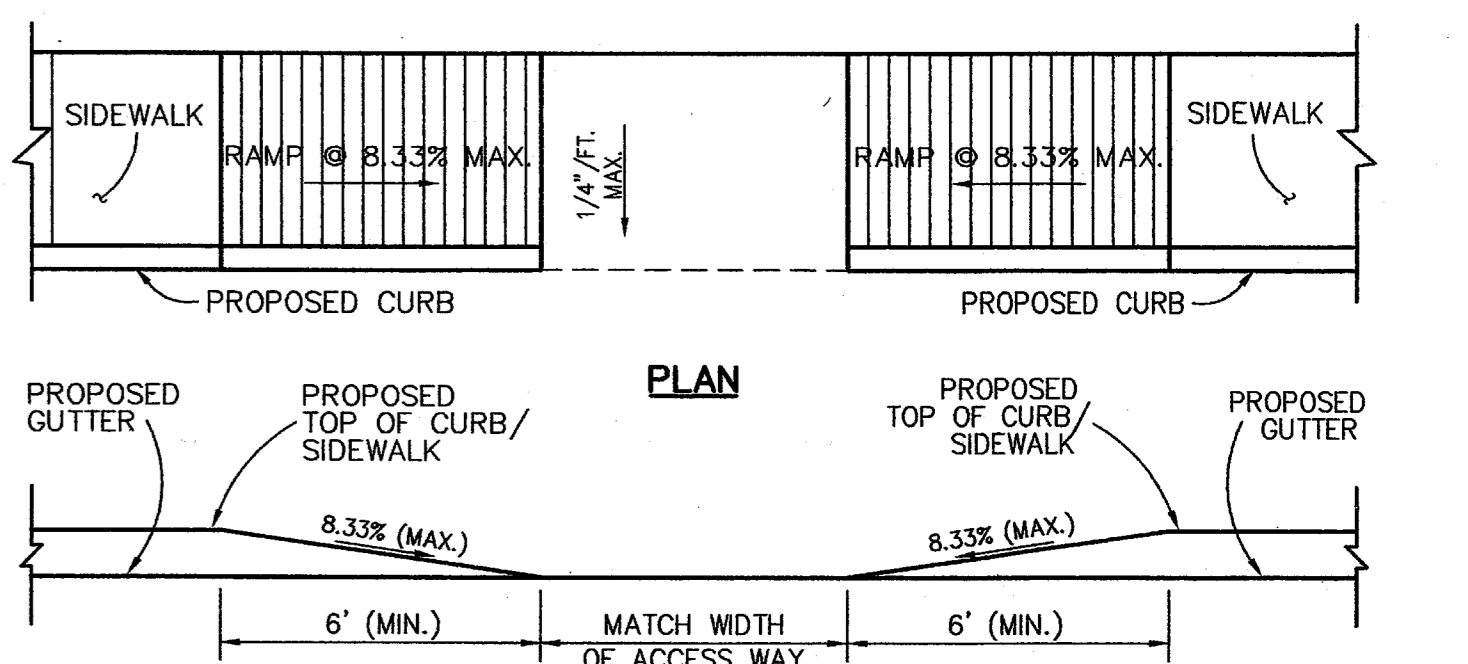

PLAN AND ELEVATION OF HANDICAP RAMP @ BUILDING
N.T.S.

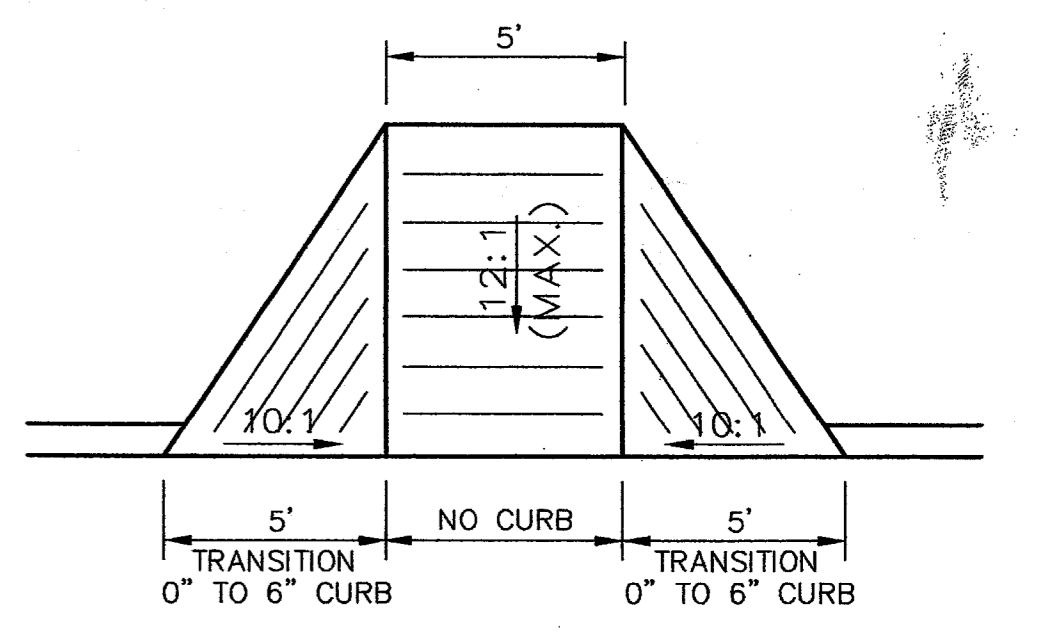

BARRIER FREE RAMP W/ FLARED END
N.T.S.

- NOTE:**
- WALKING SURFACE WILL HAVE DETECTABLE WARNING THAT CONSISTS OF CONTRACTION JOINTS SPACED 6 IN. CENTER-TO-CENTER AND SHALL CONTRAST VISUALLY WITH ADJOINING SURFACES, EITHER LIGHT-ON-DARK OR DARK-ON-DARK. MATERIAL USED TO PROVIDE CONTRAST SHALL BE AN INTEGRAL PART OF THE WALKING SURFACE.

BARRIER FREE RAMP W/ FLARED END
N.T.S.

LEGEND

[Hatched Pattern]	Existing Pavement To Be Removed
[Dotted Pattern]	6" 3600 PSI Conc. Pavement w/ #3 @ 18" O.C.E.W.
[Cross-hatched Pattern]	4" 3600 PSI Conc. Pavement w/ #3 @ 18" O.C.E.W.
[Dashed Line]	Sawcut

PAVING PLAN
CONTAINER STORE
CITY OF ADDISON, TEXAS

BROCKETTE • DAVIS • DRAKE, INC.
Civil & Structural Engineering • Surveying
4144 North Central Expressway, Suite 1100 • Dallas, Texas 75204
(214) 824-3647 • fax (214) 824-7064

DESIGN	DRAWN	DATE	SCALE	NOTES	FILE	NO.
JAR	DJR	02/24/04	1"=40'	BDD	C03244	C5

© Copyright 2002 Brockette/Davis/Drake, Inc. All Rights Reserved. No part of this drawing may be reproduced, stored in a retrieval system, or used in any form without the express written authorization of Brockette/Davis/Drake, Inc.