

BELT LINE ROAD

(100' RIGHT-OF-WAY)

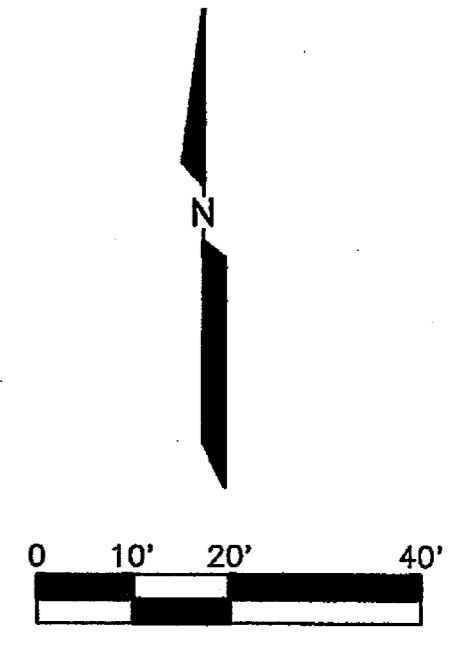

LEGEND	
—60—	EXIST. CONTOUR
-87-	PROP. CONTOUR
00.00	PROP. SPOT ELEV.
00 00	PROP. TOP OF CURB & GUTTER ELEVATION
*633.86 G	EXIST. GUTTER
*6.34.25 TC	PROP. TOP OF CURB
WV	EXIST. WATER VALVE
FH	EXIST. FIRE HYDRANT
L.P.	EXIST. LIGHT POLE
SSMH	EXIST. SANITARY SEWER MANHOLE

- GENERAL NOTES - GRADING**
- STANDARDS AND SPECIFICATIONS:** ALL MATERIALS, CONSTRUCTION METHODS, WORKMANSHIP, EQUIPMENT, SERVICES AND TESTING FOR ALL PUBLIC IMPROVEMENTS SHALL BE IN ACCORDANCE WITH THE GOVERNING AUTHORITIES' ORDINANCES, REGULATIONS, REQUIREMENTS, STATUTES, SPECIFICATIONS AND DETAILS, LATEST PRINTING AND AMENDMENTS THEREOF.
 - GEOTECHNICAL REPORT:** SITE PREPARATION, GRADING, FILL COMPACTION, AND BUILDING PAD PREPARATION SHALL BE PERFORMED IN ACCORDANCE WITH THE GEOTECHNICAL REPORT PREPARED BY HBC (REPORT NO. 0403050), DATED JANUARY, 2004.
 - EXISTING CONDITIONS:** PRIOR TO COMMENCING CONSTRUCTION, THE CONTRACTOR SHALL BE RESPONSIBLE FOR VERIFYING THE EXISTING CONDITIONS, INCLUDING GRADES AND DIMENSIONS. THE CONTRACTOR SHALL NOTIFY THE PROJECT ENGINEER OF ANY DISCREPANCIES.
 - EROSION CONTROL:** EROSION CONTROL DEVICES SHALL BE INSTALLED PRIOR TO COMMENCING CLEARING, STRIPPING AND GRADING OPERATIONS. REFER TO THE EROSION CONTROL PLAN FOR EROSION CONTROL DEVICES TO BE INSTALLED.
 - PROPOSED GRADES:** THE PROPOSED ELEVATIONS AND CONTOURS SHOWN ARE TO FINISHED GRADE. THE PROPOSED CONTOURS ARE APPROXIMATE. THE PROPOSED SPOT ELEVATIONS AND GRADIENTS ARE TO BE USED IN THE EVENT OF ANY DISCREPANCY WITH THE PROPOSED CONTOURS. MINOR ADJUSTMENT TO FINISH GRADE TO ACCOMPLISH SPOT DRAINAGE IS ACCEPTABLE.
 - ACCESSIBLE ROUTES:** GRADING FOR SIDEWALKS ALONG ACCESSIBLE ROUTES SHALL BE IN ACCORDANCE WITH T&A AND ADA STANDARDS WITH A MAXIMUM RUNNING SLOPE OF 5% AND A MAXIMUM CROSS SLOPE OF 2%.
 - STRIPPING AND DEBRIS REMOVAL:** THE BUILDING PAD(S), AREAS TO BE PAVED, AND ALL AREAS THAT ARE TO RECEIVE FILL MATERIAL SHALL BE STRIPPED OF VEGETATION, TREES, ROOTS, STUMPS, DEBRIS AND OTHER ORGANIC MATERIAL. THE DEPTH OF THE STRIPPING SHALL BE BASED ON THE DEPTH OF SURFACE SOIL CONTAINING ORGANIC MATERIAL. ALL TREES, INCLUDING STUMPS AND ROOT SYSTEMS, VEGETATION, DEBRIS AND OTHER OBJECTIONABLE MATERIAL SHALL BE REMOVED AND DISPOSED OFF SITE. STRIPPED TOPSOIL SHALL BE STOCKPILED IN A LOCATION ON THE SITE APPROVED BY THE DEVELOPER.
 - BURNING:** BURNING SHALL NOT BE ALLOWED ON THE PROJECT SITE UNLESS APPROVED IN WRITING BY THE GOVERNING AUTHORITIES AND THE DEVELOPER.
 - PROOF-ROLLING:** AFTER COMPLETION OF THE NECESSARY STRIPPING, CLEARING AND EXCAVATION AND PRIOR TO PLACING ANY REQUIRED FILL, THE EXPOSED SUBGRADE SHALL BE EVALUATED BY PROOF ROLLING WITH A HEAVY PNEUMATIC TIRE ROLLER, LOADED DUMP TRUCK OR SIMILAR EQUIPMENT WEIGHING APPROXIMATELY 10 TONS TO CHECK FOR POCKETS OF SOFT OR LOOSE MATERIAL. THE PROOF-ROLLING PROCEDURES SHOULD BE OBSERVED BY THE GEOTECHNICAL ENGINEER OR DESIGNATED REPRESENTATIVE. ANY UNDESIRABLE MATERIAL EXPOSED FROM PROOF-ROLLING SHALL BE REMOVED. PRIOR TO THE PLACEMENT OF ANY FILL, THE EXPOSED SUBGRADE SHOULD BE SCARIFIED TO A MINIMUM DEPTH OF 8 INCHES AND RECOMPACTED.
 - CONTROLLED FILL:** ALL SOILS USED FOR CONTROLLED FILL SHALL BE FREE OF ROOTS, VEGETATION, AND OTHER DELETERIOUS OR UNDESIRABLE MATTER. THE FILL MATERIAL SHALL BE PLACED IN LEVEL, UNIFORM LIFTS, WITH EACH LIFT COMPACTED TO THE MINIMUM DRY DENSITY WITHIN THE COMPACTION SOIL MOISTURE RANGES RECOMMENDED. THE LOOSE LIFT DEPTH SHALL NOT EXCEED 6". EACH LAYER SHALL BE PROPERLY PLACED, MIXED, SPREAD AND COMPACTED IN ACCORDANCE WITH THE FILL COMPACTION SECTION.
 - FILL COMPACTION:** FILL COMPACTION SHALL BE PERFORMED IN ACCORDANCE WITH THE GEOTECHNICAL REPORT.
 - BUILDING PAD:** THE BUILDING PAD SHALL BE CONSTRUCTED TO THE "LIMITS OF PAD PREPARATION" ILLUSTRATED ON THE GRADING PLAN AND TO WITHIN 0.1' +/- OF THE FINISH PAD ELEVATION (F.P.).

PROJECT NOTE:
REMOVAL OF CONCRETE PAVEMENT TO INCLUDE STORM DRAINAGE WORK SHALL NOT COMMENCE PRIOR TO JANUARY 10, 2011

BENCH MARK NOTE:
SITE BENCH MARK: STORM SEWER INLET RIM LOCATED AT THE NORTHEAST CORNER OF SUBJECT PROPERTY. ELEVATION = 634.44'

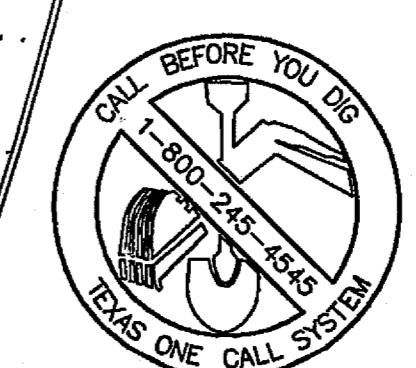

THE SEAL APPEARING ON THIS DOCUMENT WAS AUTHORIZED BY LAWRENCE A. CATES, P.E. 41838 ON 09.14.10

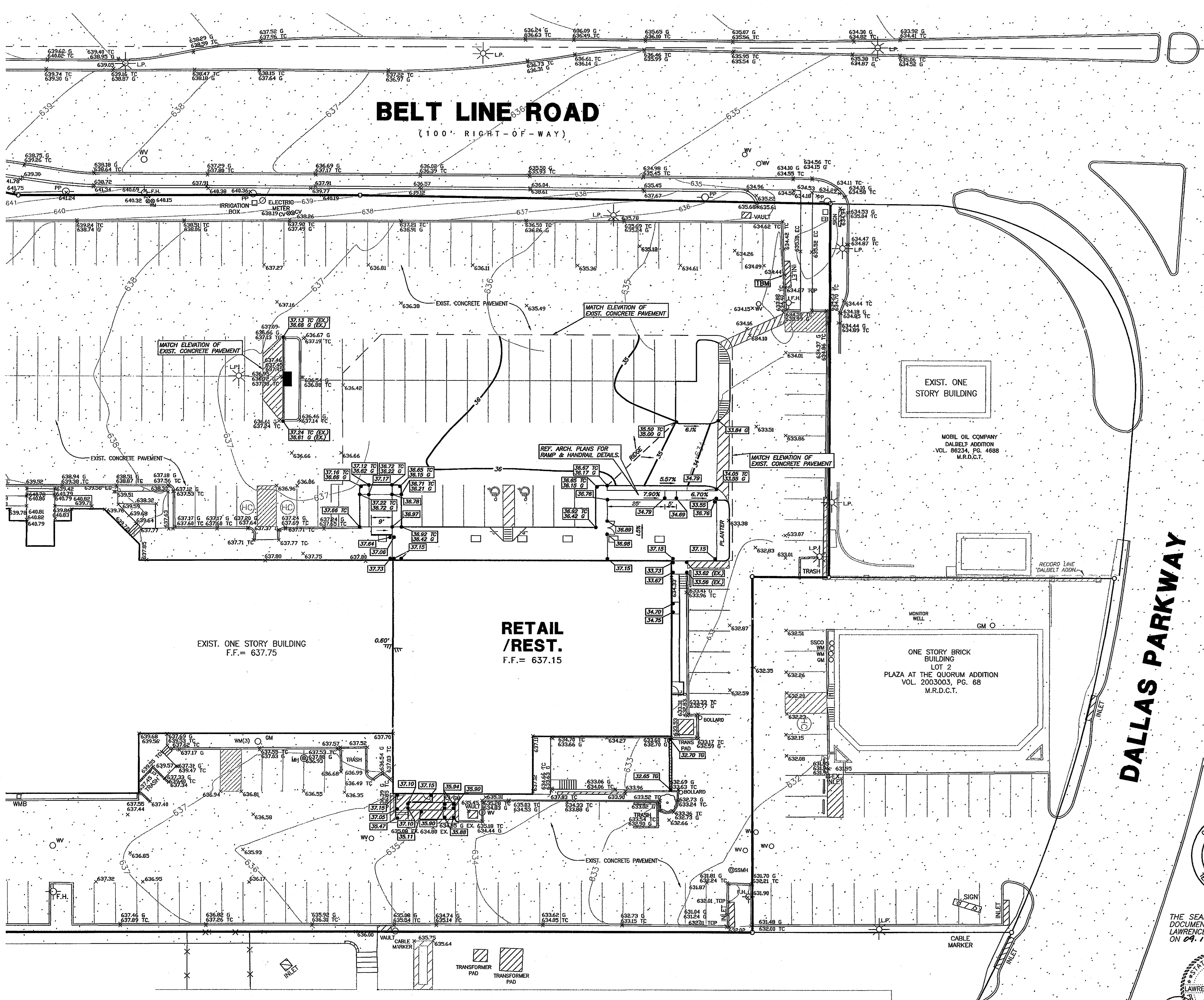
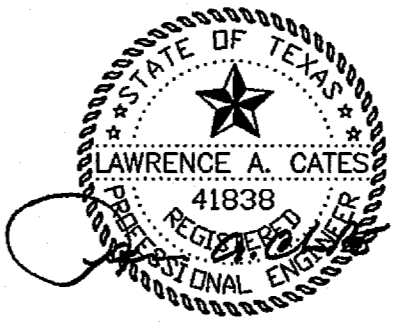

REV	DATE	REMARKS
09.03.10		ADDED TRENCH DRAIN & PROJECT NOTE.

GRADING PLAN	
ADDISON WALK	
LOT 1 - PLAZA AT THE QUORUM	
THE TOWN OF ADDISON, TEXAS	
L. Lawrence A. Cates & Associates, LLP	
Consulting Engineers * Dallas	
DESIGN	NO.
LCA	010-001
DRAWN	FILE
CAC/HDS	GRADING
DATE	NO.
9.9.10	C-5.0
SCALE	
1"=20'	
NOTES	
D.P.	