

**EXISTING DRAINAGE AREA MAP**

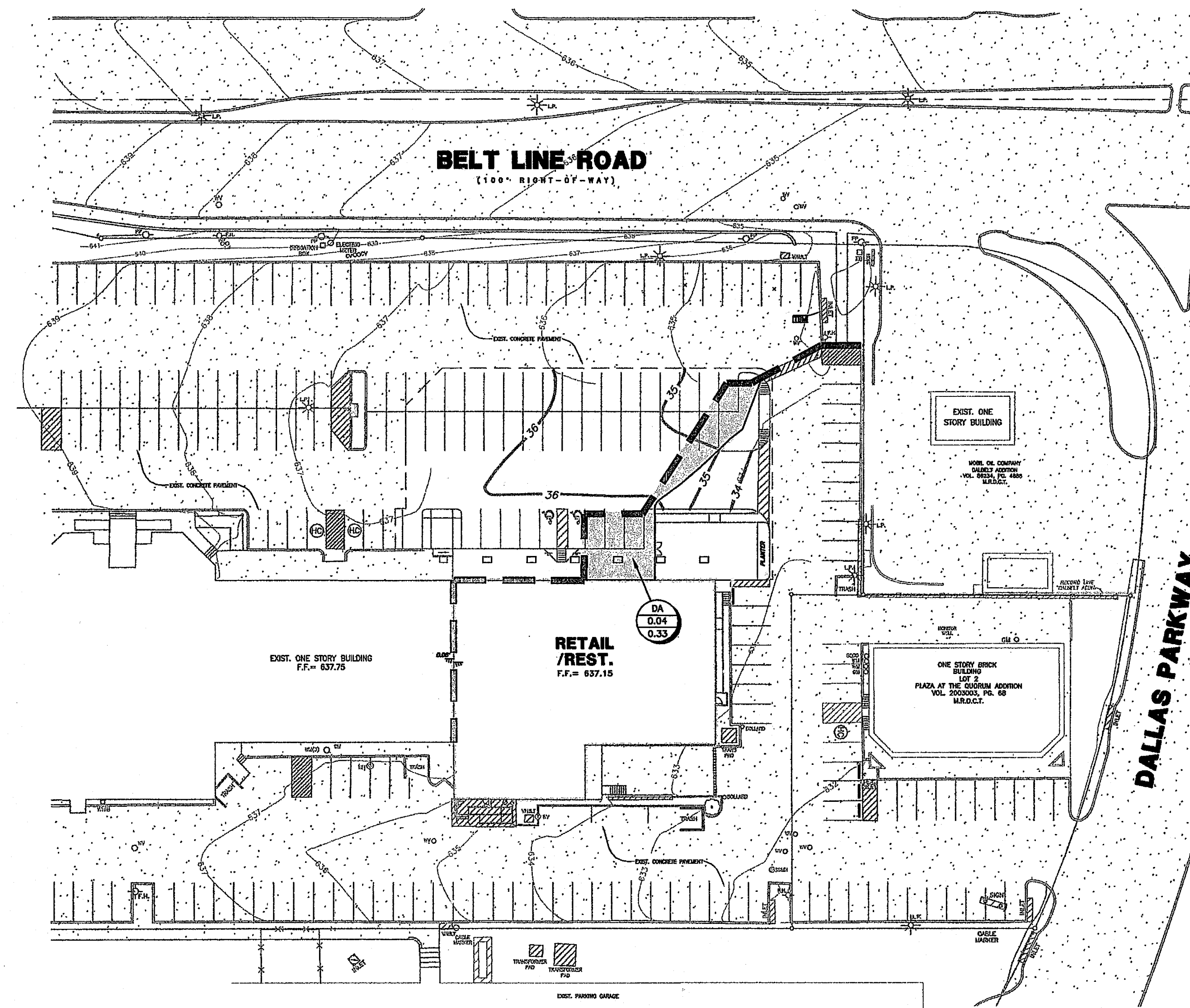

**PROPOSED DRAINAGE AREA MAP**

**LEGEND**

- ADDITIONAL DRAINAGE AREA TO EX. INLET @ NORTHEAST CORNER OF SITE
- ORIGINAL DRAINAGE DIVIDE
- NEW DRAINAGE DIVIDE
- ROOF DRAINS
- DRAINAGE AREA NO. Q<sub>100</sub> (CFS) AREA (ACRES)

**DIFFERENCE IN Q<sub>100</sub> TO INLET**  
 $Q = C \times I \times A$

D.A. NO.	AREA (acres)	C	I <sub>100</sub> (in/hr)	Q <sub>100</sub> (cfs)
1	0.04	0.90	8.74	0.33

**PROJECT NOTE:**  
 REMOVAL OF CONCRETE PAVEMENT TO INCLUDE STORM DRAINAGE WORK SHALL NOT COMMENCE PRIOR TO JANUARY 10, 2011

**BENCH MARK NOTE:**  
 SITE BENCH MARK: STORM SEWER INLET RIM LOCATED AT THE NORTHEAST CORNER OF SUBJECT PROPERTY. ELEVATION = 634.44'

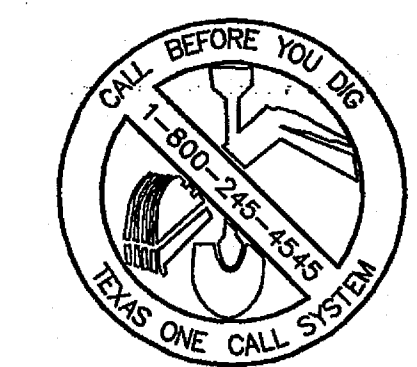

THE SEAL APPEARING ON THIS DOCUMENT WAS AUTHORIZED BY LAWRENCE A. CATES, P.E. 41838 ON 09-03-10

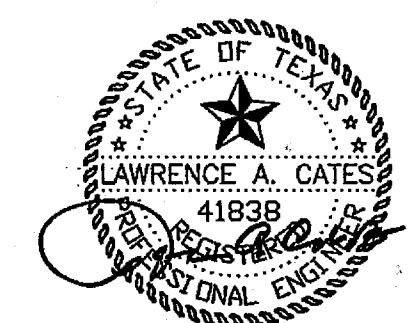

REV.	DATE	REMARKS
1	09.03.10	ADDED PROJECT NOTE.

**DRAINAGE AREA MAPS**

ADDISON WALK  
 LOT 1 - PLAZA AT THE QUORUM  
 THE TOWN OF ADDISON, TEXAS

Lawrence A. Cates & Associates, LLP  
 Consulting Engineers \* Dallas

DESIGN	DRAWN	DATE	SCALE	NOTES	FILE	NO.
LCA	CAC/HDS	9.03.10	1"=40'	D.P.	010-001 GRADING	C-6.0

R:\DWG\010-001\DWG\010-001\_DAMP.dwg, Layout1, 9/3/2010 2:20:01 PM, chis