

TRAFFIC CONTROL NOTES

1. CONTRACTOR IS RESPONSIBLE FOR BIDDING ALL TRAFFIC CONTROL SHOWN ON THIS PLAN THAT FALLS OUTSIDE AS WELL AS INSIDE THE PROPOSED CONSTRUCTION URDANCE LINE. **NO CHANGE ORDERS WILL BE ACCEPTED OR APPROVED FOR FAILURE TO INCLUDE THESE ITEMS.**
2. CONTRACTOR SHALL COORDINATE CONSTRUCTION IN SHOPPING CENTER TRAFFIC ZONES WITH THE PROPERTY MANAGER.
3. CONTRACTOR SHALL PROVIDE A MINIMUM 12 FOOT WIDE TRAVEL LANE DURING STORM DRAIN AND WATER LINE CONSTRUCTION. DRIVE AISLES ARE SUFFICIENTLY WIDE ENOUGH TO ACCOMMODATE STAGED CONSTRUCTION AND A SAFE PATH OF TRAVEL.
4. FENCING, BARRICADES, TRENCH PLATES AND ALL OTHER NECESSARY SAFETY PRECAUTIONS SHALL BE PROVIDED WHILE EXCAVATIONS ARE OPEN AND HAVE NOT BEEN RETURNED TO EXISTING OR BETTER CONDITION.
5. CONTRACTOR SHALL REFER TO TPOOT STANDARDS FOR TRAFFIC CONTROL SIGNAGE AS APPROPRIATE.
6. CONTRACTOR SHALL PROVIDE DETOUR INFORMATION AND ALTERNATE ROUTE INFORMATION AT THE MAJOR INTERSECTIONS NEAR THE WORK BEING PERFORMED TO ALLOW MOTORISTS TO CHOOSE AN ALTERNATE PATH OF TRAVEL.

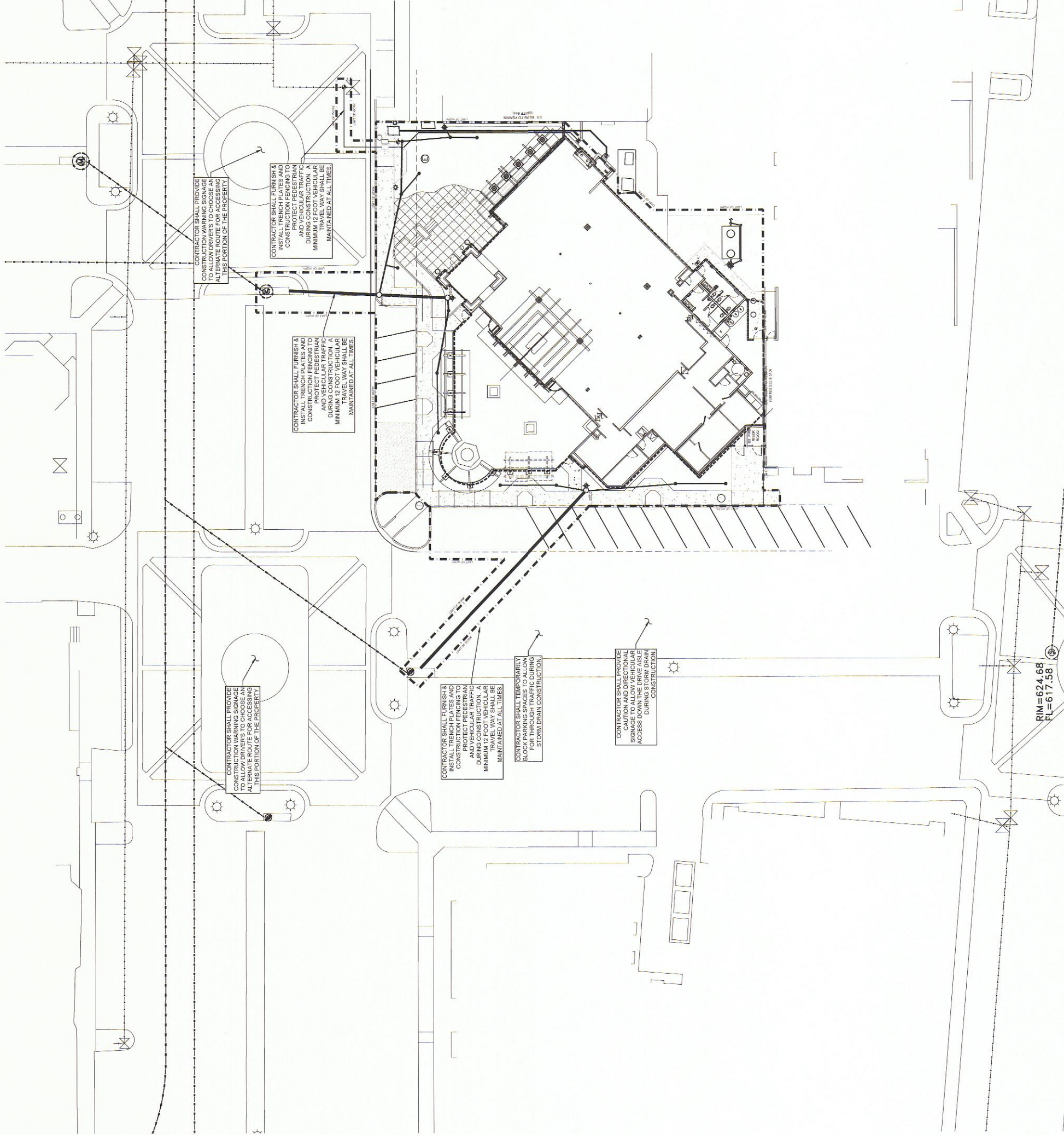

CONTRACTOR SHALL PROVIDE CONSTRUCTION WARNING SIGNAGE TO ALLOW DRIVERS TO CHOOSE AN ALTERNATE ROUTE FOR ACCESSING THIS PORTION OF THE PROPERTY.

CONTRACTOR SHALL FURNISH AND INSTALL TRENCH PLATES AND PROTECT PEDESTRIAN AND VEHICULAR TRAFFIC DURING CONSTRUCTION. A MINIMUM 12 FOOT VEHICULAR TRAVEL WAY SHALL BE MAINTAINED AT ALL TIMES.

CONTRACTOR SHALL FURNISH AND INSTALL TRENCH PLATES AND PROTECT PEDESTRIAN AND VEHICULAR TRAFFIC DURING CONSTRUCTION. A MINIMUM 12 FOOT VEHICULAR TRAVEL WAY SHALL BE MAINTAINED AT ALL TIMES.

CONTRACTOR SHALL TEMPORARILY BLOCK PARKING SPACES TO ALLOW FOR THROUGH TRAFFIC DURING STORM DRAIN CONSTRUCTION.

CONTRACTOR SHALL PROVIDE CAUTION AND DIRECTIONAL SIGNAGE TO ALLOW VEHICULAR ACCESS TO STORM DRAIN DURING CONSTRUCTION.

CONTRACTOR SHALL PROVIDE CONSTRUCTION WARNING SIGNAGE TO ALLOW DRIVERS TO CHOOSE AN ALTERNATE ROUTE FOR ACCESSING THIS PORTION OF THE PROPERTY.

CONTRACTOR SHALL FURNISH AND INSTALL TRENCH PLATES AND PROTECT PEDESTRIAN AND VEHICULAR TRAFFIC DURING CONSTRUCTION. A MINIMUM 12 FOOT VEHICULAR TRAVEL WAY SHALL BE MAINTAINED AT ALL TIMES.

<p>PROJECT NAME: LAZY DOG RESTAURANT & BAR</p> <p>PROJECT ADDRESS: VILLAGE ON THE PARKWAY 5100 BELT LINE ROAD, SUITE 500 ADDISON, TX 75254</p> <p>BUILDING DEPT. 2nd SUBMITTAL / BID SET</p> <p>PROJECT #: C-LDR-004</p> <p>ISSUE DATE: 10-22-2014</p>		<p>TRAFFIC CONTROL PLAN</p> <p>SHEET NUMBER: C6.0</p>						
<p>LAZY DOG RESTAURANT & BAR</p>		<p>VALLEY CIVIL DESIGN GROUP</p> <p>2267 MORNING MESA HENDERSON, NV 89052</p> <p>702.551.2005</p> <p>info@valley-cdg.com</p> <p>TBPE Firm No. 14469</p>						
<p>PROFESSIONAL ENGINEER</p> <p>MATTHEW W. LOSER</p> <p>103982</p> <p>STATE OF TEXAS</p>	<p>12/10/14</p> <table border="1"> <thead> <tr> <th>Revision</th> <th>Date</th> <th>Description</th> </tr> </thead> <tbody> <tr> <td>Rev</td> <td>10 DEC 14</td> <td>PLAN CHECK COMMENTS</td> </tr> </tbody> </table>	Revision	Date	Description	Rev	10 DEC 14	PLAN CHECK COMMENTS	<p>PROJECT TITLE: LAZY DOG RESTAURANT & BAR</p>
Revision	Date	Description						
Rev	10 DEC 14	PLAN CHECK COMMENTS						

APPROVED FOR CONSTRUCTION

Town of Addison

Infrastructure Operations And Services Department

APPROVED BY: *Dave Schulte*

DATE: *12/17/14*

16801 Westgrove Dr. Addison, TX 75001 (972)450-2871

All responsibility for the adequacy of these plans remains with the Engineer who prepared them. In approving these plans, the Town of Addison makes no representation of adequacy of the work of the Design Engineer.